

FAP RTE	SECTION	COUNTY	TOTAL SHEETS	SHEET NO.
• 115BR-1, 110BR-1		••	73	1

• 776 & 782
 •• HAMILTON & WHITE
 P-99-
 D-99-007-08

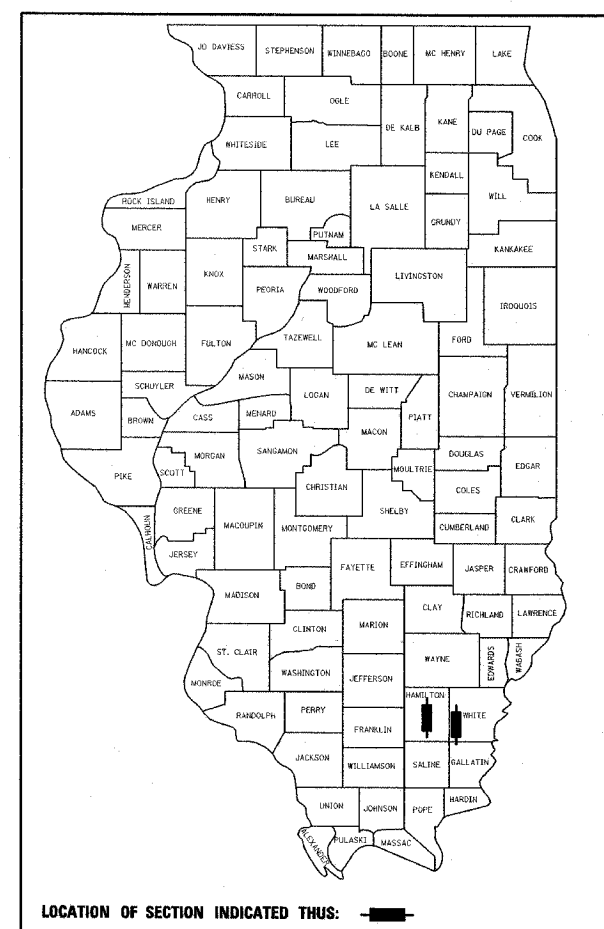

STATE OF ILLINOIS
 DEPARTMENT OF TRANSPORTATION
 DIVISION OF HIGHWAYS

**PROPOSED
 HIGHWAY PLANS**

FAP RTE'S 776 & 782 (IL 142 & IL 1)
 SECTIONS 115BR-1 & 110BR-1
 PROJECT: *BHF-0005(585)*
 HAMILTON & WHITE COUNTIES

C - 99 - 007-08

PPC DECK BEAM SUPERSTRUCTURE REPLACEMENTS
 OVER BEAR CREEK AND INDIAN CREEK

INDEX OF SHEETS

SHEET NO.	DESCRIPTION
ROADWAY PLANS	
1.	COVER SHEET
2.	GENERAL NOTES AND STANDARDS
3.	SUMMARY OF QUANTITIES
4.-5.	TYPICAL SECTIONS
6.-7.	SCHEDULES OF QUANTITIES
8.	FAP RTE 776 (IL 142) PLAN AND PROFILE
9.	FAP RTE 782 (IL 1) PLAN AND PROFILE
10.-13.	STAGE CONSTRUCTION PLANS
14.	WIDE LOAD DETOUR
15.-16.	EROSION CONTROL AND DRAINAGE PLANS
17.	MISCELLANEOUS DETAILS
STRUCTURE PLANS - SN 033-0016	
18.	GENERAL PLAN
19.	GENERAL DATA
20.	STAGE CONSTRUCTION DETAILS
21.	TEMPORARY CONCRETE BARRIER
22.	SUPERSTRUCTURE
23.-24.	SUPERSTRUCTURE DETAILS
25.	APPROACH DETAILS
26.	SUPERSTRUCTURE AND APPROACH DETAILS
27.	STEEL RAILING, TYPE SM
28.	STRIP SEAL EXPANSION JOINT
29.	NORTH ABUTMENT
30.	SOUTH ABUTMENT
31.	ABUTMENT DETAILS
32.	PIER
33.	PIER DETAILS
34.	BAR SPLICER ASSEMBLY DETAILS
EXISTING STRUCTURE PLANS - SN 033-0016	
35.-45.	EXISTING STRUCTURE PLANS
STRUCTURE PLANS - SN 097-0026	
46.	GENERAL PLAN
47.	GENERAL DATA
48.	STAGE CONSTRUCTION DETAILS
49.	TEMPORARY CONCRETE BARRIER
50.	SUPERSTRUCTURE
51.-52.	SUPERSTRUCTURE DETAILS
53.-54.	APPROACH DETAILS
55.	SUPERSTRUCTURE AND APPROACH DETAILS
56.	STEEL RAILING, TYPE SM
57.	STRIP SEAL EXPANSION JOINT
58.	NORTH ABUTMENT
59.	NORTH ABUTMENT DETAILS
60.	SOUTH ABUTMENT
61.	SOUTH ABUTMENT DETAILS
62.	BAR SPLICER ASSEMBLY DETAILS
EXISTING STRUCTURE PLANS - SN 097-0026	
63.-66.	EXISTING STRUCTURE PLANS
CROSS SECTIONS	
67.-69.	FAP RTE 776 (IL 142) CROSS SECTIONS
70.-73.	FAP RTE 782 (IL 1) CROSS SECTIONS

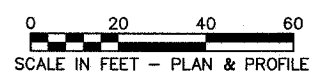

FULL SIZE PLANS HAVE BEEN PREPARED USING STANDARD ENGINEERING SCALES. REDUCED SIZED PLANS WILL NOT CONFORM TO STANDARD SCALES. IN MAKING MEASUREMENTS ON REDUCED PLANS, THE ABOVE SCALES MAY BE USED.

MICROFILMED _____
 REEL NUMBER _____
 AWARDED _____
 RESIDENT ENGINEER _____
 AS BUILT CHANGES WERE MADE ON THE FOLLOWING SHEETS _____

J.U.L.I.E.
 JOINT UTILITY LOCATION INFORMATION FOR EXCAVATION
 1-800-892-0123

DISTRICT 9 NO. (217) 549-2171
 PROJECT ENGINEER: DAVID PICHE
 UNIT CHIEF:
 TOWNSHIP: MCLEANSBORO & INDIAN CREEK
 CONTRACT NO: 78027

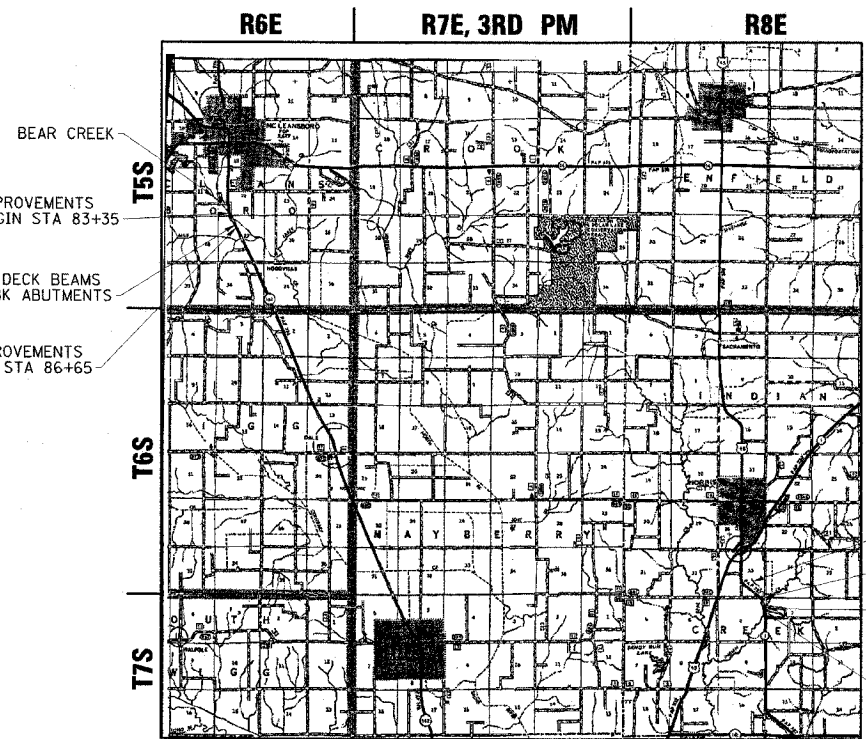

LOCATION MAP

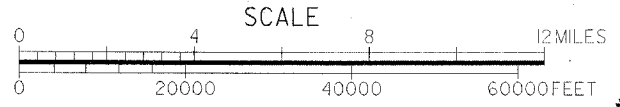

115BR-1 110BR-1
 GROSS LENGTH : 330 FT. = 0.063 MI. ; 322.5 FT. = 0.061 MI.
 NET LENGTH : 330 FT. = 0.063 MI. ; 322.5 FT. = 0.061 MI.



**DESIGN DESIGNATION
 N.A.**



Richard D. Payne DATE: 02/29/08
 ILLINOIS PROFESSIONAL LICENSE NO. 37421
 (EXPIRATION DATE: 11-30-09)

FUNCTIONAL CLASSIFICATION: MINOR ARTERIAL (RURAL)
 DESIGN SPEED: 55 mph
 POSTED SPEED: 55 mph
 ADT: (IL 142; IL 1) 2500; 2240 (2007)
 PV: (IL 142; IL 1) 85%; 83%
 SU: (IL 142; IL 1) 8%; 6%
 MU: (IL 142; IL 1) 7%; 11%

STATE OF ILLINOIS
 DEPARTMENT OF TRANSPORTATION
 DIVISION OF HIGHWAYS

SUBMITTED *March 14, 2008*
May 9, 2008
May 9, 2008
May 9, 2008

DEPUTY DIRECTOR OF HIGHWAYS, REGION ENGINEER
 INTERIM ENGINEER OF DESIGN AND ENVIRONMENT
 DIRECTOR OF HIGHWAYS, CHIEF ENGINEER

**PRINTED BY THE AUTHORITY
 OF THE STATE OF ILLINOIS**