



FAS RTE	SECTION	COUNTY	TOTAL SHEETS	SHEET NO.
899	8BR-2	SALINE	75	11
STA. 798+75		TO STA. 806+50		
FED. ROAD DIST. NO.		ILLINOIS	FED. AID PROJECT	

GENERAL NOTES

1. TRAFFIC CONTROL SHALL BE ERECTED AS SHOWN AND ACCORDING TO "TRAFFIC CONTROL AND PROTECTION, STANDARD 701321."
2. SEE SPECIAL PROVISIONS FOR ADDITIONAL TRAFFIC CONTROL REQUIREMENTS.
3. COORDINATE LOCATION OF SIGNALS WITH FINAL WORK AS DIRECTED BY THE ENGINEER.
4. CONSTRUCT TEMPORARY RUMBLE STRIPS AT LOCATIONS SHOWN ON STANDARD 701321.
5. THE DIMENSION SHOWN ON THE WIDTH RESTRICTION SIGN (W12-I102(O)-48) SHOWN ON STANDARD 701321 SHALL BE 11'-0" FOR STAGE II CONSTRUCTION.
6. THE EXISTING 'TURNDOWN' TBT'S AT THE NE AND NW CORNERS OF THE BRIDGE MUST BE REMOVED AND REPLACED AS SHOWN PRIOR TO SHIFTING TRAFFIC TO THE STAGE I LANE.

LEGEND

- TRAFFIC SIGNAL WITH BACKPLATE, SIGNAL DIRECTION INDICATED
- BASE COURSE WIDENING, 10"
- TEMPORARY RAMP
- PAVEMENT REMOVAL
- HMA SURFACE REMOVAL, SPECIAL

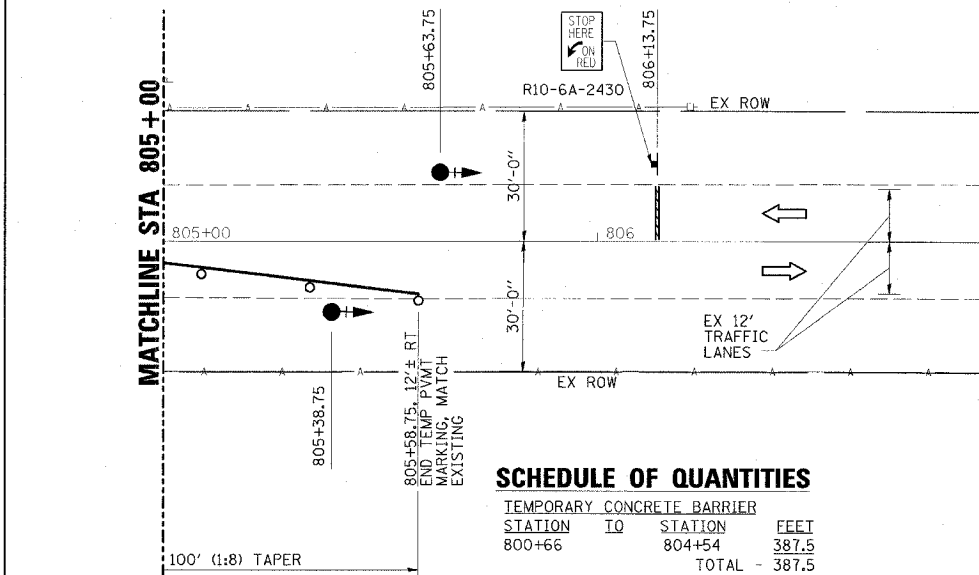
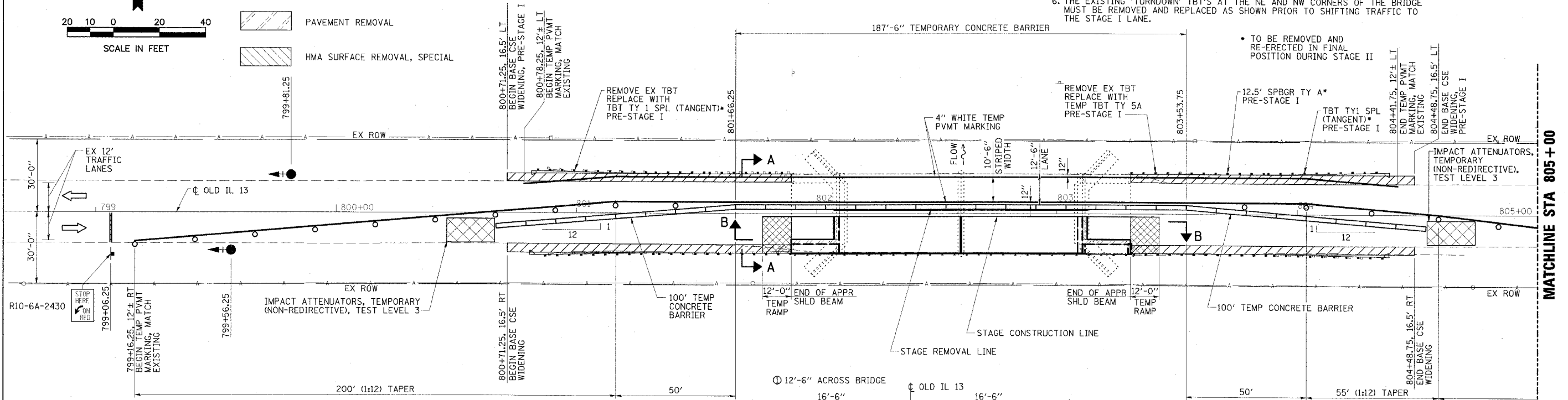
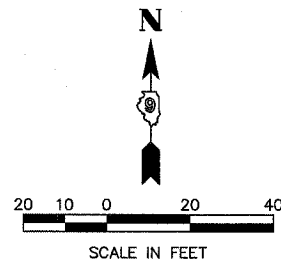

SCHEDULE OF QUANTITIES

TEMPORARY CONCRETE BARRIER		
STATION TO	STATION	FEET
800+66	804+54	387.5
TOTAL		387.5
TEMPORARY BRIDGE TRAFFIC SIGNALS - 1 EACH		
TEMPORARY RUMBLE STRIPS - 6 EACH		
IMPACT ATTENUATORS, TEMPORARY (NON-REDIRECTIVE), TEST LEVEL 3 - 2 EACH		

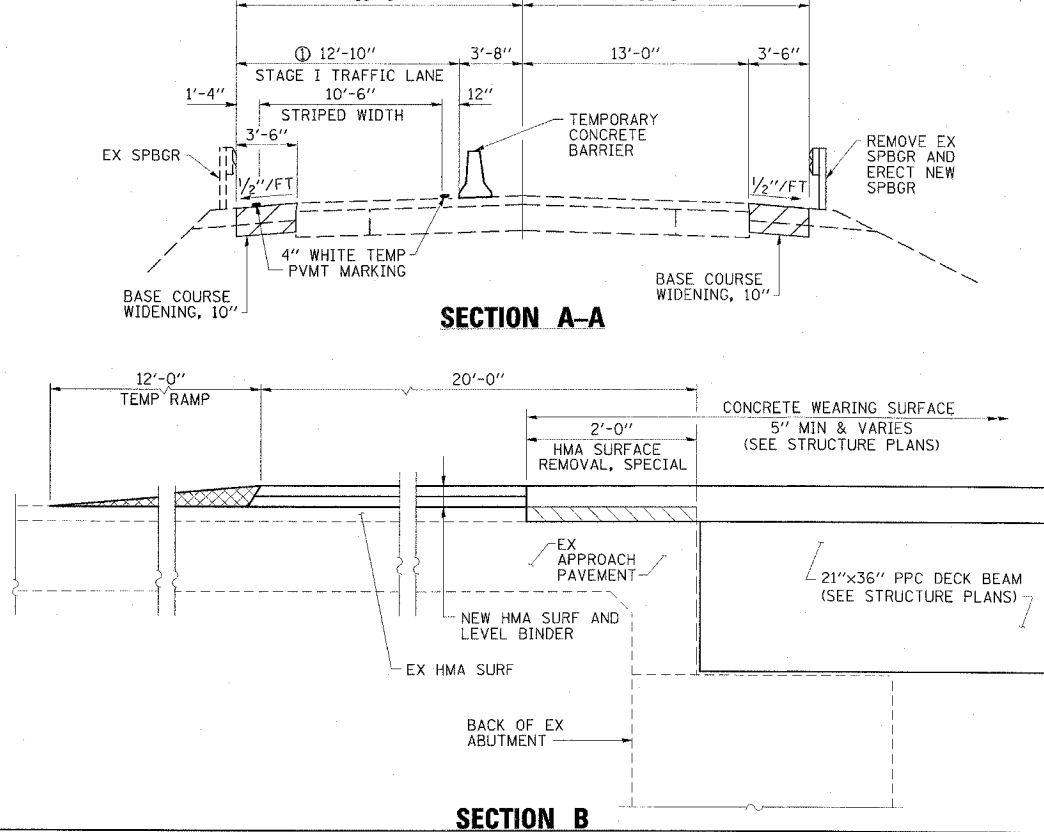

ERECT THIS SIGN AT THE IL 13/OLD IL 13 INTERSECTION IN HARRISBURG

WIDE LOADS OVER 11'-0"

DETOUR VIA

60"x90"

ERECT THIS SIGN AT THE IL 13/OLD IL 13 INTERSECTION NEAR THE WILLIAMSON/SALINE COUNTY LINE

WIDE LOADS OVER 11'-0"

DETOUR VIA

60"x90"

DETOUR NOTES

1. THE CONTRACTOR SHALL FURNISH THE POSTS AND ERECT THE SIGNS AT THE LOCATIONS DIRECTED BY THE ENGINEER. ALL SIGNS SHALL BE POST MOUNTED AND SHALL REMAIN IN PLACE THROUGHOUT STAGE CONSTRUCTION OPERATIONS.
2. THE ABOVE NOTED WORK, INCLUDING SIGNS, POSTS, HARDWARE, AND LABOR SHALL BE INCLUDED IN THE CONTRACT UNIT PRICE, EACH, FOR TRAFFIC CONTROL AND PROTECTION, STANDARD 701321 AND NO OTHER COMPENSATION WILL BE ALLOWED.

WIDE LOAD DETOUR

ESCA CONSULTANTS, INC.

DESIGNED BY:	JMS	10/07
DRAWN BY:	CJ/HAS	10/07
CHECKED BY:	DAJ/MTD	01/08
APPROVED BY:	RDP	02/08

STAGE I CONSTRUCTION
FAP RTE 899 (OLD IL 13)
SECTION 8BR-2
SALINE COUNTY