

BENCHMARK 2499
RR SPIKE SET IN 36" BLACK OAK
STA 52+20 - ELEV 372.165'

BOX CULVERT END SECTIONS
DS FL ELEVATION 366.00

BOX CULVERT END SECTIONS
US FL ELEVATION 366.20

EXISTING ROW

PROPOSED LIMIT OF CONSTRUCTION

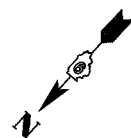
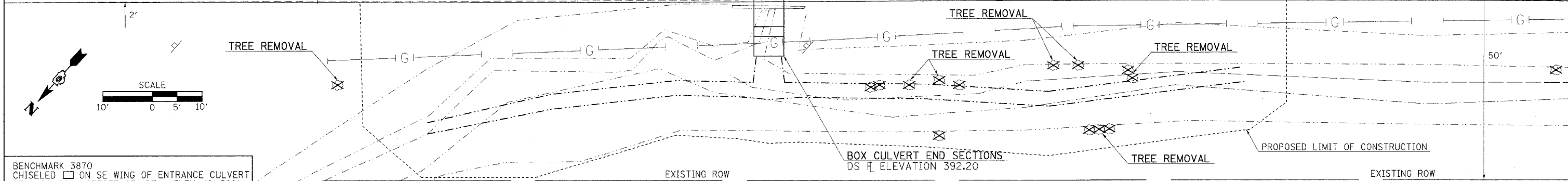
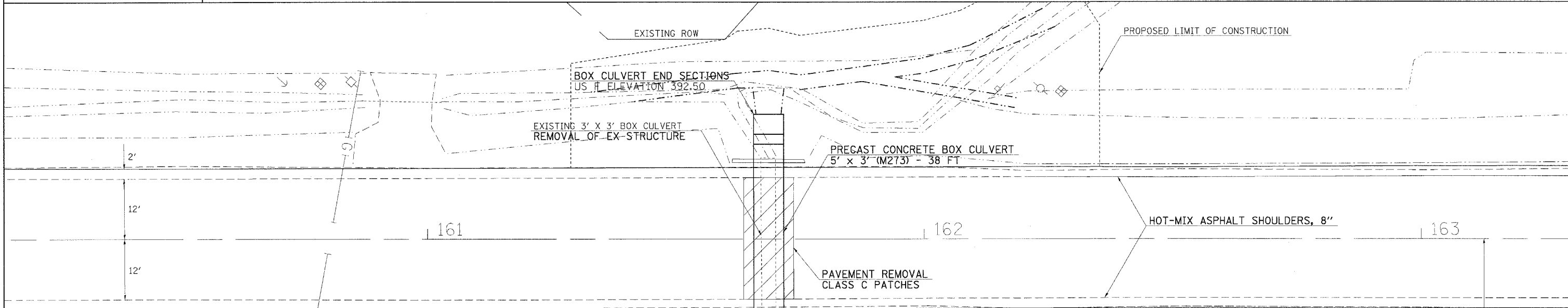

BENCHMARK 3870
CHISELED □ ON SE WING OF ENTRANCE CULVERT
STA 166+06 - OFFSET 23' RT - ELEV 401.762'

FILE NAME =
c:\projects\d901907\d901907p1.m32

USER NAME = thomaahf

DESIGNED -
DRAWN -
CHECKED -
DATE -

REVISD -
REVISD -
REVISD -
REVISD -

PLOT SCALE = 10.0000' / IN.
PLOT DATE = 3/18/2009

STATE OF ILLINOIS
DEPARTMENT OF TRANSPORTATION

PLAN VIEW - LOCATIONS 1 & 2

SCALE: 1" = 10' SHEET NO. ___ OF ___ SHEETS STA. _____ TO STA. _____

F.A.P. RTE.	SECTION	COUNTY	TOTAL SHEETS	SHEET NO.
881	D9 SAFETY FY08-1	VARIOUS	64	13
CONTRACT NO. 78038				
FED. ROAD DIST. NO. ILLINOIS FED. AID PROJECT				