

STATE OF ILLINOIS  
DEPARTMENT OF TRANSPORTATION

CONTRACT: 78040  
ROUTE: F.A.I. 57  
SECTION: (02-1B-1)P-1  
COUNTY: ALEXANDER, IL; MISSISSIPPI, MO  
SHEET 52 OF 67  
FOR INFORMATION ONLY

GENERAL NOTES

All new structural steel shall conform to AASHTO Classification M-270 Gr. 36, unless otherwise noted.  
The Contractor shall provide support and/or shoring systems for the beam in the area of existing pin and link plate replacement. See Special Provision "Temporary Support System."  
The inorganic zinc rich primer/acrylic/acrylic paint system shall be used for shop and field painting of new structural steel except where otherwise noted. The color of the acrylic finish coat shall be Interstate Green, Munsell No. 7.5G 4/8. See Special Provisions "Cleaning and Painting New Metal Structures". Cost shall be included in the cost of "Pin and Link Plate Replacement".  
Existing Structural steel shall be cleaned and painted as required by the Special Provision "Cleaning and Painting Adjacent Areas of Existing Steel Structures". Cost shall be included in the cost of "Pin and Link Plate Replacement".  
All existing steel surfaces behind link plates shall be cleaned and primed before installation of new link plates. Cost shall be included in the cost of "Pin and Link Plate Replacement".  
Plan dimensions and details relative to existing structure have been taken from existing plans and are subject to nominal construction variations. It shall be the Contractor's responsibility to verify such dimensions and details in the field, except the pin diameters, and make necessary approved adjustments prior to construction or ordering of materials. Such variations shall not be cause for additional compensation for a change in the scope of the work, however, the Contractor will be paid for the quantity actually furnished at the unit price bid for the work.  
The Pins and Link Plates shall conform to the minimum Charpy V-Notch Toughness of 25 ft.-lbs. at 40° F.  
The pins, link plates, bushings, nuts, Set Bolts, Neoprene Pad and silicone sealant are the items included in "Pin and Link Plate Replacement".  
The existing structural steel coating contains lead. The Contractor should take appropriate precautions to deal with the presence of lead on this project.

Notes: For notes A thru G see sheet 2 of 13.  
⊗ Indicates existing Plug Welds (See Note G)

BRIDGE NO. 1  
STRUCTURE NO. 002-0022  
FOR INFORMATION ONLY

TOTAL BILL OF MATERIAL

ITEM	UNIT	QUANTITY
Temporary Support System	Each	122
Pin and Link Plate Replacement	Each	122

PIN AND LINK PLATE REPLACEMENT  
SPANS 4 AND 7  
F.A.I. ROUTE 57 SEC. 02-1B-1  
ALEXANDER COUNTY  
STA. 1168+50  
STR. No. 002-0022

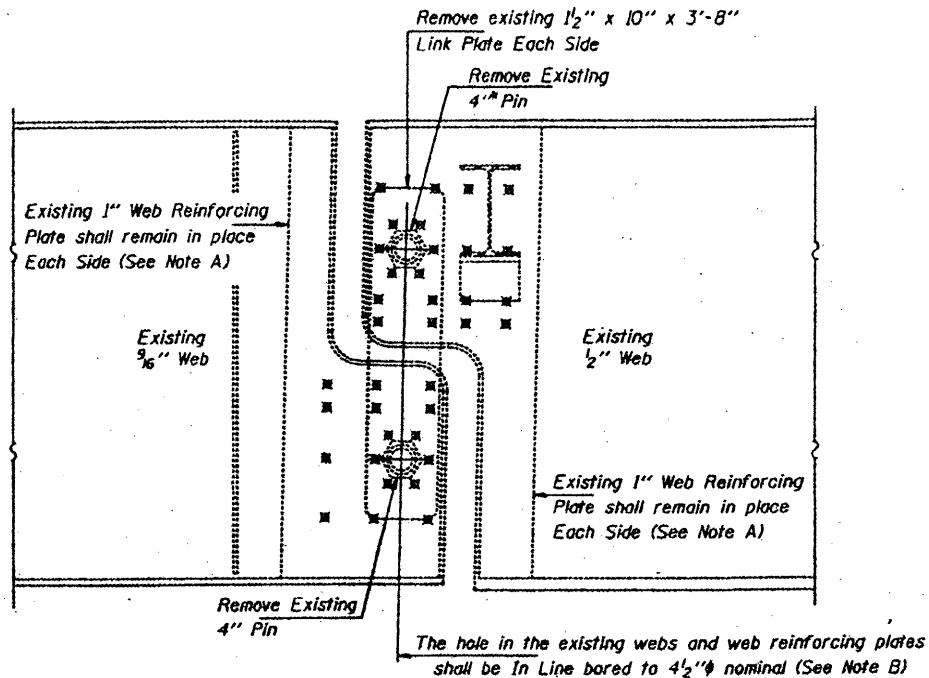

ELEVATION AT EXISTING PIN ASSEMBLY SPAN 4

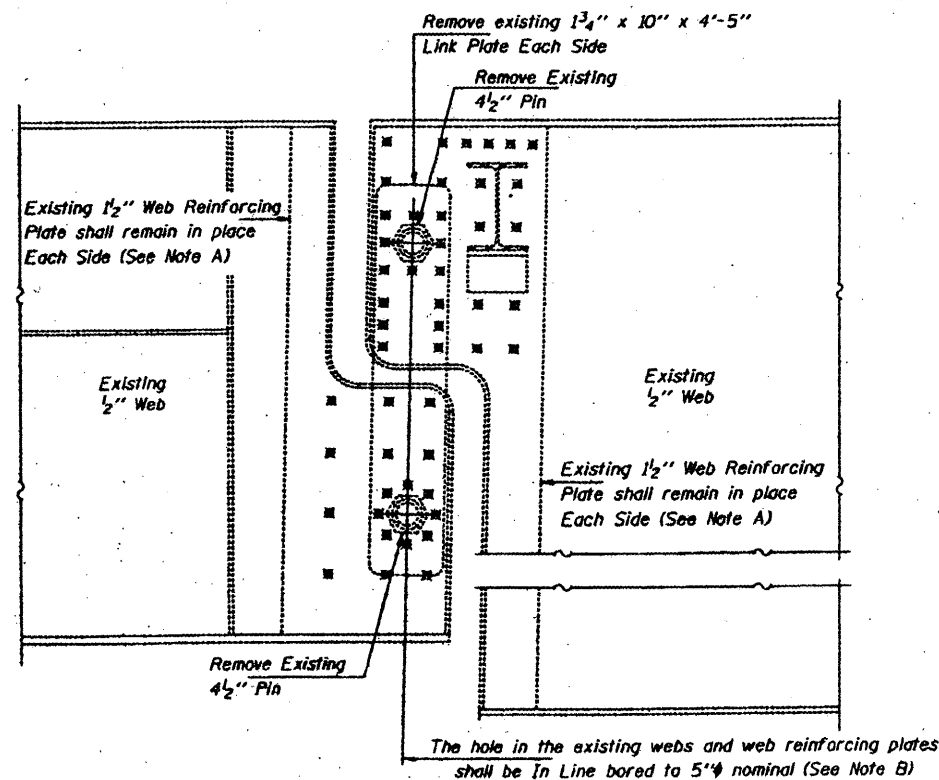

ELEVATION AT EXISTING PIN ASSEMBLY SPAN 7 GIRDERS 2 THRU 6

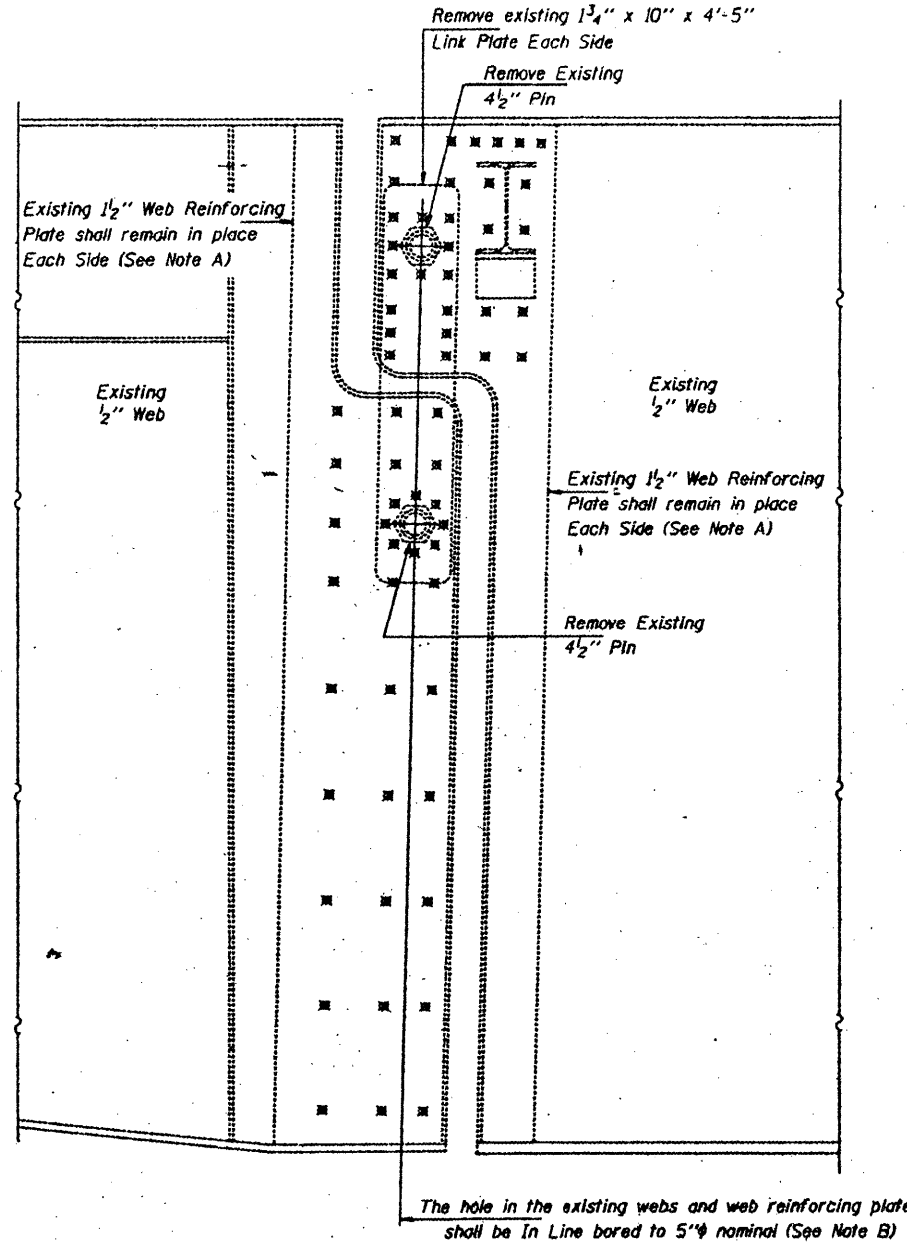

ELEVATION AT EXISTING PIN ASSEMBLY SPAN 7 GIRDERS 1 AND 7

Any Pins that can be easily removed without damage to the pin shall be salvaged and the Bridge Engineer shall be contacted for disposition. Cost of salvage is included in "Pin and Link Plate Replacement".

MAXIMUM REACTIONS  
AT PIN SPAN 4

RR	(K)	60.5
Rt	(K)	60.8
Imp.	(K)	13.0
R (Total)	(K)	134.3

MAXIMUM REACTIONS  
AT PIN SPAN 7

RR	(K)	101.5
Rt	(K)	61.7
Imp.	(K)	13.3
R (Total)	(K)	176.5

DESIGNED VICTOR H. VELTZ  
CHECKED Paul M. Every  
DRAWN Paul Sumner  
CHECKED VHV CMPE

FEBRUARY 19, 1998

EXAMINED Joseph E. Ahrens  
PASSED

ENGINEER OF STRUCTURAL SERVICES  
ENGINEER OF BRIDGES AND STRUCTURES