

PROPOSED ROADWAY DESIGN CRITERIA

75TH ST. ROADWAY LUMINAIRE PERFORMANCE COMPARISON									
IES ROADWAY CLASSIFICATION: COLLECTOR	ROADWAY AREA						SIDEWALK AREA		
	ILLUMINANCE (fc)		LUMINANCE				ILLUMINANCE (fc)		
IES AREA CLASSIFICATION: MEDIUM	E _{AVG}	E _{AVG} / E _{MIN}	L _{AVG}	L _{AVG} / L _{MIN}	L _{MAX} / L _{MIN}	L _Y / L _{AVG}	E _{AVG}	E _{AVG} / E _{MIN}	
IES RECOMMENDED LEVELS	0.9	4.0	0.6	3.5	6.0	0.4	0.5	4.0	
MANUFACTURER A: GENERAL ELECTRIC	1.2	2.4	0.8	1.7	2.4	0.17	0.7	2.3	
MANUFACTURER B: HUBBELL LIGHTING	1.1	2.0	0.8	2.0	4.0	0.21	0.7	2.1	

F.A.U. RTE.	SECTION	COUNTY	TOTAL SHEETS	SHEET NO.
369	00-00018-00-PV	COOK	20	11
STA.	TO STA.			
FED. ROAD DIST. NO. 1 ILLINOIS FED. AID PROJECT				

CONTRACT NO. 83897

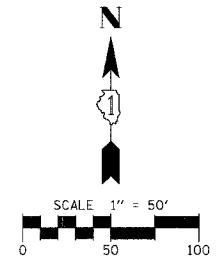

REFER TO PHASE I PLANS FOR CONTINUATION

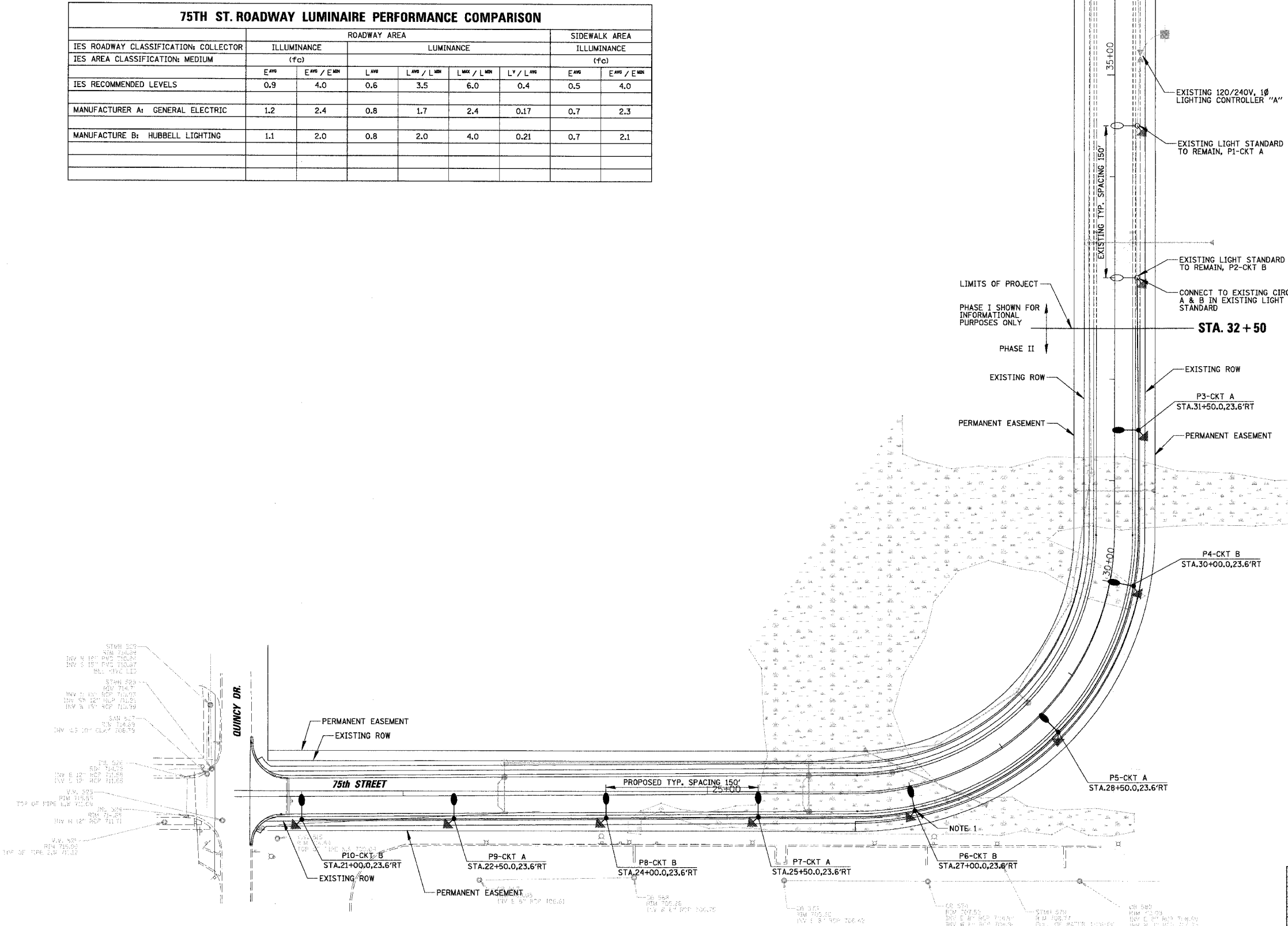

- LEGEND**
- PROPOSED LIGHT POLE WITH 250W HIGH PRESSURE SODIUM LUMINAIRE MOUNTED AT 40' (SEE LIGHT STANDARD DETAIL FOR MODEL INFORMATION)
 - EXISTING LIGHTPOLE TO REMAIN (REFER TO PLANS FOR LOCATIONS)
 - PROPOSED 4-1/2" #8 & 1/2" #8 GROUND TYPE XLP-USE CABLES IN 1/4" UNIT DUCT, IN TRENCH
 - POLE NUMBER
 - CIRCUIT IDENTIFIER
 - OFFSET
 - STATION
 - EXISTING SANITARY SEWER
 - EXISTING STORM SEWER
 - EXISTING WATERMAIN
 - EXISTING OVERHEAD WIRES
 - EXISTING GASLINE
 - EXISTING CABLES IN UNIT DUCT
 - EXISTING LIGHTING CONTROLLER
 - EXISTING COM ED SERVICE LOCATION

NOTES:
 1. LIGHT POLE P6 SHALL HAVE A 20'-0" CONCRETE FOUNDATION DEPTH (REFER TO "CONCRETE FOUNDATION DETAIL" ON SHEET 13).

REVISIONS	
NAME	DATE

ILLINOIS DEPARTMENT OF TRANSPORTATION
75th STREET ROADWAY LIGHTING PLAN

SCALE: VERT. _____
 HORIZ. _____
 DATE 2/19/2008
 DRAWN BY KB
 CHECKED BY JPC