

F.A. RTE.	SECTION	COUNTY	TOTAL SHEETS	SHEET NO.
05-00174-00-BT	ROCK ISLAND	112	18	
STA. TO STA.				
FED. ROAD DIST. NO.		ILLINOIS FED. AID PROJECT		

HORIZONTAL AND VERTICAL CONTROL

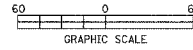

Beginning chain TRAIL description
 Point 160 N 1,760,727.76 E 2,190,960.49 Sta 200+00.00
 Course from 160 to 161 N 64° 00' 54.93" W Dist 38.73
 Point 161 N 1,760,744.73 E 2,190,925.68 Sta 200+38.73

chain TRAIL description (CONTINUED)
 Point 166 N 1,760,874.58 E 2,190,735.65 Sta 202+85.33
 Course from 166 to 167 N 60° 19' 01.02" W Dist 37.45
 Point 167 N 1,760,893.13 E 2,190,703.11 Sta 203+22.78

Curve Data

Curve CURTR1
 P.I. Station 200+55.43 N 1,760,752.04 E 2,190,910.67
 Delta = 21° 43' 48.91" (RT)
 Degree = 65° 51' 25.98"
 Tangent = 16.70
 Length = 33.00
 Radius = 87.00
 External = 1.59
 Long Chord = 32.80
 Mid. Ord. = 1.56
 P.C. Station 200+38.73 N 1,760,744.73 E 2,190,925.68
 P.T. Station 200+71.72 N 1,760,764.40 E 2,190,899.44
 C.C. N 1,760,822.93 E 2,190,963.80
 Back = N 64° 00' 55.89" W
 Ahead = N 42° 17' 06.98" W
 Chord Bear = N 53° 09' 01.43" W

Curve Data

Curve CURTR4
 P.I. Station 203+38.97 N 1,760,901.24 E 2,190,689.10
 Delta = 33° 22' 14.53" (LT)
 Degree = 106° 03' 50.44"
 Tangent = 16.19
 Length = 31.46
 Radius = 54.02
 External = 2.37
 Long Chord = 31.02
 Mid. Ord. = 2.27
 P.C. Station 203+22.78 N 1,760,893.13 E 2,190,703.11
 P.T. Station 203+54.24 N 1,760,900.30 E 2,190,672.93
 C.C. N 1,760,846.37 E 2,190,676.05
 Back = N 59° 56' 12.17" W
 Ahead = S 86° 41' 33.29" W
 Chord Bear = N 76° 37' 19.44" W

NATURE TRAIL

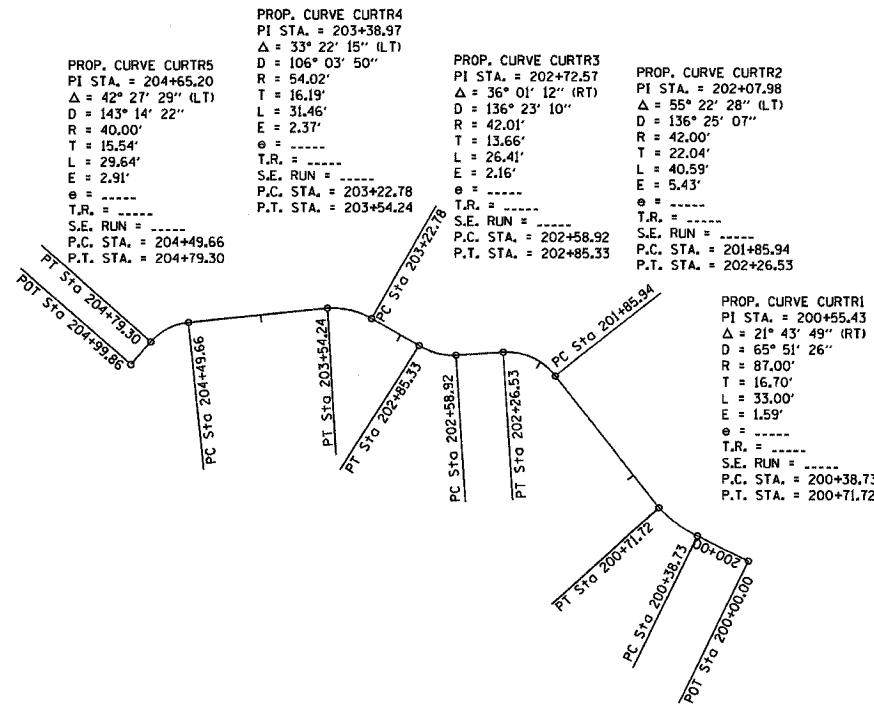

Point 162 N 1,760,764.40 E 2,190,899.44 Sta 200+71.72
 Course from 162 to 163 N 38° 14' 45.91" W Dist 114.21
 Point 163 N 1,760,854.09 E 2,190,828.73 Sta 201+85.94

Curve Data

Curve CURTR2
 P.I. Station 202+07.98 N 1,760,871.40 E 2,190,815.09
 Delta = 55° 22' 27.53" (LT)
 Degree = 136° 25' 06.68"
 Tangent = 22.04
 Length = 40.59
 Radius = 42.00
 External = 5.43
 Long Chord = 39.03
 Mid. Ord. = 4.81
 P.C. Station 201+85.94 N 1,760,854.09 E 2,190,828.73
 P.T. Station 202+26.53 N 1,760,870.01 E 2,190,793.10
 C.C. N 1,760,828.09 E 2,190,795.75
 Back = N 38° 14' 45.91" W
 Ahead = S 86° 22' 46.56" W
 Chord Bear = N 65° 55' 59.67" W

Curve Data

Curve CURTR5
 P.I. Station 204+65.20 N 1,760,888.84 E 2,190,562.57
 Delta = 42° 27' 29.27" (LT)
 Degree = 143° 14' 22.02"
 Tangent = 15.54
 Length = 29.64
 Radius = 40.00
 External = 2.91
 Long Chord = 28.97
 Mid. Ord. = 2.71
 P.C. Station 204+49.66 N 1,760,890.45 E 2,190,578.03
 P.T. Station 204+79.30 N 1,760,877.23 E 2,190,552.26
 C.C. N 1,760,850.66 E 2,190,582.16
 Back = S 84° 04' 19.47" W
 Ahead = S 41° 36' 50.20" W
 Chord Bear = S 62° 50' 34.84" W

Point 164 N 1,760,870.01 E 2,190,793.10 Sta 202+26.53
 Course from 164 to 165 S 86° 22' 46.56" W Dist 32.39
 Point 165 N 1,760,867.97 E 2,190,760.77 Sta 202+58.92

Curve Data

Curve CURTR3
 P.I. Station 202+72.57 N 1,760,867.19 E 2,190,747.14
 Delta = 36° 01' 11.68" (RT)
 Degree = 136° 23' 09.78"
 Tangent = 13.66
 Length = 26.41
 Radius = 42.01
 External = 2.16
 Long Chord = 25.98
 Mid. Ord. = 2.06
 P.C. Station 202+58.92 N 1,760,867.97 E 2,190,760.77
 P.T. Station 202+85.33 N 1,760,874.58 E 2,190,735.65
 C.C. N 1,760,909.91 E 2,190,758.38
 Back = S 86° 44' 12.93" W
 Ahead = N 57° 14' 35.39" W
 Chord Bear = N 75° 15' 11.23" W

Point 170 N 1,760,877.23 E 2,190,552.26 Sta 204+79.30
 Course from 170 to 171 S 41° 07' 58.04" W Dist 20.56
 Point 171 N 1,760,861.74 E 2,190,538.73 Sta 204+99.86

Ending chain TRAIL description

DATE: 11/11/11
 FILE: HVC
 SCALE: 1"=100'
 USER: MUSE

REVISIONS		ILLINOIS DEPARTMENT OF TRANSPORTATION
NAME	DATE	
		HORIZONTAL AND VERTICAL CONTROL

SCALE: VERT. 1"=100'
 HORIZ. 1"=100'
 DATE: 11/11/11
 DRAWN BY: MUSE
 CHECKED BY: MUSE