

F.A. RTE.	SECT-ION	COUNTY	TOTAL SHEETS	SHEET NO.
05-00174-00-BT	ROCK ISLAND	ILLINOIS	112	49
STA. TO STA.		FED. ROAD DIST. NO. ILLINOIS FED. AID PROJECT		

# LIGHTING PLANS

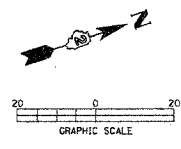

- LEGEND**
- (S2) 150W HPS CITY OWNED
  - (B7) 70W LANDSCAPE BOLLARDS
  - (T) "BLUE PHONE" LOCATION
  - SERVICE INSTALLATION
  - ▣ LIGHTING CONTROLLER
  - (P1) 100W METAL HALIDE PATH LIGHTS

NOTE:  
INSTALL 3/4" G.S. CONDUIT FROM BOTTOM OF BREAKER PANEL TO BELOW GRADE CONNECTION TO 3/4" PVC CONDUIT. INCIDENTAL TO ELECTRIC SERVICE INSTALLATION, SPECIAL.

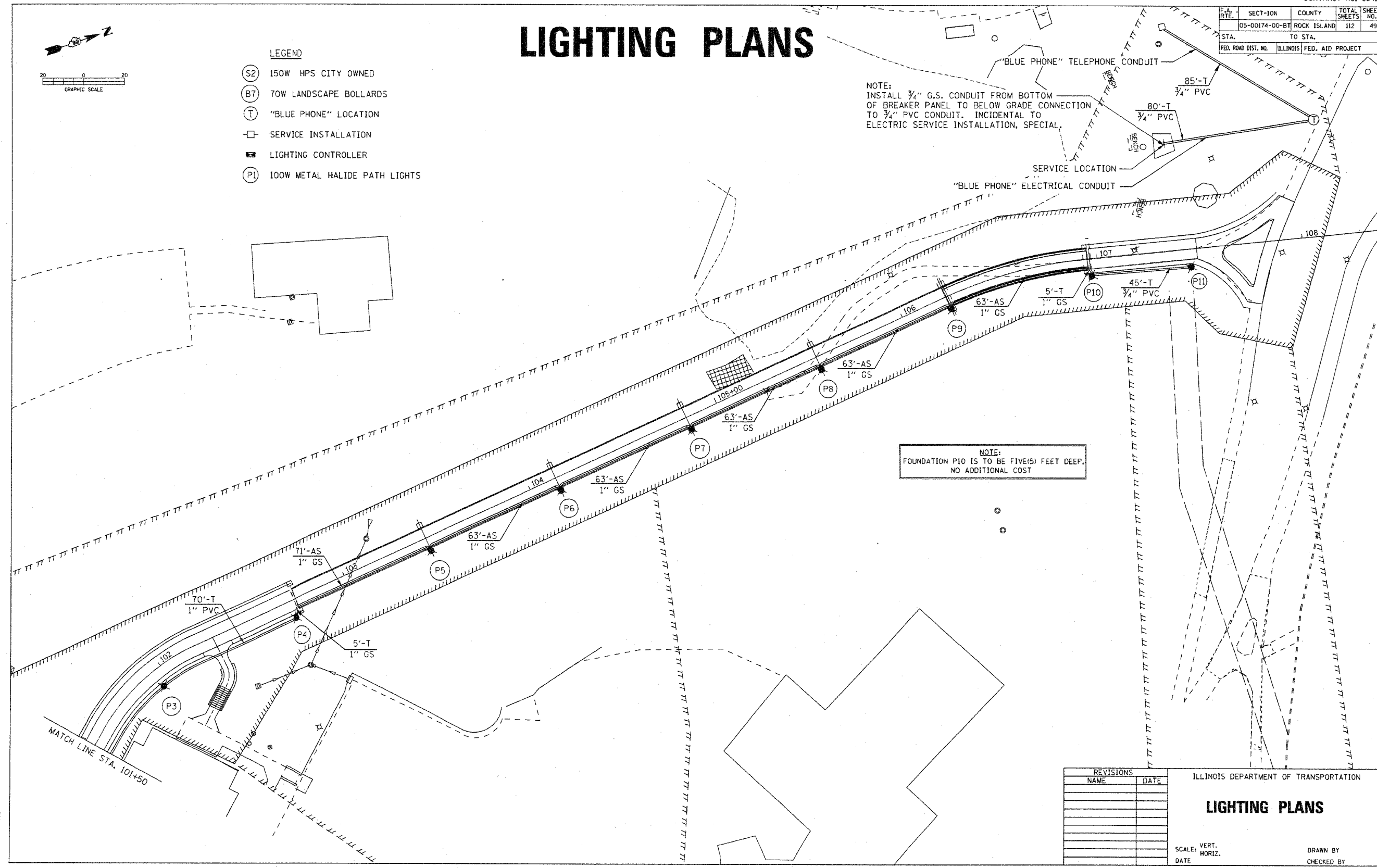

NOTE:  
FOUNDATION P10 IS TO BE FIVE(5) FEET DEEP.  
NO ADDITIONAL COST

PLANT DATE \* DATE  
FILE NAME \* FILE  
DRAWN BY \* NAME  
CHECKED BY \* NAME

REVISIONS	
NAME	DATE

ILLINOIS DEPARTMENT OF TRANSPORTATION

## LIGHTING PLANS

SCALE: VERT.     DRAWN BY  
HORIZ.             CHECKED BY  
DATE