

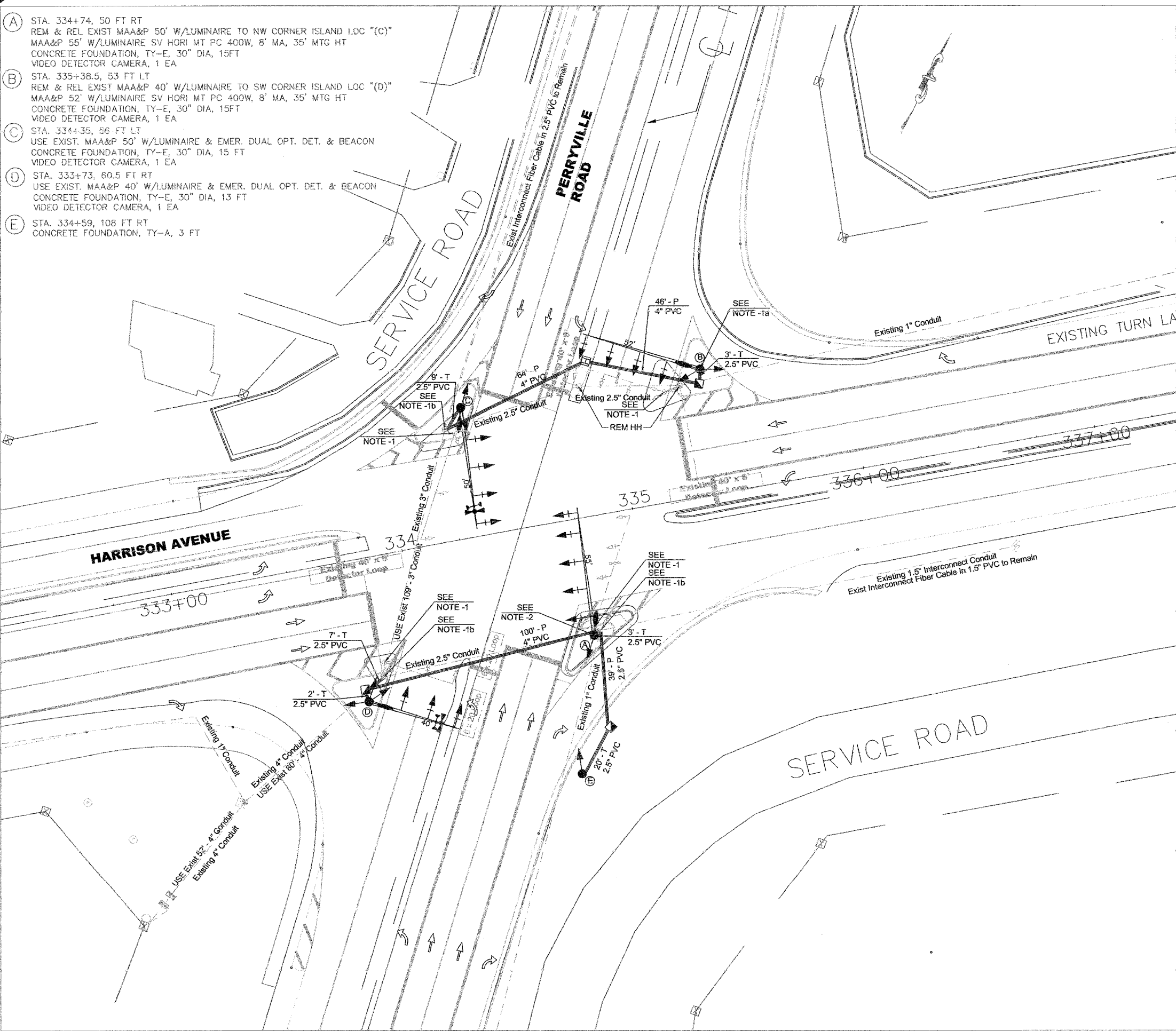

- (A) STA. 334+74, 50 FT RT
REM & REL EXIST MAA&P 50' W/LUMINAIRE TO NW CORNER ISLAND LOC "(C)"
MAA&P 55' W/LUMINAIRE SV HORI MT PC 400W, 8' MA, 35' MTG HT
CONCRETE FOUNDATION, TY-E, 30" DIA, 15FT
VIDEO DETECTOR CAMERA, 1 EA
- (B) STA. 335+38.5, 53 FT LT
REM & REL EXIST MAA&P 40' W/LUMINAIRE TO SW CORNER ISLAND LOC "(D)"
MAA&P 52' W/LUMINAIRE SV HORI MT PC 400W, 8' MA, 35' MTG HT
CONCRETE FOUNDATION, TY-E, 30" DIA, 15FT
VIDEO DETECTOR CAMERA, 1 EA
- (C) STA. 334+35, 56 FT LT
USE EXIST. MAA&P 50' W/LUMINAIRE & EMER. DUAL OPT. DET. & BEACON
CONCRETE FOUNDATION, TY-E, 30" DIA, 15 FT
VIDEO DETECTOR CAMERA, 1 EA
- (D) STA. 333+73, 60.5 FT RT
USE EXIST. MAA&P 40' W/LUMINAIRE & EMER. DUAL OPT. DET. & BEACON
CONCRETE FOUNDATION, TY-E, 30" DIA, 13 FT
VIDEO DETECTOR CAMERA, 1 EA
- (E) STA. 334+59, 108 FT RT
CONCRETE FOUNDATION, TY-A, 3 FT



- NOTES:**
- 1) CONSTRUCT NEW MAA&P 52' AND CONCRETE FOUNDATION TYPE E, 30" DIA., 15' DEEP IN ACCORDANCE TO SECTION 878 AND SECTION 877, AND STANDARD 878001 AND 877011.
 - 1a) DRILL HOLE IN EXISTING HANDHOLE FOR PROPOSED CONDUIT IN ACCORDANCE TO SECTION 879.
 - 2) CONSTRUCT NEW MAA&P 55' AND CONCRETE FOUNDATION TYPE E, 30" DIA., 15' DEEP IN ACCORDANCE TO SECTION 878 AND SECTION 877, AND STANDARD 878001 AND STANDARD 877011.
 - 3b) USE EXISTING CONTROLLER, CABINET AND FOUNDATION.
 - 4) USE EXISTING EMERGENCY VEHICLE PREEMPTION SYSTEM WITH DUAL OPTICAL DETECTOR AND DUAL CONFIRMATION BEACON.
 - 5) ABANDONED EXISTING DETECTOR LOOP & PULL CABLE FROM CONDUIT AND CAP IT.
 - 8) REMOVING ELECTRICAL CABLE FROM CONDUIT SHALL BE PAID FOR BY THE FOOT. PAY ITEM- REM ELEC CABLE FROM CONDUIT. EACH CABLE FOR EACH SIGNAL HEAD SHALL BE REMOVED FROM THE SIGNAL HEAD TO THE CONTROLLER.

TRAFFIC SIGNAL LEGEND

	EXISTING	PROPOSED
CONTROLLER		
SERVICE INSTALLATION		
SIGNAL HEAD		
SIGNAL HEAD WITH BACKPLATE		
SIGNAL HEAD, PEDESTRIAN		
PEDESTRIAN PUSHBUTTON DETECTOR		
SIGNAL POST		
MAST ARM ASSEMBLY AND POLE		
HANDHOLE		
HEAVY DUTY HANDHOLE		
DOUBLE HANDHOLE		
EMERGENCY VEHICLE SYSTEM DETECTOR		
CONFIRMATION BEACON		
WOOD POLE		
CONDUIT IN TRENCH OR PUSHED		
COMMON TRENCH		
DETECTOR LOOP		
WOOD POLE		
LUMINAIRE		

E:\Users\Projects\Harrison Avenue\3535(ANDY)\Traffic_Signal.dwg, 4-9-2008 9:50:15 AM, 11, WCD, A, J, J, J, J