

STATE OF ILLINOIS  
DEPARTMENT OF TRANSPORTATION  
PLANS FOR  
PROPOSED LOCAL AGENCY IMPROVEMENT  
FEDERAL AID BRRP PROJECT  
HENRY COUNTY

FAS RTE	SECTION	COUNTY	TOTAL SHEETS	SHEET NO.
1226	06-00146-00-BR	HENRY	9	1
ILLINOIS PROJECT				

INDEX OF SHEETS

- Sheet No. 1 Cover Sheet
- Sheet No. 2 Plan & Profile
- Sheet No. 3 Cross Sections
- Sheet No. 4 General Plan & Elevation
- Sheet No. 5 P.P.C. Deck Beam Superstructure
- Sheet No. 6 P.P.C. Deck Beam Superstructure
- Sheet No. 7 Pile Bent Abutment
- Sheet No. 8 Type S-1 Railing
- Sheet No. 9 Boring Details

HENRY COUNTY SECTION 06-00146-00-BR  
PROJECT BRS-1226(101) JOB C-92-061-08  
FAS RTE 1226 CONTRACT 85439

STANDARDS

701006-02, 701301-02, 701901, 720011, 728001, 729001  
BLR 21-7, BLR 22-5  
280001-04  
BLR 23-2, BLR 26, BLR 27

CONSTRUCTION TYPE CODE X081-2A  
SCHEDULE OF QUANTITIES

CODE QUANTITY UNIT DESCRIPTION

20200100	600	Cu.Yds.	Earth Excavation
20300100	45	Cu.Yds.	Channel Excavation
25000330	0.54	Acre	Seeding, Class 6
25000400	49	Pound	Nitrogen Fertilizer Nutrient
25000500	49	Pound	Phosphorous Fertilizer Nutrient
25000600	49	Pound	Potassium Fertilizer Nutrient
25100120	1.10	Ton	Mulch, Method 2
28000300	4	Each	Temporary Ditch Checks
28100707	293	Sq.Yds.	Stone Dumped Riprap, Class A4
35101400	710	Ton	Aggregate Base Course, Type B
50100100	1	Each	Removal of Existing Structures
50200100	116	Cu.Yds.	Structure Excavation
50300225	25.9	Cu.Yds.	Concrete Structures
50400605	2279	Sq.Ft.	P P Conc Dk Bm 33 Dp
50800105	3190	Pound	Reinforcement Bars
50900205	152	Foot	Steel Railing, Type S1
51201400	558	Foot	Fur. Stl. Pile HP 10X42
51202305	558	Foot	Driving Piles
51203400	2	Each	Test Pile Stl HP 10X42
51204650	12	Each	Pile Shoes
51500100	1	Each	Name Plate
54200223	174	Foot	P Cul CL D 1 18"
54200229	64	Foot	P Cul CL D 1 24"
58100200	254	Sq.Yds.	WaterPrf Membrane System
58300100	746	Foot	PC Mortar Fairing CSE
* 63100075	1	Each	Traffic Barrier Terminal Type 5A
67100100	1	L. Sum	Mobilization
* LR631020	1	Each	Traffic Barrier Terminal Type 1
50300280	3.8	Cu.Yds.	Concrete Encasement

\* Specialty Items

Major Collector (Less Than 400)

CALL J.U.L.I.E.  
BEFORE YOU DIG  
800-892-0123

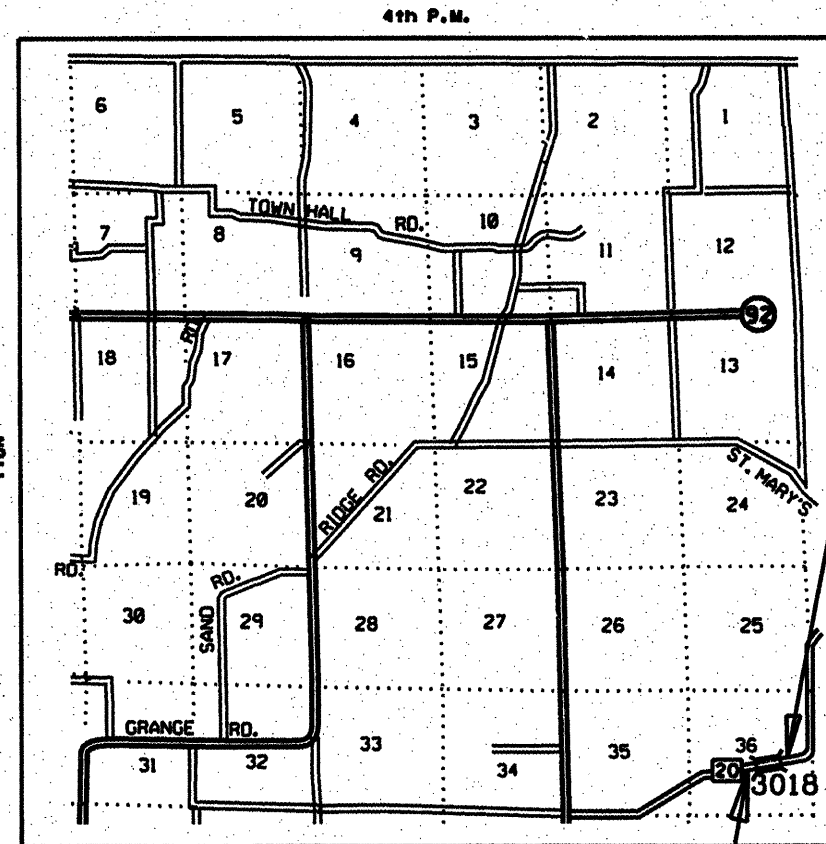

LOCATION MAP

NET LENGTH OF SECTION = 450 FEET = 0.085 MILES

Section 06-00146-00-BR Ends at Station 106+00.

Section includes a single span bridge (75') with precast prestressed concrete deck beams (33" deep) on pile bent concrete abutments, skewed 15° right ahead. Also included are aggregate surface approach roadways.

SECTION 06-00146-00-BR Begins at Station 101+50.

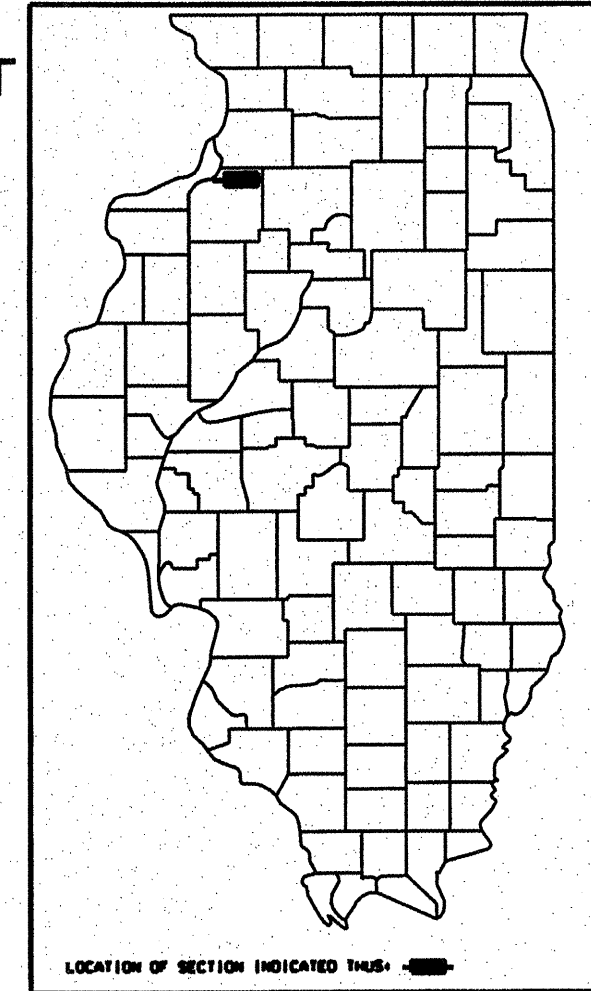

LOCATION OF SECTION INDICATED THUS: [Symbol]

THESE PLANS WERE PREPARED BY ME OR BY THE FULL TIME MEMBERS OF MY STAFF.

*Steven L. Brandau*  
STEVEN L. BRANDAU  
P.E. 42625

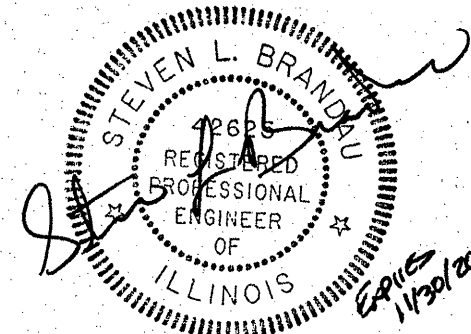

STATE OF ILLINOIS  
DEPARTMENT OF TRANSPORTATION  
DIVISION OF HIGHWAYS

APPROVED 4/9/2008 *Steven L. Brandau*  
HENRY COUNTY ENGINEER

PASSED APR 17 2008  
DISTRICT #2 ENGINEER OF LOCAL ROADS & STREETS

RELEASING FOR BID APR 17 2008  
BASED ON LIMITED REVIEW  
DEPUTY-DIRECTOR OF HIGHWAYS REGION #2 ENGINEER