

EXIST. CURVE C01
 P.I.S.T.A. = 41+32.52
 I = 58° 43' 24" (LT)
 D = 7° 30' 00"
 R = 763.94'
 T = 429.78'
 L = 782.97'
 E = 112.60'
 e = -----
 T.R. = -----
 S.E. RUN = -----
 P.C. STA. = 37+02.74
 P.T. STA. = 44+85.71

LEGEND

- ENTRANCE LOCATION (SEE TABLE)
- ⊠ GUARDRAIL LOC. (SEE TABLE)
- ⊐ MAIL BOX TURNOUT (TYP.)

GUARDRAIL TABLE

RUN #	STATION -	STATION	LENGTH (FT)
1	18+40	21+82 RT	237.5
2	19+47	22+21 LT	150
3	22+09	22+94 RT	137.5
4	23+06	24+66 RT	150
5	65+06	68+88 RT	325
6	66+07	69+48 LT	300

EXIST. CURVE C03
 P.I.S.T.A. = 57+24.44
 I = 32° 03' 4" (LT)
 D = 6° 00' 00"
 R = 954.93'
 T = 274.38'
 L = 534.36'
 E = 38.64'
 e = -----
 T.R. = -----
 S.E. RUN = -----
 P.C. STA. = 54+50.06
 P.T. STA. = 59+84.42

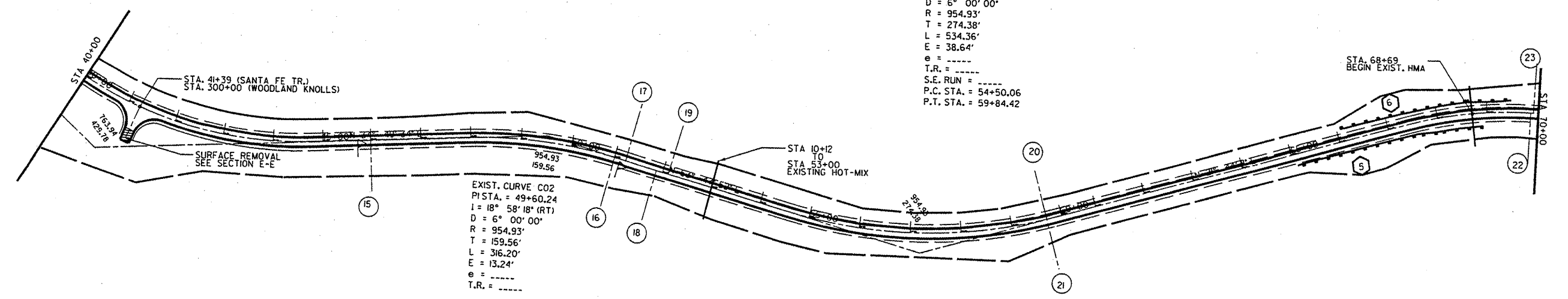

EXIST. CURVE C02
 P.I.S.T.A. = 49+60.24
 I = 18° 58' 18" (RT)
 D = 6° 00' 00"
 R = 954.93'
 T = 159.56'
 L = 316.20'
 E = 13.24'
 e = -----
 T.R. = -----

ENTRANCE #	TYPE	STATION	WIDTH (FT)	SURFACE
1	FIELD ENTRANCE	12+08 LT	19	AGG
2	COMMERCIAL ENTRANCE	12+26 RT	30	ASPH
3	PRIVATE ENTRANCE	16+66 RT	28	AGG
4	FIELD ENTRANCE	17+00 LT	21	AGG
5	PRIVATE ENTRANCE	17+32 LT	10	AGG
6	PRIVATE ENTRANCE	18+25 RT	16	AGG
7	PRIVATE ENTRANCE	19+19 LT	13	AGG
8	PRIVATE ENTRANCE	22+00 RT	14	AGG
9	FIELD ENTRANCE	22+30 LT	17	AGG
10	PRIVATE ENTRANCE	22+97 LT	15	AGG

ENTRANCE #	TYPE	STATION	WIDTH (FT)	SURFACE
11	PRIVATE ENTRANCE	23+00 RT	9	AGG
12	FIELD ENTRANCE	29+63 LT	25	AGG
13	FIELD ENTRANCE	37+20 RT	16	AGG
14	FIELD ENTRANCE	37+80 LT	20	AGG
15	PRIVATE ENTRANCE	46+00 RT	14	ASPH
16	PRIVATE ENTRANCE	51+00 RT	40	ASPH
17	FIELD ENTRANCE	51+23 LT	23	AGG
18	FIELD ENTRANCE	51+86 RT	33	AGG
19	COMMERCIAL ENTRANCE	52+11 LT	30	AGG
20	FIELD ENTRANCE	59+70 LT	21	AGG

ENTRANCE #	TYPE	STATION	WIDTH (FT)	SURFACE
21	FIELD ENTRANCE	59+70 RT	22	AGG
22	FIELD ENTRANCE	69+85 RT	13	AGG
23	FIELD ENTRANCE	69+90 LT	21	AGG

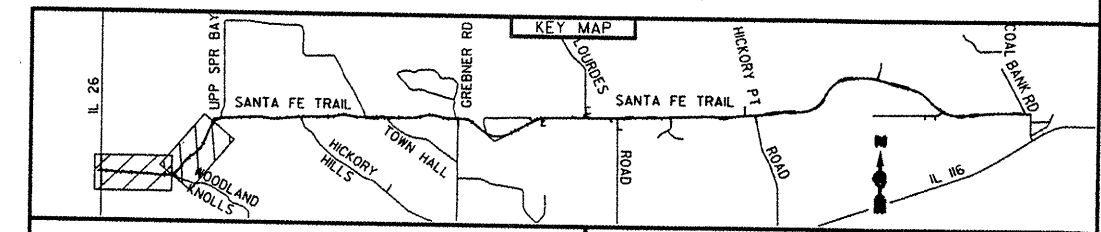

WOODFORD COUNTY HIGHWAY DEPARTMENT
 DENNIS BACHMAN, P.E., COUNTY ENGINEER
 301 S. Main St.
 Roanoke, IL 61561-0467
 TEL: 309-923-2891
 FAX: 309-923-7928

F.A.S. RTE. 2360
 SECTION 04-00058-08-FP
 SANTA FE TRAIL (C.H.#25)
PLAN SHEET
 SCALE: 1"=100'
 DATE: 1/31/08
 DRAWN BY: BJH
 CHECKED BY: DDB