

ROUTE NO.	SECTION	COUNTY	TOTAL SHEETS	SHEET NO.
	*	DOUGLAS	279	63
FED. ROAD DIST. NO.		ILLINOIS	PROJECT	
*99-00080-00-RP				

**NORTH CURB LINE**

Location	Station	Offset	Theoretical Grade Elevations
Back Abut No. 2	162+74.00	-19.50	650.55
A	162+84.00	-19.50	650.55
B	162+94.00	-19.50	650.55
End of East appr pavement	163+04.00	-19.50	650.54

**NORTH EDGE OF PAVEMENT**

Location	Station	Offset	Theoretical Grade Elevations
Back Abut No. 2	162+74.00	-11.00	650.73
A	162+84.00	-11.00	650.73
B	162+94.00	-11.00	650.73
End of East appr pavement	163+04.00	-11.00	650.72

**CH 11 ROADWAY AND CH 11**

Location	Station	Offset	Theoretical Grade Elevations
Back Abut No. 2	162+74.00	0.00	650.90
A	162+84.00	0.00	650.90
B	162+94.00	0.00	650.90
End of East appr pavement	163+04.00	0.00	650.89

**SOUTH EDGE OF PAVEMENT**

Location	Station	Offset	Theoretical Grade Elevations
Back Abut No. 2	162+74.00	11.00	650.73
A	162+84.00	11.00	650.73
B	162+94.00	11.00	650.73
End of East appr pavement	163+04.00	11.00	650.72

**SOUTH CURB LINE**

Location	Station	Offset	Theoretical Grade Elevations
Back Abut No. 2	162+74.00	19.50	650.55
A	162+84.00	19.50	650.55
B	162+94.00	19.50	650.55
End of East appr pavement	163+04.00	19.50	650.54

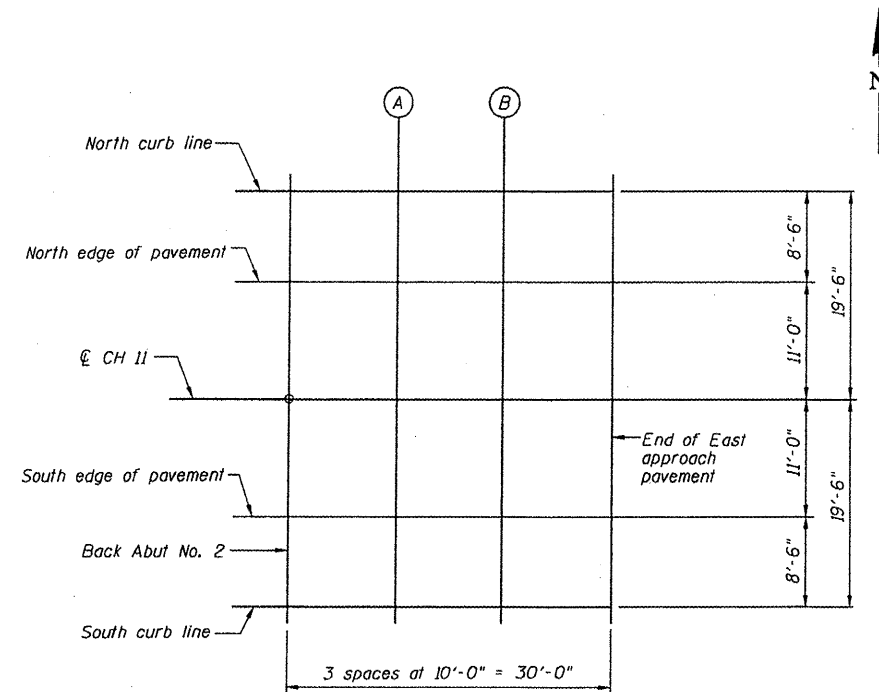

**PLAN**

CH 11 (FA 666) OVER BIG SLOUGH

**TOP OF EAST APPROACH SLAB ELEVATIONS**

REVISIONS	SECTION 99-00080-00-RP	CH 11 (FAS 666)	DRAWN BY DATE R KING 01/08
1	DOUGLAS	SN 021-4548	CHECKED BY DATE JMB 01/08
2		COUNTY	BOOK NUMBER
3			
4			
5			
6			
7			
8			
9			
10			

**HOMER L. CHASTAIN & ASSOCIATES, LLP**  
CONSULTING ENGINEERS  
DECATUR CHICAGO  
(317) 422-8844 (773) 714-0060  
ROCKFORD  
(815) 499-0060  
184-96197

PROJECT NO.  
**5149**  
SHEET NO.