

ROUTE NO.	SECTION	COUNTY	TOTAL SHEETS	SHEET NO.
FAS 666	99-00080-00-RP	DOUGLAS	279	88
FEDERAL DISTRICT		ILLINOIS	PROJECT	C-95-323-07

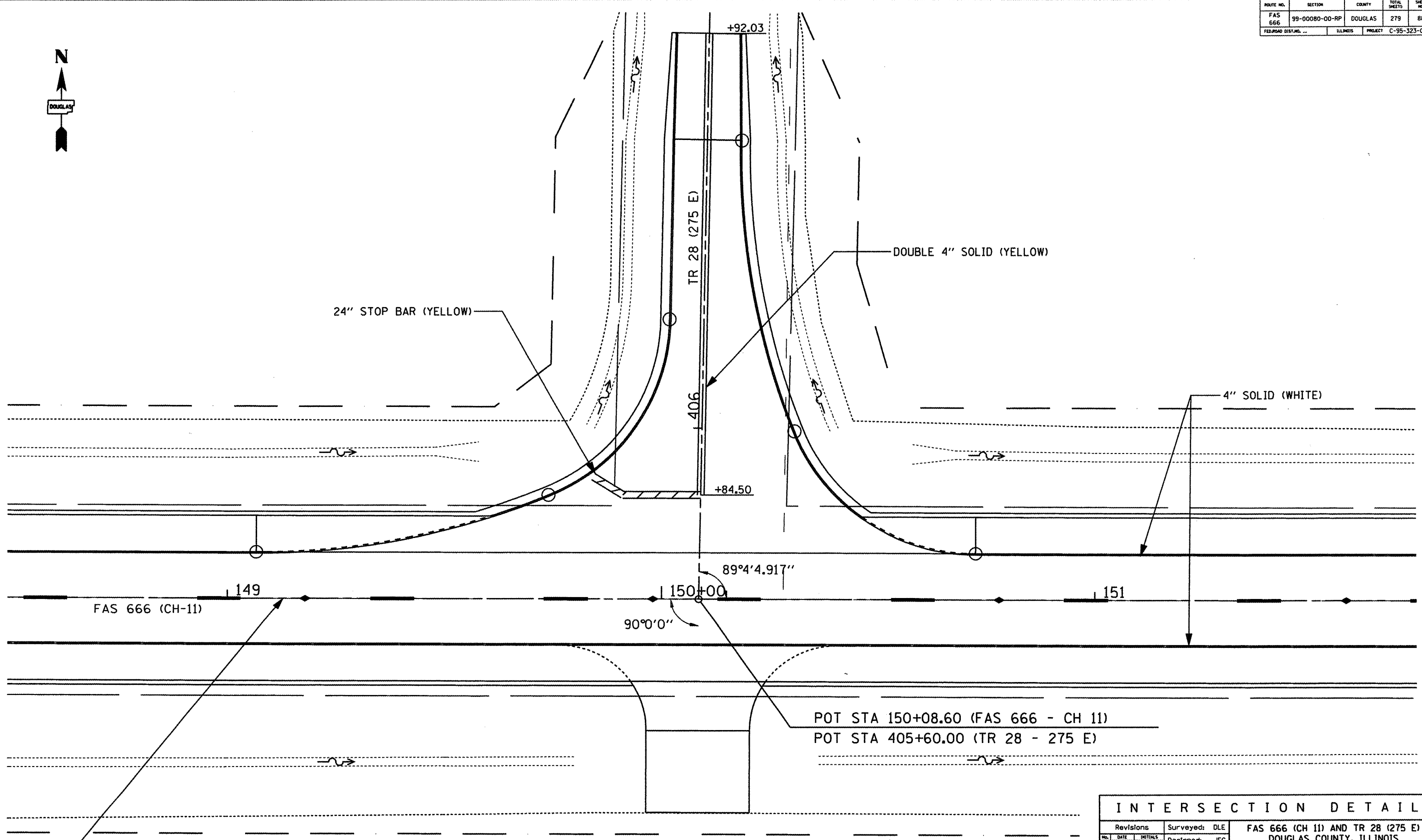

4" YELLOW SKIP DASH (10' DASH - 40' SKIP)  
WITH RAISED REFLECTIVE PAVEMENT MARKERS (STANDARD 781001-02) TYP.

POT STA 150+08.60 (FAS 666 - CH 11)  
POT STA 405+60.00 (TR 28 - 275 E)

INTERSECTION DETAIL			
Revisions	Surveyed:	DLE	FAS 666 (CH 11) AND TR 28 (275 E) DOUGLAS COUNTY, ILLINOIS
No. DATE INITIALS	Designed:	JEC	
1	Drawn:	JEC	
2	Checked:	---	
3	Approved:	JEC	
4			
5			
Job No.:	NA	Date:	2/07