

CO. HWY.	SECTION	COUNTY	TOTAL SHEETS	SHEET NO.
13	05-00130-14-RS	McLEAN	5	4
FED. ROAD DIST. NO. 5		ILLINOIS FED. AID PROJECT		

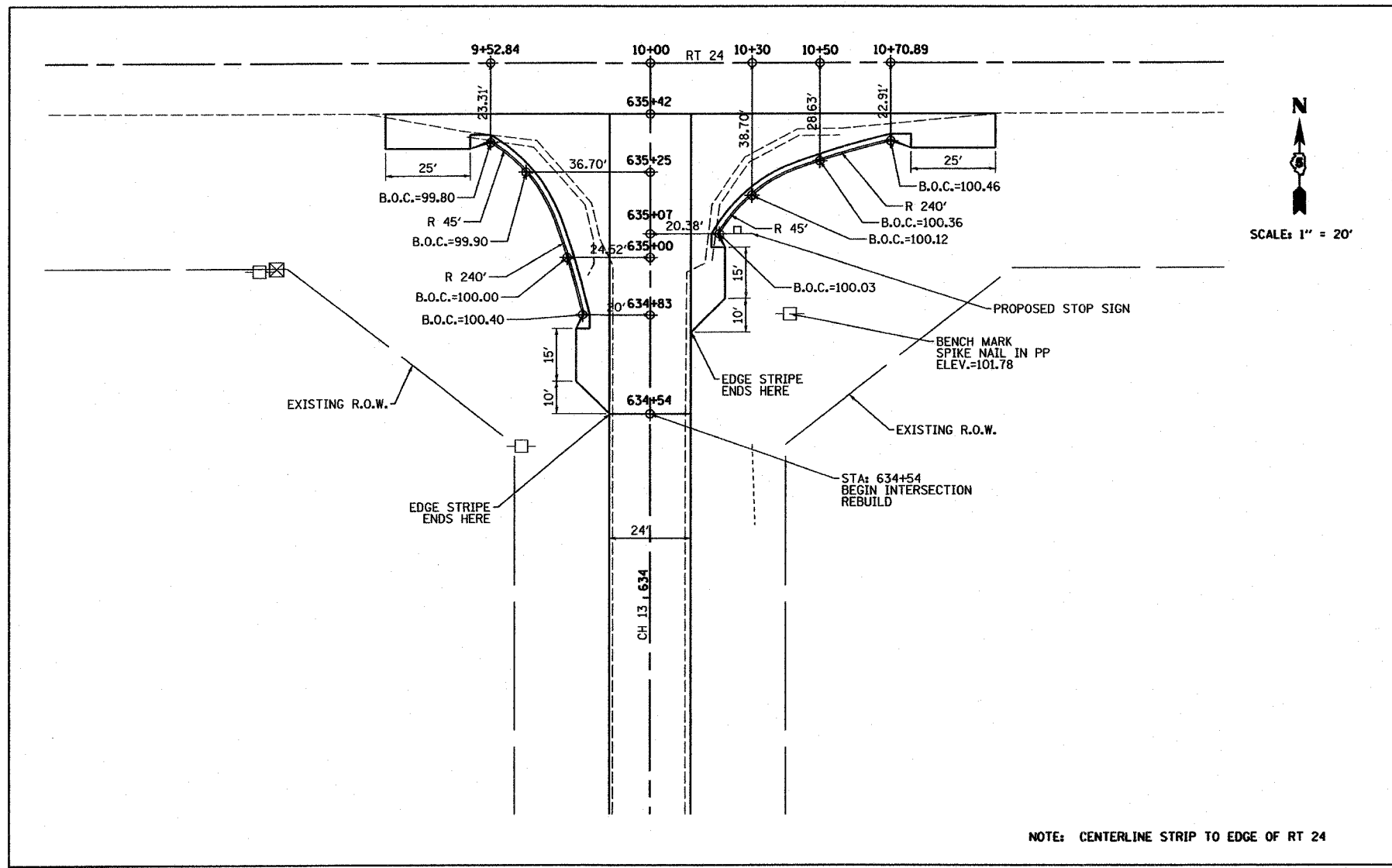

NOTES:

- EARTH EXCAVATION QUANTITY EQUALS 290 CU YD.
- COMBINATION CONCRETE CURB & GUTTER REMOVAL EQUALS 128 FOOT.
- GEOTECHNICAL FABRIC QUANTITY EQUALS 645 SQ YDS.
- AGGREGATE BASE COURSE, TYPE B 8" QUANTITY EQUALS 645 SQ YD.
- HOT-MIX ASPHALT BASE COURSE 6" QUANTITY EQUALS 580 SQ YD.
- LEVELING BINDER, BINDER AND SURFACE COURSES ARE FIGURED IN MAINLINE QUANTITIES.
- COMBINATION CONCRETE CURB AND GUTTER, TYPE M-6.18 QUANTITY EQUALS 130 FOOT.
- BACK FILL BEHIND PROPOSED CURB & GUTTER SHALL BE DONE TO THE SATISFACTION OF THE ENGINEER AND SHALL BE CONSIDERED INCIDENTAL TO THE COST OF COMBINATION CONCRETE CURB AND GUTTER, TYPE M-6.18.
- STATIONING ALONG RT 24 IS ASSUMED AND FOR CONSTRUCTION PURPOSES ONLY.

CH 13 PROPOSED CENTERLINE ELEVATIONS

STATION	ELEV.
635+42	100.12
635+25	100.03
635+00	99.90
634+54	100.42

INTERSECTION RECONSTRUCTION DETAIL
STA: 634+54 TO STA: 635+42

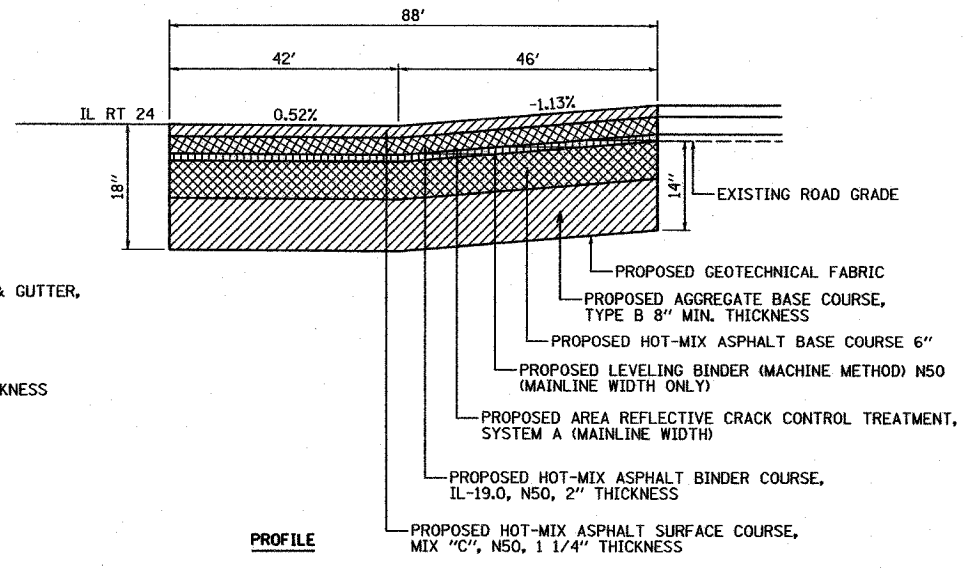
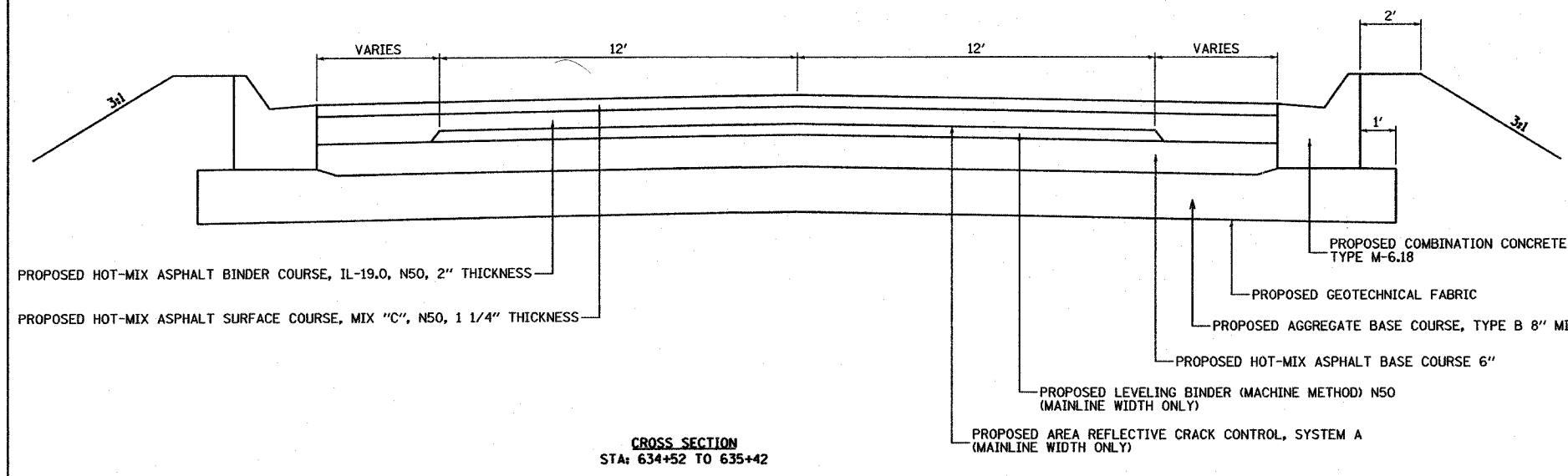

CROSS SECTION
STA: 634+52 TO 635+42

PROFILE