

T.R. RTE.	SECTION	COUNTY	TOTAL SHEETS	SHEET NO.
34	95-05109-00-BR	MENARD	14	8
CONTRACT NO. 9946				
FED. ROAD DIST. NO. ILLINOIS FED. AID PROJECT				

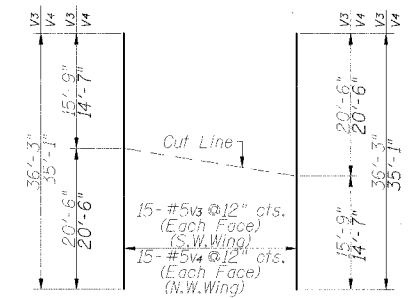
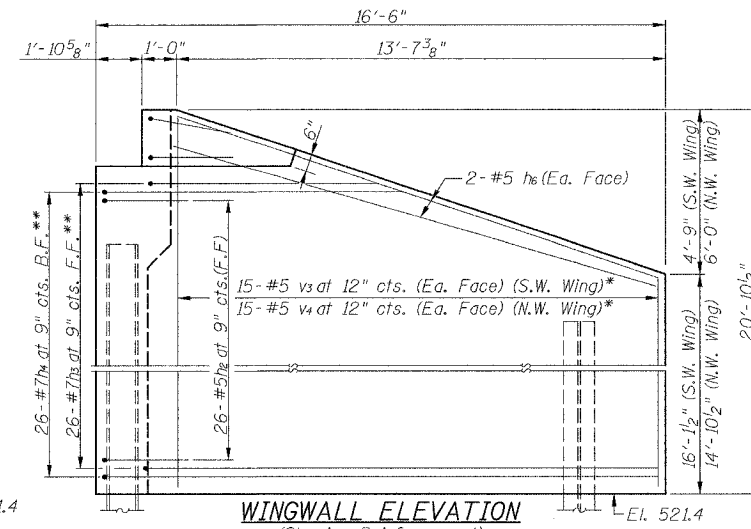
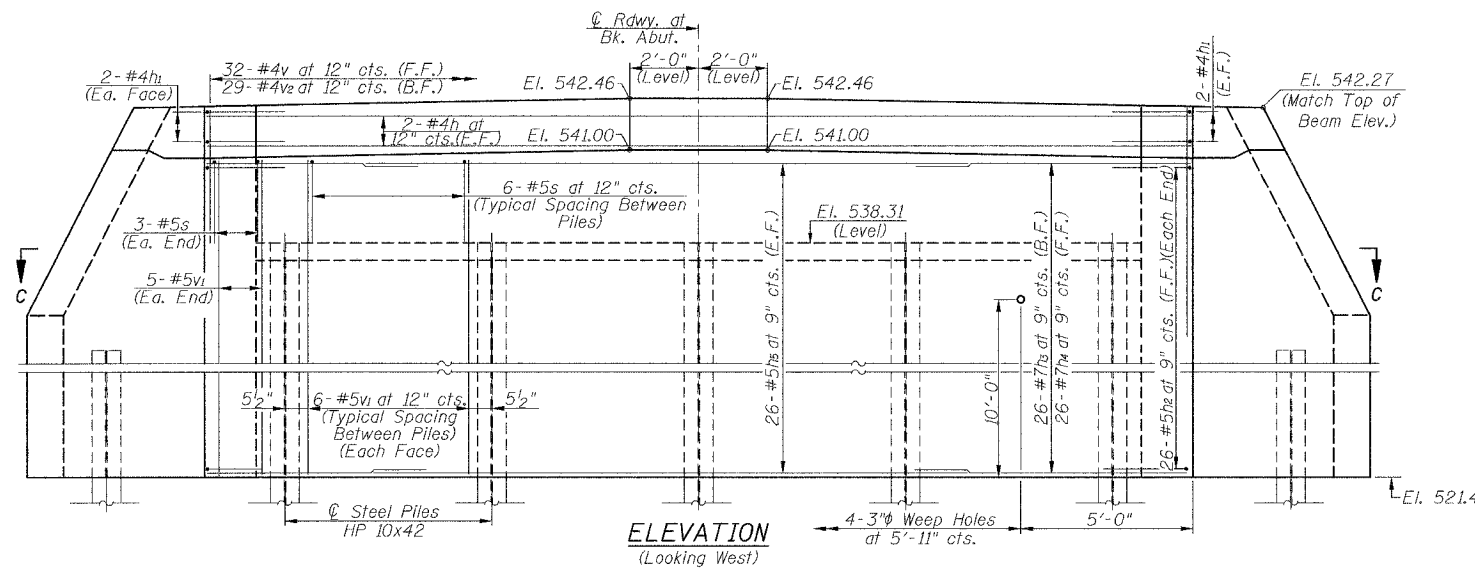

WINGWALL ELEVATION
(Showing Reinforcement)

* See v3 and v4 Bar Cut Diagram
** Field Cut as Required

V3 & V4 - BAR CUT DIAGRAM

Note: Order v3 and v4 bars full length. Lay out in field as shown. Cut along cut line. Use remainder of bar in opposite face of wingwall.

NOTES

All exposed edges shall have standard 3/4\"/>

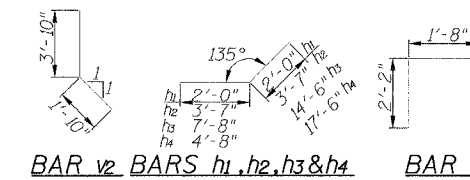
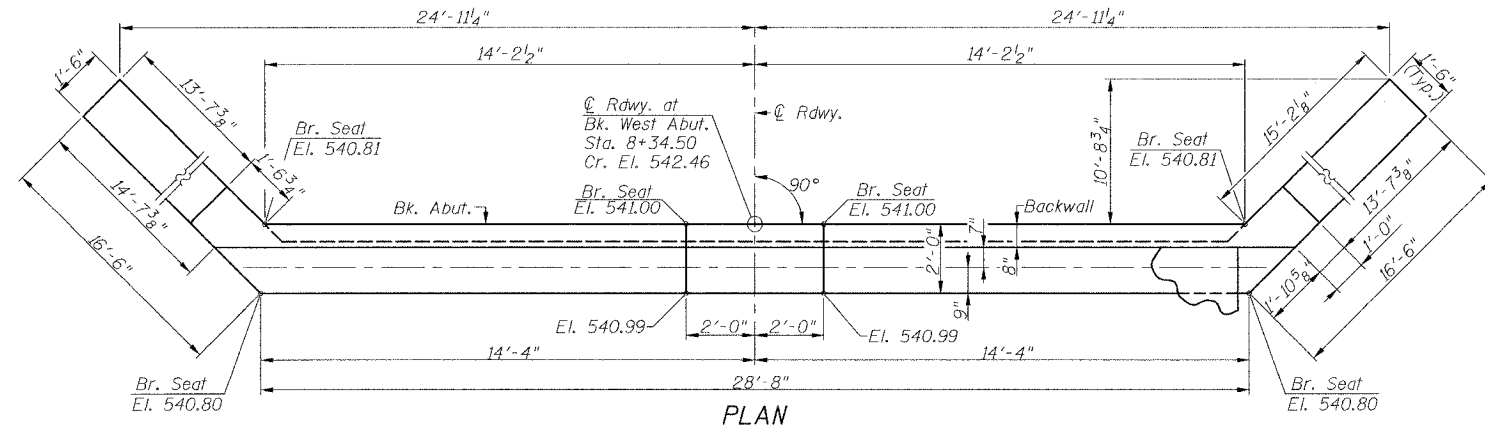

PILE DATA

Type: Steel HP 10x42
Nominal Required Bearing: 300 kips
Allowable Resistance Available: 100 kips
Est. Length: 48'
No. of Production Piles: 6
No. of Test Piles: 1

The test pile shall be driven to 110 percent of the Nominal Required Bearing indicated in the pile data information.

The Steel H-Piles shall be according to AASHTO M270 Grade 50.

BILL OF MATERIAL
WEST ABUTMENT

BAR	NO.	SIZE	LENGTH	SHAPE	
h	4	#4	31'-8"	—	
h1	8	#4	4'-0"	—	
h2	52	#5	7'-2"	—	
h3	52	#7	22'-2"	—	
h4	52	#7	22'-2"	—	
h5	52	#5	20'-6"	—	
h6	8	#5	14'-1"	—	
s	30	#5	6'-0"	—	
v	32	#4	3'-0"	—	
v1	58	#5	19'-1"	—	
v2	29	#4	5'-8"	—	
v3	15	#5	36'-3"	—	
v4	15	#5	35'-1"	—	
Reinforcement Bars				Pound	9070
Concrete Structures				Cu. Yd.	66.4
Furnishing Steel Piles HP 10x42				Foot	288
Driving Steel Piles				Foot	288
Test Pile Steel HP 10x42				Each	1
Underwater Structure Excavation				Each	1
Protection - Location 1				Each	1
Structure Excavation				Cu. Yd.	194

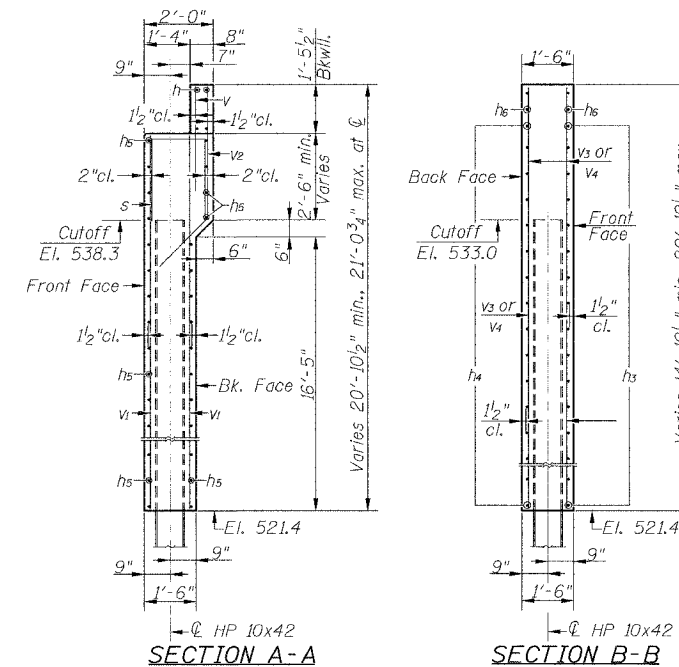
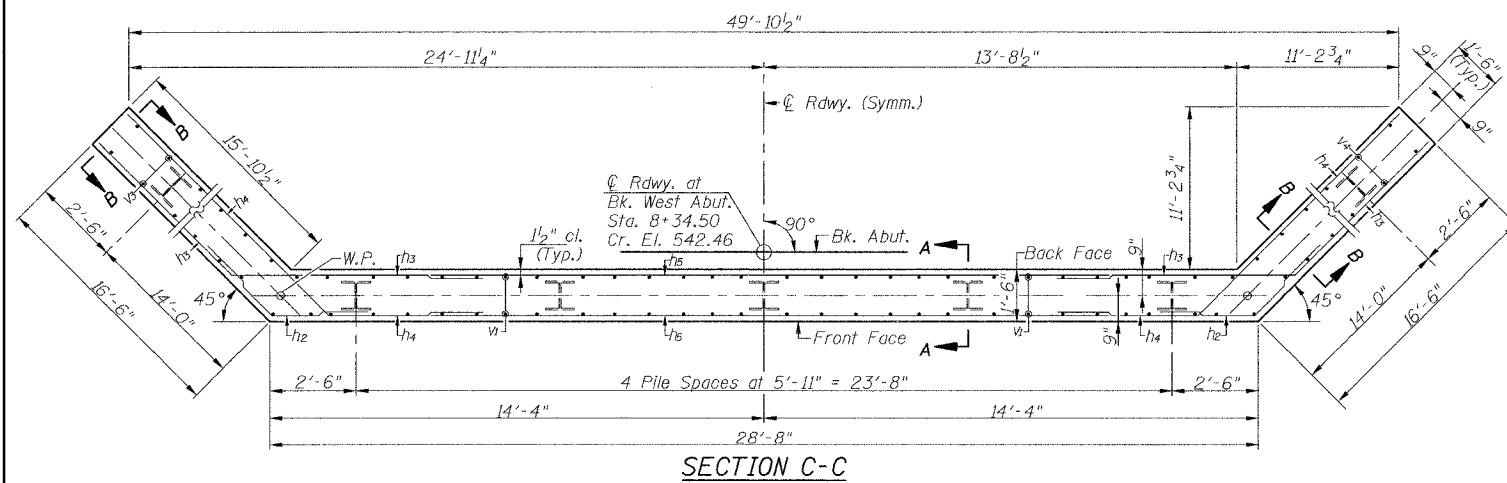

FILE NAME = #FILE.#	USER NAME = #USER#	DESIGNED -	REVISED -
		DRAWN -	REVISED -
		CHECKED -	REVISED -
		DATE	REVISED -

Allen Henderson & Associates, Inc.
Civil and Structural Engineers Springfield, IL
62703 Phone: (217)544-8033 IL Design Firm
No. 184-001907

WEST ABUTMENT
SCALE: SHEET NO. 8 OF 14 SHEETS STA. 5+99.00 TO STA. 11+75.00

T.R. RTE.	SECTION	COUNTY	TOTAL SHEETS	SHEET NO.
34	95-05109-00-BR	MENARD	14	8
CONTRACT NO.				
FED. ROAD DIST. NO. ILLINOIS FED. AID PROJECT				