

F.A.U. ROUTE	SECTION	COUNTY	TOTAL SHEETS	SHEET NO.
8047	96-00379-00-PV	SANG	66	48
STA. 462+00 TO STA. 464+00				
FED. ROAD DIST. NO.	ILLINOIS	FED. AID PROJECT		

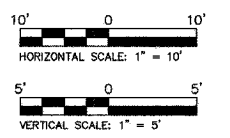
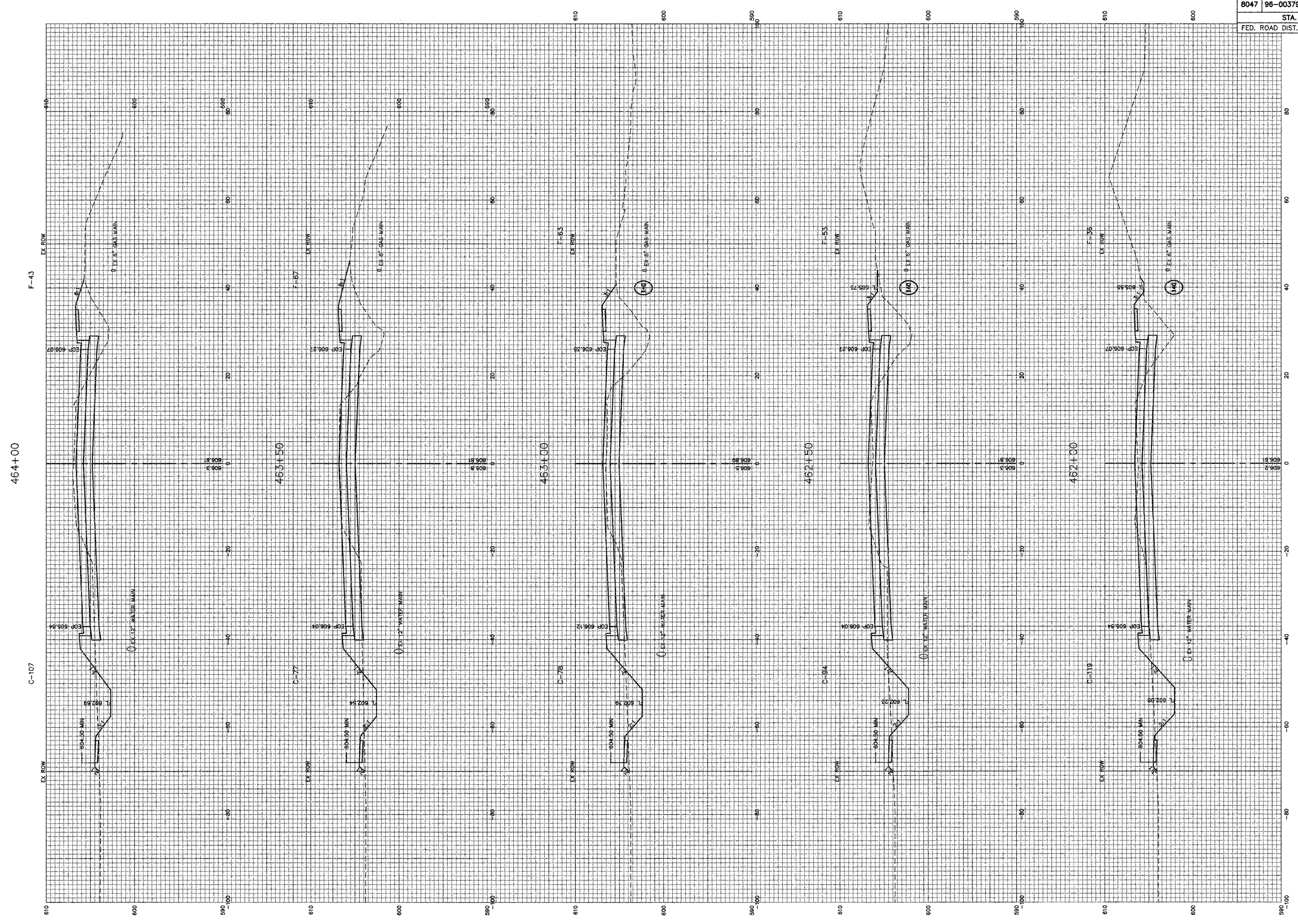

ILES AVENUE (FAU 8047) STA. 462+00 TO STA. 464+00

\\job\96100\CONPLANS_2007\C-XSEC-R2.dwg, STA. 462+00 TO STA. 464+00, 3/21/2008 10:30 AM, RPOPTS, 1:1