

F.A.U. ROUTE	SECTION	COUNTY	TOTAL SHEETS	SHEET NO.
8047	96-00379-00-PV	SANG	66	53
STA. 470+25 TO STA. 471+54.96				
FED. ROAD DIST. NO.	ILLINOIS	FED. AID PROJECT		

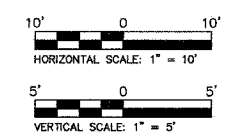
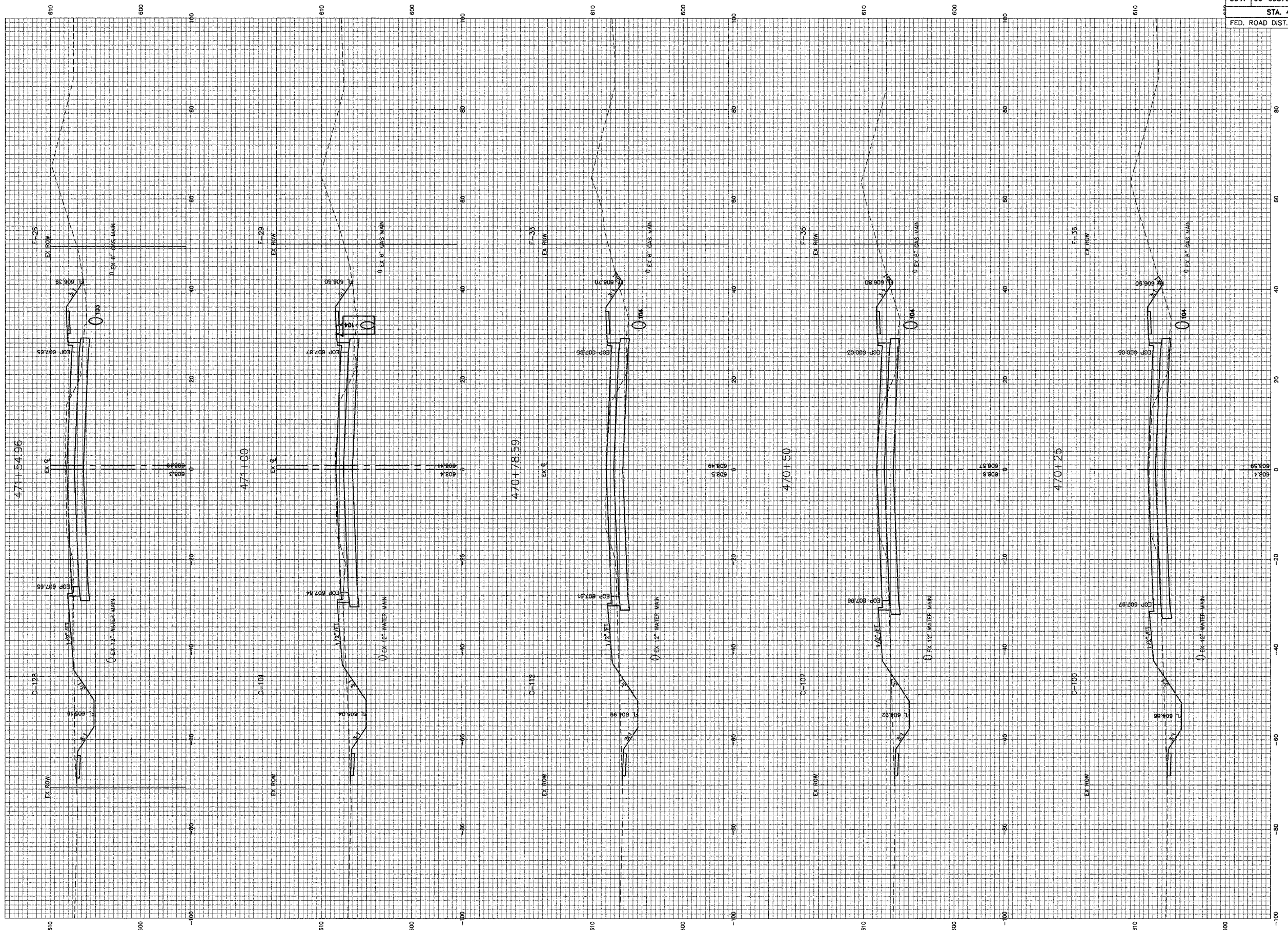

ILES AVENUE (FAU 8047) STA. 470+25 TO STA. 471+54.96

Attached: Y:\6100\CONPLANS_2007\C-XSEC-R2.dwg, STA. 470+25 TO STA. 471+54.96, 3/21/2008 10:31 AM, RPOTTS, 1:1
 P:\TBLK (S:\V\6100\CONPLANS_2007\C-XSEC-R2.dwg)