

F.A.D.	SECTION	COUNTY	TOTAL SHEETS	SHEET NO.
7998	97-00030-06-WR	SANGAMON	117	32
FED. ROAD DIST. NO.		ILLINOIS	FED. AID PROJECT	

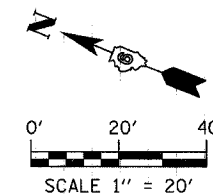

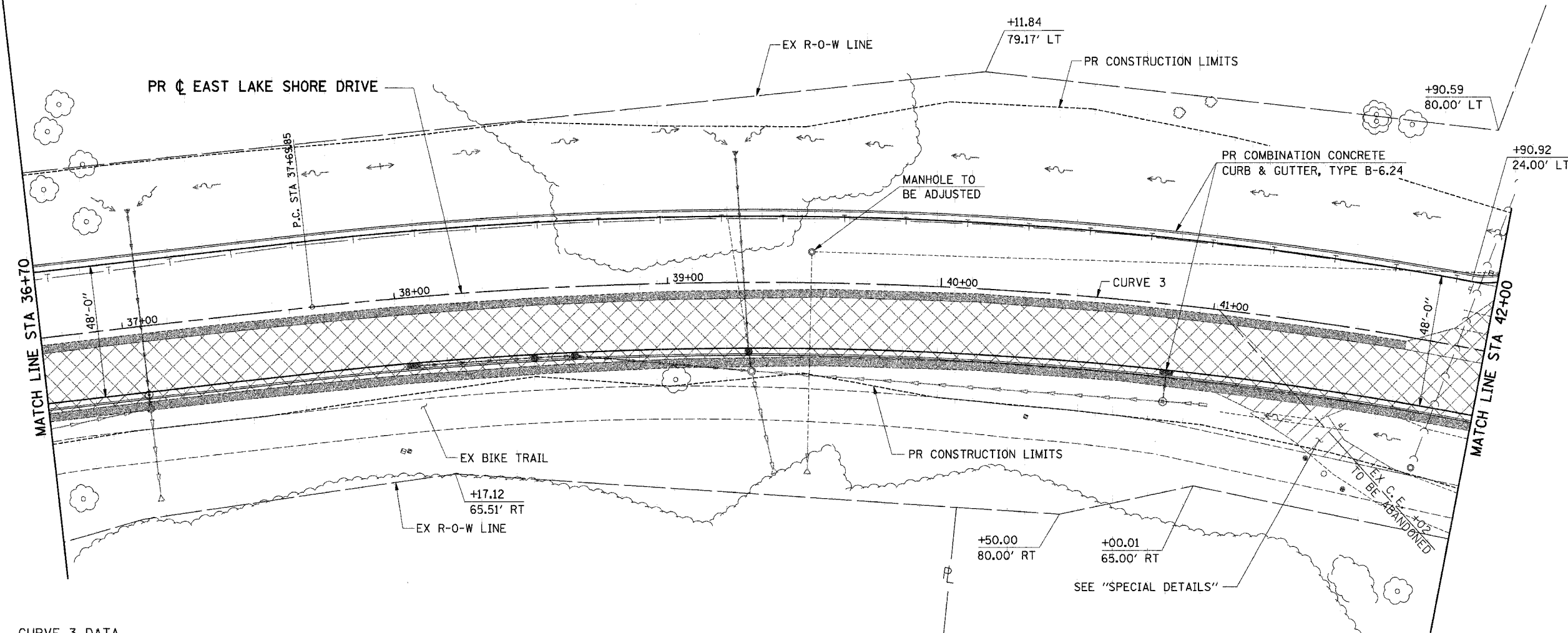

**CITY OF SPRINGFIELD**

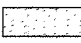
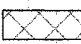
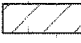

**CURVE 3 DATA**  
 P.I. STA 45+66.81  
 $\Delta = 58^\circ 10' 55''$  (RT)  
 $D = 4^\circ 00' 00''$   
 $T = 796.96'$   
 $R = 1,432.39'$   
 $L = 1,454.55'$   
 $E = 206.78'$   
 $e = 0.033''$   
 $T.R = 49'$   
 $S.E. RUN = 111'$   
 P.C. STA 37+69.85  
 P.T. STA 52+24.40

**6(f) PARK LAND**

- LEGEND**
-  PR TREE REMOVAL
  -  PR HOT-MIX ASPHALT SURFACE REMOVAL (VARIABLE DEPTH)
  -  PR PAVEMENT REMOVAL
  -  PR DRIVEWAY PAVEMENT REMOVAL
  -  PR PAVED SHOULDER REMOVAL

**ie consultants**  
 IE CONSULTANTS, INC.  
 8420 SOUTH SIXTH STREET  
 SPRINGFIELD, ILLINOIS 62712  
 TEL: (217) 529-8027  
 FAX: (217) 529-4543  
 IESPRINGFIELD@IE-CONSULTANTS.COM  
 WWW.IE-CONSULTANTS.COM

ROADWAY PLAN			
STA 36+70 TO STA 42+00			
DESIGNED BY: JEB	DRAWN BY: AAD	CHECKED BY: CMS	DATE: 4/4/08