

93467

F.A.U.	SECTION	COUNTY	TOTAL SHEETS	SHEET NO.
7998	97-00030-06-WR	SANGAMON	117	36
FED. ROAD DIST. NO.		ILLINOIS	FED. AID PROJECT	

CURVE 3 DATA
 P.I. STA 45+66.81
 $\Delta = 58^\circ 10' 55''$ (RT)
 $D = 4^\circ 00' 00''$
 $T = 796.96'$
 $R = 1,432.39'$
 $L = 1,454.55'$
 $E = 206.78'$
 $e = 0.0333'/'$
 $T.R = 49'$
 $S.E. RUN = 111'$
 P.C. STA 37+69.85
 P.T. STA 52+24.40

CITY OF SPRINGFIELD

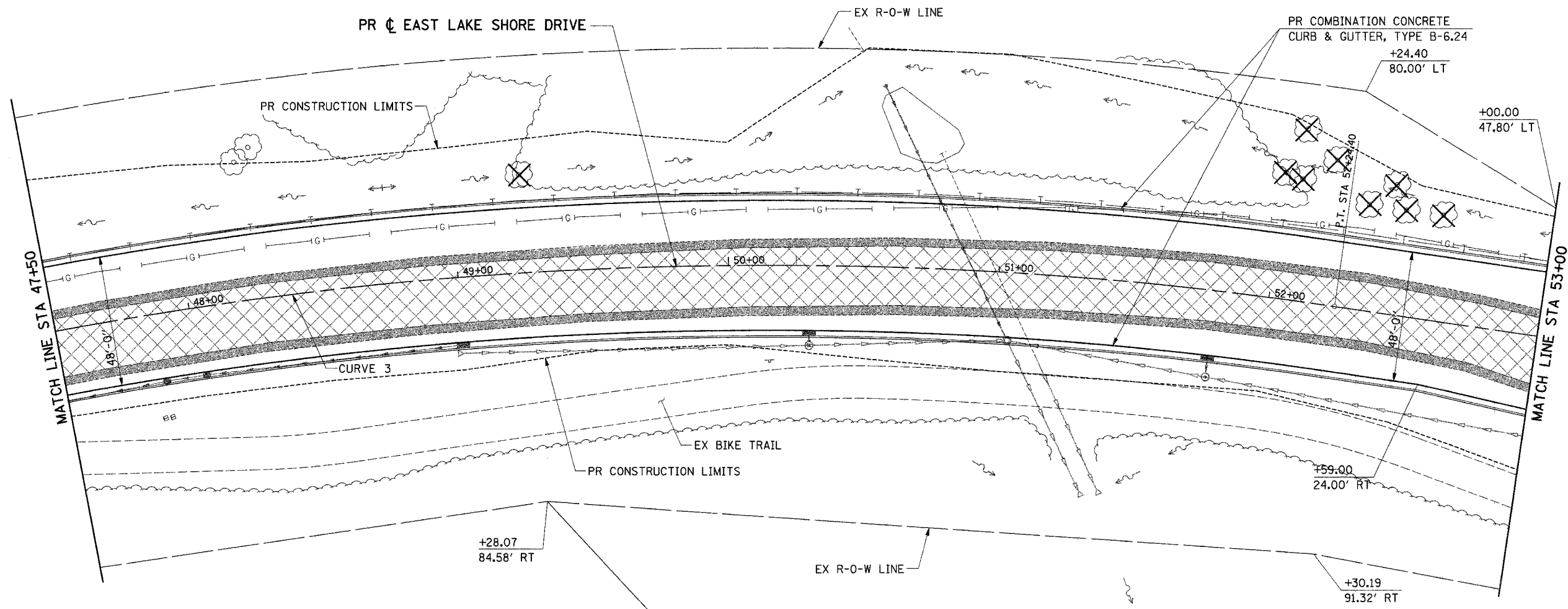
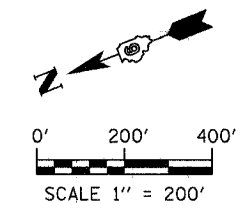

B.M. #6 STA 51+87, 33' RT
 RR SPIKE IN 18" TREE, W.
 SIDE OF ROAD, ELEV. 582.53

- LEGEND**
- PR TREE REMOVAL
 - PR HOT-MIX ASPHALT SURFACE REMOVAL (VARIABLE DEPTH)
 - PR PAVEMENT REMOVAL
 - PR DRIVEWAY PAVEMENT REMOVAL
 - PR PAVED SHOULDER REMOVAL

ie consultants
 IE CONSULTANTS, INC.
 6420 SOUTH SIXTH STREET
 SPRINGFIELD, ILLINOIS 62712
 TEL. (217) 529-8027
 FAX. (217) 529-4543
 IESPRINGFIELD@IE-CONSULTANTS.COM
 WWW.IE-CONSULTANTS.COM

**ROADWAY PLAN
 STA 47+50 TO STA 53+00**

DESIGNED BY: JEB	DRAWN BY: AAD	CHECKED BY: CMS	DATE: 4/4/08
---------------------	------------------	--------------------	-----------------

4/9/2008