

FAU	SECTION	COUNTY	TOTAL SHEETS	SHEET NO.
7998	97-00030-06-WR	SANGAMON	117	60
FED. ROAD DIST. NO.		ILLINOIS	FED. AID PROJECT	

- (S-1) STA 9+53, 52.0' RT
PRECAST REINFORCED CONCRETE
FLARED END SECTIONS 18"
INV = 567.00
- (S-2) STA 10+00, 12.2' RT
RD MANHOLES, 5' DIA,
TYPE 3V FRAME & GRATE
EOP EL = 576.48
INV (E) = 572.50
INV (N) = 573.25
INV (SW) = 570.50
- (S-3) STA 10+00, 12.2' LT
INLETS, TYPE A,
TYPE 3V FRAME & GRATE
EOP EL = 576.48
INV (S) = 573.50
- (S-4) STA 11+70, 21.7' RT
RD CATCH BASIN, 3' DIA,
TYPE 3V FRAME & GRATE
EOP EL = 578.35
INV (E) = 574.75
INV (W) = 574.50
- (S-5) STA 14+20, 24.0' RT
RD CATCH BASIN, 3' DIA,
TYPE 3V FRAME & GRATE
EOP EL = 581.12
INV (E) = 578.00
INV (W) = 577.75
- (P-1) S-2 TO S-1 // 60' @ 5.30%
STORM SEWERS, CLASS A, TYPE 1 18"
- (P-2) S-3 TO S-2 // 25' @ 1.00%
STORM SEWERS, CLASS A, TYPE 1 12"
- (P-3) S-4 TO S-2 // 170' @ 1.18%
STORM SEWERS, CLASS A, TYPE 1 18"
- (P-4) S-5 TO S-4 // 243' @ 1.23%
STORM SEWERS, CLASS A, TYPE 2 15"
- (P-5) S-10 TO S-5 // 126' @ 2.38%
STORM SEWERS, CLASS A, TYPE 2 12"

NOTES:
① PIPE CULVERT REMOVAL (C.M.P 15'') = 40'

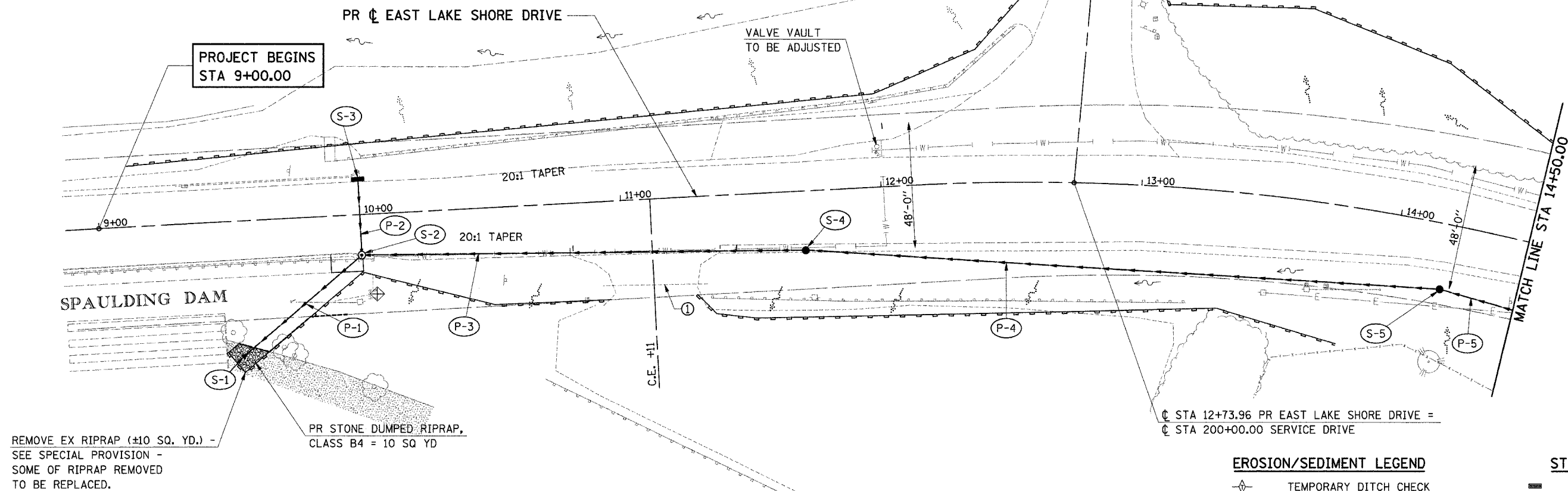
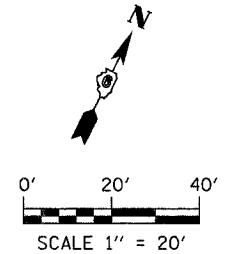

LAKE SPRINGFIELD

- | EROSION/SEDIMENT LEGEND | | STORM LEGEND | |
|-------------------------|---------------------------|--------------|--------------------|
| | TEMPORARY DITCH CHECK | | INLET |
| | INLET & PIPE PROTECTION | | CATCH BASIN |
| | PERIMETER EROSION BARRIER | | MANHOLE |
| | EX DITCH SUMMIT | | STORM SEWER |
| | PR DITCH SUMMIT | | FLARED END SECTION |
| | EX FLOW LINE | | |
| | PR FLOW LINE | | |
| | PR SWALE | | |
| | EX SHEET FLOW | | |
| | PR SHEET FLOW | | |
| | PR RIP RAP | | |

ie
consultants

IE CONSULTANTS, INC.
6420 SOUTH SIXTH STREET
SPRINGFIELD, ILLINOIS 62712
TEL: (217) 529-8027
FAX: (217) 529-4643
IESPRINGFIELD@IE-CONSULTANTS.COM
WWW.IE-CONSULTANTS.COM

DRAINAGE PLAN
STA 9+00 TO STA 14+50

DESIGNED BY: JEB	DRAWN BY: AAD	CHECKED BY: CMS	DATE: 4/4/08
---------------------	------------------	--------------------	-----------------