

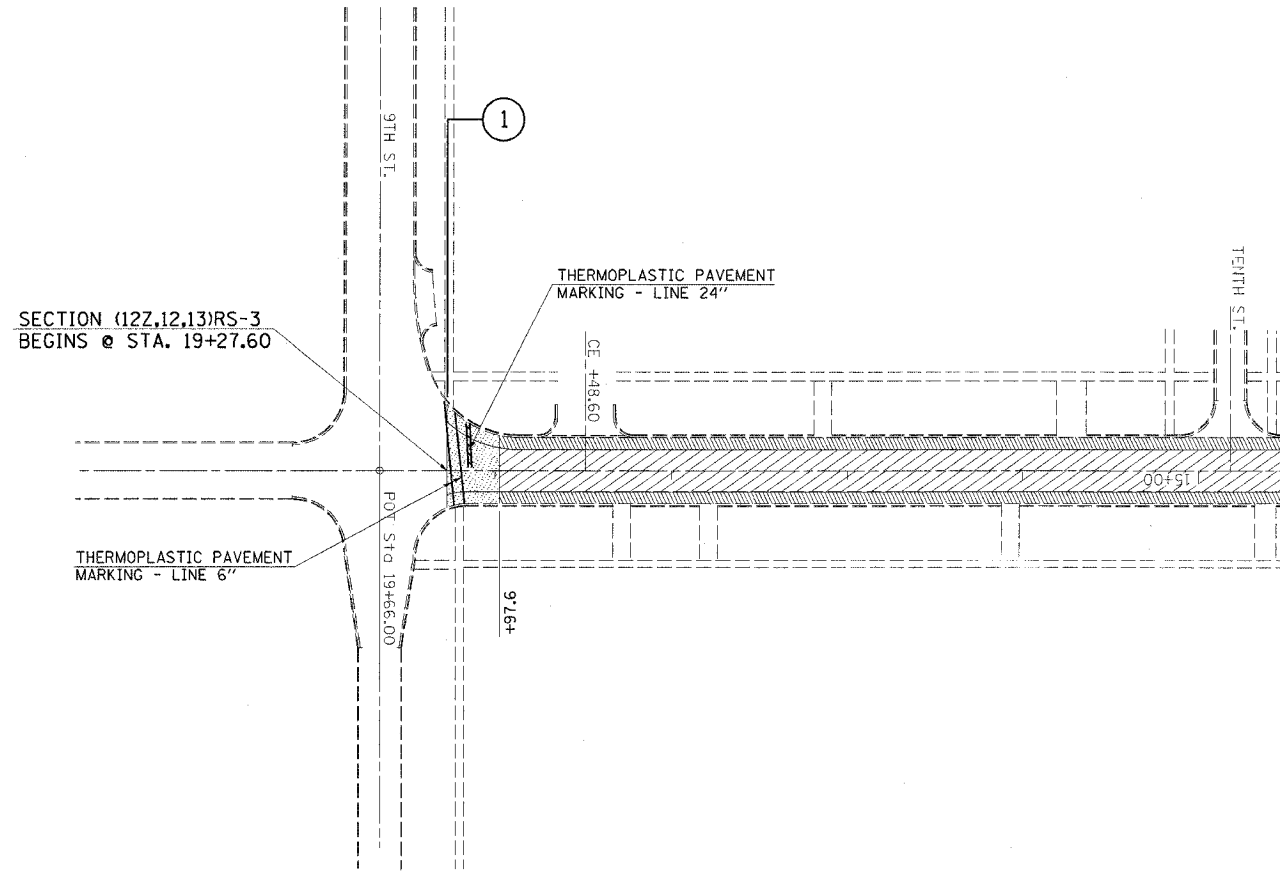



F.A.P. RTE.	SECTION	COUNTY	TOTAL SHEETS	SHEET NO.
332	*	WABASH	36	13
STA. TO STA.				
FED. ROAD DIST. NO.	ILLINOIS	FED. AID PROJECT		

* (12Z,12,13)RS-3



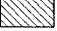

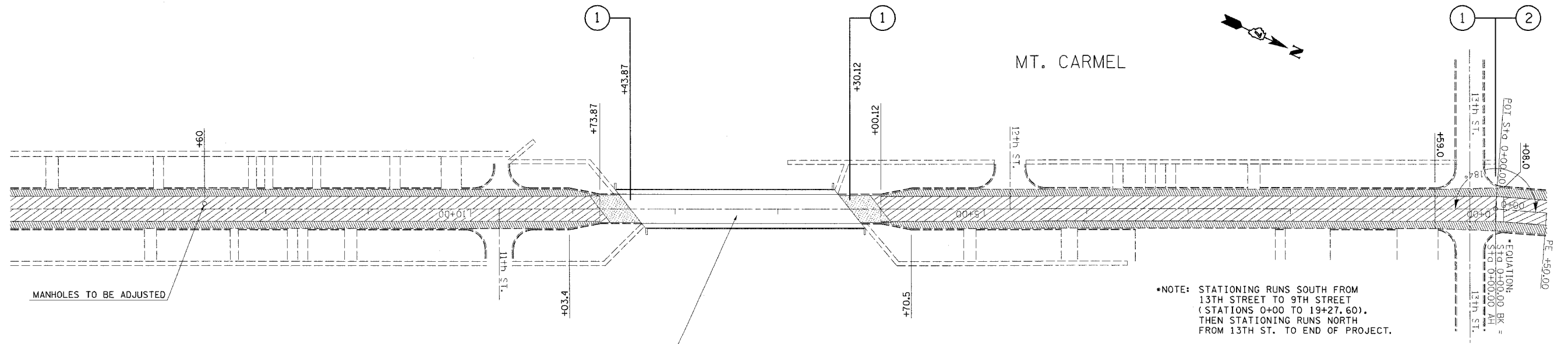
-  HOT MIX ASPHALT SURFACE REMOVAL, 1/2"
-  HOT MIX ASPHALT SURFACE REMOVAL, VARIABLE DEPTH
-  HOT MIX ASPHALT SURFACE REMOVAL - BUTT JOINT

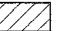

*NOTE: STATIONING RUNS SOUTH FROM 13TH STREET TO 9TH STREET (STATIONS 0+00 TO 19+27.60). THEN STATIONING RUNS NORTH FROM 13TH ST. TO END OF PROJECT.

BRIDGE OMISSION SN 093-0006
STA. 6+30.12 TO STA. 8+43.87

-  HOT MIX ASPHALT SURFACE REMOVAL, 1/2"
-  HOT MIX ASPHALT SURFACE REMOVAL, VARIABLE DEPTH
-  HOT MIX ASPHALT SURFACE REMOVAL - BUTT JOINT

PLOT DATE = 1/16/2008
FILE NAME = c:\prowork\94984\plan_1.dgn
USER NAME = bms1234