

| ROUTE NO. | SECTION  | COUNTY | SHEET | TOTAL |
|-----------|----------|--------|-------|-------|
| *         | LAWRENCE | 10     | 1     |       |

\* 05-08133-00-BR

B.M.  
Existing Structure  
Salvage

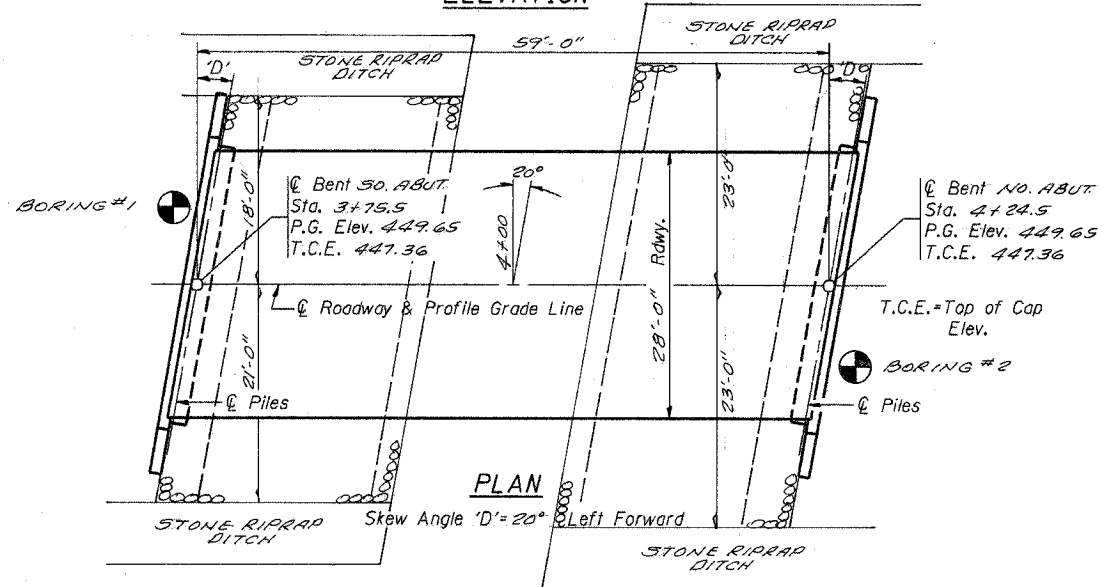
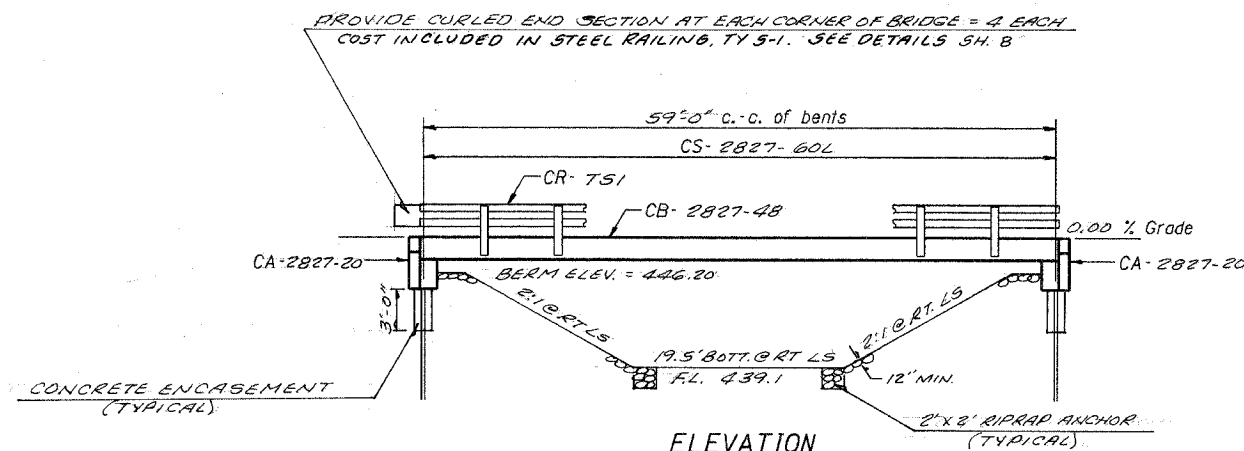

STONE DUMPED RIPRAP, CLASS AA (MIN. THICKNESS = 12")  
SOUTH SIDE = 50 TON  
NORTH SIDE = 60 TON  
TOTAL = 110 TON

**GENERAL NOTES**

- The Contractor shall drive 1 test piles, as specified, in a permanent location as directed by the Engineer before ordering the remaining piles.
- See Special Provisions for boring logs.
- A Corrosion inhibitor, as covered in the Special Provisions, shall be used in the concrete for precast prestressed concrete deck beams.

**TOTAL BILL OF MATERIAL**

| Item  | Unit    | Super | Sub.  |        | Total |
|---|---------|-------|-------|--------|-------|
|   |         |       | Piers | Abuts. |       |
| Removal of Existing Structures                      | Each    |       |       |        | 1     |
| Bituminous Concrete Surface Course, Superpave       | Ton     |       |       |        |       |
| Waterproofing Membrane System                       | Sq. Yd. |       |       |        |       |
| Concrete Structures                                 | Cu. Yd. |       |       | 22.2   | 22.2  |
| Precast Prestressed Concrete Deck Beams (27" Depth) | Sq. Ft. | 1680  |       |        | 1680  |
| Steel Bridge Rail, Type SM                          | Foot    |       |       |        |       |
| Steel Railing, Type S-1                             | Foot    | 120   |       |        | 120   |
| Reinforcement Bars                                  | Pound   |       |       | 2680   | 2680  |
| Furnishing STEEL PILES HP 10x42                     | Foot    |       |       | 234    | 234   |
| Driving PILES                                       | Foot    |       |       | 234    | 234   |
| Test Piles STEEL HP 10x42                           | Each    |       |       | 1      | 1     |
| Name Plates   | Each    |       |       | 1      | 1     |
| Concrete Encasement                                 | Cu. Yd. |       |       | 2.6    | 2.6   |
| Portland Cement Mortar Fairing Course               | Foot    |       |       |        |       |
| STONE DUMPED RIPRAP, CLASS AA                       | TON     |       |       | 110    | 110   |

**INDEX OF SHEETS**

- General Plan & Elevation
- Standard CS-2827-60L
- Standard CB-2827-48
- Standard CA-2827-20
- Standard CR-751
- Standard CN
- Standard CX-1
- Standard
- Standard

**DESIGN SPECIFICATIONS**

2002 AASHTO Standard Specifications - 17th ed.

**LOADING HS20-44**

Allow 25#/sq. ft. for future wearing surface.

**SEISMIC DATA**

Seismic Performance Category (SPC) =  
Bedrock Acceleration Coefficient (A) =  
Site Coefficient (S) =

**PILE DATA (2-ABUTS.)**

Type STEEL HP 10x42 (IN ACCORD. TO AASHTO M 270 GRADE 50)  
Estimated Length 26 Feet  
Number Required 10 (Includes 1 Test Pile located in N. ABUT.)  
ALLOWABLE RESISTANCE AVAILABLE = 112 KIPS  
NOMINAL REQUIRED BEARING = 335 KIPS

STATION 4+00  
MAD CREEK  
SEC. 05-08133-00-BR BUILT 20  
PROJECT NO. BR05-101(027)  
LAWRENCE COUNTY  
LOADING HS20  
STR. NO. 051-3280

**LETTERING FOR NAME PLATE**

Locate Name Plate at SOUTHEAST Corner of Bridge (See Std. CN)

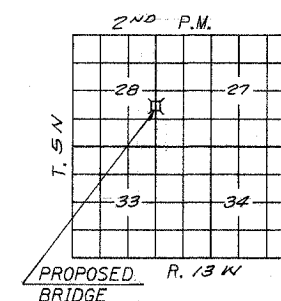

LOCATION SKETCH

**WATERWAY INFORMATION**

Drainage Area = 3.09 SQ. MI. Low Grade Elev. = 446.2 @ Sta. 4+00

| Flood       | Freq. Yr. | Q C.F.S. | Opening Sq. Ft. |       | Nat. H.W.E. | Head - Ft. |       | Headwater El. | APPROACH OPENING |       |    |
|-------------|-----------|----------|-----------------|-------|-------------|------------|-------|---------------|------------------|-------|----|
|             |           |          | Exist.          | Prop. |             | Exist.     | Prop. |               | EXIST.           | PROP. |    |
| Design      | 15        | 771      | 145             | 240   | 446.2       | 0.2        | 0.3   | 446.4         | 446.5            | 82    | 0  |
| Base        | 100       | 1235     | 145             | 256   | 446.5       | 0.2        | 0.3   | 446.7         | 446.8            | 217   | 67 |
| Overtopping |           |          |                 |       |             |            |       |               |                  |       |    |
| Max. Calc.  | 500       | 1612     |                 |       | 446.7       |            |       |               |                  |       |    |

**GENERAL PLAN & ELEVATION**

TR ROUTE 32  
OVER MAD CREEK  
SECTION 05-08133-00-BR  
LAWRENCE COUNTY  
STATION 4+00