

ROUTE	SECTION	COUNTY	TOTAL SHEETS	SHEET NO.
TR 175A	07-03123-00-BR	CRAWFORD	11	3
STA. 5+00 TO STA. 19+00.00		ILLINOIS CONTRACT NO. 95556		

EXISTING STRUCTURE: THREE SPAN BRIDGE WITH PRECAST CONCRETE DECK SLABS ON CONCRETE ABUTMENT CAPS WITH STEEL H-PILE BENTS. PIERS ARE FOOTING SUPPORTED CONCRETE COLUMNS. 110' LONG x 26.25' WIDE, 45° AHEAD LEFT SKEW. TO BE REMOVED. SEE SPECIAL PROVISIONS.

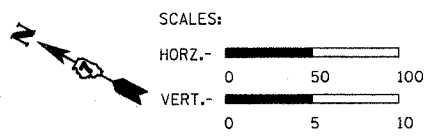

← PALESTINE CHAMBER OF COMMERCE →

SHOULDER WIDENING FOR TRAFFIC BARRIER TERMINALS, (TYP. ALL 4 CORNERS) (SEE STD. 630301)

END SECTION STA. 14+24.14

BEGIN SECTION STA. 11+66.78

PROPOSED STRUCTURE STA. 12+95.46  
 THREE SPAN PRECAST PRESTRESSED CONCRETE DECK BEAM BRIDGE.  
 157'-4 1/2" BK. TO BK. ABUTMENTS x 28' WIDE.  
 45° AHEAD LEFT SKEW.  
 EXISTING STRUCTURE NO. 017-3314  
 PROPOSED STRUCTURE NO. 017-3325

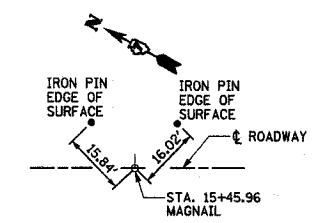
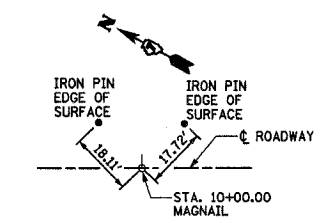

**TREE REMOVAL SCHEDULE**

STA.	OFFSET	OVER 15 INCH DIA.
11+92	35' RT.	26"
11+94	34' RT.	18"
12+09	34' RT.	16"
12+12	28' RT.	28"
TOTAL		88"

**EARTHWORK SCHEDULE**

LOCATION	EARTH EXCAVATION CU. YD.	EARTH EXCAVATION ADJUSTED FOR SHRINKAGE* CU. YD.	EMBANKMENT CU. YD.	EARTHWORK BALANCE** WASTE (+) OR SHORTAGE (-) CU. YD.
STA. 10+61.80 TO STA. 12+16.78	19	14	240	-226
STA. 13+74.14 TO STA. 15+29.12	15	11	178	-167
TOTAL	34	25	418	-393

\*25% SHRINKAGE      \*\*FURNISHED EXCAVATION

THE EXISTING RIGHT OF WAY SHOWN HEREON HAS BEEN PROTRACTED FROM EXISTING RECORDS AND IS TO BE USED FOR REFERENCE PURPOSES ONLY. FURTHERMORE, NO COMPLETE SURVEY OF SAID R.O.W. IS IMPLIED BY THIS DRAWING.

PLAN  
 DRAWN BY: \_\_\_\_\_  
 CHECKED BY: \_\_\_\_\_  
 DATE: \_\_\_\_\_

PROFILE  
 DRAWN BY: \_\_\_\_\_  
 CHECKED BY: \_\_\_\_\_  
 DATE: \_\_\_\_\_

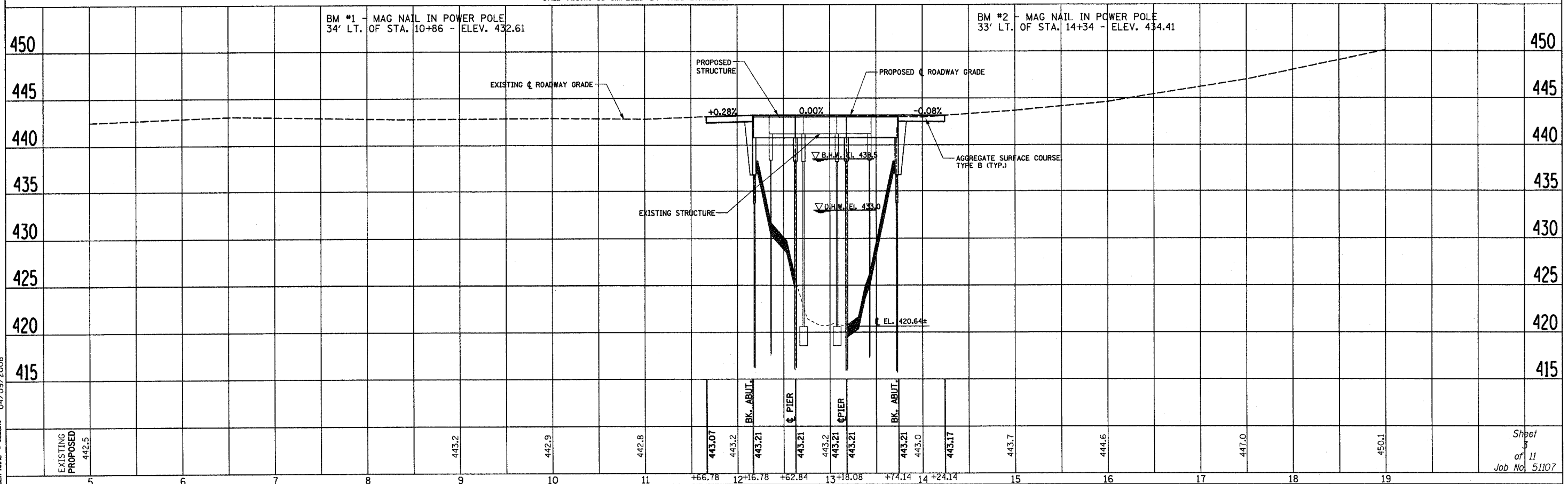

PLAN & PROFILE OF ROADWAY PROPOSED BRIDGE OVER LAMOTTE CREEK  
 TR 175A SECTION 07-03123-00-BR CRAWFORD COUNTY, ILLINOIS

Sheet of 11  
 Job No. 51107