

ROUTE NO.	SECTION	COUNTY	TOTAL SHEETS	SHEET NO.
-	99-00009-01-FP	ST. CLAIR	69	6
FED. ROAD DIST. NO. 8	ILLINOIS	FED. AID PROJECT-	TYPICAL SECTIONS	
CONTRACT NO. 97312				

- 8 LIME MODIFIED SOILS 12"
- 9 HOT-MIX ASPHALT BASE COURSE 9.75"
- 10 AGGREGATE SUBBASE TYPE C
- 11 HOT-MIX ASPHALT CONC SURFACE COURSE 2.25"
- 12 HOT-MIX ASPHALT SHLD 8"
- 13 AGGREGATE SHLD 8"

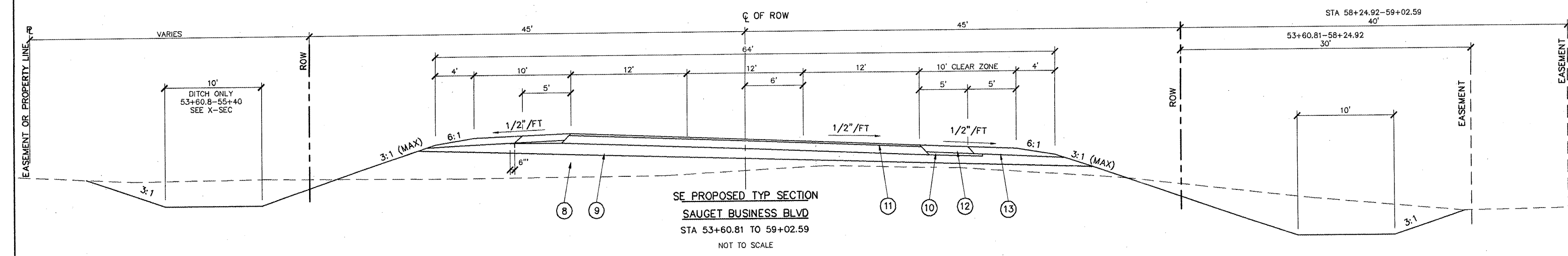
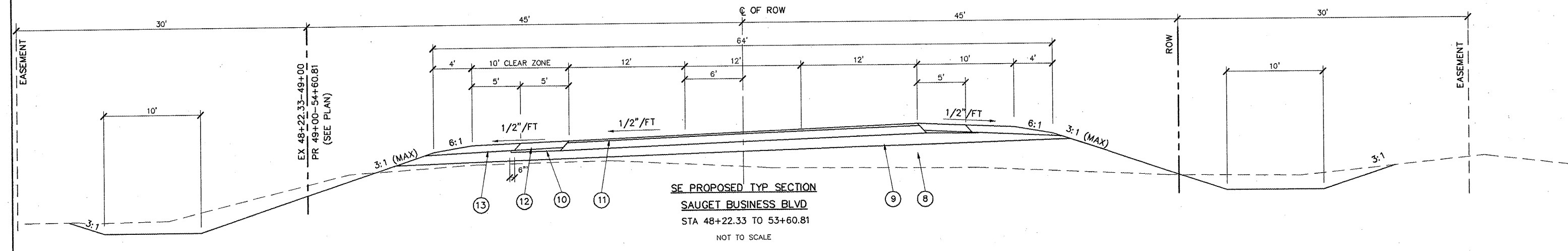
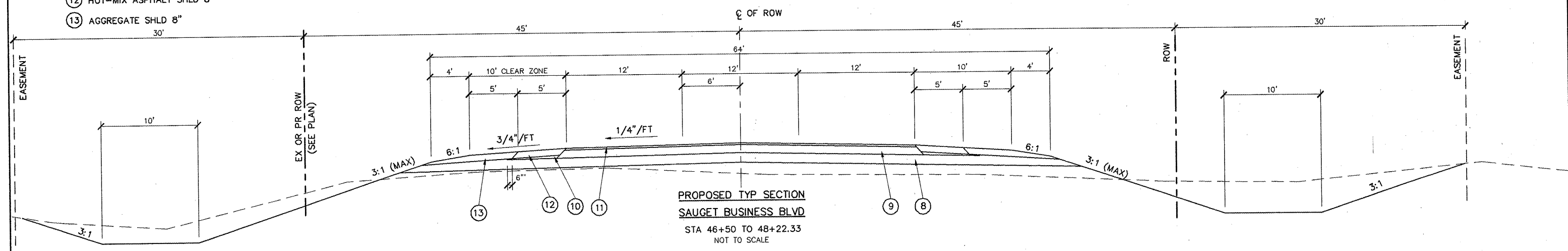

T:\chm\saug\typ\typ13-87-1.plt 06/06/06 09:14 TYPICALS.dwg, 006-TYP-PR, 4/10/2008 12:43 PM, Xref: 8425.dwg