

T.R.	SECTION	COUNTY	TOTAL SHEETS	SHEET NO.
131	05-01114-00-BR	HAMILTON	13	2
FED. ROAD DIST. NO. 9 ILLINOIS		WOLF CREEK		
PROJECT # BROS-191551		CONTRACT # 99317		
LEC JOB # H061020HM				

323 W. 3RD ST.
P.O. BOX 160
MT. CARMEL, IL
62893
PHONE:
(618)-262-8651
FAX:
(618)-263-3327

405 W. STATE ST.
SUITE 1
PRINCETON, IN
47670
PHONE:
(812)-386-7611
FAX:
(812)-385-2812



PROFESSIONAL DESIGN FIRM
LAND SURVEY & PROFESSIONAL ENGINEERING CORPORATION
184-00887
(62-032435)(35-002769)

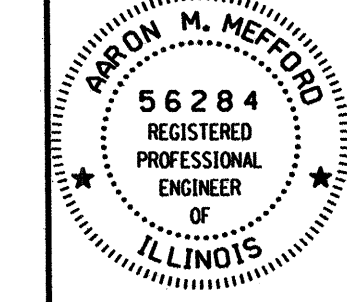

AARON M. MEFFORD
NAME
SIGNATURE
DATE
11-30-09
EXPIRES

BEAVER CREEK TOWNSHIP
OVER WOLF CREEK
HAMILTON COUNTY, ILLINOIS

SHEET TITLE:
PLAN & PROFILE

SCALE: VRIES

BY: AMM
DATE: 11/07
REV:

2 OF 13 SHEETS

SHEET NO. 2

NOTE: CONSTRUCTION TRANSITIONS
STA. 1+50 TO STA 2+00
STA 7+50 TO STA 8+00
ALL QUANTITIES ARE INCLUDED IN THE PROPOSAL

GENERAL NOTES:

THIS SECTION SHALL BE CONSTRUCTED IN ACCORDANCE WITH THE PLANS, SPECIAL PROVISIONS AND "STANDARD SPECIFICATIONS FOR ROAD AND BRIDGE CONSTRUCTION", ADOPTED JANUARY 1, 2007.

THE WORK INVOLVED ON THIS SECTION CONSISTS OF THE REMOVAL OF THE EXISTING STRUCTURE, THE CONSTRUCTION OF A 60 FOOT LONG SINGLE SPAN PRECAST, PRESTRESSED CONCRETE DECK BEAM BRIDGE, EARTH APPROACHES, AGGREGATE SURFACE COURSE AND OTHER MISCELLANEOUS ITEMS NECESSARY TO COMPLETE THIS SECTION.

ALL ELEVATIONS ARE BASED ON U.S.G.S. MEAN SEA LEVEL DATUM.

IT SHALL BE THE CONTRACTOR'S RESPONSIBILITY TO CONTACT ALL THE UTILITIES, AFFECTING THE PROJECT, PRIOR TO CONSTRUCTION.

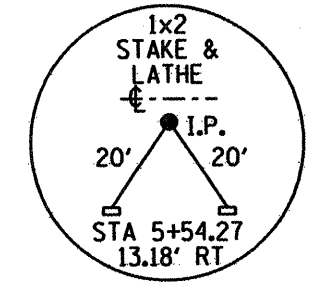
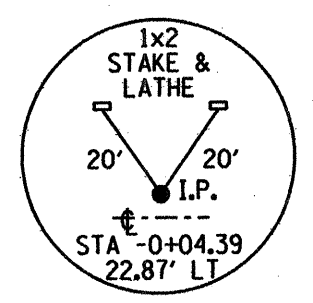

CURVE #1
P.I. STA= 3+18.58
Δ= LT. 5'43'28"
D= 1°54'35"
R= 3000'
T= 149.99'
L= 299.73'
E= 3.75'
e= NONE
T.R.= NONE
S.E. RUN= NONE
P.C. STA= 1+68.59
P.T. STA= 4+68.32

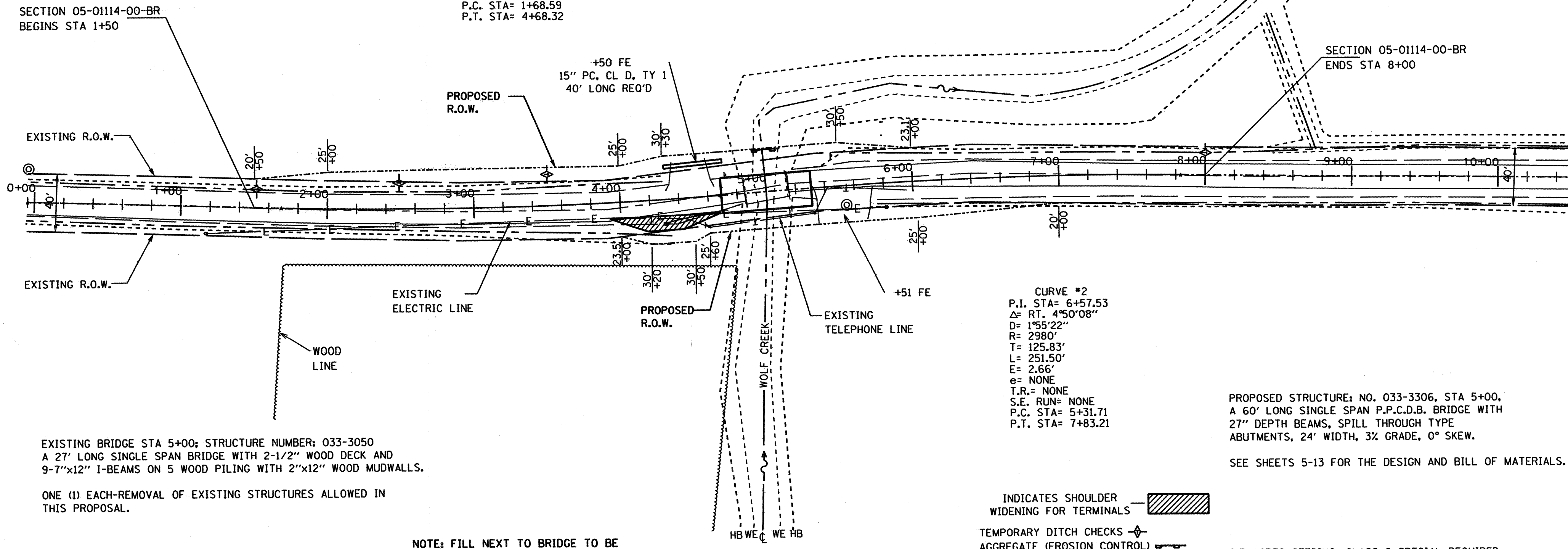
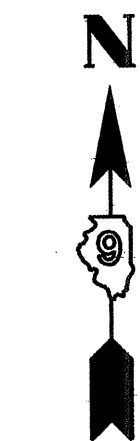

EXISTING BRIDGE STA 5+00; STRUCTURE NUMBER: 033-3050
A 27' LONG SINGLE SPAN BRIDGE WITH 2-1/2" WOOD DECK AND 9-7"x12" I-BEAMS ON 5 WOOD PILING WITH 2"x12" WOOD MUDWALLS.

ONE (1) EACH-REMOVAL OF EXISTING STRUCTURES ALLOWED IN THIS PROPOSAL.

INDICATES SHOULDER WIDENING FOR TERMINALS
TEMPORARY DITCH CHECKS
AGGREGATE (EROSION CONTROL)

PROPOSED STRUCTURE: NO. 033-3306, STA 5+00,
A 60' LONG SINGLE SPAN P.P.C.D.B. BRIDGE WITH 27" DEPTH BEAMS, SPILL THROUGH TYPE ABUTMENTS, 24' WIDTH, 3% GRADE, 0° SKEW.

SEE SHEETS 5-13 FOR THE DESIGN AND BILL OF MATERIALS.

TYPICAL CROSS SECTION PROPOSED

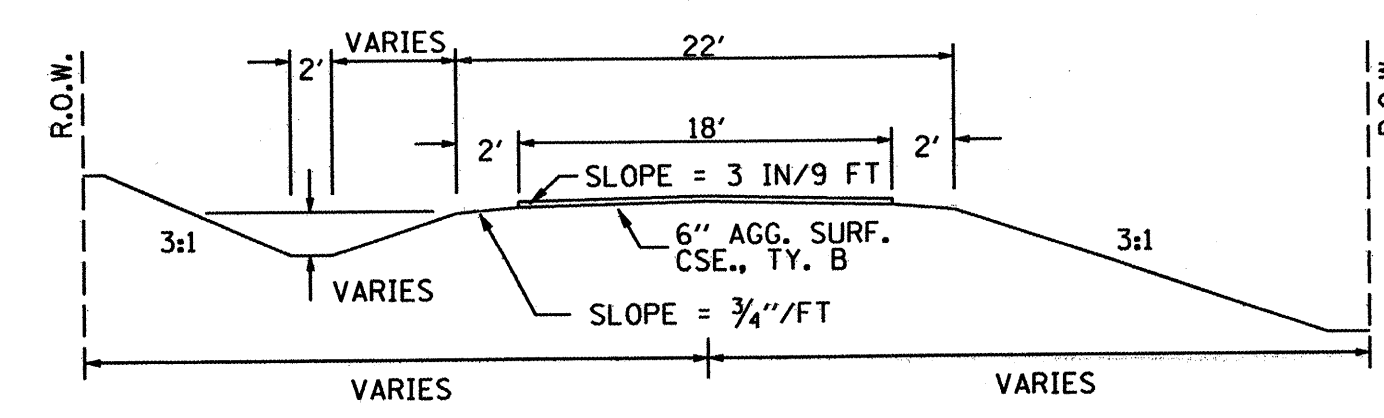

TYPICAL CROSS SECTION EXISTING

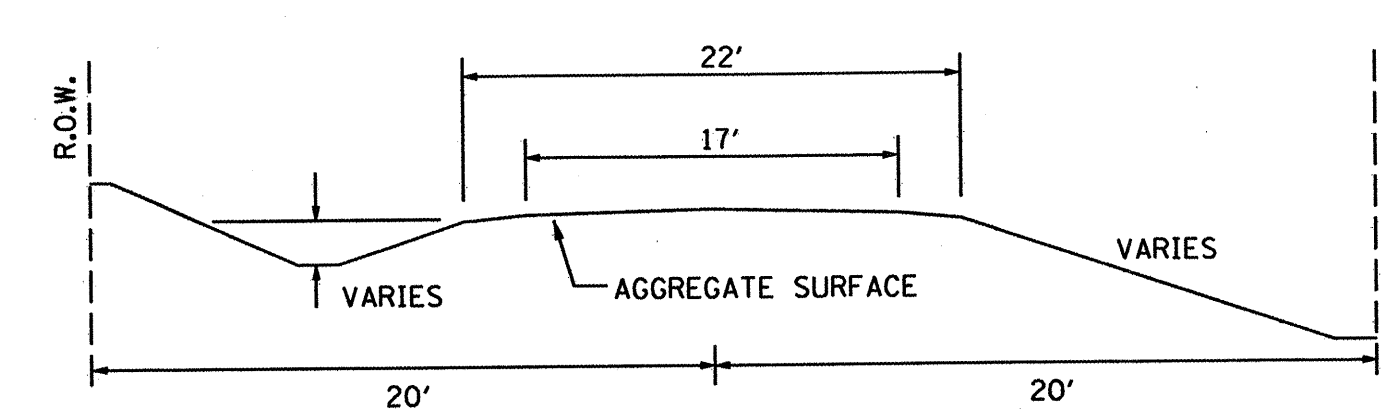

FIELD ENTRANCE DETAIL

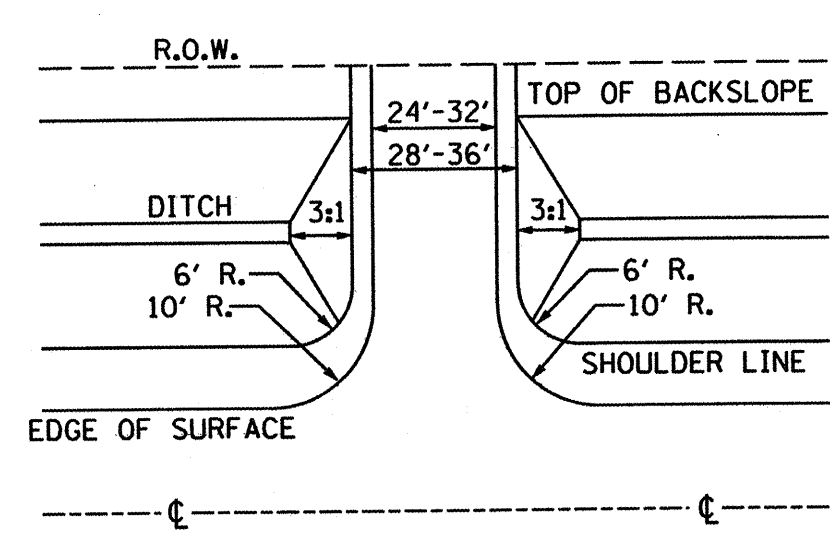

NOTE: CONSTRUCT SPECIAL DITCH

STA 1+50 TO STA 4+00 LT
STA 4+00 TO STA 4+70 RT
STA 5+72 TO STA 6+50 LT
STA 7+00 TO STA 8+00 RT

NOTE: CONSTRUCT STONE RIPRAP DITCH

STA 4+00 TO STA 4+30 LT (0.62 TON/LIN FT)
STA 4+00 TO STA 4+70 RT (0.62 TON/LIN FT)
62 TON STONE RIPRAP DITCH ALLOWED IN PROPOSAL.

SEE SHEET NO. 13 FOR STONE RIPRAP DITCH DETAIL.

UTILITIES:
J.U.L.I.E. 1-800-892-0123
WAYNE-WHITE COUNTY ELECTRIC
618-842-2196
HAMILTON COUNTY TELEPHONE
618-736-2214

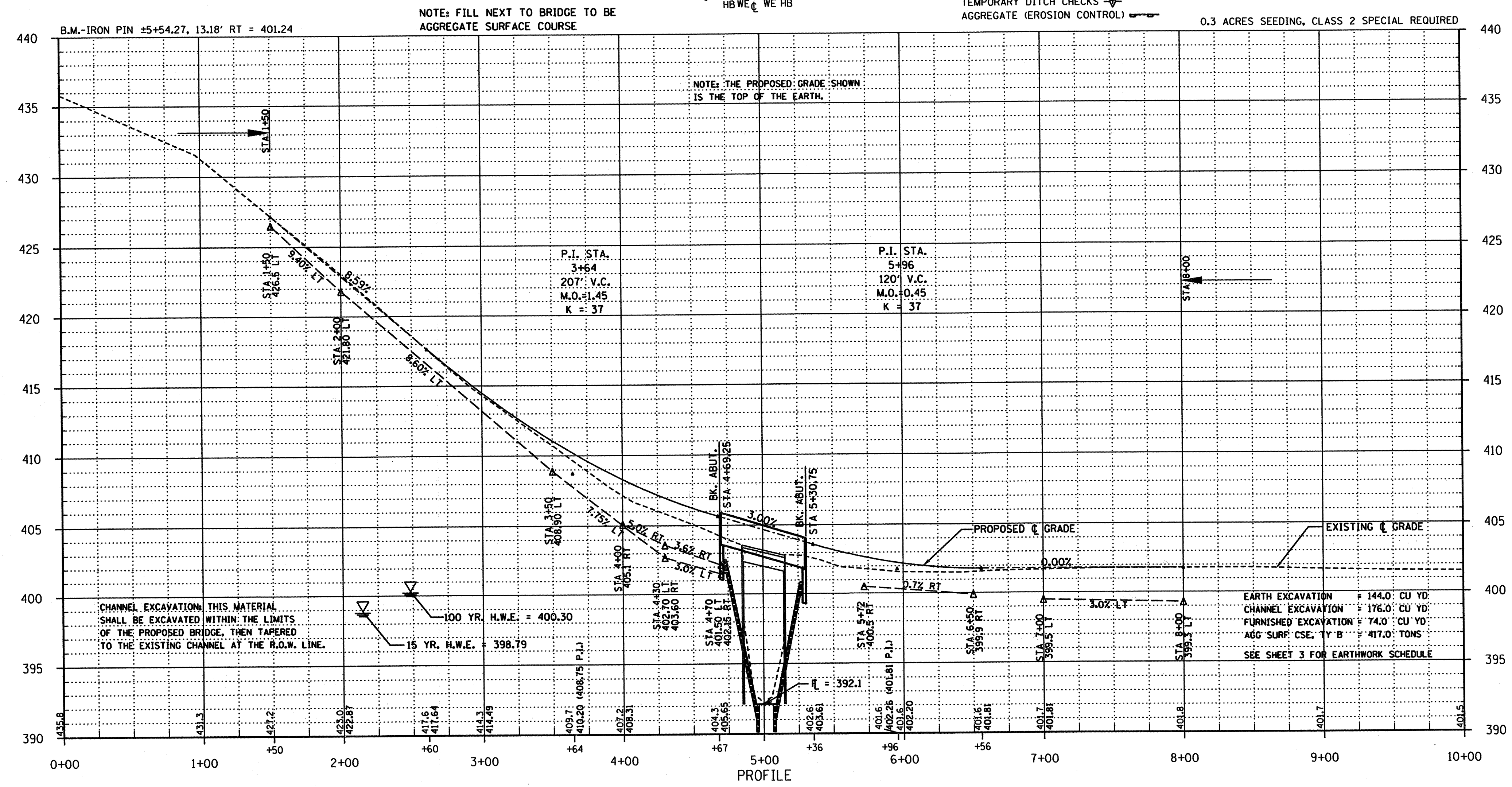

NOTE: FILL NEXT TO BRIDGE TO BE AGGREGATE SURFACE COURSE

NOTE: THE PROPOSED GRADE SHOWN IS THE TOP OF THE EARTH.

0.3 ACRES SEEDING, CLASS 2 SPECIAL REQUIRED

CHANNEL EXCAVATION: THIS MATERIAL SHALL BE EXCAVATED WITHIN THE LIMITS OF THE PROPOSED BRIDGE, THEN TAPERED TO THE EXISTING CHANNEL AT THE R.O.W. LINE.

EARTH EXCAVATION = 144.0 CU YD
CHANNEL EXCAVATION = 176.0 CU YD
FURNISHED EXCAVATION = 74.0 CU YD
AGG SURF CSE: 1Y B = 417.0 TONS
SEE SHEET 3 FOR EARTHWORK SCHEDULE