

CRITICAL POINTS			
POINT	LATITUDE	LONGITUDE	ELEVATION
A	40° 28' 28.04"	88° 54' 40.83"	867.82'
B	40° 28' 27.51"	88° 54' 38.67"	863.74'
C	40° 28' 25.58"	88° 54' 39.29"	862.91'
D	40° 28' 24.30"	88° 54' 35.96"	870.68'
E	40° 28' 22.31"	88° 54' 35.92"	872.87'
F	40° 28' 22.73"	88° 54' 35.27"	871.55'
G	40° 28' 25.56"	88° 54' 34.97"	877.59'
H	40° 28' 27.54"	88° 54' 34.13"	876.81'

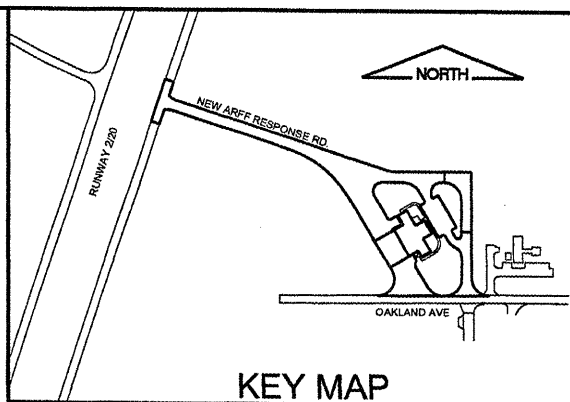

K:\Bloomington\0508509_BMI_ARFF\Draw\Sheets
 FILE: CAP-1.dwg
 UPDATE BY: Kristy Brad
 PLOT DATE: 4/18/2008 8:31 AM
 BASE_EXISTORP
 FLOOR_ENG-UCS
 SITE_KEYMAP
 BASE_PROPCEO

BL064

REVISIONS		
NUMBER	BY	DATE

0 1 2
 THIS BAR IS EQUAL TO 2" AT FULL SCALE (34X22).

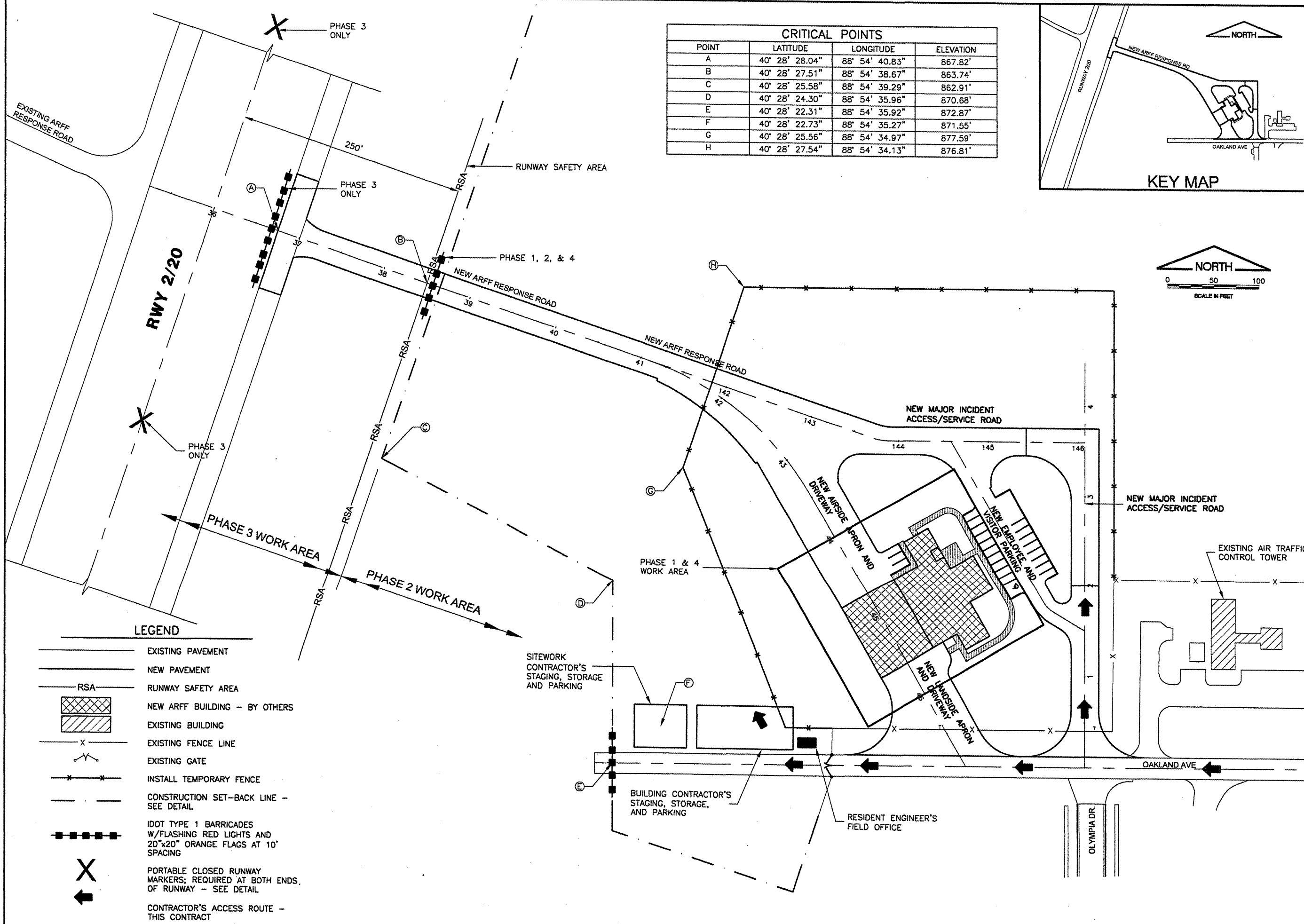

LEGEND

- EXISTING PAVEMENT
- NEW PAVEMENT
- RSA
- NEW ARFF BUILDING - BY OTHERS
- EXISTING BUILDING
- EXISTING FENCE LINE
- EXISTING GATE
- INSTALL TEMPORARY FENCE
- CONSTRUCTION SET-BACK LINE - SEE DETAIL
- IDOT TYPE 1 BARRICADES W/FLASHING RED LIGHTS AND 20"x20" ORANGE FLAGS AT 10' SPACING
- PORTABLE CLOSED RUNWAY MARKERS; REQUIRED AT BOTH ENDS OF RUNWAY - SEE DETAIL
- CONTRACTOR'S ACCESS ROUTE - THIS CONTRACT

BLOOMINGTON-NORMAL AIRPORT AUTHORITY
 CENTRAL ILLINOIS REGIONAL AIRPORT
 BLOOMINGTON, ILLINOIS

CONSTRUCT NEW ARFF FACILITY
 CONSTRUCTION ACTIVITY PLAN

© Copyright CMT, Inc.
CMT
 CRAWFORD, MURPHY & TILLY, INC.
 CONSULTING ENGINEERS
 License No. 184-000613



DESIGN BY:	RLV
DRAWN BY:	DPA
CHECKED BY:	RLV
APPROVED BY:	RLV
DATE:	04/01/2008
JOB No:	0508509
IL PROJ. NO. BMI-3797	
AIP PROJ. NO. 3-17-0006-46 & 48	
SHEET 04 OF 66 SHEETS	

MAXIMUM EQUIPMENT HEIGHT = 25'