

**EROSION CONTROL BLANKET NOTES**

AN EROSION CONTROL MATERIAL (EXCELSIOR BLANKET) EIGHT FEET IN WIDTH WILL BE INSTALLED AT THE SHOULDER ADJUSTMENT LOCATIONS ADJACENT TO THE EDGE OF THE PAVEMENT AS SHOWN ON THIS SHEET AND IN ACCORDANCE WITH THE SPECIAL PROVISIONS.

THIS ITEM OF WORK SHALL BE PAID FOR UNDER ITEM AR156531 "EROSION CONTROL BLANKET" \_\_\_\_\_ PER S.Y.

**UNCLASSIFIED EXCAVATION NOTE**

A SURPLUS OF EXCAVATED MATERIAL WILL REMAIN FOLLOWING THE FINAL GRADING FOR THE PROJECT WHICH IS PLANNED TO BE DISTRIBUTED ON SITE, IN AN ADJACENT AREA OF AGRICULTURAL GROUND - SEE SHEET 3 FOR WASTE AREA LOCATION. THE SOIL WILL BE EVENLY DISTRIBUTED OVER AN AREA APPROXIMATELY 125'X275', AND SHALL BE SPREAD SO THAT MINIMAL CHANGE OCCURS TO THE EXISTING CONTOURS IN THE AREA. THE WASTE AREA SHALL NOT BE COMPACTED BUT SHALL BE LIGHTLY DISCED TO REDUCE THE TYPICAL TEXTURE OF THE SURFACE TO THAT WHICH CURRENTLY EXISTS IN THE FIELD AT THE TIME OF CONSTRUCTION. NO SEEDING OR MULCHING IS EXPECTED IN THE WASTE AREA. THE AMOUNT EXPECTED TO REQUIRE HAUL TO THE WASTE AREA IS APPROXIMATELY 550 CY OF TOPSOIL QUALITY MATERIAL, BUT WILL DEPEND ON THE AMOUNT THE MATERIAL COMPACTS WHEN PLACED AS FILL DURING CONSTRUCTION. REGARDLESS OF AMOUNT USED DURING CONSTRUCTION, THE HAUL AND DISTRIBUTION OF THE REMAINING WASTE MATERIAL SHALL BE CONSIDERED INCIDENTAL TO ITEM AR152410 UNCLASSIFIED EXCAVATION AND NO ADDITIONAL COMPENSATION WILL BE ALLOWED. ALL WASTE MATERIAL PLACED IN THE WASTE AREA SHALL BE FREE OF ANY PAVEMENT, AGGREGATE, OR CONSTRUCTION DEBRIS. ALL EXCAVATED MATERIAL THAT DOES CONTAIN PAVEMENT, AGGREGATE, OR CONSTRUCTION DEBRIS SHALL BE HAULED OFF SITE AT NO ADDITIONAL COST TO THE PROJECT.

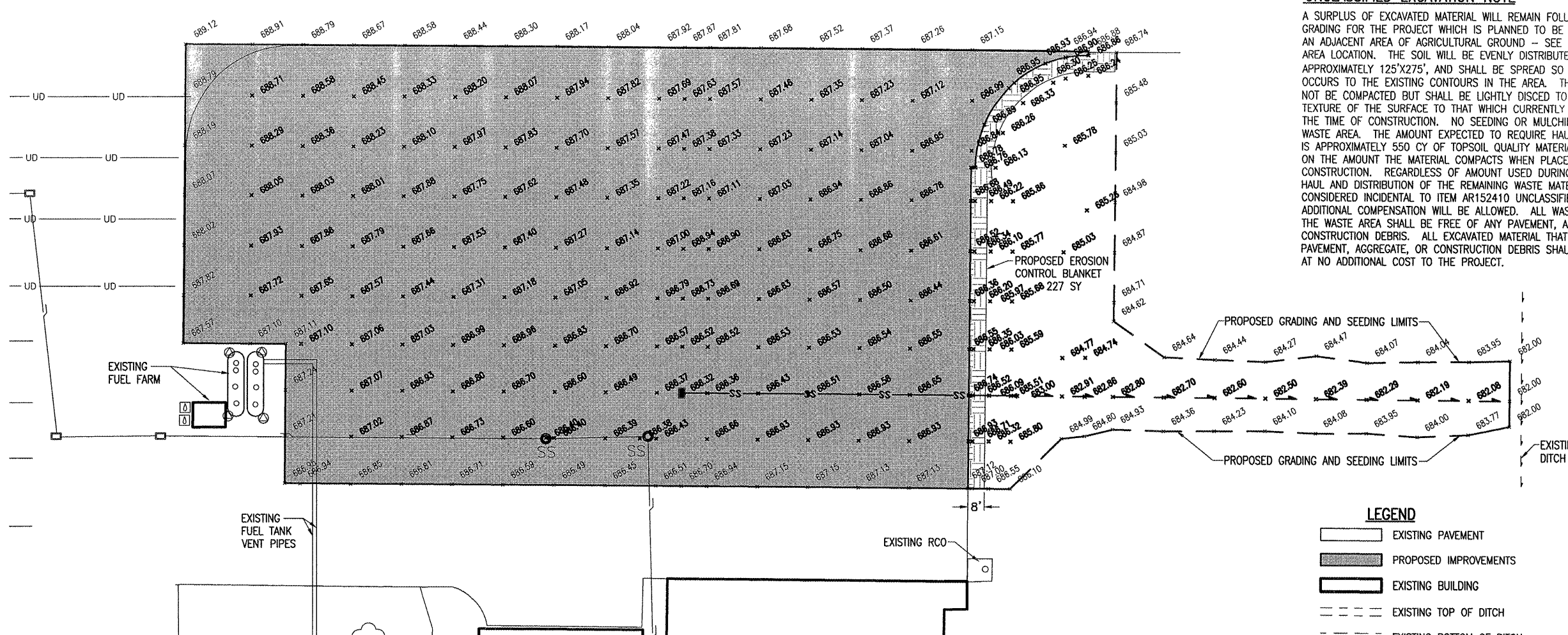

- LEGEND**
- EXISTING PAVEMENT
  - PROPOSED IMPROVEMENTS
  - EXISTING BUILDING
  - EXISTING TOP OF DITCH
  - EXISTING BOTTOM OF DITCH
  - EXISTING UNDERDRAIN
  - EXISTING STORM SEWER
  - EXISTING UNDERGROUND FUEL TANK
  - EXISTING INLET
  - EXISTING STORM SEWER MANHOLE (TO BE ADJUSTED)
  - EXISTING FUEL PUMP
  - EXISTING FUEL MONITORING WELL
  - PROPOSED EROSION CONTROL BLANKET
  - PROPOSED GRADING AND SEEDING LIMITS
  - PROPOSED STORM SEWER
  - PROPOSED DITCH
  - EXISTING GRADE
  - PROPOSED GRADE
  - PROPOSED INLET
  - PROPOSED FLARED END SECTION

**901 SEEDING NOTES**

THE PROPOSED SEEDING SHALL BE ACCOMPLISHED IN ACCORDANCE WITH ITEM 901 "SEEDING" AS STATED ON PAGE 120 OF THE SUPPLEMENTAL SPECIFICATIONS AND RECURRING SPECIAL PROVISIONS, ADOPTED JULY 1, 2004.

ALL DISTURBED AREAS LOCATED WITHIN THE PROPOSED GRADING AND SEEDING LIMITS WILL BE SEEDING IN ACCORDANCE WITH THE ABOVE NOTED SPECIFICATION. ALL AREAS OUTSIDE THE DESIGNATED GRADING AND SEEDING LIMITS WILL ALSO BE SEEDING BUT AT THE CONTRACTOR'S OWN EXPENSE.

ALL MATERIALS AND/OR DEBRIS RESULTING FROM THE SEEDING OPERATIONS WILL BE REMOVED FROM THE PAVEMENTS AND MISCELLANEOUS STRUCTURES PRIOR TO OPENING THE RUNWAY.

901-3.4 MAINTENANCE OF SEEDED AREAS. DELETE THE SECOND PARAGRAPH OF THIS SECTION AND ADD THE FOLLOWING:

"THE CONTRACTOR WILL BE REQUIRED TO ESTABLISH A GOOD STAND OF GRASS OF UNIFORM COLOR AND DENSITY TO THE SATISFACTION OF THE RESIDENT ENGINEER. IF AT THE TIME WHEN THE CONTRACT HAS BEEN OTHERWISE COMPLETED, IT IS NOT POSSIBLE TO MAKE AN ADEQUATE DETERMINATION OF COLOR, DENSITY, AND UNIFORMITY OF SUCH STAND OF GRASS, THE ITEM OF WORK WILL BE REVIEWED AT A LATER DATE DETERMINED BY THE ILLINOIS DIVISION OF AERONAUTICS."

DATE SEEDING COMPLETED \_\_\_\_\_

THE PROPOSED SEEDING WILL BE PAID FOR UNDER ITEMS:  
AR901510 SEEDING \_\_\_\_\_ PER ACRES

**908 MULCHING NOTES**

THE PROPOSED MULCHING SHALL BE ACCOMPLISHED IN ACCORDANCE WITH ITEM 908 "MULCHING" AS STATED ON PAGE 127 OF THE SUPPLEMENTAL SPECIFICATIONS AND RECURRING SPECIAL PROVISIONS, ADOPTED JULY 1, 2004.

THIS ITEM SHALL CONSIST OF THE FURNISHING, TRANSPORTING, AND PLACING MULCH OVER THE SEEDING AREA. DISTURBED AREAS OUTSIDE THE GRADING LIMITS SHALL ALSO BE MULCHED AND PARTICIPATION WILL BE THE SAME AS FOR SEEDING AREAS.

908-2.1 MULCH MATERIAL: THE CONTRACTOR SHALL USE HYDROMULCH EXCLUSIVELY AS THE TYPE OF MULCH MATERIAL TO BE USED ON THIS PROJECT.

908-3.1 MULCHING: THE HYDRAULIC MULCH SHALL BE APPLIED AS A SLURRY OF 2,500 POUNDS OF MULCH AND NOT LESS THAN 2,500 GALLONS OF WATER PER ACRE.

908-3.4 STRUCTURE CLEANING: AFTER THE PROPOSED MULCH HAS BEEN APPLIED, THE CONTRACTOR WILL CLEAN THE MULCH OFF ALL STRUCTURES (DRAINAGE, ELECTRICAL, LIGHTS, ETC.).

DATE MULCHING COMPLETED \_\_\_\_\_

THE PROPOSED MULCHING WILL BE PAID FOR UNDER ITEMS:  
AR908510 MULCHING \_\_\_\_\_ PER ACRES

DATE	REVISION	BY

**MACOMB MUNICIPAL AIRPORT  
MACOMB, ILLINOIS**

A.I.P. PROJ.: 3-17-0064-B16  
IL PROJ.: MOB-3798

HANSON Professional Services Inc. 1525 South St. Ste. 2086 Springfield, Illinois 62708-2886 Offices Nationwide	HANSON PROFESSIONAL SERVICES INC. 1525 SOUTH ST. STE. 2086 SPRINGFIELD, ILLINOIS 62708-2886 OFFICES NATIONWIDE
--	--

**CONSTRUCT  
RAMP EXPANSION**

**PROPOSED  
STAKING  
PLAN**

APR 24, 2008 5:16 PM WALLE00723  
 I:\AIRPORTS\MACOMB\08A0004\DESIGN\CADD\SHEETS\R-191\STK.DWG - Layout1