

FORESTER PRIVY  
LIGHTING FIXTURE AND ARM TO BE  
REMOVED AND REPLACE ON EXISTING  
POLE (SEE DETAIL)

FIELD VERIFY LOCATION

**BILL OF MATERIALS - FORESTER**

ITEM	UNIT	TOTAL
FURNISHED EXCAVATION	CU YD	91
TOPSOIL FURNISH AND PLACE, 4"	SQ YD	1,092
GRADING AND SHAPING DITCHES	FOOT	35
TEMPORARY DITCH CHECKS	FOOT	8
INLET AND PIPE PROTECTION	EACH	1
LEVELING BINDER (MACHINE METHOD), 1L-9.5 FG, N50	TON	5.2
HOT-MIX ASPHALT SURFACE COURSE, MIX "C", N50	TON	264.9
AGGREGATE WEDGE SHOULDER, TYPE B	TON	17.6
SIGN PANEL - TYPE 1	SQ FT	14
WOOD SIGN SUPPORT	FOOT	31
PAINT PAVEMENT MARKING - LINE 4"	FOOT	1,440
REMOVE EXISTING PARKING BLOCKS	EACH	46
PRECAST CONCRETE PARKING BLOCK	EACH	45
AGGREGATE SHOULDERS (SPECIAL)	TON	7.1
PIPE CULVERTS TO BE CLEANED 12"	FOOT	40
LUMINAIRE (SPECIAL)	EACH	1
BITUMINOUS MATERIALS (PRIME COAT)	POUND	1,084

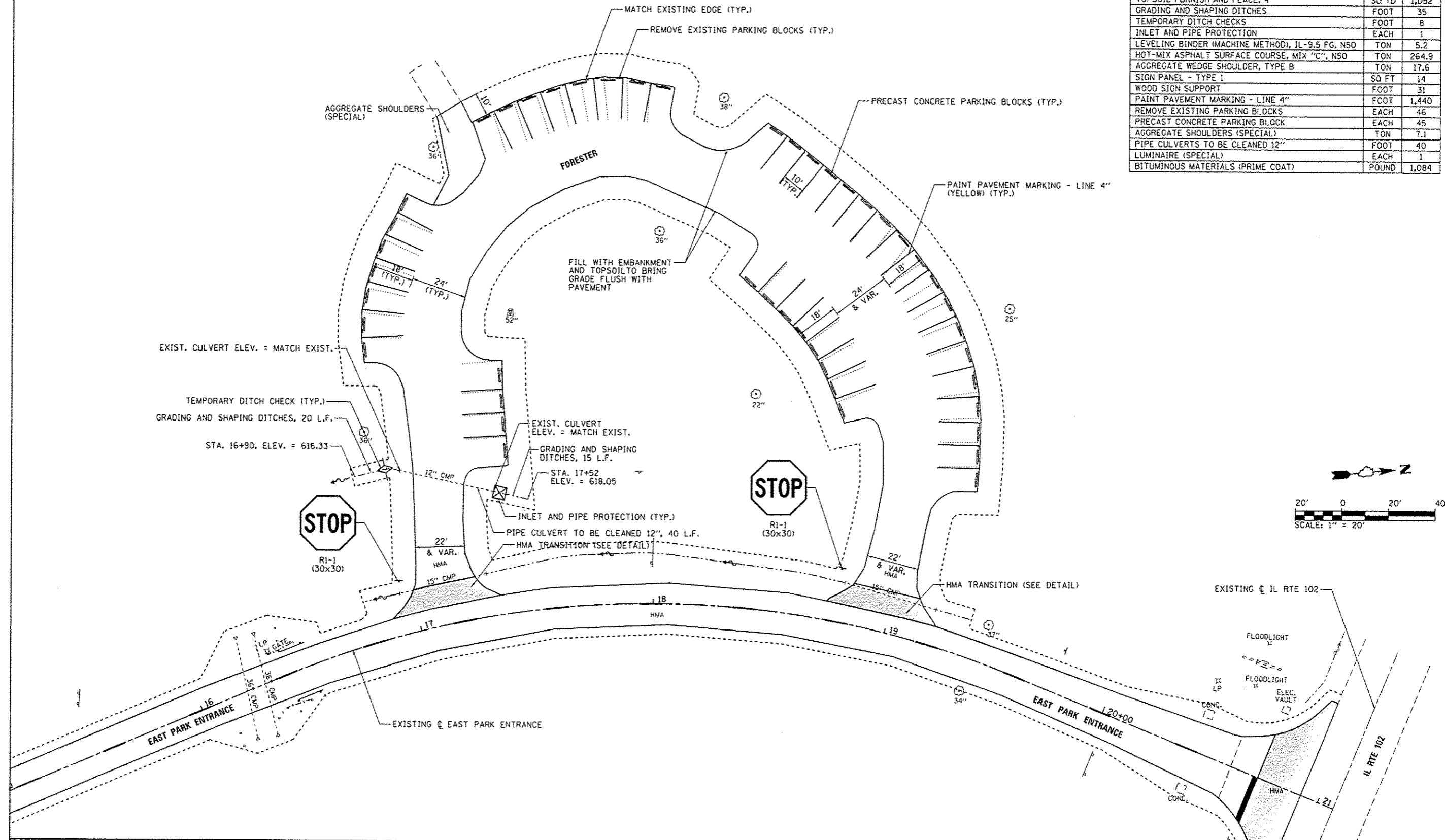

FILE NAME	USER NAME = Brad Downen	DESIGNED - MJO	REVISED -	<b>STATE OF ILLINOIS DEPARTMENT OF TRANSPORTATION</b>	<b>SITE PLAN - FORESTER KANKAKEE RIVER STATE PARK</b>	F.A. RTE.	SECTION	COUNTY	TOTAL SHEETS	SHEET NO.
L:\1001\1106618\WG.17\Draw\CADD_Sheets\046302.dwg Forester-SitePlan.dgn	DRAWN - RAH	REVISED -				• WILL AND KANKAKEE	CONTRACT NO. 46302			
Default	PLOT SCALE = 48.0000 1/4 in.	CHECKED - BJD	REVISED -			ILLINOIS FED. AID PROJECT				
	PLOT DATE = 3/28/2014	DATE - 3/28/2014	REVISED -			SCALE: 1" = 20'	SHEET 1 OF 1 SHEETS			
						STA. TO STA.				