

Stage 1- Jefferson Street- Sheet 2/2

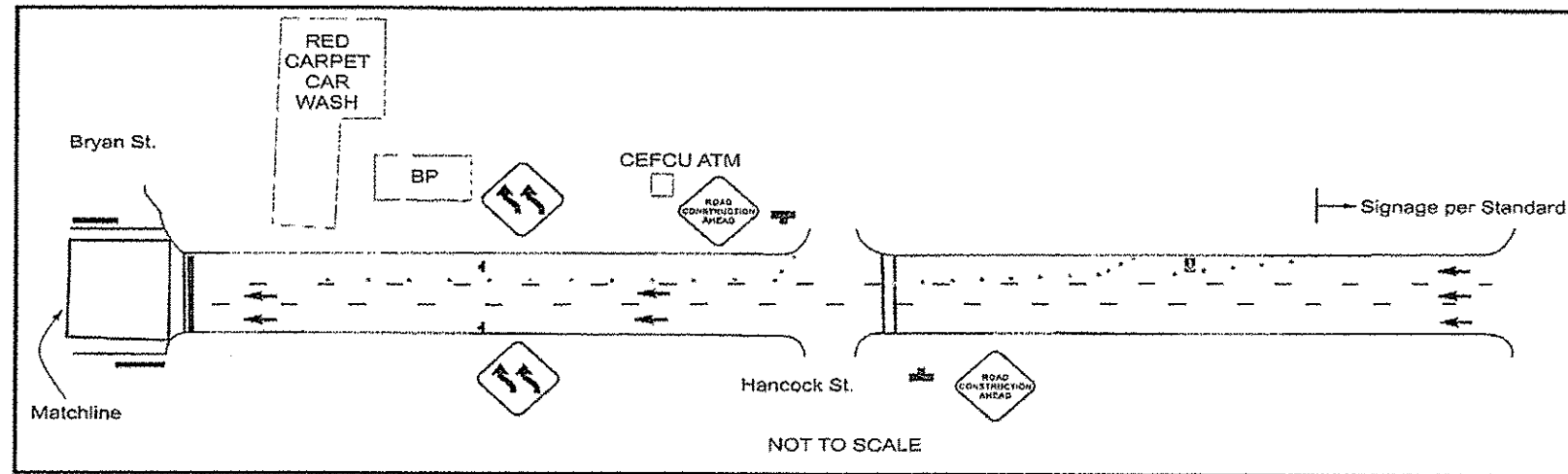

General Notes:

The USPS shall be contacted in regards to temporarily removing from service the mail drop-box.

Conflicting pavement markings (within the travelled lanes) shall be covered with black-out tape-Type III 4".

(NOTE: Some plane sheets show conflicting marking from existing layout on the proposed layout- ALL CONFLICTING PAVEMENT MARKINGS SHALL BE COVERED FROM VIEW.)

Any conflicting signs shall be covered from view.

Jefferson St. Traffic Control and Protection is based on Std. 701601. Std 701601 shall be used as a reference and to supplement details shown.

Std. 701801 shall also be utilized for the sidewalk closures

Sign spacing shall be 200' or greater.

All devices shall be lit with mono-directional lighting, unless specified otherwise.

Taper devices spaced at 20' cts. Longitudinal devices spaced at 25' cts.

Flaggers are not required due to speed but are encouraged when placing traffic control, placing barrier, and at other times which will provide a safer condition for work activities close to live traffic.

All signage, excluding pedestrian sidewalk signage, shall be stand mounted with a minimum road to sign height of 7'.

PCMS from Adams St. shall be utilized on Jefferson St. Placement and message to be discussed on project.

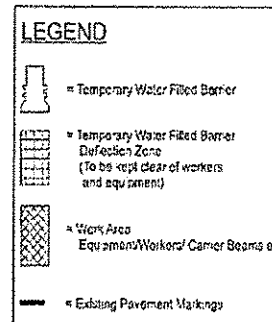
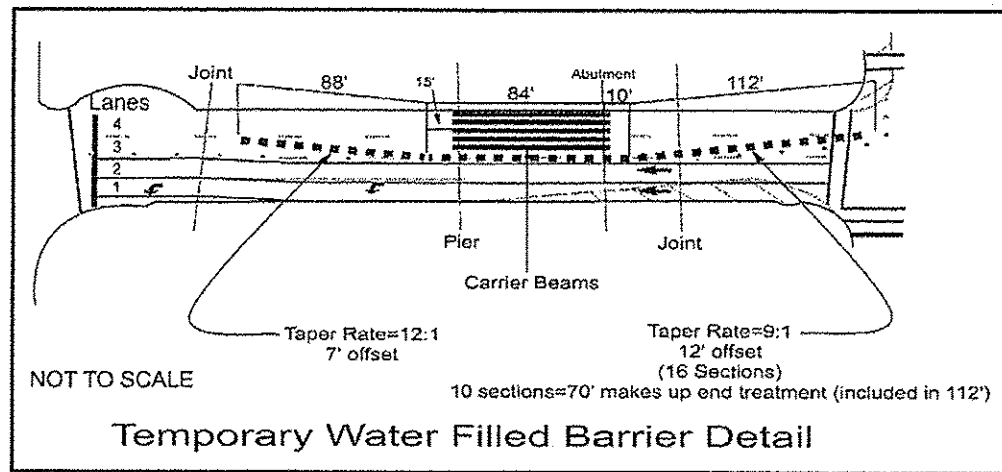

Pre Stage 1: NOT SHOWN

This stage will allow the drilling of the carrier beam support holes.

Set-up Std 701601 (double lane closure).

Lane closure restrictions:

Lanes 3 & 4 (together) - shall not start prior to 8:30 am. Lane 4 shall be closed without restriction.

Pre Stage 1A: NOT SHOWN

This stage will allow the covering & placement of pavement markings to facilitate Stage 1 work.

Set-up Std 701601 shall be utilized for Lane 2. (Closing Lane 2 also closes Lane 1.) An exit taper for access to southbound Fayette St. shall be provided for the travelling public.

Lane closure restrictions:

Lanes 1 & 2 - shall not start prior to 8:30 am.

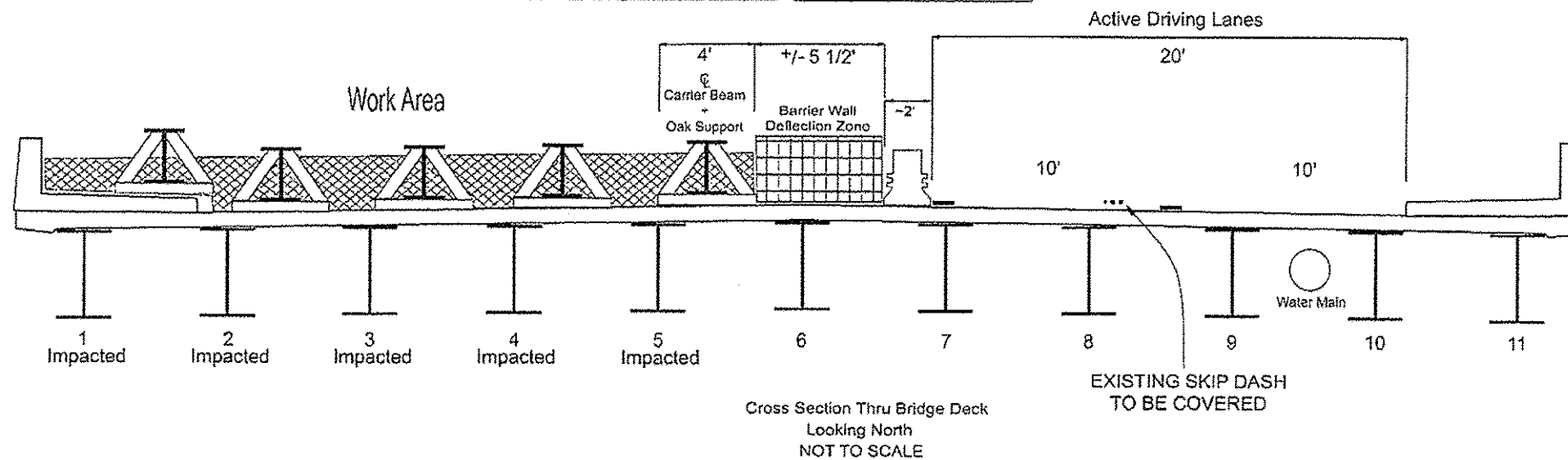

S:\GEN-DRG\T-5105\PLNS-Scans\BRIDGES-BRIDGE_CONTRACTS-DAYL\005-SLT-9A-001-14_58072-0179-0182.dgn

FILE NAME * 46323 T.C.S.P.dgn	USER NAME * jonesco	DESIGNED - CEJ	REVISED - ---	STATE OF ILLINOIS DEPARTMENT OF TRANSPORTATION	PROPOSED TRAFFIC CONTROL JEFFERSON AVE. OVER I-74 SN. 072-0179	F.A.I. RTE.	SECTION	COUNTY	TOTAL SHEET SHEETS	NO.
PLOT SCALE * 102.9463 1/4"	DRAWN - CEJ	REVISED - ---	1-74			172-9-HBIBR	PEORIA	12	12	
PLOT DATE * 5/5/2014	CHECKED - ---	REVISED - ---	STEEL GIRDER REP./REPL.			CONTRACT NO.	46323			
DATE - 03/10/2014	REVISED - ---	REVISED - ---	FED. ROAD DIST. NO. 4			ILLINOISIFIED, AID PROJECT				