

NORTHWEST WINGWALL ELEVATION

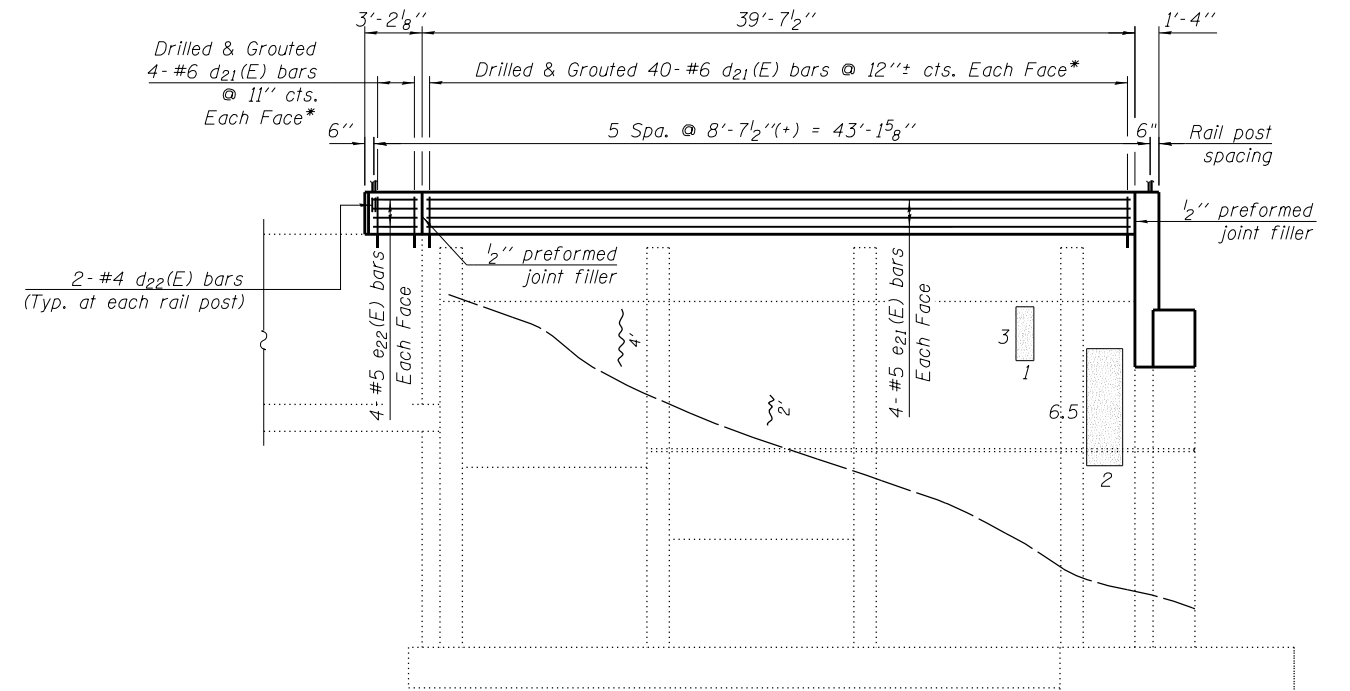

NORTHEAST WINGWALL ELEVATION

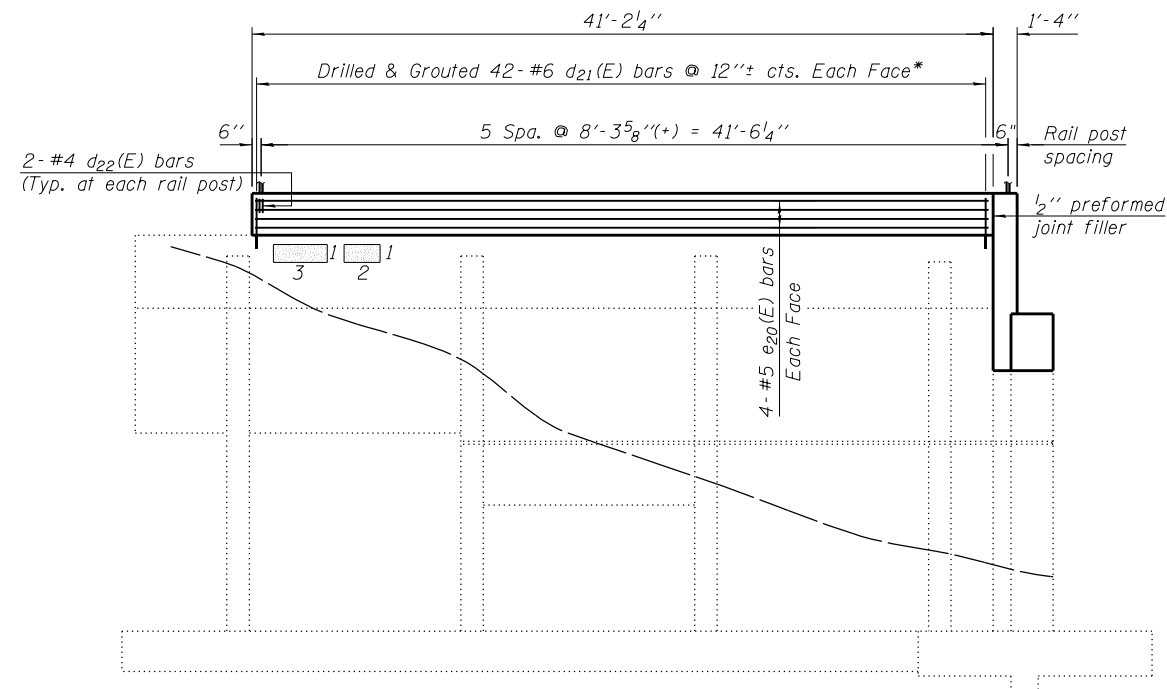

SOUTHWEST WINGWALL ELEVATION

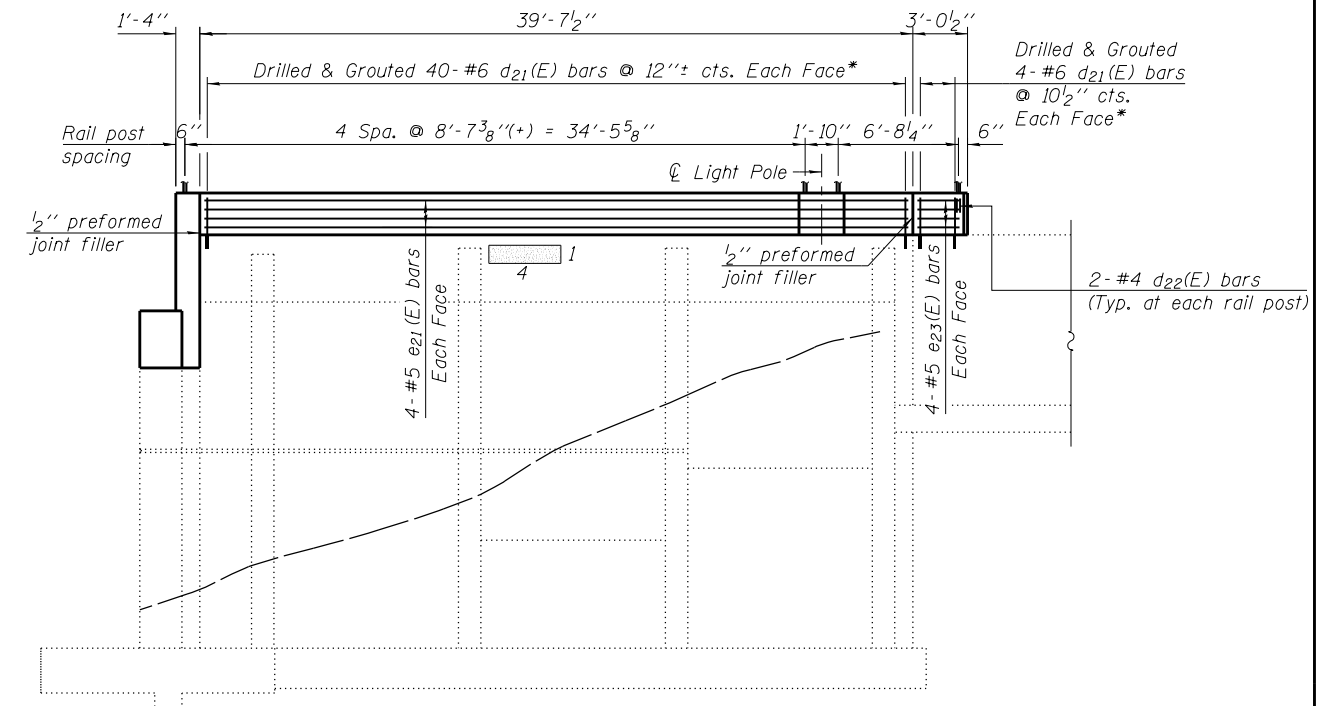

SOUTHEAST WINGWALL ELEVATION

LEGEND

- Structural Repair of Concrete (Depth Equal to or Less than 5")
- Epoxy Crack Injection

NOTE

*Epoxy grout d₂₁(E) bars in 12" (min.) drilled holes according to Article 584 of the Standard Specifications.

H:\projects\2011\0223\CAD\Structure\dwg\06-1149-Final\00\Di60J15-s36-ww-rwp2.dgn 3/27/2014 4:55:51PM

USER NAME =	DESIGNED - J.Z.	REVISED -
	CHECKED - J.A.Z.	REVISED -
PLOT SCALE =	DRAWN - E.E.J.	REVISED -
PLOT DATE =	DATE - 3/31/2014	REVISED -

F.A.I. RTE.	SECTION	COUNTY	TOTAL SHEETS	SHEET NO.
94	1920-B	COOK	142	100
CONTRACT NO. 60J15				