

CONSTRUCTION NOTES

* FAR-OUT DETECTION SHALL BE PROVIDED AT APPROX. 250' FROM THE STOP BAR OR AS DIRECTED BY THE ENGINEER.

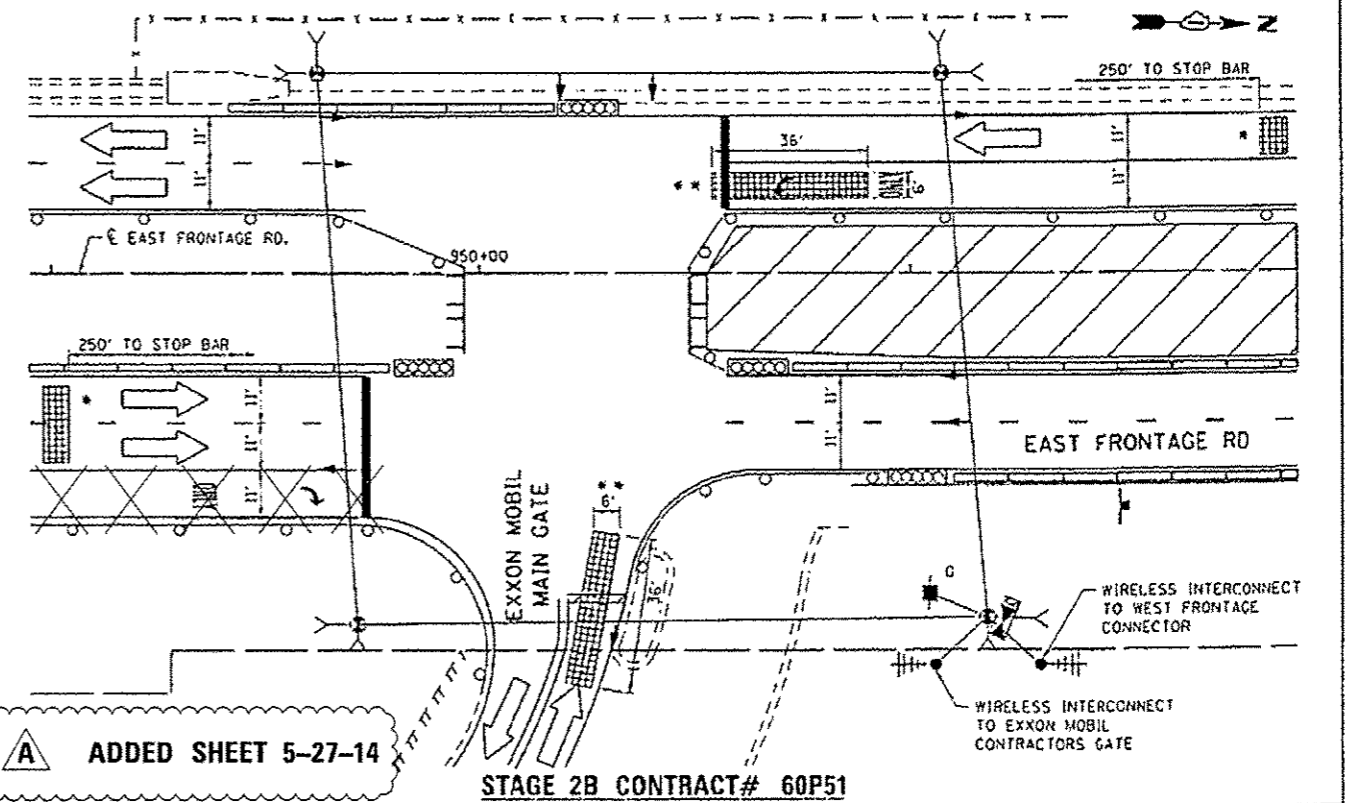
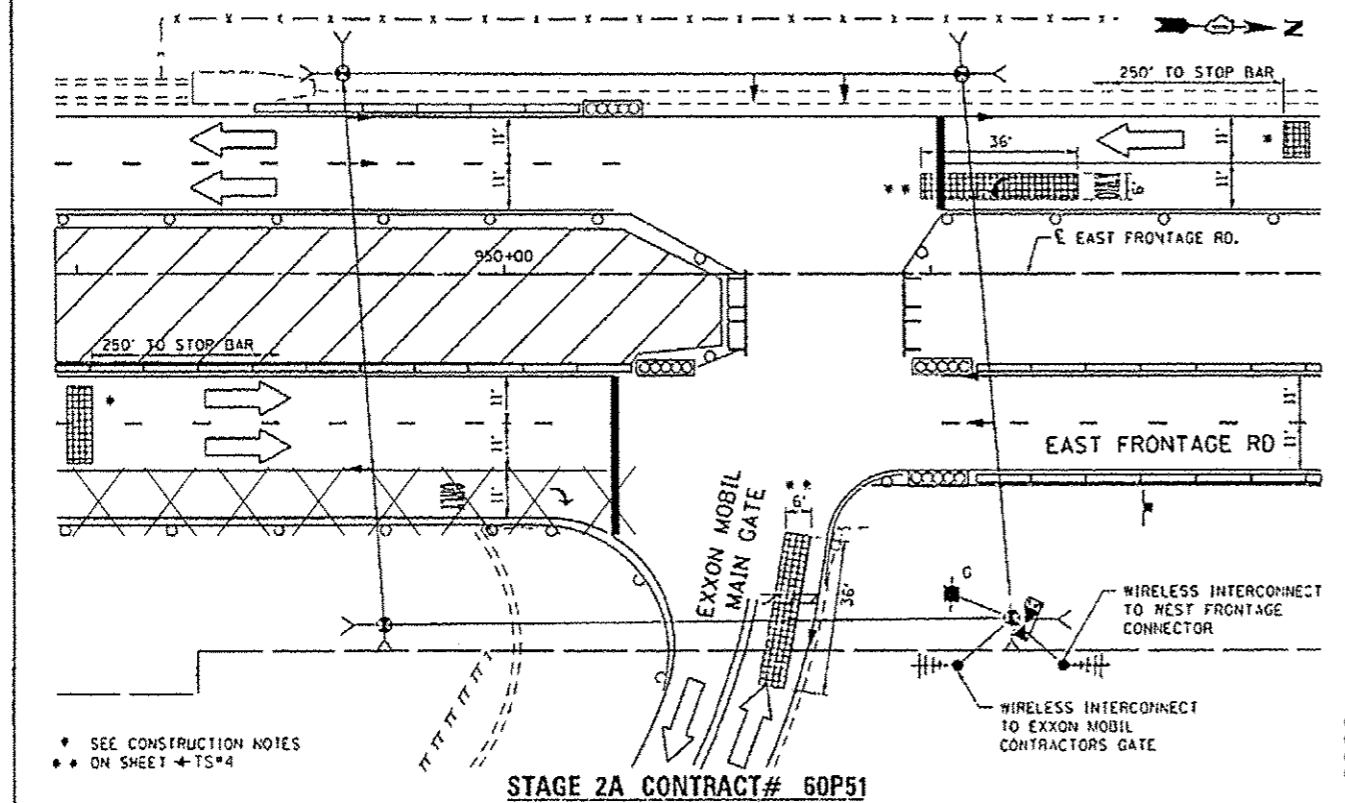

A ADDED SHEET 5-27-14

FILE NAME	USER NAME = B126K4	DESIGNED - LP	REVISED - LP 12/04/2012
FILE #		DRAWN - LP	REVISED - JU 09/20/2013
MODEL NAME	PLOT SCALE = 1/8"=1'-0"	CHECKED - PB / SW	REVISED - JU 10/02/2013
	PLOT DATE = 02/16/14	DATE - 11/16/2012	REVISED -

WILL COUNTY DEPARTMENT OF HIGHWAYS

TEMPORARY SPAN WIRE TRAFFIC SIGNAL INSTALLATION STAGE 1A, 1B, 2A AND 2B (CONTRACT# 60P51) EAST FRONTAGE RD AT EXXON MOBIL MAIN GATE

F.A. RTE.	SECTION	COUNTY	TOTAL SHEETS	SHEET NO.
55	99-IAC-2	WILL	102	721
CONTRACT NO. 60P51				
ILLINOIS FED. AID PROJECT				

FILE NAME	USER NAME = B12IP	DESIGNED - LP	REVISED -
S:\JDL\6300-0399\6346\045\micr\05\CA00	Sheets\0120007-sh1-ts.dgn	DRAWN - LP	REVISED -
Default	PLOT SCALE = 1/8"=1'-0"	CHECKED - IP	REVISED -
	PLOT DATE = 5/27/2014	DATE - 05/21/2014	REVISED -

STATE OF ILLINOIS DEPARTMENT OF TRANSPORTATION

TEMPORARY SPAN WIRE TRAFFIC SIGNAL INSTALLATION STAGE 1A, 1B, 2A AND 2B EAST FRONTAGE RD AT EXXON MOBIL MAIN GATE

F.A. RTE.	SECTION	COUNTY	TOTAL SHEETS	SHEET NO.
55	99-IAC-2	WILL	102	721
CONTRACT NO. 60P51				
ILLINOIS FED. AID PROJECT				