

SOUTH  
ABUTMENT

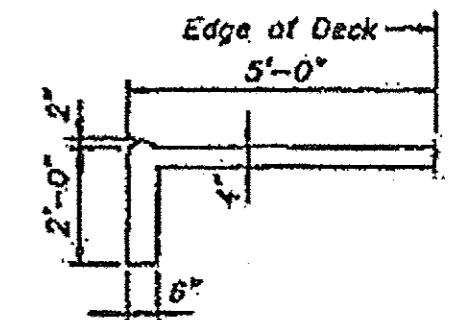
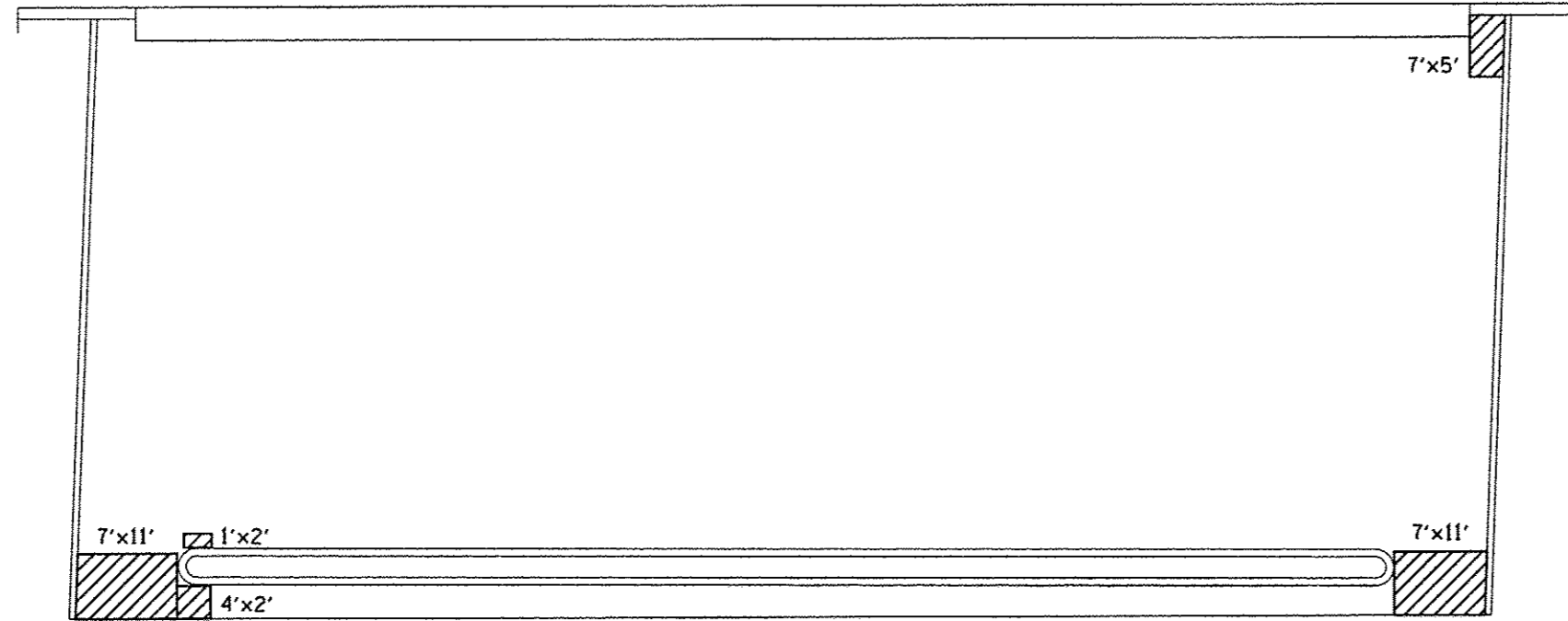

**SECTION A-A**

PIER 1

NOTE: EXISTING WELDED WIRE FABRIC  
MUST OVERLAY NEW WIRE FABRIC BY 6".

PIER 2

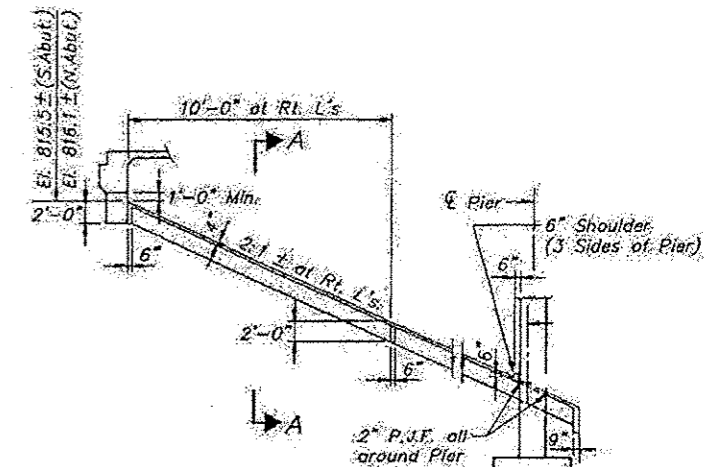
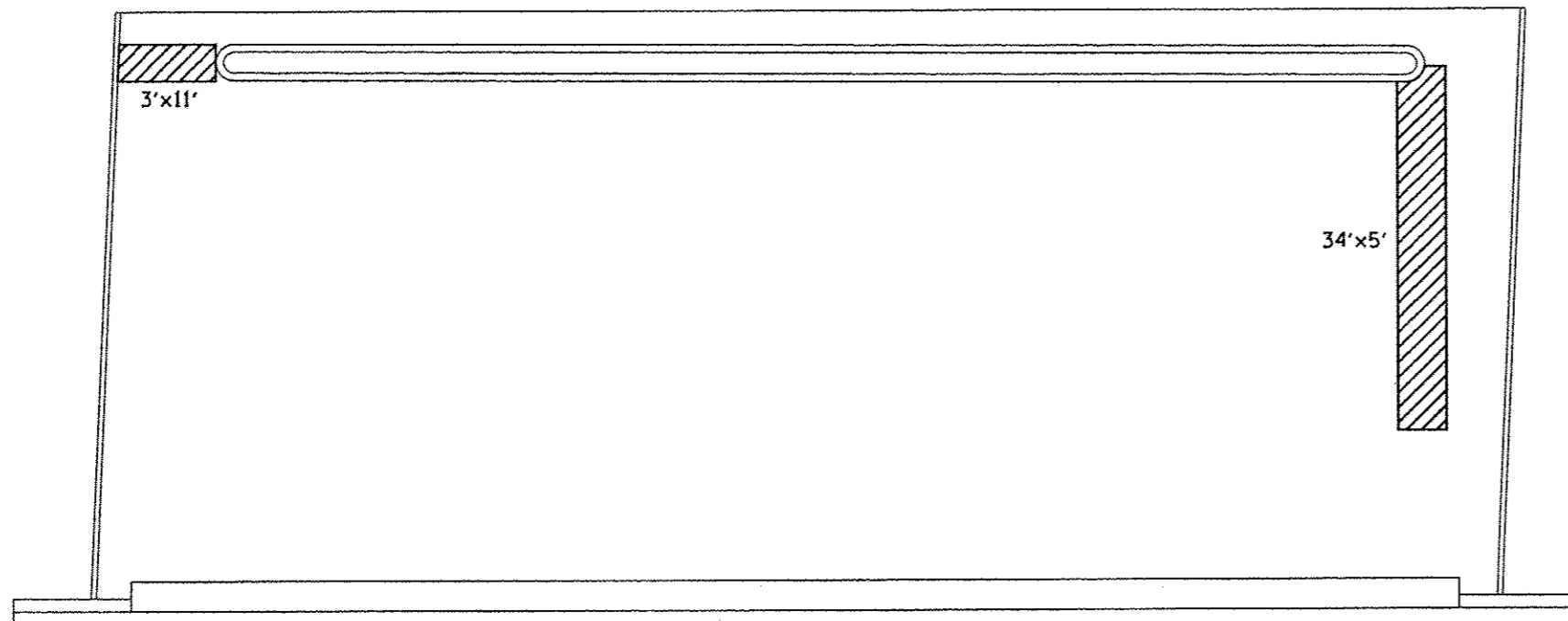

**SECTION THRU SLOPE WALL**

**LEGEND:**

SLOPE WALL REMOVAL &  
SLOPE WALL 4 INCH

**BILL OF MATERIAL**

| Item               | Unit  | Total |
|--------------------|-------|-------|
| SLOPE WALL REMOVAL | 50 YD | 45    |
| SLOPE WALL 4 INCH  | 50 YD | 45    |

NORTH  
ABUTMENT