

FEDERAL AID PROGRAM ENGINEER: FAWAD AQUEEL, P.E. 847-705-4021, SCHAUMBURG, IL.
CONSULTANTS: ROBINSON ENGINEERING, LTD. 708-331-6700

INDEX OF SHEETS

1. COVER SHEET, INDEX OF SHEETS & STATE STANDARDS
2. SUMMARY OF QUANTITIES & GENERAL NOTES
3. TYPICAL SECTIONS
- 4.-6. PAVEMENT PLAN
- 7.-9. PAVEMENT MARKING PLAN
- 10.-13. IDOT DISTRICT 1 STANDARD DETAILS

HIGHWAY STANDARDS

- 000001-06 STANDARD SYMBOLS, ABBREVIATIONS AND PATTERNS
- 424001-07 PERPENDICULAR CURB RAMPS FOR SIDEWALKS
- 442201-03 CLASS C AND D PATCHES
- 701201-04 LANE CLOSURE, 2L, 2W, DAY ONLY, FOR SPEEDS > 45 MPH
- 701301-04 LANE CLOSURE, 2L, 2W, SHORT TIME OPERATIONS
- 701306-03 LANE CLOSURE, 2L, 2W, SLOW MOVING OPERATIONS DAY ONLY, FOR SPEEDS > 45 MPH
- 701311-03 LANE CLOSURE, 2L, 2W MOVING OPERATIONS-DAY ONLY
- 701901-03 TRAFFIC CONTROL DEVICES
- 780001-04 TYPICAL PAVEMENT MARKINGS

	BRUNS ROAD WEST OF ROUTE 52	BRUNS ROAD EAST OF ROUTE 52
2008 ADT -	400	500
2040 ADT -	500	600
POSTED SPEED LIMIT -	45 mph	55 mph
DESIGN PERIOD -	20 YEARS	20 YEARS
DESIGN SPEED LIMIT -	50 mph	55 mph
STREET CLASSIFICATION -	MAJOR COLLECTOR	MAJOR COLLECTOR

PROJECT LOCATED IN THE VILLAGE OF MANHATTAN

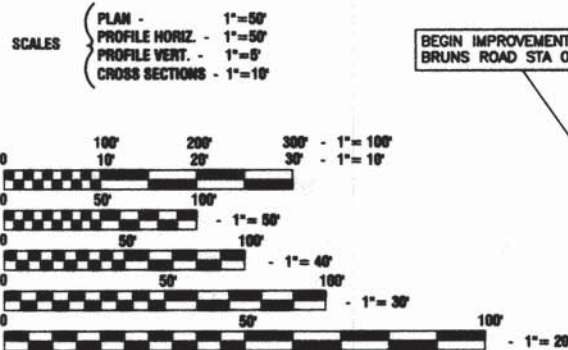

FULL SIZE PLANS HAVE BEEN PREPARED USING STANDARD ENGINEERING SCALES, REDUCED SIZED PLANS WILL NOT CONFORM TO STANDARD SCALES, IN MAKING MEASUREMENTS ON REDUCED PLANS, THE ABOVE SCALES MAY BE USED.

J. U. L. I. E.
JOINT UTILITY LOCATION INFORMATION FOR EXCAVATION
1-800-892-0123 or 811

CONTRACT NO. 61A51

STATE OF ILLINOIS 06-13-14 LETTING ITEM 051
DEPARTMENT OF TRANSPORTATION
DIVISION OF HIGHWAYS
**PLANS FOR PROPOSED
FEDERAL AID HIGHWAY**

**BRUNS ROAD (GALLAGHER ROAD)
GOUGAR ROAD TO FAU 0369 (CEDAR ROAD)
ROADWAY RESURFACING
SECTION NO.: 13-00013-00-RS
PROJECT NO.: M-4003 (288)
VILLAGE of MANHATTAN
WILL COUNTY
JOB NO.: C-91-230-14**

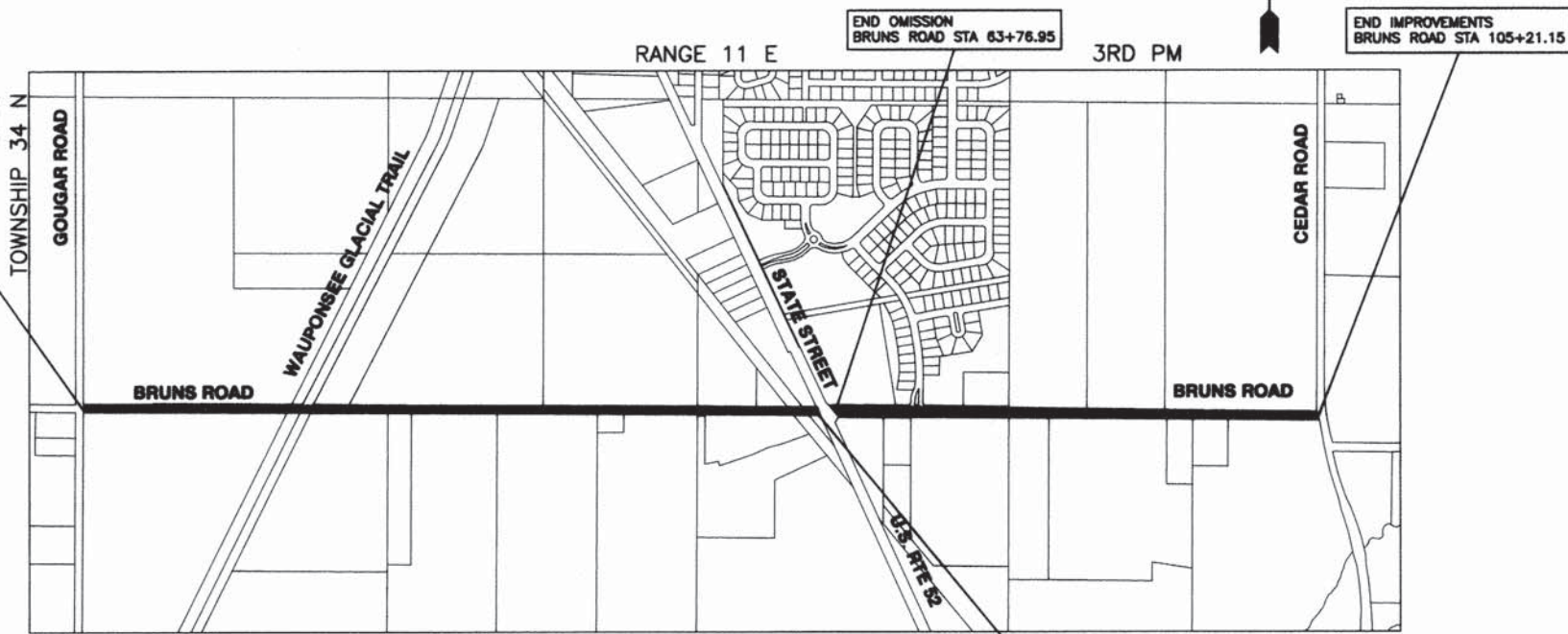

LOCATION MAP

GROSS LENGTH=10,468.31 FEET=1.983 MILES
NET LENGTH=9,368.24 FEET=1.774 MILES

F. A. U. REC.	SECTION	COUNTY	TOTAL SHEETS	SHEET NO.
	13-00013-00-RS	WILL	13	1
STA.	TO STA.			
FED. ROAD DIST. NO.	ILLINOIS	FED. AID PROJECT	M-4003 (288)	

CONTRACT #61A51

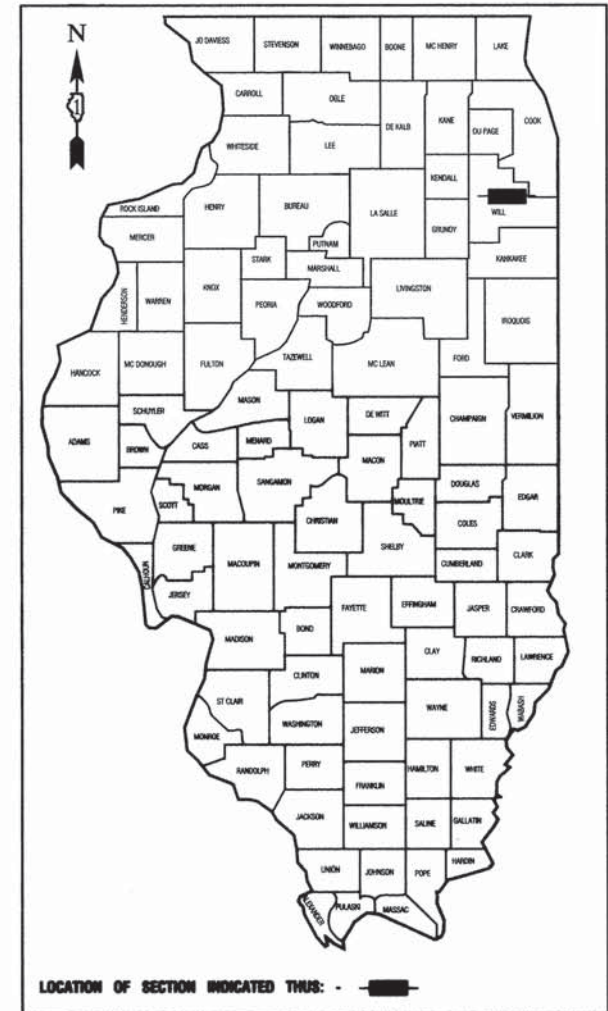

STATE OF ILLINOIS DEPARTMENT OF TRANSPORTATION
DIVISION OF HIGHWAYS

Approved: James M. Doyle
James M. DOYLE
Mayor, Village of MANHATTAN

Passed: APRIL 4 2014
CHRISTOPHER HERTOLT
District 1 Engineer of Local Roads & Streets

Released for Bid Based on Limited Review: April 17 2014
John F. Johnson
Deputy Director of Highways, Region 1 Engineer

PRINTED BY THE AUTHORITY OF THE STATE OF ILLINOIS

PREPARED BY OR UNDER THE DIRECT SUPERVISION OF:

Dana E Ludwig
3/20/14



LICENSE EXPIRES: 11/30/15

SUMMARY OF QUANTITIES					CONSTRUCTION TYPE CODE
S.I.	CODE NO.	PAY ITEM	UNIT	TOTAL QUANTITY	0005
	40600827	POLYMERIZED LEVELING BINDER (MACHINE METHOD), IL-4.75, N50	TON	937	937
	40600982	HOT-MIX ASPHALT SURFACE REMOVAL - BUTT JOINT	SQ YD	706	706
	40603335	HOT-MIX ASPHALT SURFACE COURSE, MIX "D", N50	TON	3301	3301
	42400400	PORTLAND CEMENT CONCRETE SIDEWALK 7 INCH	SQ FT	65	65
	42400800	DETECTABLE WARNINGS	SQ FT	48	48
	44000155	HOT-MIX ASPHALT SURFACE REMOVAL, 1 1/2"	SQ YD	9359	9359
	44000156	HOT-MIX ASPHALT SURFACE REMOVAL, 1 3/4"	SQ YD	14017	14017
	44000177	HOT-MIX ASPHALT SURFACE REMOVAL, 7"	SQ YD	65	65
	48102100	AGGREGATE WEDGE SHOULDER, TYPE B	TON	1037	1037
	44201692	CLASS D PATCHES, TYPE II, 4 INCH	SQ YD	33	33
	44201694	CLASS D PATCHES, TYPE III, 4 INCH	SQ YD	79	79
	44201696	CLASS D PATCHES, TYPE IV, 4 INCH	SQ YD	2080	2080
	67100100	MOBILIZATION	L SUM	1	1
	70100450	TRAFFIC CONTROL AND PROTECTION, STANDARD 701201	L SUM	1	1
	70100460	TRAFFIC CONTROL AND PROTECTION, STANDARD 701306	L SUM	1	1
	70300100	SHORT TERM PAVEMENT MARKING	FOOT	2888	2888
*	78000100	THERMOPLASTIC PAVEMENT MARKING LETTERS AND SYMBOLS	SQ FT	73	73
*	78000200	THERMOPLASTIC PAVEMENT MARKING - LINE 4"	FOOT	24925	24925
*	78000400	THERMOPLASTIC PAVEMENT MARKING - LINE 6"	FOOT	43	43
*	78000600	THERMOPLASTIC PAVEMENT MARKING - LINE 12"	FOOT	120	120
*	78000650	THERMOPLASTIC PAVEMENT MARKING - LINE 24"	FOOT	64	64
	X406.0110	BITUMINOUS MATERIALS (PRIME COAT)	POUNDS	74000	74000
	Z0013798	CONSTRUCTION LAYOUT	L SUM	1	1

GENERAL NOTES

- BEFORE STARTING ANY EXCAVATION THE CONTRACTOR SHALL CALL "J.U.L.I.E." AT (800) 892-0123 OR 811 AND (312) 744-7000 FOR FIELD LOCATIONS OF BURIED ELECTRIC, TELEPHONE AND GAS UTILITIES. (48 HOUR NOTIFICATION REQUIRED)
- UTILITIES INDICATED ON THE PLANS ARE PROVIDED FOR THE CONTRACTOR'S USE AND ARE BASED UPON INFORMATION AVAILABLE AT THE TIME OF THE ADVERTISEMENT FOR BIDS. THE OWNER AND ENGINEER DO NOT GUARANTEE THE ACCURACY OF UTILITY INFORMATION.
- IT SHALL BE THE CONTRACTOR'S RESPONSIBILITY TO VERIFY ALL DIMENSIONS AND CONDITIONS EXISTING IN THE FIELD PRIOR TO CONSTRUCTION AND ORDERING OF MATERIALS.
- THE THICKNESS OF HMA MIXTURE STATED IN THE SPECIFICATIONS IS THE NOMINAL THICKNESS. DEVIATIONS FROM THE NOMINAL THICKNESS WILL BE PERMITTED WHEN SUCH DEVIATIONS OCCUR DUE TO IRREGULARITIES IN THE EXISTING SURFACE OR BASE ON WHICH THE HMA SURFACE IS PLACED.
- ACCESS TO DRIVEWAYS SHALL BE MAINTAINED AT ALL TIMES BY LIMITING CURB AND GUTTER REPAIR TO ONE-HALF THE DRIVEWAY WIDTH AT ONE TIME AS WELL AS TEMPORARY AGGREGATE. ANY TEMPORARY AGGREGATE REQUIRED SHALL BE CONSIDERED INCLUDED IN THE COST OF THE RELATED PAY ITEM IT IS NEEDED FOR WHEN DIRECTED BY THE ENGINEER.
- THE REMOVAL AND/OR REPLACEMENT OF ANY DRIVEWAYS, PAVEMENT, CURB, SIDEWALK, ETC. SHALL BE ACCOMPLISHED BY MEANS OF A SAW CUT JOINT, AT THE DIRECTION OF THE ENGINEER. SAW CUTTING WILL NOT BE PAID FOR SEPARATELY, BUT SHALL BE INCLUDED IN THE UNIT PRICE FOR THE VARIOUS REMOVAL ITEMS.
- ANY LOOSE MATERIAL DEPOSITED IN THE FLOW LINE OF DITCHES, GUTTERS OR OTHER DRAINAGE STRUCTURES SHALL BE REMOVED BY THE END OF EACH DAY BY THE CONTRACTOR AT THEIR EXPENSE.
- THE CONTRACTOR SHALL LEAVE ANY CLEAN EXCESS ORGANIC FILL EXCAVATED DURING THE CURB AND GUTTER AND SIDEWALK REMOVAL AND REPLACEMENT OPERATIONS ON SITE. ANY EXCESS MATERIAL SHALL BE SPREAD OR PLACED AT LOCATIONS DETERMINED BY THE ENGINEER. THIS WORK WILL NOT BE PAID FOR SEPARATELY, BUT SHALL BE INCLUDED IN THE UNIT PRICE FOR THE VARIOUS REMOVAL AND REPLACEMENT ITEMS. RESTORATION OF AREAS WHERE EXCESS MATERIALS IS PLACED SHALL BE PAID FOR AS SEEDING (COMPLETE).
- ANY REMOVAL/REGRAVING OF THE STONE DRIVEWAYS TO BE OVERLAYED WILL NOT BE PAID FOR SEPARATELY BUT IS CONSIDERED INCIDENTAL TO THE CONTRACT.

* - INDICATES SPECIALTY ITEMS

FILE NAME = 09647_02-QUAN-01 - IDOT P01

USER NAME =	DESIGNED -- D.E.L.	REVISED --
	CHECKED -- H.L.G.	REVISED --
PLOT SCALE =	DRAWN -- ACAD	REVISED --
PLOT DATE =	CHECKED -- ACAD	REVISED --

STATE OF ILLINOIS
DEPARTMENT OF TRANSPORTATION

ROADWAY RESURFACING
BRUNS ROAD (GALLAGHER ROAD)
SUMMARY OF QUANTITIES

F.A.U. RTE.	SECTION	COUNTY	TOTAL SHEETS	SHEET NO.
	13-00013-00-RS	WILL	13	2
SCALE:			CONTRACT NO. 61A51	
SHEET NO. 2 OF 13 SHEETS			FED. ROAD DIST. NO. 1 ILLINOIS FED. AID PROJECT M-4003 (298)	

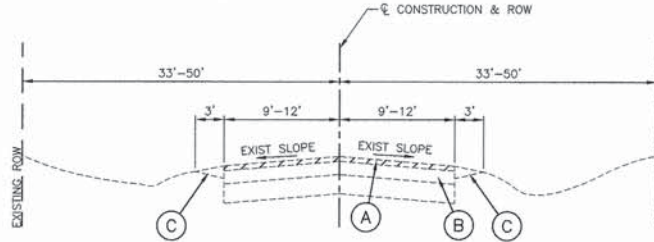

EXISTING TYPICAL SECTION
BRUNS ROAD
WEST OF ROUTE 52
GOUGAR ROAD TO CEDAR ROAD
STA. 0+52.84 TO STA. 62+76.88

- EXISTING LEGEND WEST OF ROUTE 52**
- (A) HOT MIX ASPHALT SURFACE REMOVAL, 1 3/4"
 - (B) EXISTING HOT-MIX ASPHALT PAVEMENT (4-5")
 - (C) EXISTING STONE SHOULDER

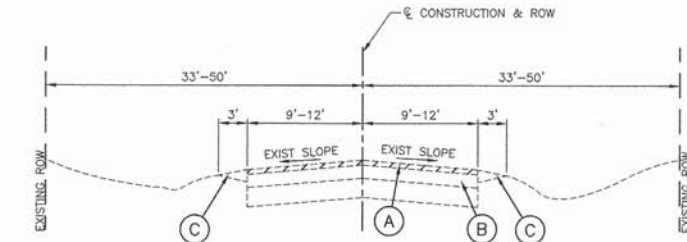

EXISTING TYPICAL SECTION
BRUNS ROAD
EAST OF ROUTE 52
GOUGAR ROAD TO CEDAR ROAD
STA. 63+76.95 TO STA. 105+21.15

- EXISTING LEGEND EAST OF ROUTE 52**
- (A) HOT MIX ASPHALT SURFACE REMOVAL, 1 1/2"
 - (B) EXISTING HOT-MIX ASPHALT PAVEMENT (4-5")
 - (C) EXISTING STONE SHOULDER

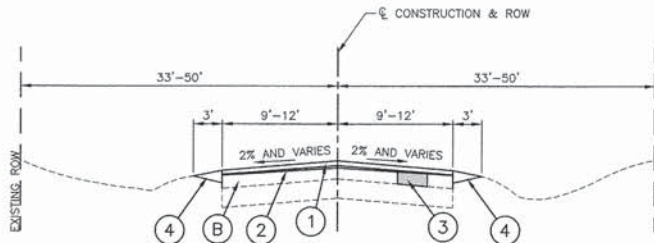

PROPOSED TYPICAL SECTION
BRUNS ROAD
WEST OF ROUTE 52
GOUGAR ROAD TO CEDAR ROAD
STA. 0+52.84 TO STA. 62+76.88
NOTE: CONTRACTOR SHALL MILL BEFORE PATCHING

- PROPOSED LEGEND WEST OF ROUTE 52**
- (1) HOT MIX ASPHALT SURFACE COURSE, MIX "D", N50, 3" (2 LIFTS)
 - (2) POLYMERIZED LEVELING BINDER (MACHINE METHOD), IL-4.75, N50, 3/4"
 - (3) CLASS D PATCH, 4" AT LOCATIONS SHOWN ON PLANS OR DIRECTED BY ENGINEER
 - (4) AGGREGATE WEDGE SHOULDER, TYPE B

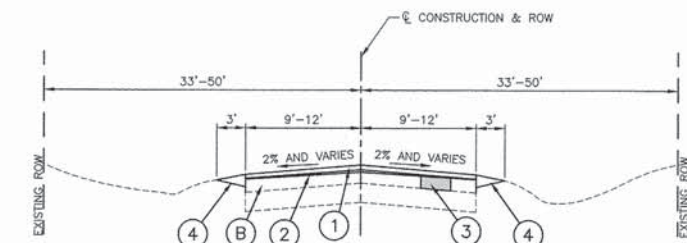

PROPOSED TYPICAL SECTION
BRUNS ROAD
EAST OF ROUTE 52
GOUGAR ROAD TO CEDAR ROAD
STA. 63+76.95 TO STA. 105+21.15
NOTE: CONTRACTOR SHALL MILL BEFORE PATCHING

- PROPOSED LEGEND EAST OF ROUTE 52**
- (1) HOT MIX ASPHALT SURFACE COURSE, MIX "D", N50, 2"
 - (2) POLYMERIZED LEVELING BINDER (MACHINE METHOD), IL-4.75, N50, 3/4"
 - (3) CLASS D PATCH, 4" AT LOCATIONS SHOWN ON PLANS OR DIRECTED BY ENGINEER
 - (4) AGGREGATE WEDGE SHOULDER, TYPE B

HOT-MIX ASPHALT MIXTURE REQUIREMENTS
(CONTRACTOR SHALL MILL BEFORE PATCHING)

MIXTURE TYPE	AIR VOIDS @ Ndes	QUALITY MANAGEMENT PROGRAM (QMP)
RESURFACING		
HOT-MIX ASPHALT SURFACE COURSE, MIX "D", N50, 3" (IL 9.5 MM) (2 LIFTS)	4% @ 50 Gyr.	QCP
HOT-MIX ASPHALT SURFACE COURSE, MIX "D", N50, 2" (IL 9.5 MM)	4% @ 50 Gyr.	QCP
POLYMERIZED LEVELING BINDER (MACHINE METHOD), IL-4.75, N50, 3/4"	3.5% @ 50 Gyr.	QCP
PATCHING		
CLASS D PATCHES, TYPE I, II, III, IV, (HMA BINDER IL-19.0mm): 4" (IN 2 LIFTS)	4% @ 70 Gyr.	QCP

NOTE:
CLASS D PATCHES, TYPE I, II, III & IV AT APPROXIMATE STATIONS AS SHOWN ON THE PLANS OR AS DIRECTED BY THE ENGINEER.

- NOTES:
- THE UNIT WEIGHT USED TO CALCULATE ALL HMA SURFACE MIXTURE QUANTITIES IS 112 LBS/SQ YD/IN.
 - THE "AC TYPE" FOR POLYMERIZED HMA MIXES SHALL BE "SBS/SBR PG 76-22" AND FOR NON-POLYMERIZED HMA THE "AC TYPE" SHALL BE "PG 64-22" UNLESS MODIFIED BY DISTRICT ONE SPECIAL PROVISIONS.
 - FOR USE OF RECYCLED MATERIALS SEE DISTRICT ONE SPECIAL PROVISIONS.
 - QUALITY MANAGEMENT PROGRAM (QMP) IDENTIFIES THE PARTICULAR QUALITY CONTROL SPECIFICATION THAT APPLIES TO THE HMA MIXTURE.

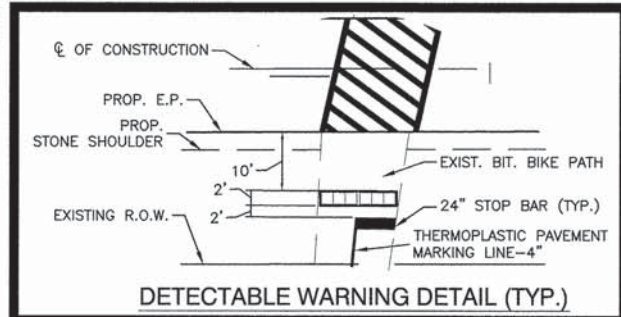
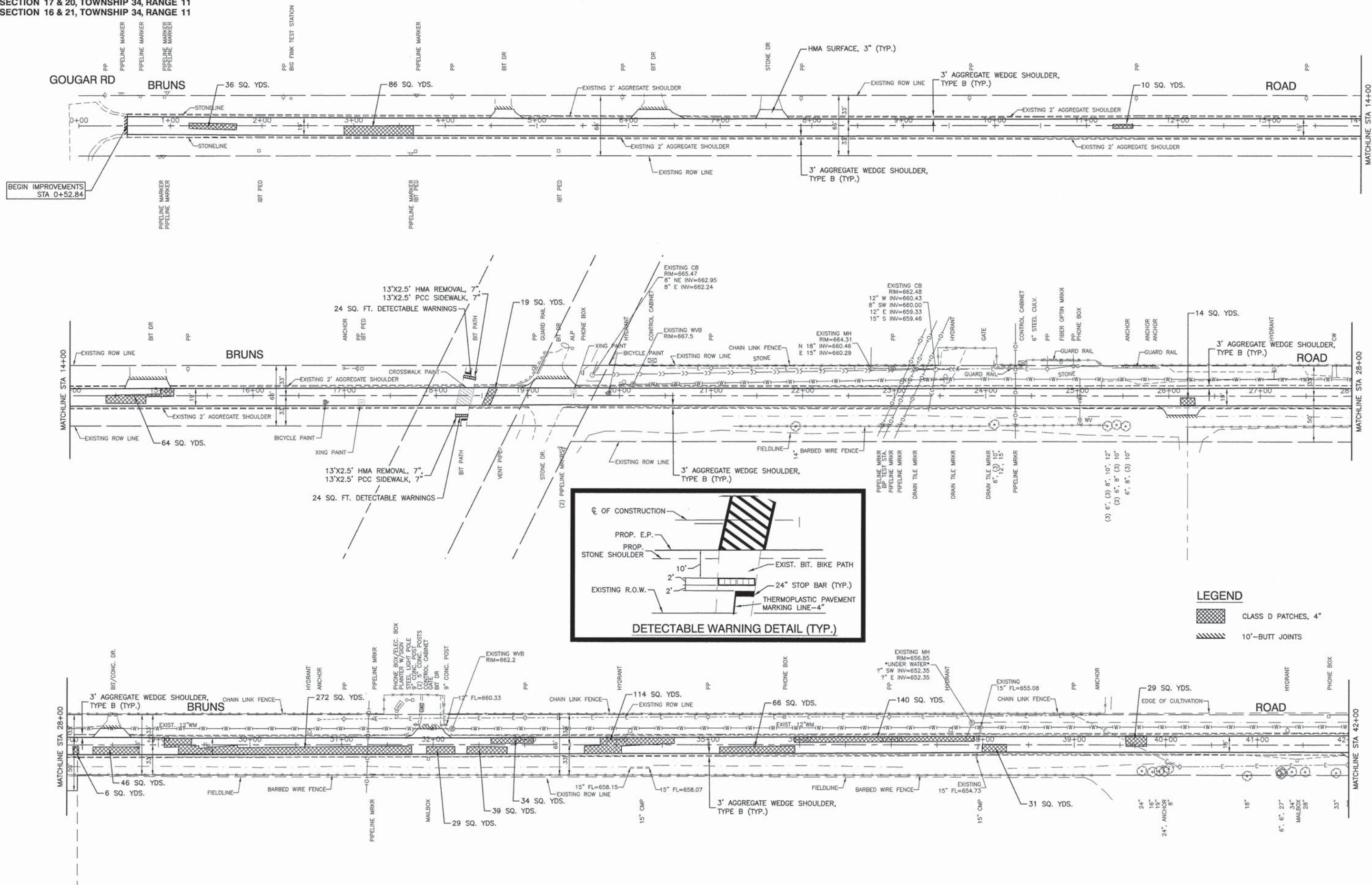

LEGEND

	CLASS D PATCHES, 4"
	10'-BUTT JOINTS

FILE NAME = 09547_02-PLAN-01 - P01

USER NAME =	DESIGNED -- D.E.L.	REVISED --
PLOT SCALE =	CHECKED -- H.L.G.	REVISED --
PLOT DATE =	DRAWN -- ACAD	REVISED --
	CHECKED -- ACAD	REVISED --

STATE OF ILLINOIS
DEPARTMENT OF TRANSPORTATION

ROADWAY RESURFACING
BRUNS ROAD (GALLAGHER ROAD)
PROPOSED PLAN

SCALE: 1"=50' SHEET NO. 4 OF 13 SHEETS STA. 0+00 TO STA. 42+00

F.A.U. RTE.	SECTION	COUNTY	TOTAL SHEETS	SHEET NO.
	13-00013-00-RS	WILL	13	4
FED. ROAD DIST. NO. 1 ILLINOIS			CONTRACT NO. 61A51	
FED. AID PROJECT M-4003 (288)				

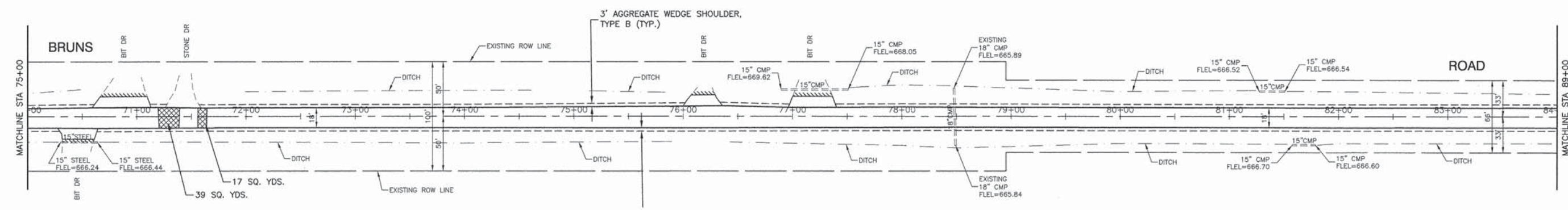
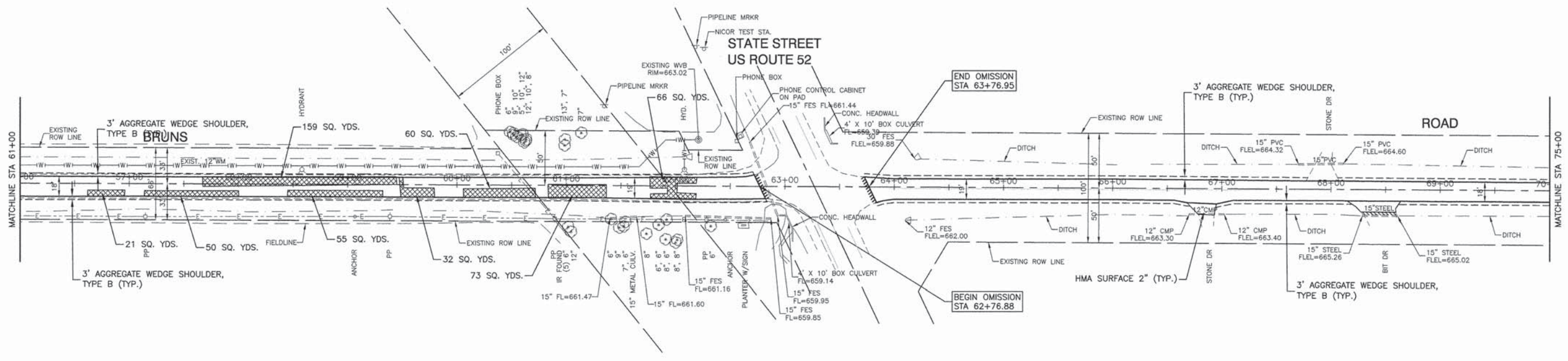
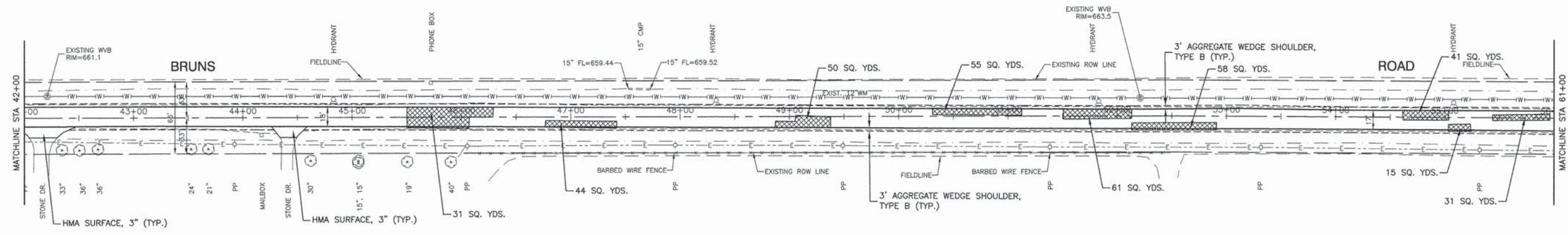

LEGEND

	CLASS D PATCHES, 4"
	10'-BUTT JOINTS

FILE NAME = 09547_02-PLAN-01 - P02
LAST REVISED BY: J. LARSON (09/20/09)
PLOT DATE: 10/20/09 10:00 AM

USER NAME =	DESIGNED — D.E.L.	REVISED —
PLOT SCALE =	CHECKED — H.L.G.	REVISED —
PLOT DATE =	DRAWN — ACAD	REVISED —
	CHECKED — ACAD	REVISED —

STATE OF ILLINOIS
DEPARTMENT OF TRANSPORTATION

ROADWAY RESURFACING BRUNS ROAD (GALLAGHER ROAD) PROPOSED PLAN		F.A.U. RTE.	SECTION	COUNTY	TOTAL SHEETS	SHEET NO.
SCALE: 1"=50'		SHEET NO. 5	OF 13 SHEETS	STA. 42+00 TO STA. 89+00	WILL	13 5
		CONTRACT NO. 61A51		FED. ROAD DIST. NO. 1 ILLINOIS FED. AID PROJECT M-4003 (288)		

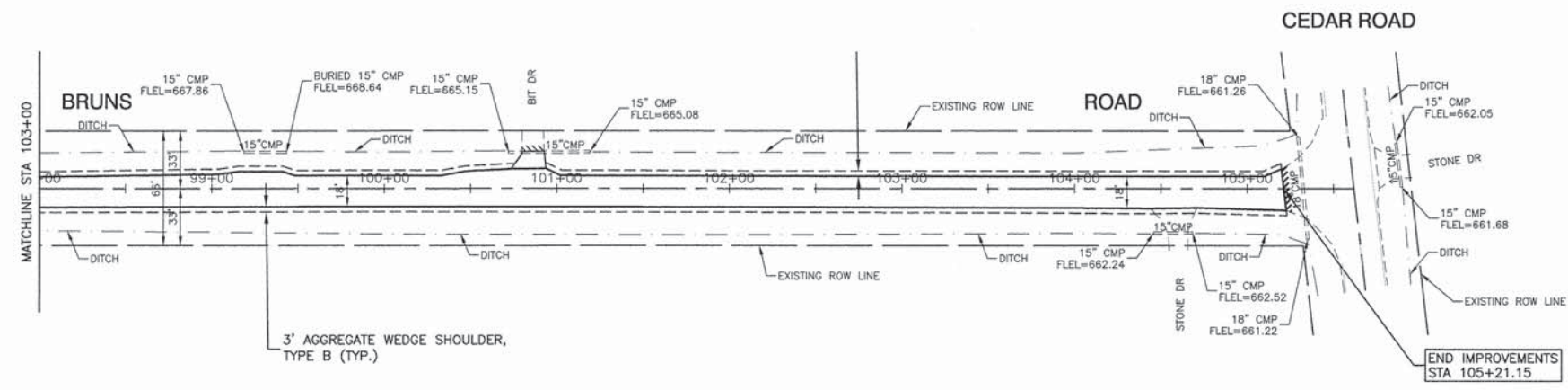
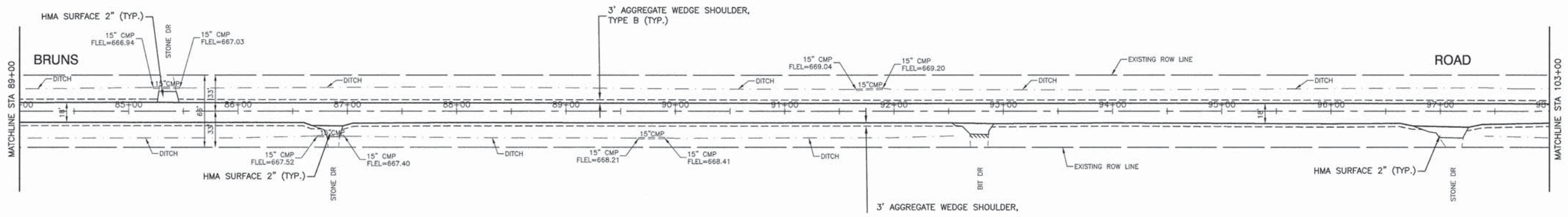

- LEGEND**
- CLASS D PATCHES, 4"
 - 10'-BUTT JOINTS

FILE NAME = 09547_02-PLAN-01 - P03
LAUREL SANDERSON & LARSON, INC. 2019
 4401 13TH ST. LAUREL, ILLINOIS 62434

USER NAME =	DESIGNED -- D.E.L.	REVISED --
PLOT SCALE =	CHECKED -- H.L.G.	REVISED --
PLOT DATE =	DRAWN -- ACAD	REVISED --
	CHECKED -- ACAD	REVISED --

STATE OF ILLINOIS
DEPARTMENT OF TRANSPORTATION

ROADWAY RESURFACING BRUNS ROAD (GALLAGHER ROAD) PROPOSED PLAN		F.A.U. RTE.	SECTION	COUNTY	TOTAL SHEETS	SHEET NO.
		---	13-00013-00-RS	WILL	13	6
SCALE: 1"=50'		SHEET NO. 6 OF 13 SHEETS		STA. 89+00 TO STA. 105+21.15		CONTRACT NO. 61A51
		FED. ROAD DIST. NO. 1	ILLINOIS	FED. AID PROJECT M-4003 (288)		

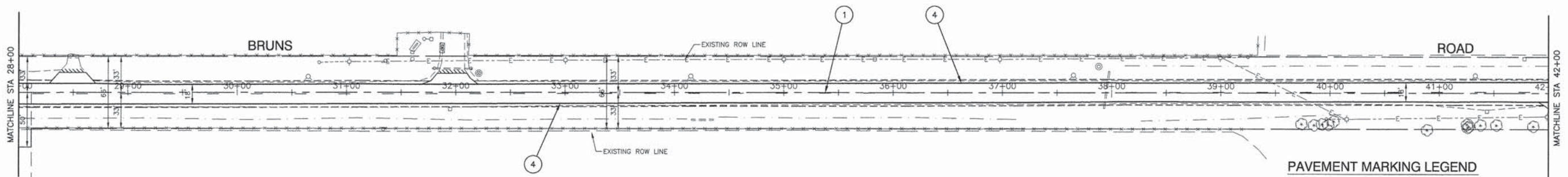
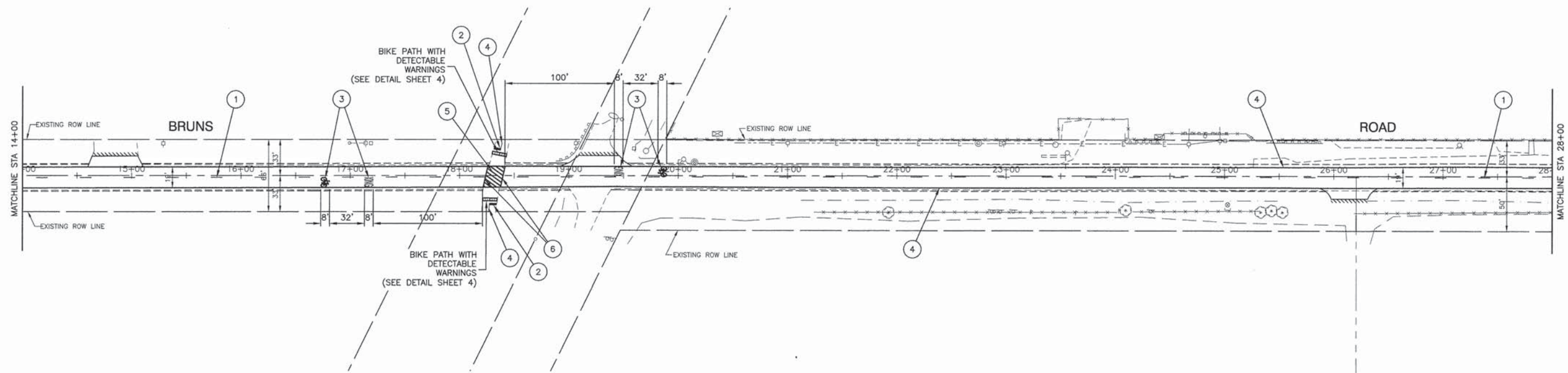
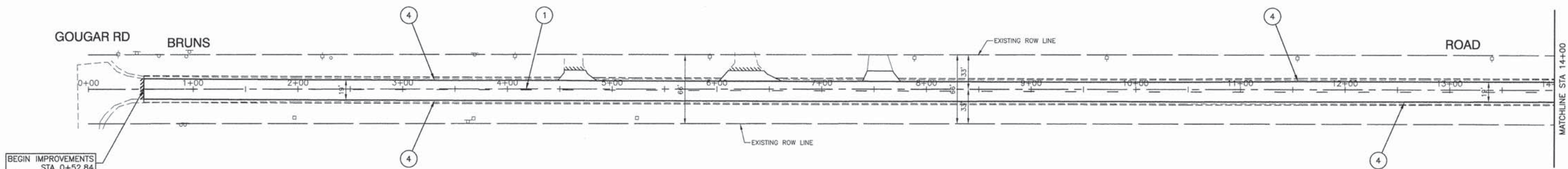

- PAVEMENT MARKING LEGEND**
- ① 4" YELLOW SKIP DASH CENTERLINE (10' LINE - 30' SPACE)
 - ② 24" WHITE STOP BAR
 - ③ WHITE LETTERS & SYMBOLS - LARGE
 - ④ 4" WHITE LINE
 - ⑤ 12" WHITE LINE (45° ANGLE, 3' C/C)
 - ⑥ 6" WHITE CROSSWALK
 - ▬ DETECTABLE WARNING

FILE NAME = 09547_02-PLAN-01 - PM01

USER NAME =	DESIGNED - D.E.L.	REVISED -
PLOT SCALE =	CHECKED - H.L.G.	REVISED -
PLOT DATE =	DRAWN - ACAD	REVISED -
	CHECKED - ACAD	REVISED -

STATE OF ILLINOIS
DEPARTMENT OF TRANSPORTATION

ROADWAY RESURFACING
BRUNS ROAD (GALLAGHER ROAD)
PAVEMENT MARKING

SCALE: 1"=50' SHEET NO. 7 OF 13 SHEETS STA. 0+00 TO STA. 42+00

F.A.U. RTE.	SECTION	COUNTY	TOTAL SHEETS	SHEET NO.
	13-00013-00-RS	WILL	13	7
CONTRACT NO. 61A51				
FED. ROAD DIST. NO. 1 ILLINOIS FED. AID PROJECT M-4003 (288)				

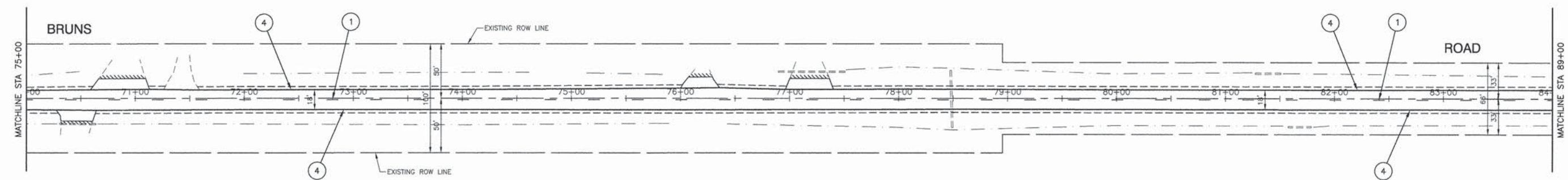
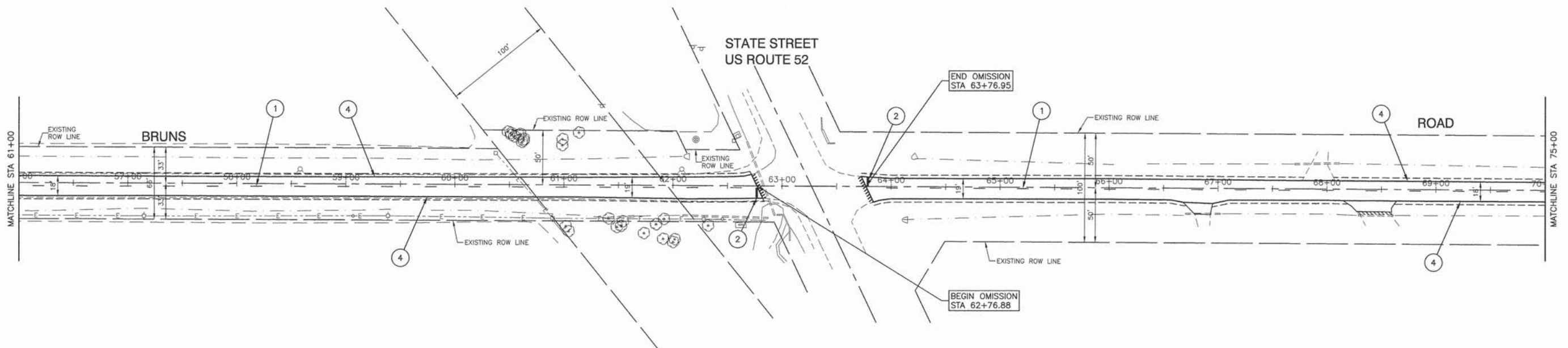
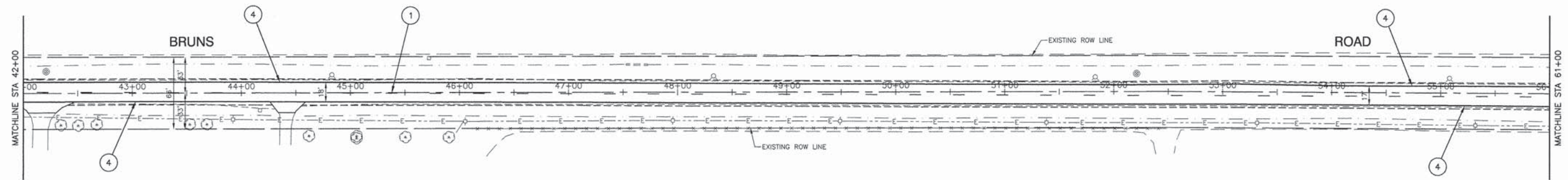

PAVEMENT MARKING LEGEND

- ① 4" YELLOW SKIP DASH CENTERLINE (10' LINE - 30' SPACE)
- ② 24" WHITE STOP BAR
- ③ WHITE LETTERS & SYMBOLS - LARGE
- ④ 4" WHITE LINE
- ⑤ 12" WHITE LINE (45° ANGLE, 3' C/C)
- ⑥ 6" WHITE CROSSWALK
- ▬ DETECTABLE WARNING

FILE NAME = 09547_02-PLAN-01 - PMK02

USER NAME =	DESIGNED -- D.E.L.	REVISED --
PLOT SCALE =	CHECKED -- H.L.G.	REVISED --
PLOT DATE =	DRAWN -- ACAD	REVISED --
	CHECKED -- ACAD	REVISED --

**STATE OF ILLINOIS
DEPARTMENT OF TRANSPORTATION**

ROADWAY RESURFACING
BRUNS ROAD (GALLAGHER ROAD)
PAVEMENT MARKING

SCALE: 1"=50' SHEET NO. 8 OF 13 SHEETS STA. 42+00 TO STA. 89+00

F.A.U. RTE.	SECTION	COUNTY	TOTAL SHEETS	SHEET NO.
	13-00013-00-RS	WILL	13	8
FED. ROAD DIST. NO. 1 ILLINOIS			CONTRACT NO. 61A51	
FED. AID PROJECT M-4003 (288)				

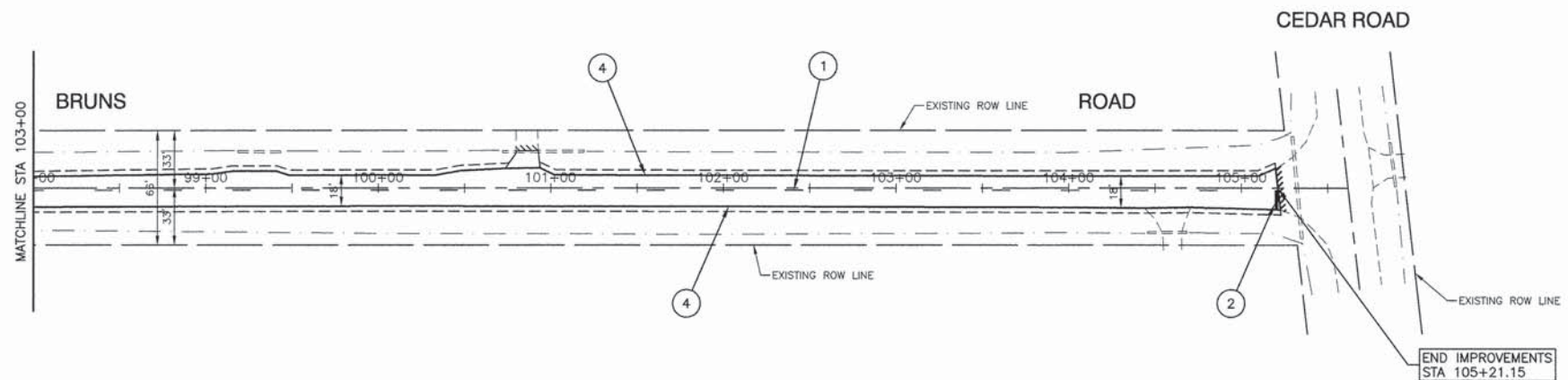

PAVEMENT MARKING LEGEND

- ① 4" YELLOW SKIP DASH CENTERLINE (10' LINE - 30' SPACE)
- ② 24" WHITE STOP BAR
- ③ WHITE LETTERS & SYMBOLS - LARGE
- ④ 4" WHITE LINE
- ⑤ 12" WHITE LINE (45° ANGLE, 3' C/C)
- ⑥ 6" WHITE CROSSWALK
- ▬▬▬▬ DETECTABLE WARNING

FILE NAME = 09547_02-PLAN-01 - PM003

USER NAME =	DESIGNED -- D.E.L.	REVISIONS --
	CHECKED -- H.L.G.	REVISIONS --
PLOT SCALE =	DRAWN -- ACAD	REVISIONS --
PLOT DATE =	CHECKED -- ACAD	REVISIONS --

STATE OF ILLINOIS
DEPARTMENT OF TRANSPORTATION

ROADWAY RESURFACING
BRUNS ROAD (GALLAGHER ROAD)
PAVEMENT MARKING

SCALE: 1"=50' SHEET NO. 9 OF 13 SHEETS STA. 89+00 TO STA. 105+21.15

F.A.U. RTE.	SECTION	COUNTY	TOTAL SHEETS	SHEET NO.
---	13-00013-00-RS	WILL	13	9
FED. ROAD DIST. NO. 1 ILLINOIS FED. AID PROJECT M-4003 (288)			CONTRACT NO. 61A51	

LAST DRAWN BY: CLARENCE OKSZA
PLOTTER: BPL FOR LARSEN & SON/INC

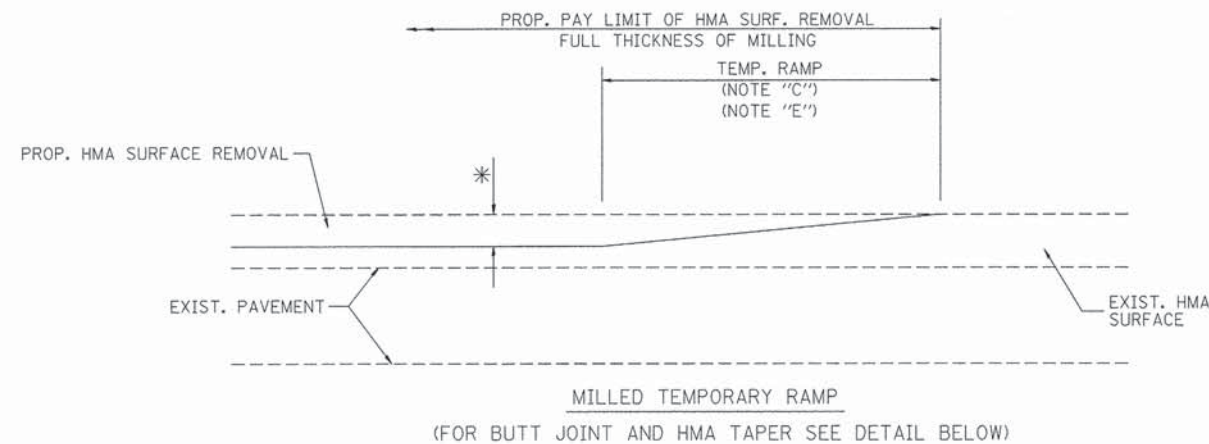

OPTION 1

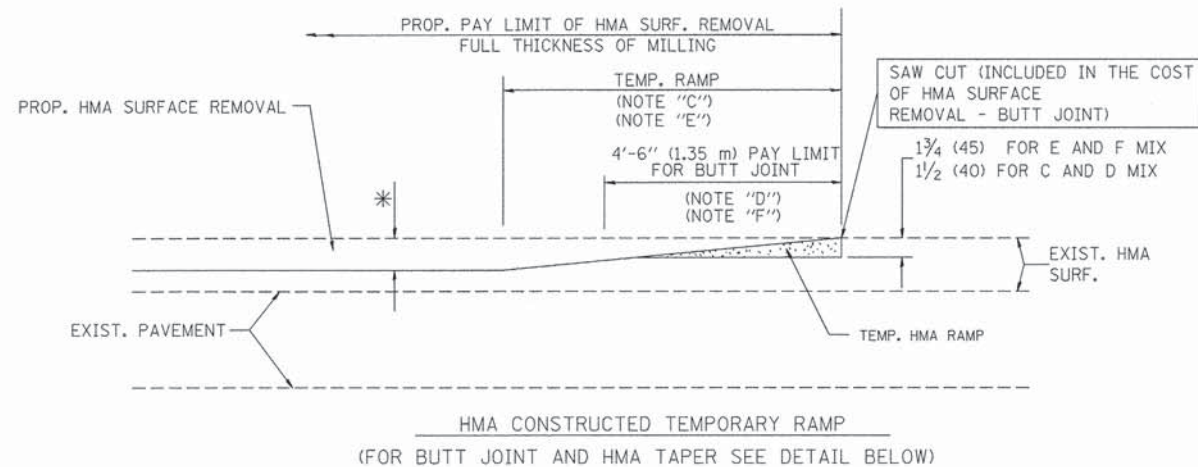

OPTION 2

TYPICAL TEMPORARY RAMP

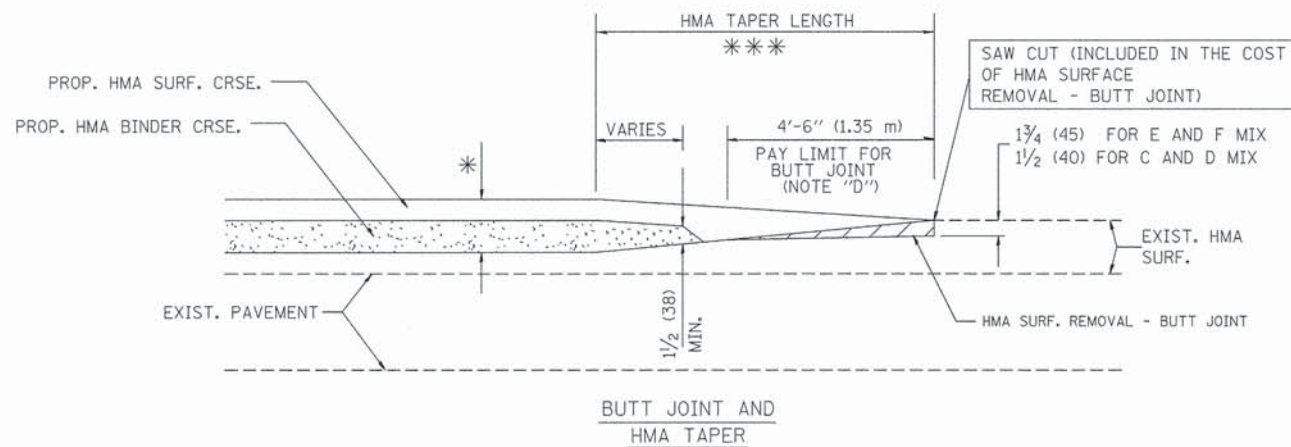

TYPICAL BUTT JOINT AND HMA TAPER FOR MILLING AND RESURFACING

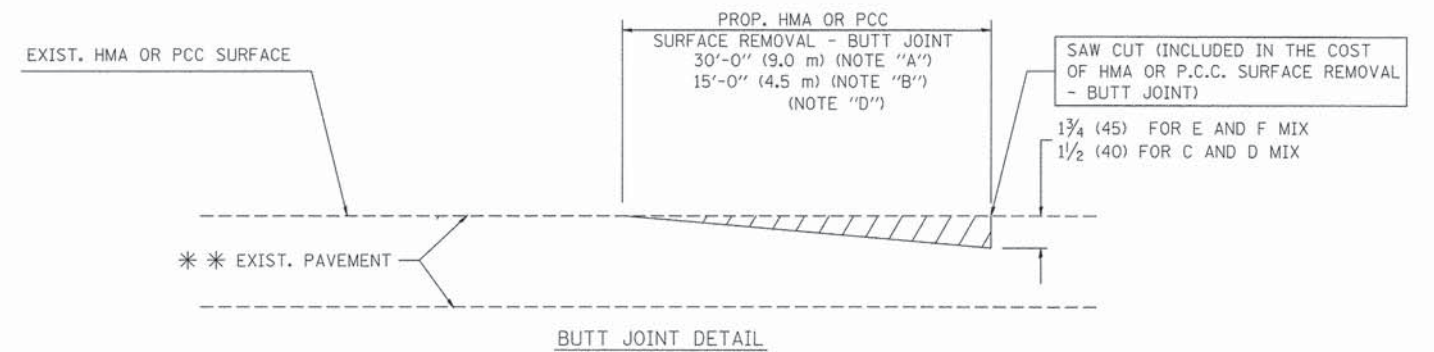

BUTT JOINT DETAIL

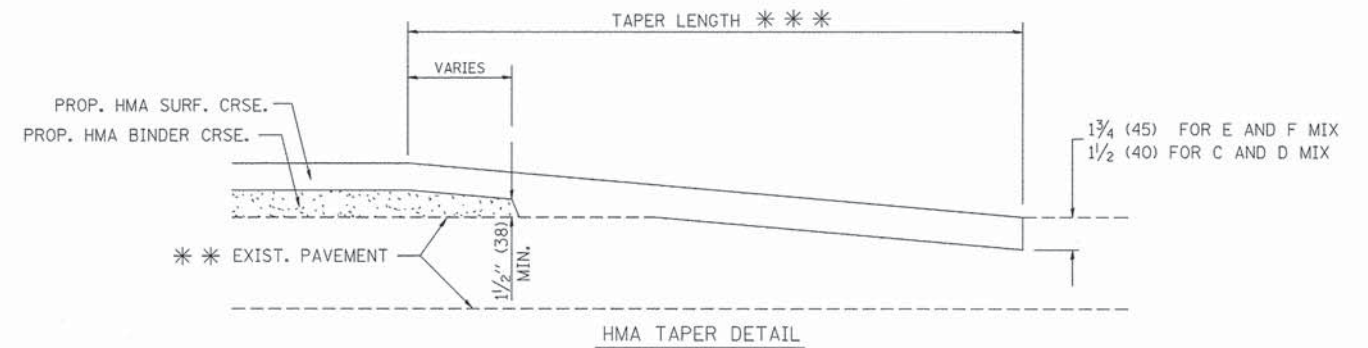

HMA TAPER DETAIL

TYPICAL BUTT JOINT AND HMA TAPER FOR RESURFACING ONLY

*** PC CONCRETE, HMA OR HMA RESURFACED PAVEMENT.

NOTES

- A: MAINLINE ROADWAYS AND MAJOR SIDE ROADS.
 - B: MINOR SIDE ROADS.
 - C: THE TEMP. RAMP SHALL BE CONSTRUCTED IMMEDIATELY UPON REMOVAL OF THE EXISTING HMA SURFACE.
 - D: THE BUTT JOINT SHALL BE CONSTRUCTED IMMEDIATELY PRIOR TO PLACING THE PROPOSED HMA COURSES.
 - E: TAPER THE TEMP. RAMP AT A RATE OF 3'-0" (900 mm) PER 1 INCH (25 mm) OF MILLING THICKNESS.
 - F: INSTALLATION AND REMOVAL OF THE 4'-6" (1.35 m) TEMP. RAMP IS INCLUDED IN COST OF HMA SURFACE REMOVAL - BUTT JOINT
 - G: SEE ARTICLE 406.08 AND 406.14 OF THE STANDARD SPECIFICATIONS FOR "HMA AND/OR PCC SURFACE REMOVAL, BUTT JOINT".
- * SEE TYPICAL SECTIONS FOR MILLING THICKNESS.
- *** 20'-0" (6.1 m) PER 1 (25) RESURFACING (NOTE "A")
10'-0" (3.0 m) PER 1 (25) RESURFACING (NOTE "B")

BASIS OF PAYMENT:

THE BUTT JOINT WILL BE PAID FOR AT THE CONTRACT UNIT PRICE PER SQUARE YARD (SQUARE METER) FOR "HOT-MIX ASPHALT SURFACE REMOVAL - BUTT JOINT" OR FOR "PORTLAND CEMENT CONCRETE SURFACE REMOVAL - BUTT JOINT".

ALL DIMENSIONS ARE IN INCHES (MILLIMETERS) UNLESS OTHERWISE SHOWN.

FILE NAME = W:\diststd\22x34\bd32.dgn	USER NAME = geglianobt	DESIGNED - M. DE YONG	REVISED - R. SHAH 10-25-94	STATE OF ILLINOIS DEPARTMENT OF TRANSPORTATION	DISTRICT ONE BUTT JOINT AND HMA TAPER DETAILS		F.A.U. RTE.	SECTION	COUNTY	TOTAL SHEETS	SHEET NO.	
	PLOT SCALE = 50.0000' / IN.	DRAWN -	REVISED - A. ABBAS 03-21-97		SCALE: NONE	SHEET NO. 10 OF 13 SHEETS	STA.	TO STA.	13-00013-00-RS	WILL	13	10
	PLOT DATE = 1/4/2008	CHECKED -	REVISED - M. GOMEZ 04-06-01					BD400-05 BD32		CONTRACT NO. 61A51		
		DATE - 06-13-90	REVISED - R. BORO 01-01-07					FED. ROAD DIST. NO. 1 ILLINOIS FED. AID PROJECT M-4003 (288)				

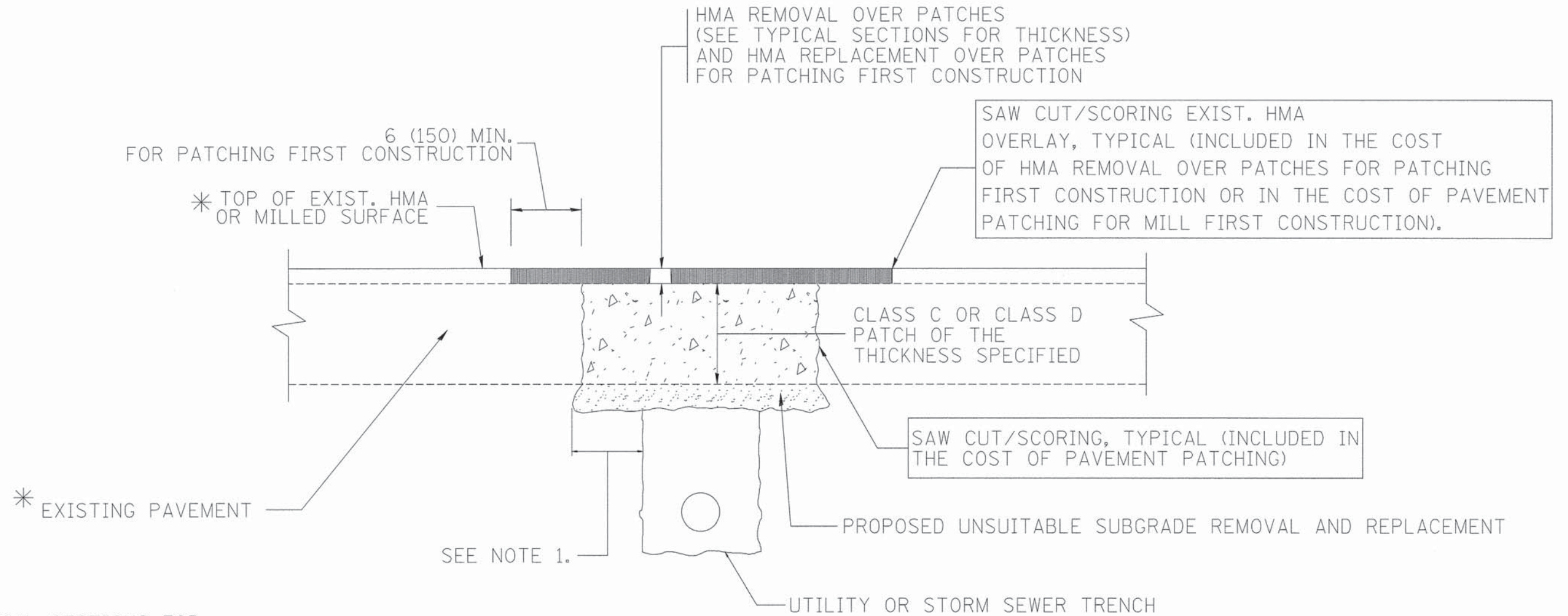

* SEE TYPICAL SECTIONS FOR THICKNESS AND MATERIALS

NOTES:

1. THE WIDTH OF THE FULL DEPTH PATCH OVER A TRENCH SHALL BE 12 (300) WIDER ON EACH SIDE OF THE TRENCH.
2. FOR METHOD OF MEASUREMENT AND BASIS OF PAYMENT, SEE RECURRING SPECIAL PROVISION "PATCHING WITH HOT-MIX ASPHALT OVERLAY REMOVAL".

SEQUENCE OF CONSTRUCTION (PATCHING FIRST)

1. REMOVE THE EXISTING HMA MATERIAL OVER THE AREA TO BE PATCHED.
2. REMOVE AND REPLACE WITH CLASS C OR D PATCH.
3. REPLACE HMA MATERIAL OVER THE AREA TO BE PATCHED.

SEQUENCE OF CONSTRUCTION (MILLING FIRST)

1. MILL HMA FIRST IF THERE IS AT LEAST 4 1/2 INCHES OR MORE OF HMA MATERIAL ON TOP OF THE EXISTING PAVEMENT OR IF THE PAVEMENT IS FULL DEPTH HMA. A MINIMUM OF 2 INCHES OF HMA MATERIAL SHALL BE IN PLACE AFTER MILLING.
2. REMOVE AND REPLACE WITH FULL DEPTH CLASS D PATCHES TO TOP OF MILLED SURFACE.

ALL DIMENSIONS ARE IN INCHES (MILLIMETERS) UNLESS OTHERWISE SHOWN.

FILE NAME = c:\projects\distsd22x34\bd22.dgn	USER NAME = bauerdl	DESIGNED - R. SHAH	REVISED - A. ABBAS 04-27-98	STATE OF ILLINOIS DEPARTMENT OF TRANSPORTATION	DISTRICT ONE PAVEMENT PATCHING FOR HMA SURFACED PAVEMENT	F.A.U. RATE	SECTION	COUNTY	TOTAL SHEETS	SHEET NO.	
		DRAWN -	REVISED - R. BORO 01-01-07			---	13-00013-00-RS	WILL	13	11	
		PLLOT SCALE = 50.000' / IN.	REVISED - R. BORO 09-04-07			BD400-04 (BD-22)		CONTRACT NO. 61A51			
		PLLOT DATE = 10/27/2008	REVISED - K. ENG 10-27-08			SCALE: NONE	SHEET NO. 11 OF 13 SHEETS	STA.	TO STA.		FED. ROAD DIST. NO. 1 ILLINOIS FED. AID PROJECT M-4003 (288)

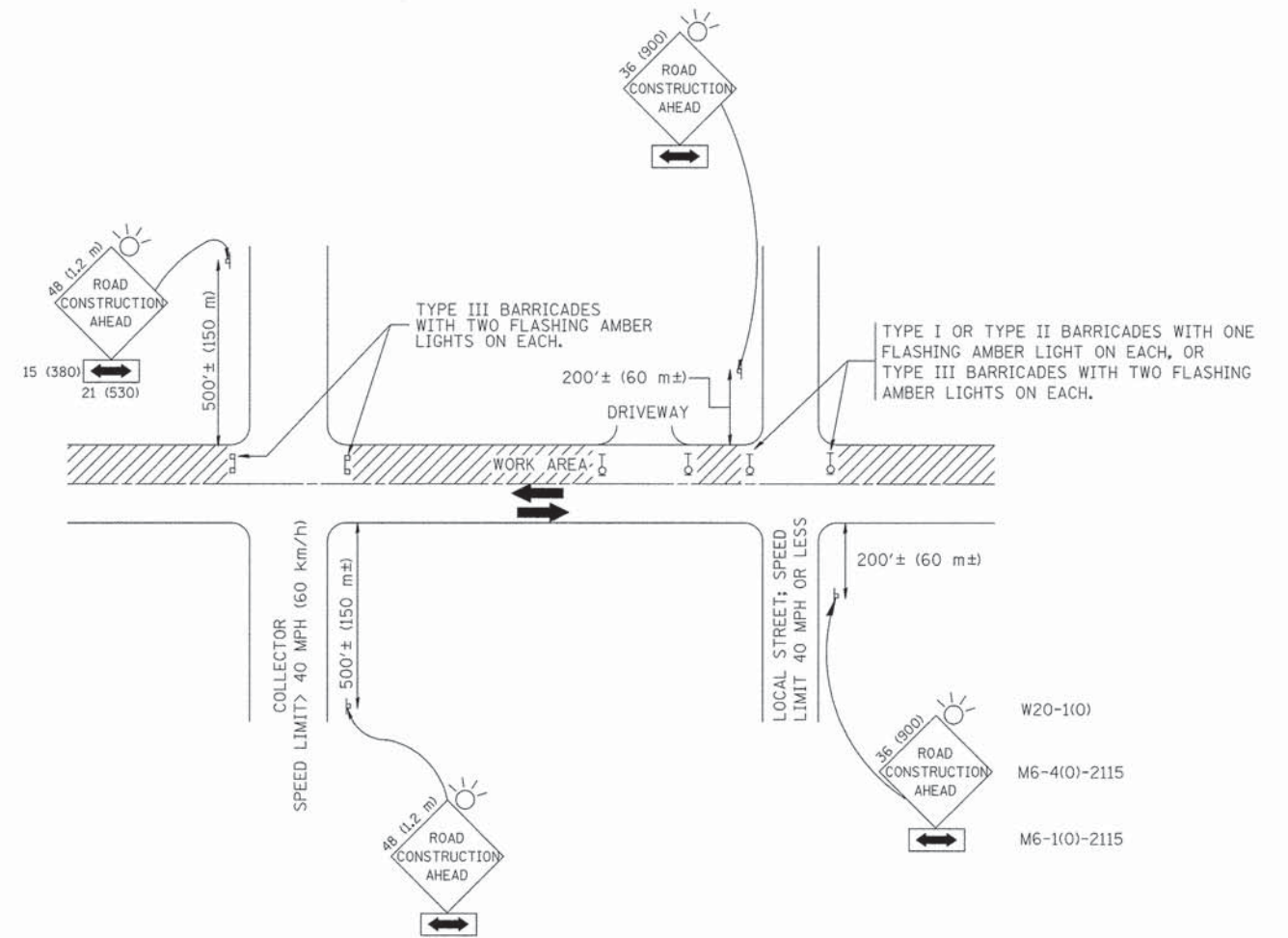

TRAFFIC CONTROL AND PROTECTION FOR SIDE ROADS, INTERSECTIONS, AND DRIVEWAYS

NOTES:

- A. FOR NO LANE RESTRICTION ON THE SIDE ROAD OR DRIVEWAYS
 1. SIDE ROAD WITH A SPEED LIMIT OF 40 MPH (60 km/h) OR LESS AS SHOWN ON THE DRAWING AND AS DIRECTED BY THE ENGINEER:
 - a) ONE **ROAD CONSTRUCTION AHEAD** SIGN 36 x 36 (900x900) WITH A FLASHER AND FLAG MOUNTED ON IT APPROXIMATELY 200' (60 m) IN ADVANCE OF THE MAIN ROUTE.
 - b) THE CLOSED PORTION OF THE MAIN ROUTE SHALL BE PROTECTED BY BLOCKING WITH TYPE I, TYPE II OR TYPE III BARRICADES, 1/3 OF THE CROSS SECTION OF THE CLOSED PORTION.
 2. SIDE ROAD WITH A SPEED LIMIT GREATER THAN 40 MPH (60 km/h) AS SHOWN ON THE DRAWING AND AS DIRECTED BY THE ENGINEER:
 - a) ONE **ROAD CONSTRUCTION AHEAD** SIGN 48 x 48 (1.2 m x 1.2 m) WITH A FLASHER MOUNTED ON IT APPROXIMATELY 500' (150 m) IN ADVANCE OF THE MAIN ROUTE.
 - b) THE CLOSED PORTION OF THE MAIN ROUTE SHALL BE PROTECTED BY BLOCKING WITH TYPE III BARRICADES, 1/2 OF THE CROSS SECTION OF THE CLOSED PORTION.
 3. WHEN THE SIDE ROAD LIES BETWEEN THE BEGINNING OF THE MAINLINE SIGNING AND THE WORK ZONE, A SINGLE HEADED ARROW (M6-1) SHALL BE USED IN LIEU OF THE DOUBLE HEADED ARROW (M6-4).
- B. FOR A LANE CLOSURE ON A SIDE ROAD OR DRIVEWAY:

USE APPLICABLE PORTIONS OF THE TYPICAL APPLICATION OF TRAFFIC CONTROL DEVICES (STD. 701501, STD. 701606 OR THE APPROPRIATE STANDARD). THE SPACING OF SIGNS AND BARRICADES SHALL BE ADJUSTED FOR FIELD CONDITIONS AS DIRECTED BY THE ENGINEER. THE DIRECTIONAL ARROW SHALL BE COVERED OR REMOVED WHEN NO LONGER CONSISTENT WITH THE SIDE ROAD LANE CLOSURE.
- C. ADVANCE WARNING SIGNS ARE TO BE OMITTED ON DRIVEWAY UNLESS OTHERWISE NOTED.
- D. THE TRAFFIC CONTROL AND PROTECTION FOR SIDE ROADS, INTERSECTIONS, AND DRIVEWAYS SHALL BE INCIDENTAL TO THE COST OF SPECIFIED TRAFFIC CONTROL STANDARDS OR ITEMS.

All dimensions are in millimeters (Inches) unless otherwise shown.

FILE NAME = W:\diststd\22x34\tcl8.dgn	USER NAME = geglianobt	DESIGNED - LHA	REVISED - J. OBERLE 10-18-95
		DRAWN -	REVISED - A. HOUSEH 03-06-96
		CHECKED -	REVISED - A. HOUSEH 10-15-96
		DATE - 06-89	REVISED - T. RAMMACHER 01-06-00

STATE OF ILLINOIS
DEPARTMENT OF TRANSPORTATION

DISTRICT ONE			
TRAFFIC CONTROL AND PROTECTION FOR			
SIDE ROADS, INTERSECTIONS, AND DRIVEWAYS			
SCALE: NONE	SHEET NO. 12 OF 13 SHEETS	STA.	TO STA.

F.A.U. RTE.	SECTION	COUNTY	TOTAL SHEETS	SHEET NO.
	13-00013-00-RS	WILL	13	12
TC-10			CONTRACT NO. 61A51	
FED. ROAD DIST. NO. 1 ILLINOIS FED. AID PROJECT M-4003 (288)				

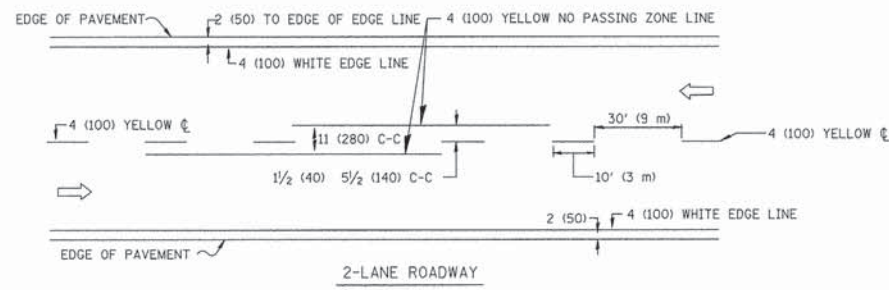

2-LANE ROADWAY

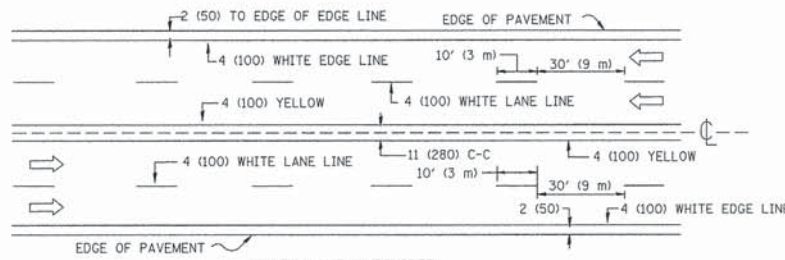

MULTI-LANE UNDIVIDED

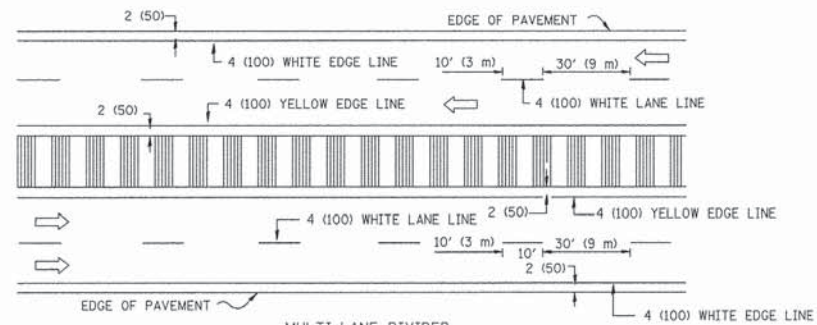

MULTI-LANE DIVIDED WITH MOUNTABLE MEDIAN

NOTE: MEDIANS WITH BARRIER CURB DO NOT REQUIRE AN EDGE LINE

TYPICAL LANE AND EDGE LINE MARKING

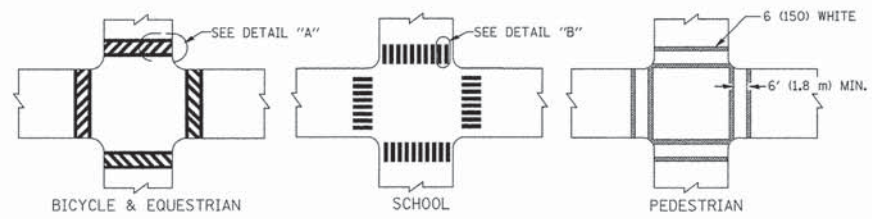

TYPICAL CROSSWALK MARKING

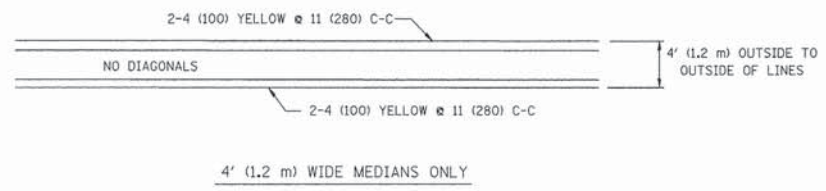

4' (1.2 m) WIDE MEDIANS ONLY

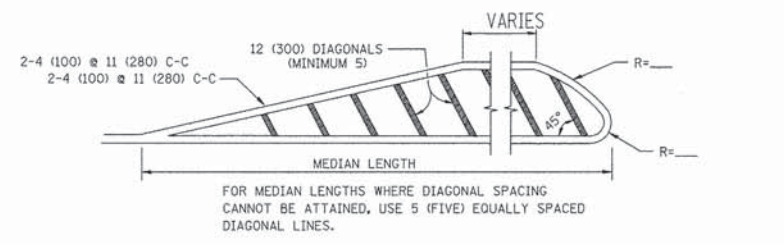

DIAGONAL LINE SPACING: 50' (15 m) C-C (LESS THAN 30MPH (50 km/h))
75' (25 m) C-C 30MPH (50 km/h) TO 45MPH (70 km/h)
150' (45 m) C-C (MORE THAN 45MPH (70 km/h))

MEDIANS OVER 4' (1.2 m) WIDE

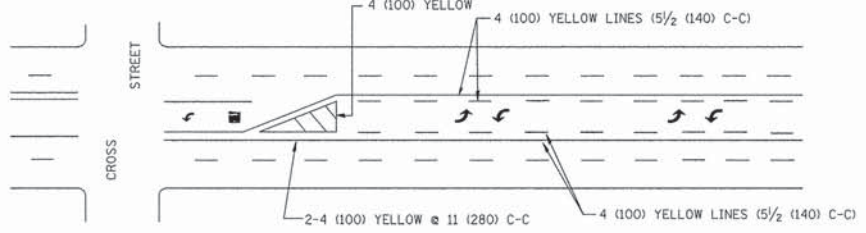

TYPICAL PAINTED MEDIAN MARKING

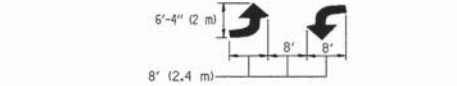

MEDIAN WITH TWO-WAY LEFT TURN LANE

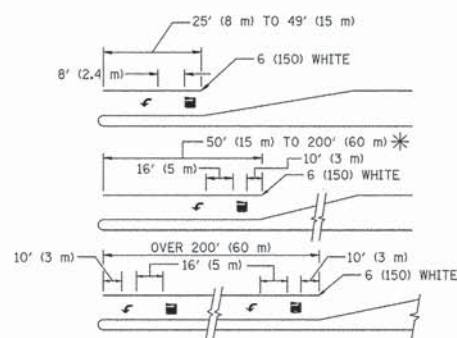

* TURN LANES IN EXCESS OF 400' (120 m) IN LENGTH MAY HAVE AN ADDITIONAL SET OF ARROW - "ONLY" INSTALLED MIDWAY BETWEEN THE OTHER TWO SETS OF ARROW - "ONLY".

TYPICAL LEFT (OR RIGHT) TURN LANE

TYPICAL TURN LANE MARKING

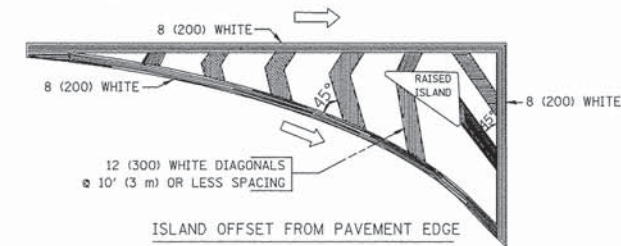

ISLAND OFFSET FROM PAVEMENT EDGE

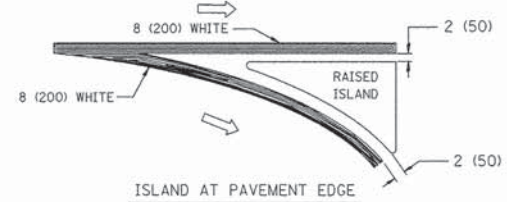

ISLAND AT PAVEMENT EDGE

TYPICAL ISLAND MARKING

TYPE OF MARKING	WIDTH OF LINE	PATTERN	COLOR	SPACING / REMARKS
CENTERLINE ON 2 LANE PAVEMENT	4 (100)	SKIP-DASH	YELLOW	10' (3 m) LINE WITH 30' (9 m) SPACE
CENTERLINE ON MULTI-LANE UNDIVIDED PAVEMENT	2 @ 4 (100)	SOLID	YELLOW	11 (280) C-C
NO PASSING ZONE LINES: FOR ONE DIRECTION FOR BOTH DIRECTIONS	4 (100) 2 @ 4 (100)	SOLID SOLID	YELLOW YELLOW	5 1/2 (140) C-C FROM SKIP-DASH CENTERLINE 11 (280) C-C OMIT SKIP-DASH CENTERLINE BETWEEN
LANE LINES	4 (100) 5 (125) ON FREEWAYS	SKIP-DASH SKIP-DASH	WHITE WHITE	10' (3 m) LINE WITH 30' (9 m) SPACE
DOTTED LINES (EXTENSIONS OF CENTER, LANE OR TURN LANE MARKINGS)	SAME AS LINE BEING EXTENDED	SKIP-DASH	SAME AS LINE BEING EXTENDED	2' (600) LINE WITH 6' (1.8 m) SPACE
EDGE LINES	4 (100)	SOLID	YELLOW-LEFT WHITE-RIGHT	OUTLINE MOUNTABLE MEDIANS IN YELLOW; EDGE LINES ARE NOT USED NEXT TO BARRIER CURB
TURN LANE MARKINGS	6 (150) LINES, FULL SIZE LETTERS & SYMBOLS (8' (2.4m))	SOLID	WHITE	SEE TYPICAL TURN LANE MARKING DETAIL
TWO WAY LEFT TURN MARKING	2 @ 4 (100) EACH DIRECTION 8' (2.4m) LEFT ARROW	SKIP-DASH AND SOLID IN PAIRS	YELLOW WHITE	10' (3 m) LINE WITH 30' (9 m) SPACE FOR SKIP-DASH; 5 1/2 (140) C-C BETWEEN SOLID LINE AND SKIP-DASH LINE SEE TYPICAL TWO-WAY LEFT TURN MARKING DETAIL
CROSSWALK LINES (PEDESTRIAN) A. DIAGONALS (BIKE & EQUESTRIAN) B. LONGITUDINAL BARS (SCHOOL)	2 @ 6 (150) 12 (300) @ 45° 12 (300) @ 90°	SOLID SOLID SOLID	WHITE WHITE WHITE	NOT LESS THAN 6' (1.8 m) APART 2' (600) APART SEE TYPICAL CROSSWALK MARKING DETAILS.
STOP LINES	24 (600)	SOLID	WHITE	PLACE 4' (1.2 m) IN ADVANCE OF AND PARALLEL TO CROSSWALK, IF PRESENT. OTHERWISE, PLACE AT DESIRED STOPPING POINT. PARALLEL TO CROSSROAD CENTERLINE, WHERE POSSIBLE
PAINTED MEDIANS	2 @ 4 (100) WITH 12 (300) DIAGONALS @ 45° NO DIAGONALS USED FOR 4' (1.2 m) WIDE MEDIANS	SOLID	YELLOW; TWO WAY TRAFFIC WHITE; ONE WAY TRAFFIC	11 (280) C-C FOR THE DOUBLE LINE SEE TYPICAL PAINTED MEDIAN MARKING.
GORE MARKING AND CHANNELIZING LINES	8 (200) WITH 12 (300) DIAGONALS @ 45°	SOLID	WHITE	DIAGONALS: 15' (4.5 m) C-C (LESS THAN 30MPH (50 km/h)) 20' (6 m) C-C 30MPH (50 km/h) TO 45MPH (70 km/h) 30' (9 m) C-C (OVER 45MPH (70 km/h))
RAILROAD CROSSING	24 (600) TRANSVERSE LINES; "RR" IS 6' (1.8 m) LETTERS; 16 (400) LINE FOR "X"	SOLID	WHITE	SEE STATE STANDARD 780001 AREA OF: "R"=3.6 SQ. FT. (0.33 m²) EACH "X"=54.0 SQ. FT. (5.0 m²)
SHOULDER DIAGONALS	12 (300) @ 45°	SOLID	WHITE - RIGHT YELLOW - LEFT	50' (15 m) C-C (LESS THAN 30MPH (50 km/h)) 75' (25 m) C-C (30 MPH (50 km/h) TO 45MPH (70 km/h)) 150' (45 m) C-C (OVER 45MPH (70 km/h))

FOR FURTHER DETAILS ON PAVEMENT MARKING REFER TO STANDARD SPECIFICATIONS FOR ROAD AND BRIDGE CONSTRUCTION AND STATE STANDARD 780001.

All dimensions are in inches (millimeters) unless otherwise shown.

FILE NAME =	USER NAME = drivakosgn	DESIGNED - EVERS	REVISED - T. RAMMACHER 10-27-94
ci:\pw\work\pwwdot\drivakosgn\d0108315\to3.dgn		DRAWN -	REVISED - C. JUCIUS 09-09-09
	PLOT SCALE = 58.0000' / IN.	CHECKED -	REVISED -
	PLOT DATE = 9/9/2009	DATE - 03-19-90	REVISED -

STATE OF ILLINOIS
DEPARTMENT OF TRANSPORTATION

DISTRICT ONE TYPICAL PAVEMENT MARKINGS		COUNTY	TOTAL SHEETS	SHEET NO.
SCALE: NONE		WILL	13	13
SHEET NO. 13 OF 13 SHEETS	STA. TO STA.	CONTRACT NO. 61A51		

FAU RTE.	SECTION	COUNTY	TOTAL SHEETS	SHEET NO.
	13-00013-00-RS	WILL	13	13
TC-13		CONTRACT NO. 61A51		
FED. ROAD DIST. NO. 1	ILLINOIS	FED. AID PROJECT M-4003 (288)		