

200-202 20TH ST.
SPIEGEL MOVING & STORAGE

ALL STORM SEWERS SHOWN ARE EXISTING. ALL CONNECTIONS OF PROPOSED SANITARY SEWER TO EITHER EXISTING OR PROPOSED STRUCTURES SHALL BE INCIDENTAL TO DIP SANITARY SEWER OF THE APPROPRIATE SIZE.

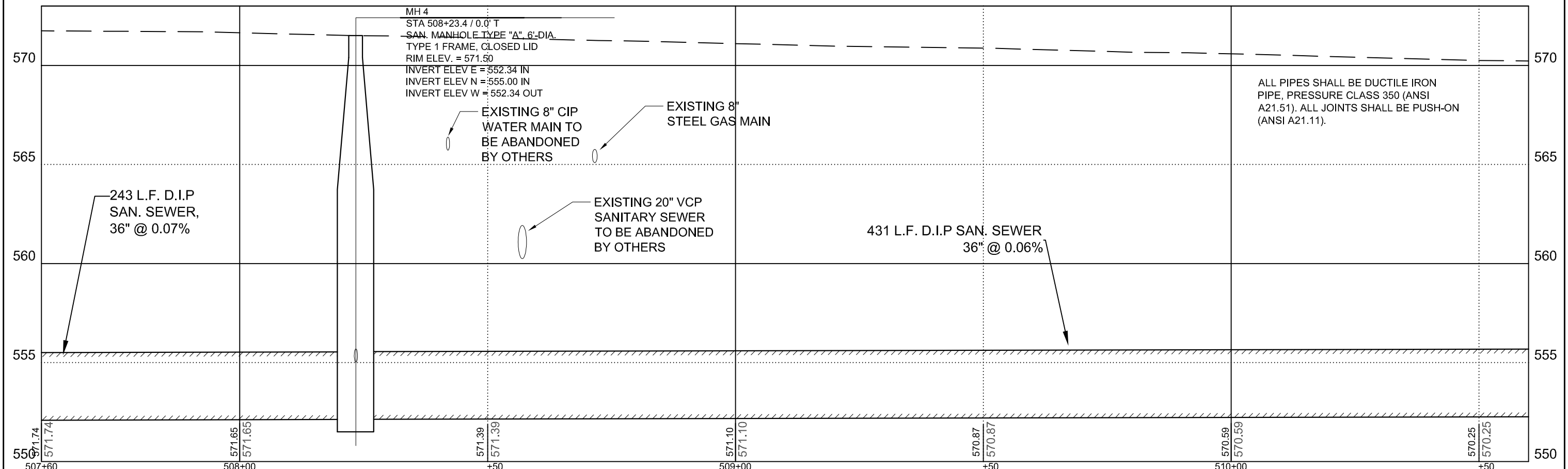
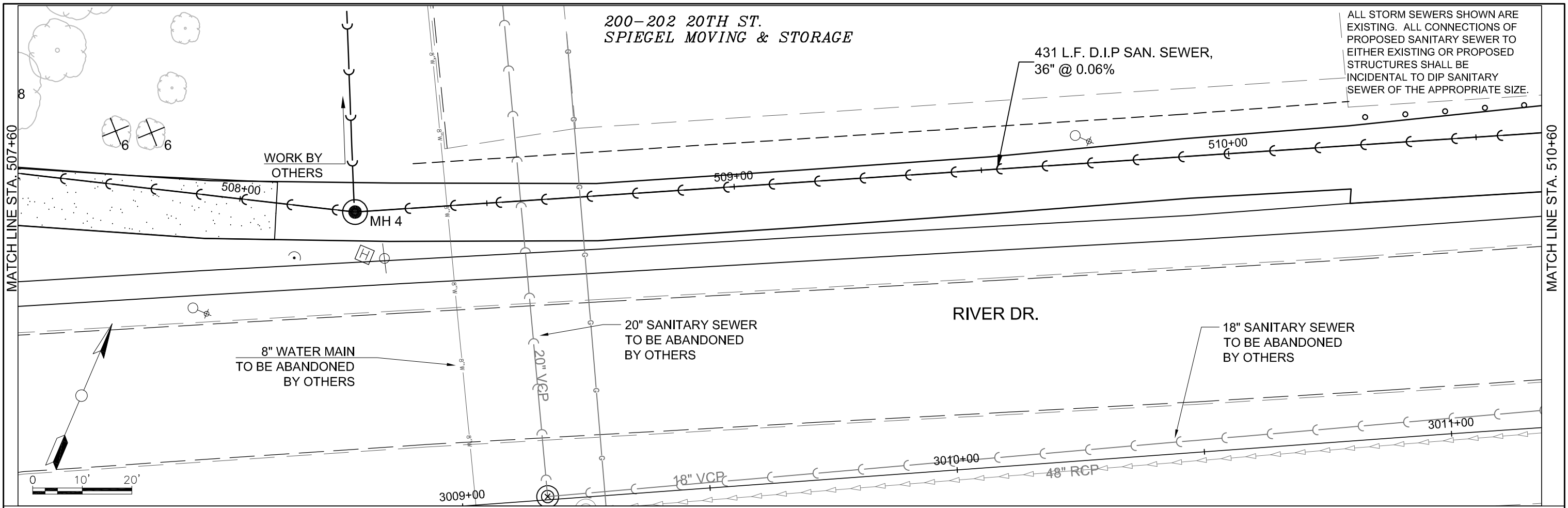

FILE NAME =	USER NAME = LK	DESIGNED - LK	REVISED - 01/20/14	STATE OF ILLINOIS DEPARTMENT OF TRANSPORTATION	UTILITIES PLAN & PROFILE SANITARY SEWER INTERCEPTOR		F.A.U. RTE. = 5756	SECTION = (81-1)M	COUNTY = ROCK ISLAND	TOTAL SHEETS = 217	SHEET NO. = 71	
H: \Engineering\ALL PROJECTS\1193 - Utility Relocations for I-74 Bridge\Design\DRAWINGS\I-74 RiverDr utilities-design	PLOT SCALE = 1"=10'	DRAWN - LK	REVISED - 02/28/14		SCALE: 1" = 10'	SHEET 71 OF 217 SHEETS	STA. 507+60 TO STA. 510+60	CONTRACT NO: 64J68		ILLINOIS FED. AID PROJECT		
	PLOT DATE = 02/28/14	CHECKED - JC	REVISED -									
		DATE - 01/03/14	REVISED -									