

ITERIS

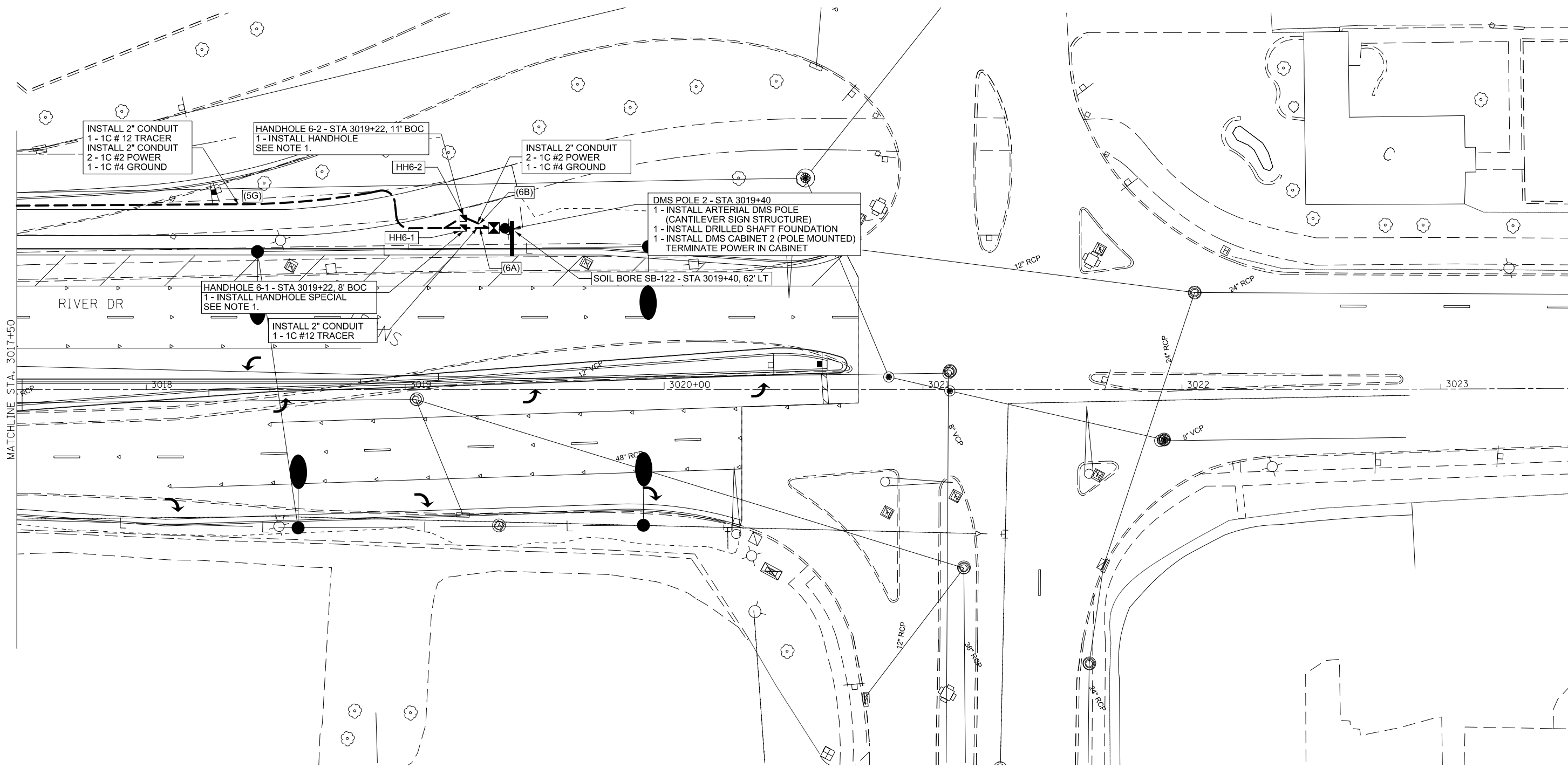

**NOTES:**

- HANDHOLE TO BE INSTALLED A MINIMUM OF 1' FROM ANY GUARDRAIL POST. INSTALL 2 - 2" CONDUIT STUBOUTS (CAPPED) FOR FUTURE CONNECTIONS.
- ALL CONDUITS TO BE CAPPED IN HANDHOLES FOR FUTURE USE.



LAYOUT	
DRAWN	
REVIEWED	

FILE NAME =	USER NAME = dmcointock	DESIGNED - DJM	REVISED -
ci:\pwise_work\do_not_delete\dms01359\02\PACKE-IT-sht-ITS500.sht		DRAWN - DJM	REVISED -
	PLOT SCALE = 1" = 40'	CHECKED - SPG	REVISED -
	PLOT DATE = 4/14/2014	DATE - 3/6/2013	REVISED -

**STATE OF ILLINOIS  
DEPARTMENT OF TRANSPORTATION**

**ITS PLANS  
RIVER DRIVE  
STA. 3017 + 50 TO STA. 3021 + 92**

SCALE: 1" = 40' SHEET NO. 6 1 OF SHEETS STA. 3017+50 13023+92

F.A.U. R.E.	SECTION	COUNTY	TOTAL SHEETS	SHEET NO.
5756	(81-1)M	ROCK ISLAND	217	132
CONTRACT NO. 64J68			ITS-06	
ILLINOIS FED. AID PROJECT				