

Contract 6492 23 of 33

ROUTE NO.	SECTION	COUNTY	TOTAL SHEETS	SHEET NO.
F.A.U. 5571	BD-1	WHITESIDE	63	16
FED. RD. DIST. NO. 7		ALWAYS	FED. AID PROJECT	SHEET NO. 2

44 SHEETS

B.M. - CHISELED "C" ON LOWEST STEP OF SOUTHEAST WINGWALL  
22' LEFT, STATION 20+30.2, ELEVATION 644.97

EXISTING STRUCTURE : STRUCTURE NUMBER 098-0052, CONSTRUCTED IN 1951 UNDER  
SENATE BILL #417, SECTION B-F.  
SUPERSTRUCTURE : REINF. CONC. DECK ON RIVETED STEEL PLATE GIRDERS  
SUBSTRUCTURE : VAULTED ABUTMENTS, SOLID PIERS  
DECK TO BE REMOVED AND STRUCTURE WIDENED, TRAFFIC  
TO BE MAINTAINED UTILIZING STAGE CONSTRUCTION.

NO SALVAGE :

STATION 32+33  
REBUILT 199... BY  
STATE OF ILLINOIS  
F A RTE. 5571 SEC. BD-1  
F A PROJ. BHM-5062(014)  
LOADING HS 20  
STR. NO. 098-0052

NOTES:  
EXISTING NAME PLATE TO BE CLEANED AND RELOCATED NEXT  
TO NEW NAME PLATE ON THE NEW PARAPET, COST INCIDENTAL  
TO "NAME PLATE."  
FOR MATERIALS AND DETAIL DIMENSIONS OF NAME PLATES,  
SEE STANDARD SHEET 2113.

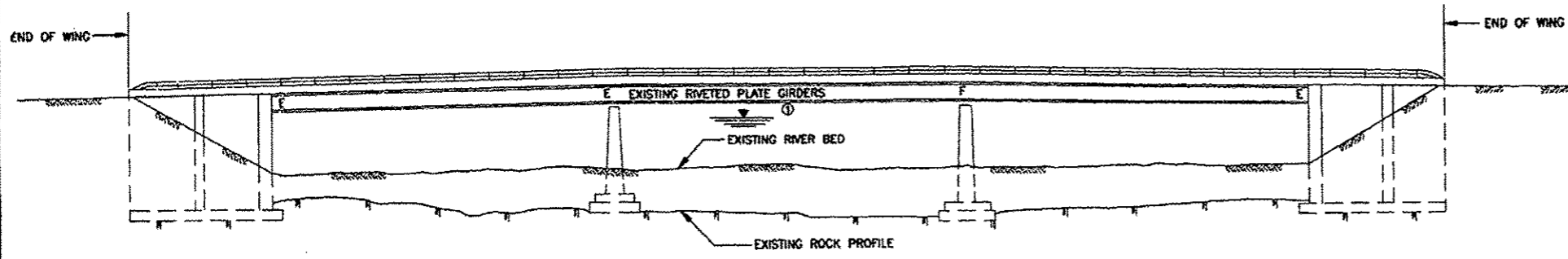

ELEVATION

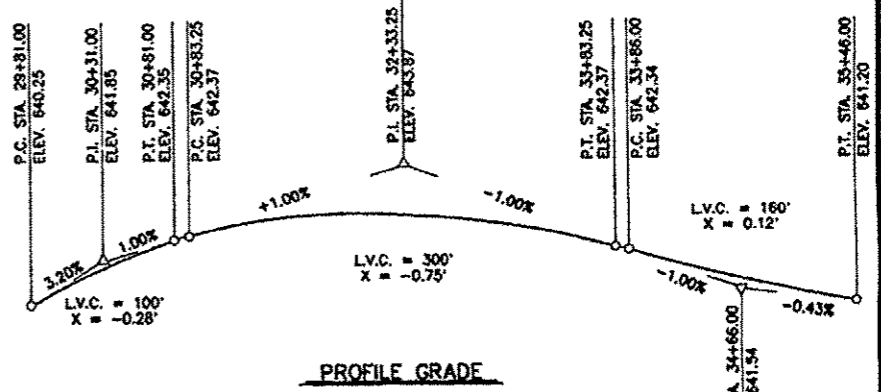

PROFILE GRADE

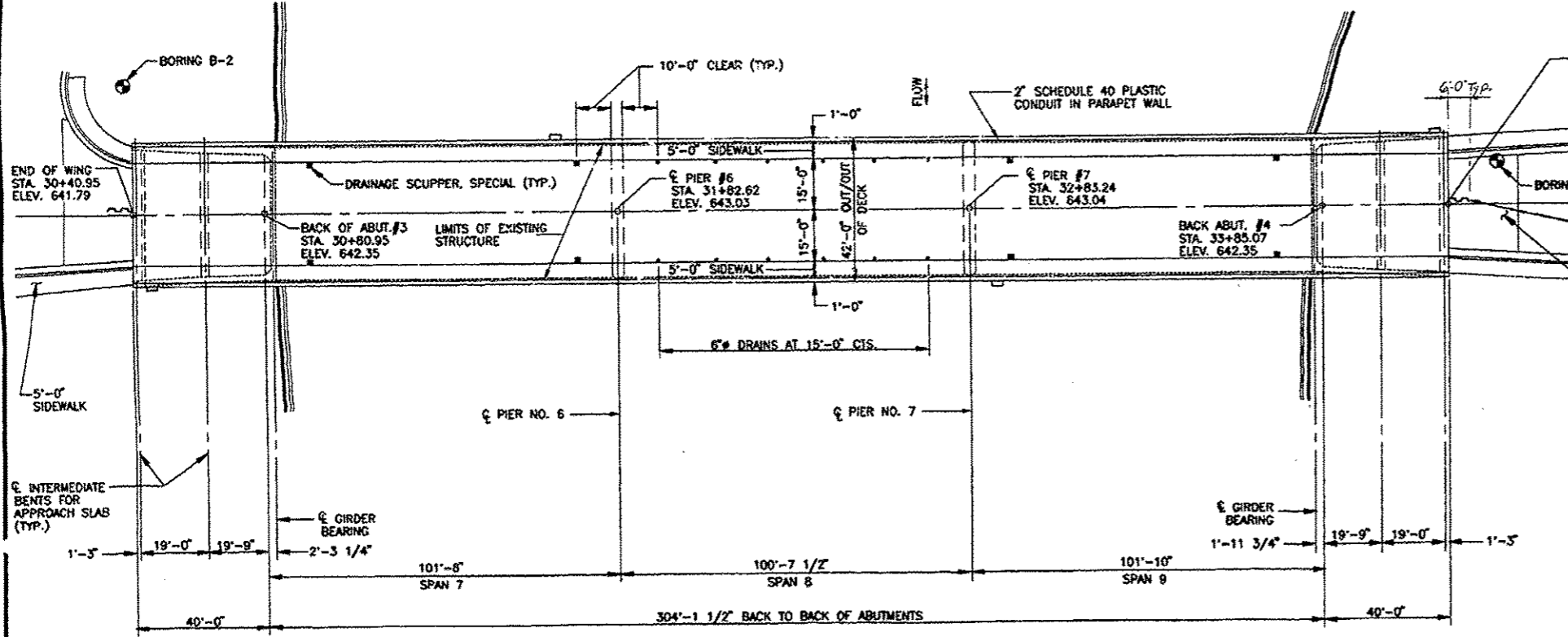

PLAN

**DESIGN SPECIFICATIONS**  
1989 AASHTO SPECIFICATIONS & 1990-1991 INTERIM

**DESIGN LOADING HS20-44**  
ALLOW 25#/SQ.FT. FOR FUTURE WEARING SURFACE

**DESIGN STRESSES**  
f<sub>c</sub> = 3500 psi  
f<sub>y</sub> = 60,000 psi (REINF.)  
f<sub>s</sub> = 18,000 psi (EXISTING PLATE GIRDERS)

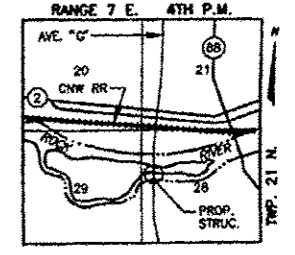

LOCATION SKETCH

**APPROVED**  
FOR STRUCTURAL ADEQUACY ONLY

*Ralph E. Anderson*  
Engineer of Bridges and Structures

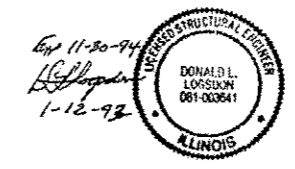

**GENERAL PLAN**  
AVENUE "G" OVER SOUTH  
CHANNEL OF THE ROCK RIVER  
F.A.U. RTE. 5571 SECTION BD-1  
WHITESIDE COUNTY  
STRUCTURE NO. 098-0052  
STATION 32+33.01

FOR INFORMATION ONLY