

F.A.I. RTE.	SECTION	COUNTY	TOTAL SHEETS	SHEET NO.
88	D2 BRIDGE PAINTING 2014-5	WHITESIDE	12	1
		ILLINOIS	CONTRACT NO. 64K12	

STATE OF ILLINOIS
DEPARTMENT OF TRANSPORTATION
DIVISION OF HIGHWAYS

**PROPOSED
HIGHWAY PLANS**

F.A.I. ROUTE 88 (I-88)
D2 BRIDGE PAINTING 2014-5
PROJECT
TYPE of IMPROVEMENT - BRIDGE PAINTING
WHITESIDE COUNTY

C-92-051-14

R.6

FOR INDEX OF SHEETS, SEE SHEET NO. 2

FOR STATE STANDARDS DISTRICT STANDARDS
AND GENERAL NOTES SEE SHEET NO. 2

WHITESIDE COUNTY - HOPKINS TOWNSHIP - SECTION 34

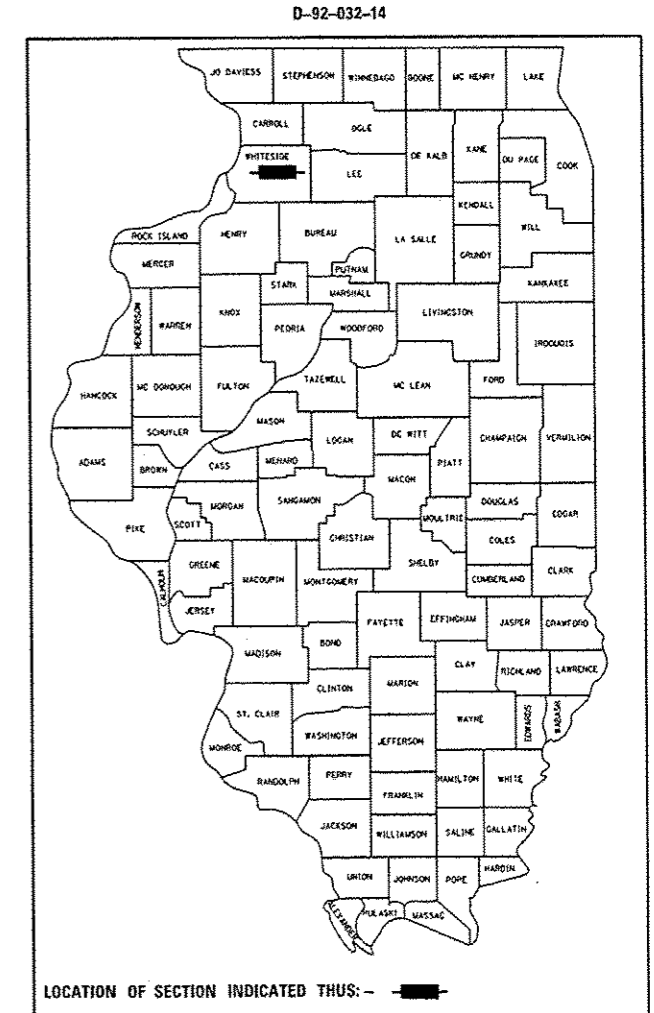

SN: 098-0073
SN: 098-0074

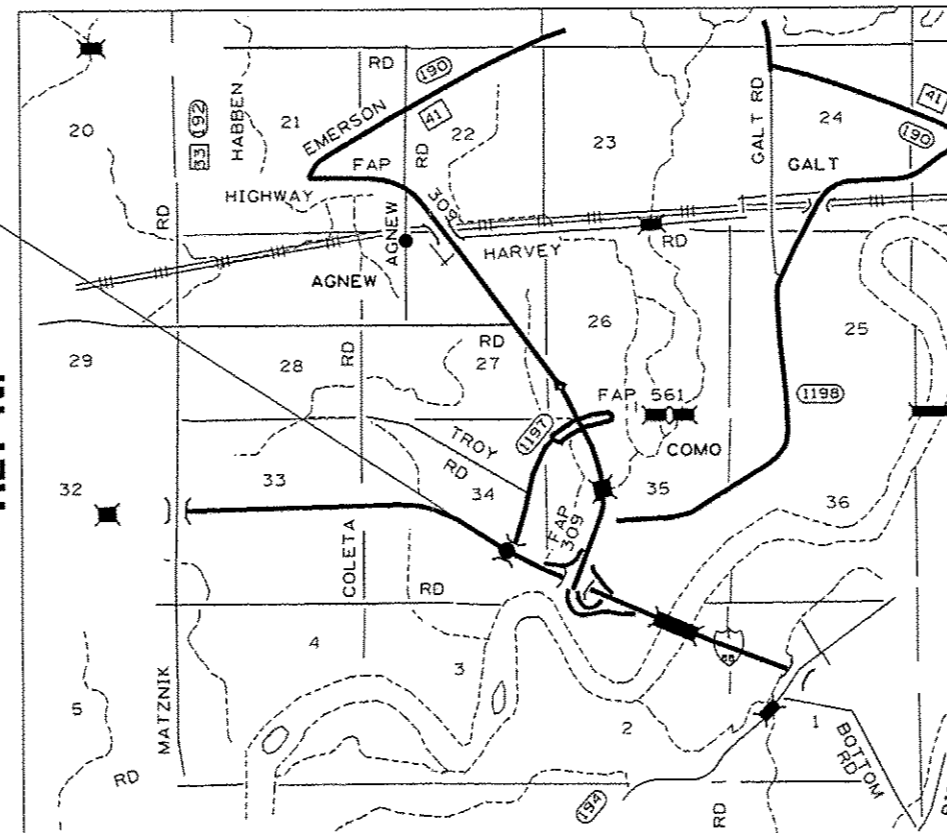

T.21 N.

T.21 N.

R.6

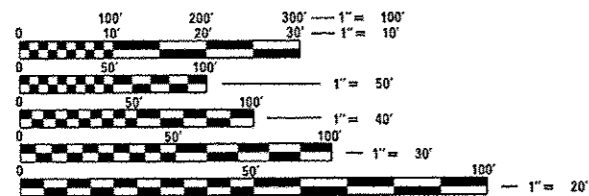

FULL SIZE PLANS HAVE BEEN PREPARED USING STANDARD ENGINEERING SCALES. REDUCED SIZED PLANS WILL NOT CONFORM TO STANDARD SCALES. IN MAKING MEASUREMENTS ON REDUCED PLANS, THE ABOVE SCALES MAY BE USED.

J.U.L.I.E.
JOINT UTILITY LOCATION INFORMATION FOR EXCAVATION
1-800-892-0123
OR 811

PROJECT MANAGER MAHMOUD ETEMADI (815) 284-5393

CONTRACT NO. 64K12

STATE OF ILLINOIS
DEPARTMENT OF TRANSPORTATION
DIVISION OF HIGHWAYS

SUBMITTED *March 14th 2014*

Paul E. [Signature]
DEPUTY DIRECTOR OF HIGHWAYS, REGION ENGINEER

May 9 2014
[Signature]
ENGINEER OF DESIGN AND ENVIRONMENT

May 9 2014
[Signature]
DIRECTOR OF HIGHWAYS, CHIEF ENGINEER

**PRINTED BY THE AUTHORITY
OF THE STATE OF ILLINOIS**