

MATCHING STA. 456 + 92.16

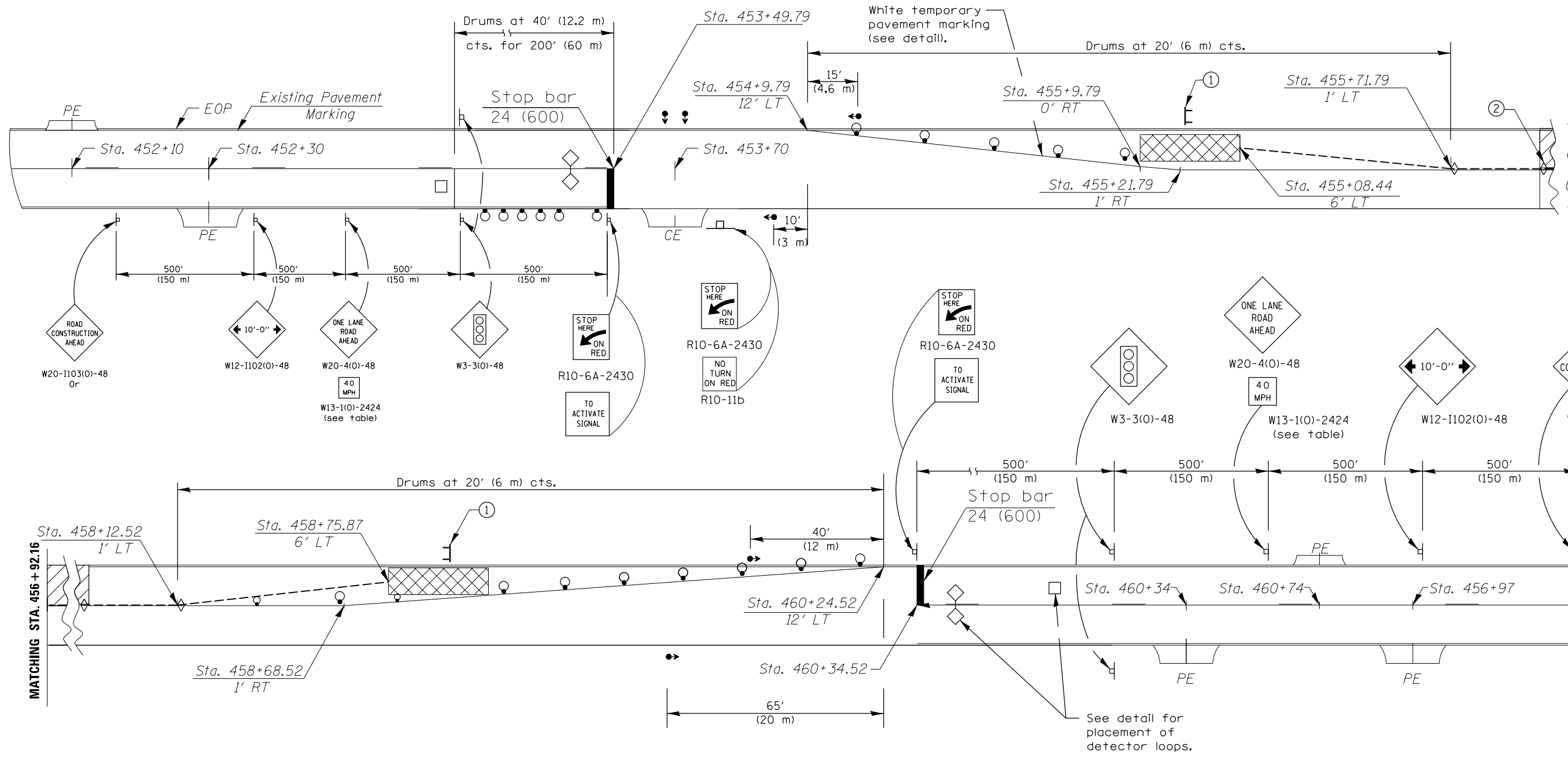

GENERAL NOTES

Traffic signals and a positive barrier are required. Traffic signals shall be operational only when all traffic controls are in place. When traffic signals are not in operation, flaggers shall be used and traffic control shall conform to Standard 701201.

Temporary concrete barrier shall be according to Standard 704001.

Existing or temporary pavement markings shall be on both sides of open lane from stop bar to stop bar.

All dimensions are in inches (millimeters) unless otherwise shown.

Barrier wall offsets are to the construction side of the wall.

SYMBOLS

- Drum with steady burning bi-directional light
- Temporary concrete barrier
- ▨ Temporary rumble strip (when specified)
- ▩ Double vertical panel (see detail)
- ◇ Crystal, bidirectional barrier wall/guardrail marker
- ▨ Work area
- ⊥ Sign
- ⊥ Type III barricade
- ⬄ Traffic signal
- ◇ Detector loops
- ▩ Impact attenuator

NOTES

- ① Type III barricade to be placed when no work is being performed.
- ② Barrier wall/guardrail markers at 25' (7.6 m) cts. See Standards 704001 & 635011.

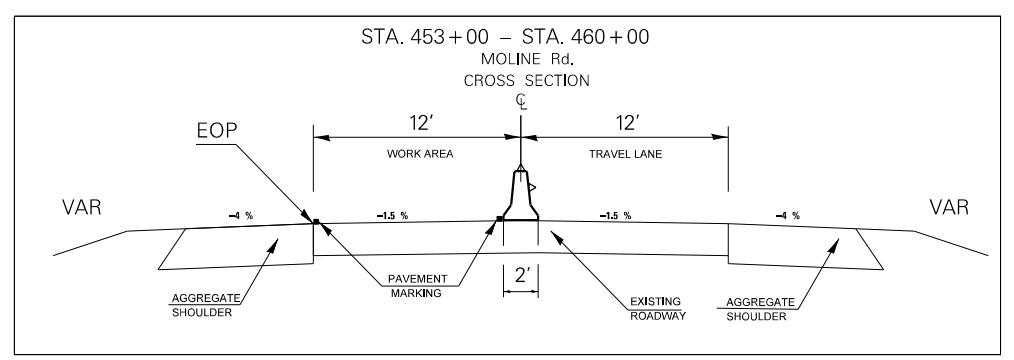

DESIGNED -	REVISIED -
DRAWN -	REVISIED -
CHECKED -	REVISIED -
DATE -	REVISIED -

STATE OF ILLINOIS
DEPARTMENT OF TRANSPORTATION

TRAFFIC CONTROL
STAGE 2

F.A.I. RTE.	SECTION	COUNTY	TOTAL SHEETS	SHEET NO.
88	D2 BRIDGE PAINTING 2014-5	WHITESIDE	12	5
				CONTRACT NO. 64K12
ILLINOIS				