

F.A.I. RTE.	SECTION	COUNTY	TOTAL SHEETS	SHEET NO.
55	D3 PATCHING 2015-3	GRUNDY	13	1
		ILLINOIS	CONTRACT NO. 66D77	

STATE OF ILLINOIS
DEPARTMENT OF TRANSPORTATION

06-13-14 LETTING ITEM 085

DIVISION OF HIGHWAYS
**PROPOSED
HIGHWAY PLANS**

FAI ROUTE 55 (I-55)
SECTION D3 PATCHING 2015-3

PAVEMENT PATCHING
GRUNDY COUNTY
C-93-100-14

INDEX OF SHEETS

1. COVER SHEET
2. GENERAL NOTES
- 3-4. SUMMARY OF QUANTITIES
5. TYPICAL SECTIONS
- 6-9. SCHEDULES
10. TRAFFIC CONTROL AND PROTECTION, STANDARD 701400 (SPECIAL)
- 11-12. CLASS A PATCHES
13. TYPICAL PAVEMENT MARKINGS

HIGHWAY STANDARDS

- 000001-06 STANDARD SYMBOLS, ABBREVIATIONS AND PATTERNS
- 001001-02 AREAS OF REINFORCEMENT BARS
- 001006 DECIMAL OF AN INCH AND OF A FOOT
- 420701-02 PAVEMENT FABRIC
- 421001-02 BAR REINFORCEMENT FOR CRC PAVEMENT
- 701101-04 OFF-ROAD OPERATIONS MULTILANE, 15' (4.5 m) TO 24' (600 mm) FROM PAVEMENT EDGE
- 701401-08 LANE CLOSURE, FREEWAY/EXPRESSWAY
- 701411-08 LANE CLOSURE, MULTILANE, AT ENTRANCE OR EXIT RAMP FOR SPEEDS ≥ 45 MPH
- 701426-06 LANE CLOSURE, MULTILANE INTERMITTENT OR MOVING OPERATION, FOR SPEEDS ≥ 45 MPH
- 701428 TRAFFIC CONTROL SETUP AND REMOVAL FREEWAY/EXPRESSWAY
- 701901-03 TRAFFIC CONTROL DEVICES

701400-07

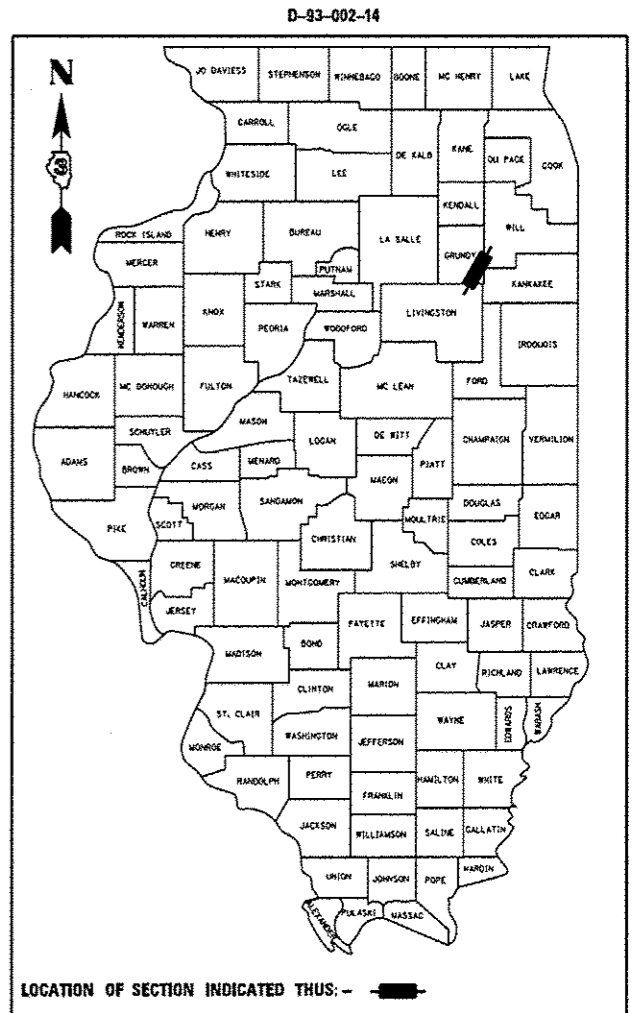

RURAL	
INTERSTATE	
FAI 55 (I-55)	
2013	
ADT	20600
P.V.	69.75%
S.U.	7.25%
M.U.	23.00%

STATE OF ILLINOIS
DEPARTMENT OF TRANSPORTATION
DIVISION OF HIGHWAYS

SUBMITTED *April 3 2014*
Paul Lenteo, P.E.
DEPUTY DIRECTOR OF HIGHWAYS, REGION ENGINEER

May 9 2014
John D. Baranzelle, P.E.
ENGINEER OF DESIGN AND ENVIRONMENT

May 9 2014
Omer Osman, P.E.
DIRECTOR OF HIGHWAYS, CHIEF ENGINEER

PROJECT BEGINS
LIVINGSTON COUNTY LINE
(M.P. 218.07)

PROJECT ENDS
WILL COUNTY LINE
(M.P. 233.49)

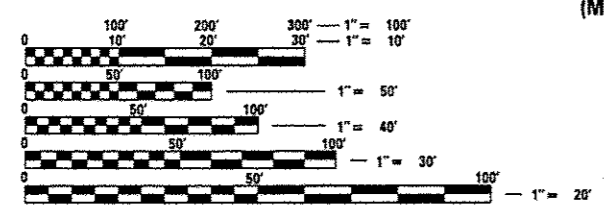

FULL SIZE PLANS HAVE BEEN PREPARED USING STANDARD ENGINEERING SCALES. REDUCED SIZED PLANS WILL NOT CONFORM TO STANDARD SCALES. IN MAKING MEASUREMENTS ON REDUCED PLANS, THE ABOVE SCALES MAY BE USED.

J.U.L.I.E.
JOINT UTILITY LOCATION INFORMATION FOR EXCAVATION
1-800-892-0123
OR 811

PROJECT ENGINEER: JOSEPH KANNEL, P.E.
UNIT CHIEF: RON WOODSHANK
TOWNSHIP: VARIOUS

CONTRACT NO. 66D77

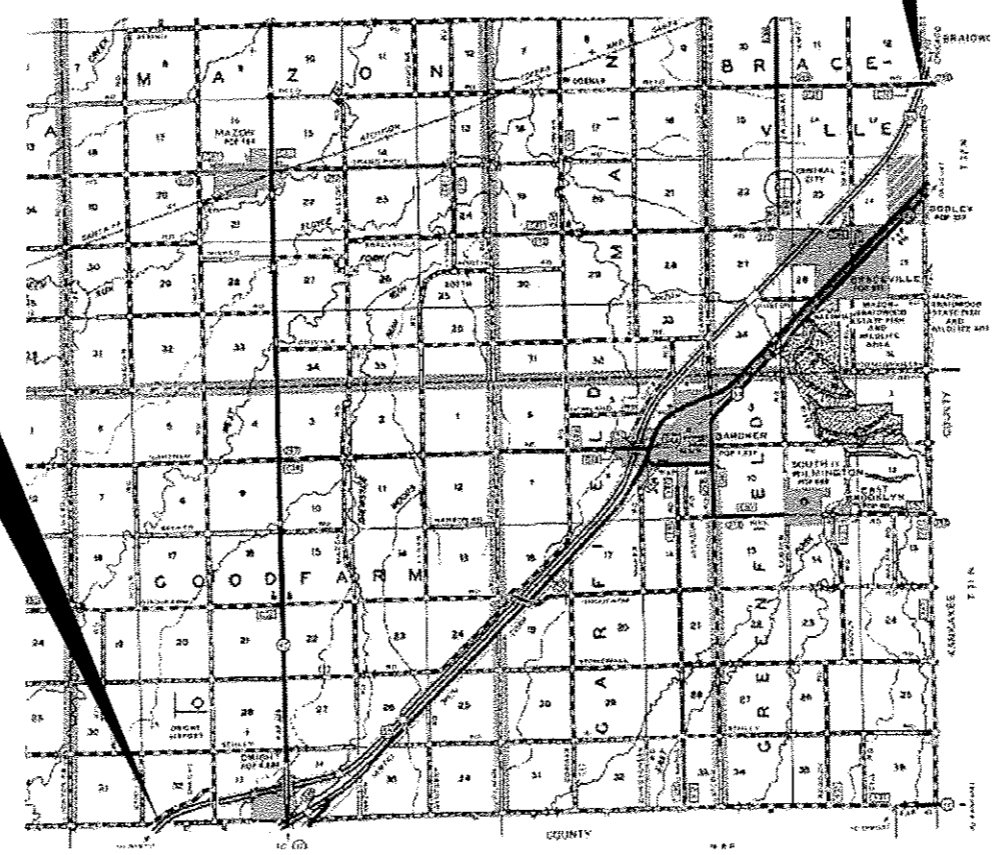

LOCATION MAP
NOT TO SCALE

GROSS LENGTH = 81417.60 FT. = 15.420 MILE
NET LENGTH = 724.00 FT. = 0.137 MILE

PRINTED BY THE AUTHORITY
OF THE STATE OF ILLINOIS

GENERAL NOTES

PLAN DIMENSIONS AND DETAILS RELATIVE TO EXISTING PLANS ARE SUBJECT TO NOMINAL CONSTRUCTION VARIATIONS. THE CONTRACTOR SHALL FIELD VERIFY EXISTING DIMENSIONS AND DETAILS AFFECTING NEW CONSTRUCTION AND MAKE NECESSARY APPROVED ADJUSTMENTS PRIOR TO CONSTRUCTION OR ORDERING OF MATERIALS. SUCH VARIATIONS SHALL NOT BE CAUSE FOR ADDITIONAL COMPENSATION FOR A CHANGE IN SCOPE OF WORK; HOWEVER, THE CONTRACTOR WILL BE PAID FOR THE QUANTITY ACTUALLY FURNISHED AT THE UNIT PRICE BID FOR THE WORK.

FOR STABILIZATION, ALL TYPE III BARRICADES WILL REQUIRE A MINIMUM OF FOUR SAND BAGS PER BARRICADE.

ANY REFERENCE TO A STANDARD IN THESE PLANS SHALL BE INTERPRETED TO MEAN THE EDITION AS INDICATED BY THE SUBNUMBER SHOWN IN THE LIST OF STANDARDS OR THE COPY INCLUDED IN THESE PLANS.

ALL EXCAVATED MATERIAL, WHICH INCLUDES DIGGING OR GRADING OF ANY SOIL OR FILL MATERIAL, WITH THE EXCEPTION OF AGGREGATE FILLS, MUST BE INCORPORATED WITHIN THE IDOT RIGHT OF WAY DUE TO ENVIRONMENTAL DOCUMENTATION REQUIREMENTS.

THE CONTRACTOR SHALL CONTACT JULIE AT LEAST 48 HOURS PRIOR TO EXCAVATION TO DETERMINE WHICH UTILITIES ARE IN THE AREA.

COMMITMENTS

DATE: 4-3-14

PREPARED BY: *Don Benoit*
DISTRICT STUDIES & PLANS ENGINEER

EXAMINED BY: *Michael J. [Signature]*
DISTRICT CONSTRUCTION ENGINEER

[Signature]
DISTRICT MATERIALS ENGINEER

Bruce A. Husler
DISTRICT OPERATIONS ENGINEER

FILE NAME *	USER NAME * #USER#	DESIGNED -	REVISED -
#FILE#		DRAWN -	REVISED -
	PLOT SCALE * #SCALE#	CHECKED -	REVISED -
#MODELNAME#	PLOT DATE * #DATE#	DATE -	REVISED -

STATE OF ILLINOIS
DEPARTMENT OF TRANSPORTATION

GENERAL NOTES

SCALE: SHEET 1 OF 1 SHEETS STA. TO STA.

F.A.I. RTE.	SECTION	COUNTY	TOTAL SHEETS	SHEET NO.
55	D3 PATCHING 2015-3	GRUNDY	13	2
CONTRACT NO. 66077				
[ILLINOIS] FED. AID PROJECT				

CODE NO.	ITEM	UNIT	TOTAL QUANTITY	CONSTR. CODE
				STATE 100% ROADWAY 0005 RURAL
44200541	CLASS A PATCHES, TYPE II, 9 INCH	SQ YD	274	274
44200545	CLASS A PATCHES, TYPE III, 9 INCH	SQ YD	40	40
44200547	CLASS A PATCHES, TYPE IV, 9 INCH	SQ YD	27	27
44200620	CLASS A PATCHES, TYPE II, 14 INCH	SQ YD	317	317
44200624	CLASS A PATCHES, TYPE III, 14 INCH	SQ YD	120	120
44200628	CLASS A PATCHES, TYPE IV, 14 INCH	SQ YD	187	187
44213000	PATCHING REINFORCEMENT	SQ YD	965	965
44213100	PAVEMENT FABRIC	SQ YD	624	624
44213200	SAW CUTS	FOOT	5192	5192
44213204	TIE BARS 3/4"	EACH	146	146
67100100	MOBILIZATION	L SUM	1	1
70100420	TRAFFIC CONTROL AND PROTECTION, STANDARD 701411	EACH	8	8
70103815	TRAFFIC CONTROL SURVEILLANCE	CAL DA	15	15
X 14 78009004	MODIFIED URETHANE PAVEMENT MARKING - LINE 4"	FOOT	724	724

*Specialty Items

Rev.

FILE NAME *	USER NAME * #USER#	DESIGNED -	REVISED -	STATE OF ILLINOIS DEPARTMENT OF TRANSPORTATION	SUMMARY OF QUANTITIES	F.A.I. RTE.	SECTION	COUNTY	TOTAL SHEETS	SHEET NO.	
#FILE#		DRAWN -	REVISED -			55	D3 PATCHING 2015-3	GRUNDY	13	3	
#MODELNAME#	PLOT SCALE * #SCALE#	CHECKED -	REVISED -			CONTRACT NO. 66077					
	PLOT DATE * #DATE#	DATE -	REVISED -			SCALE:	SHEET 1	OF 2	SHEETS	STA.	TO STA.

CODE NO.	ITEM	UNIT	TOTAL QUANTITY	CONSTR. CODE	
				STATE 100% ROADWAY 0005 RURAL	
X 78009006	MODIFIED URETHANE PAVEMENT MARKING - LINE 6"	FOOT	700	700	
X7010410	SPEED DISPLAY TRAILER	CAL MO	1	1	
X7010805	TRAFFIC CONTROL AND PROTECTION, STANDARD 701401 (SPECIAL)	L SUM	1	1	
Z0030850	TEMPORARY INFORMATION SIGNING	SQ FT	42	42	

X

u

**Specialty Items*

FILE NAME *	USER NAME * santeoruxjo	DESIGNED -	REVISED -	STATE OF ILLINOIS DEPARTMENT OF TRANSPORTATION	SUMMARY OF QUANTITIES	F.A.I. RTE.	SECTION	COUNTY	TOTAL SHEETS	SHEET NO.	
at:\p\work\p\id\seanteoruxjo\d0201285\366077-sht-details.dgn		DRAWN -	REVISED -			95	D5 PATCHING 2015-3	GRUNDY	13	4	
#MODELNAME*	PLOT SCALE * 500000.1838 ' / in.	CHECKED -	REVISED -			SCALE: SHEET 2 OF 2 SHEETS STA. TO STA.		ILLINOIS FED. AID PROJECT CONTRACT NO. 66D77			
	PLOT DATE * 3/31/2014	DATE -	REVISED -								

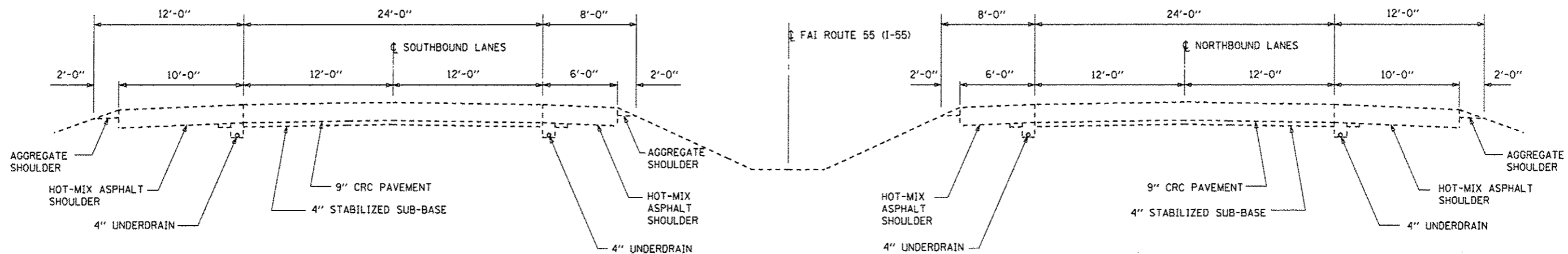

**TYPICAL SECTION
MAINLINE**
M.M. 218.07 TO M.M. 221.10

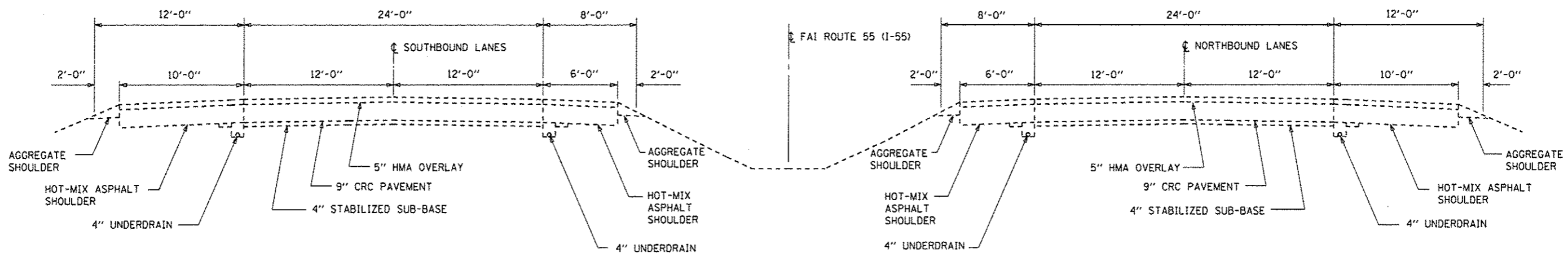

**TYPICAL SECTION
MAINLINE**
M.M. 221.10 TO M.M. 233.49

FILE NAME *	USER NAME = santacruzja	DESIGNED -	REVISED -	STATE OF ILLINOIS DEPARTMENT OF TRANSPORTATION	TYPICAL SECTIONS	F.A.I. RTE.	SECTION	COUNTY	TOTAL SHEETS	SHEET NO.	
0:\pwwork\pwwork\pwwork\santacruzja\0366077-shr-detail.dgn	PLOT SCALE = 500000.1838 * / 1/8"	DRAWN -	REVISED -			55	D3 PATCHING 2015-3	GRUNDY	13	5	
#MODELNAME*	PLOT DATE = 3/31/2014	CHECKED -	REVISED -			CONTRACT NO. 66077					
		DATE -	REVISED -			ILLINOIS FED. AID PROJECT					
					SCALE:	SHEET 1 OF 1 SHEETS		STA.	TO STA.		

SCHEDULE - NBL CLASS A PATCHING 14"														
LOCATION BY MILE MARKER	PASSING LANE							DRIVING LANE						
	CLASS A PATCHING			PATCH REINF.	PAV'T FABRIC	SAW CUTS	TIE BARS	CLASS A PATCHING			PATCH REINF.	PAV'T FABRIC	SAW CUTS	TIE BARS
	TYPE II	TYPE III	TYPE IV					TYPE II	TYPE III	TYPE IV				
SQ YD	SQ YD	SQ YD	SQ YD	SQ YD	FOOT	EACH	SQ YD	SQ YD	SQ YD	SQ YD	SQ YD	FOOT	EACH	
222.00	13			13	13	68								
222.10			40	40	40	108	28							
226.50	13			13	13	68								
226.51		20		20	20	78								
226.52	8			8	8	60								
227.40		20		20	20	78								
227.50	8			8	8	60								
227.70	8			8	8	60		8			8	8	60	
227.80								8			8	8	60	
227.90										27	27	27	88	18
228.20										27	27	27	88	18
228.50		20		20	20	78		13			13	13	68	
231.70										33	33	33	98	23
231.90									20		20	20	78	
213.95										33	33	33	98	23
232.00								8			8	8	60	
TOTALS	51	60	40	151	151	658	28	37	20	120	177	177	698	82

SCHEDULE - NBL CLASS A PATCHING 9"														
LOCATION BY MILE MARKER	PASSING LANE							DRIVING LANE						
	CLASS A PATCHING			PATCH REINF.	SAW CUTS	TIE BARS	CLASS A PATCHING			PATCH REINF.	SAW CUTS	TIE BARS		
	TYPE II	TYPE III	TYPE IV				TYPE II	TYPE III	TYPE IV					
SQ YD	SQ YD	SQ YD	SQ YD	FOOT	EACH	SQ YD	SQ YD	SQ YD	SQ YD	FOOT	EACH			
218.50						13				13	68			
218.60						8				8	60			
218.61						8				8	60			
218.62						8				8	60			
218.70						11				11	64			
218.80						13				13	68			
218.81						13				13	68			
218.90						8				8	60			
218.91						13				13	68			
218.92						13				13	68			
219.00		20		20	78	8				8	60			
219.30						8				8	60			
219.40						8				8	60			
219.50						13				13	68			
220.60						8				8	60			
220.61						8				8	60			
220.70						8				8	60			
220.80						11				11	64			
220.81						8				8	60			
220.82						13				13	68			
221.10		20		20	78									
TOTALS		40		40	156			203		203	1264			

SCHEDULE - SBL CLASS A PATCHING 14"														
LOCATION BY MILE MARKER	PASSING LANE							DRIVING LANE						
	CLASS A PATCHING			PATCH REINF.	PAV'T FABRIC	SAW CUTS FOOT	TIE BARS EACH	CLASS A PATCHING			PATCH REINF.	PAV'T FABRIC	SAW CUTS FOOT	TIE BARS EACH
	TYPE II SQ YD	TYPE III SQ YD	TYPE IV SQ YD					TYPE II SQ YD	TYPE III SQ YD	TYPE IV SQ YD				
231.70			27	27	27	88	18							
229.10								13			13	13	68	
228.10								13			13	13	68	
226.90								8			8	8	60	
226.30								8			8	8	60	
225.80								8			8	8	60	
225.70								8			8	8	60	
225.60	8			8	8	60		8			8	8	60	
225.40								8			8	8	60	
225.20								8			8	8	60	
225.10								8			8	8	60	
224.90	8			8	8	60		8			8	8	60	
224.60								8			8	8	60	
224.30								8			8	8	60	
224.20								8			8	8	60	
224.19								8			8	8	60	
224.00								8			8	8	60	
223.80	8			8	8	60		8			8	8	60	
223.50									20		20	20	78	
223.20								8			8	8	60	
222.50								8			8	8	60	
221.90								8			8	8	60	
221.80								8			8	8	60	
221.50	8			8	8	60		11			11	11	64	
221.20		20		20	20	78		8			8	8	60	
TOTALS	32	20	27	79	79	406	18	197	20		217	217	1478	

SCHEDULE - SBL CLASS A PATCHING 9"													
LOCATION BY MILE MARKER	PASSING LANE						DRIVING LANE						
	CLASS A PATCHING			PATCH REINF.	SAW CUTS FOOT	TIE BARS EACH	CLASS A PATCHING			PATCH REINF.	SAW CUTS FOOT	TIE BARS EACH	
	TYPE II SQ YD	TYPE III SQ YD	TYPE IV SQ YD				TYPE II SQ YD	TYPE III SQ YD	TYPE IV SQ YD				
219.90								8			8	60	
219.30										27	27	88	18
219.00								8			8	60	
218.99	8			8	60								
218.40								8			8	60	
218.30								13			13	68	
218.20	13			13	68								
218.19								13			13	68	
TOTAL	21			21	128			51		27	77	404	18

SCHEDULE - PAVEMENT MARKING				
LOCATION		MODIFIED URETHANE PAVEMENT MARKING TYPE 1, LINE 4"		MODIFIED URETHANE PAVEMENT MARKING TYPE 1, LINE 6"
MILE POST		YELLOW	WHITE	WHITE
222.00	NB	10		10
222.10	NB	30		10
226.50	NB	10		10
226.51	NB	15		10
226.52	NB	6		10
227.40	NB	15		10
227.50	NB	6		10
227.70	NB	6	6	10
227.80	NB		6	10
227.90	NB		20	10
228.20	NB		20	10
228.50	NB	15	10	10
231.70	NB		25	10
231.90	NB		15	10
213.95	NB		25	10
232.00	NB		6	10
SUBTOTAL		113	133	160
PAGE 1 TOTAL		246		160

SCHEDULE - PAVEMENT MARKING				
LOCATION		MODIFIED URETHANE PAVEMENT MARKING TYPE1, LINE 4"		MODIFIED URETHANE PAVEMENT MARKING TYPE1, LINE 6"
MILE POST		YELLOW	WHITE	WHITE
218.50	NB		10	10
218.60	NB		6	10
218.61	NB		6	10
218.62	NB		6	10
218.70	NB		8	10
218.80	NB		10	10
218.81	NB		10	10
218.90	NB		6	10
218.91	NB		10	10
218.92	NB		10	10
219.00	NB	15	6	10
219.30	NB		6	10
219.40	NB		6	10
219.50	NB		10	10
220.60	NB		6	10
220.61	NB		6	10
220.70	NB		6	10
220.80	NB		8	10
220.81	NB		6	10
220.82	NB		10	10
221.10	NB	15		10
SUBTOTAL		30	152	210
PAGE 2 TOTAL		182		210
NB TOTAL		428		370

SCHEDULE - PAVEMENT MARKING				
LOCATION		MODIFIED URETHANE PAVEMENT MARKING TYPE 1, LINE 4"		MODIFIED URETHANE PAVEMENT MARKING TYPE 1, LINE 6"
MILE POST		YELLOW	WHITE	WHITE
231.70	SB	20		10
229.10	SB		10	10
228.10	SB		10	10
226.90	SB		6	10
226.30	SB		6	10
225.80	SB		6	10
225.70	SB		6	10
225.60	SB	6	6	10
225.40	SB		6	10
225.20	SB		6	10
225.10	SB		6	10
224.90	SB	6	6	10
224.60	SB		6	10
224.30	SB		6	10
224.20	SB		6	10
224.19	SB		6	10
224.00	SB		6	10
223.80	SB	6	6	10
223.50	SB		15	10
223.20	SB		6	10
222.50	SB		6	10
221.90	SB		6	10
221.80	SB		6	10
221.50	SB	6	8	10
221.20	SB	15	6	10
SUBTOTAL		59	163	250
PAGE 1 TOTAL		222		250

SCHEDULE - PAVEMENT MARKING				
LOCATION		MODIFIED URETHANE PAVEMENT MARKING TYPE 1, LINE 4"		MODIFIED URETHANE PAVEMENT MARKING TYPE 1, LINE 6"
MILE POST		YELLOW	WHITE	WHITE
219.90	SB		6	10
219.30	SB		20	10
219.00	SB		6	10
218.99	SB	6		10
218.40	SB		6	10
218.30	SB		10	10
218.20	SB	10		10
218.19	SB		10	10
SUBTOTAL		16	58	80
PAGE 2 TOTAL		74		80
SB TOTAL		296		330

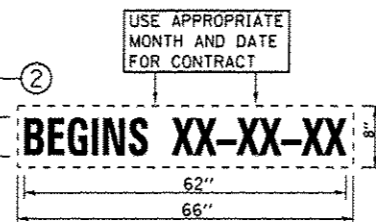
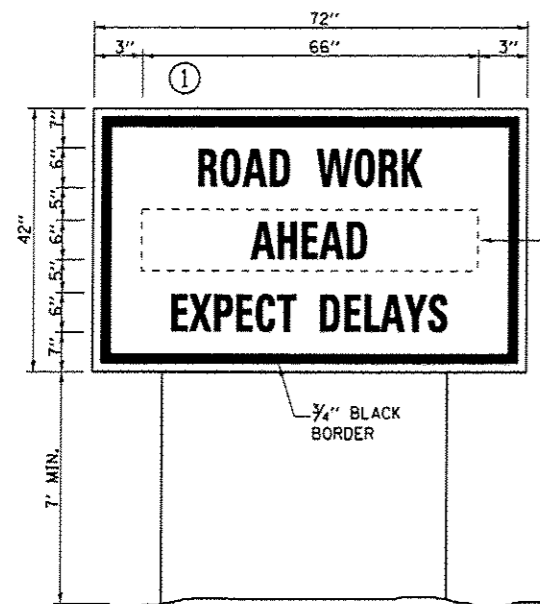
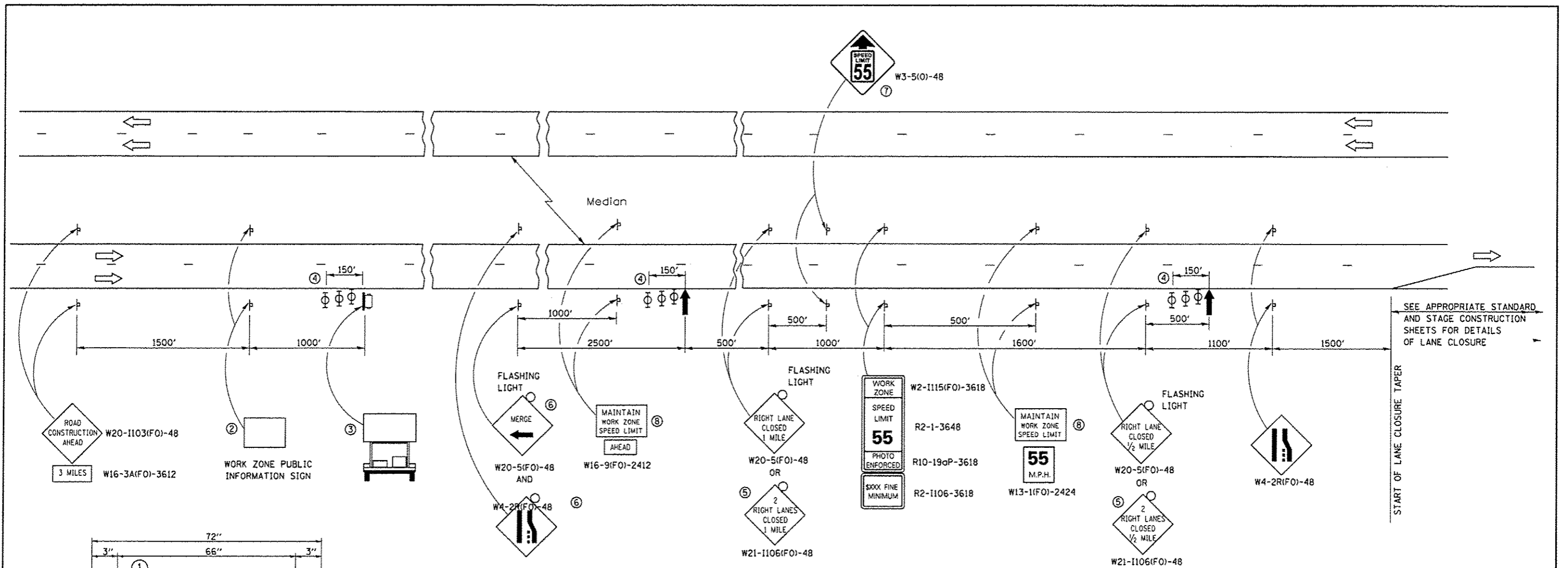

- ① THE ROAD CONSTRUCTION AHEAD SIGN SHALL BE LOCATED 3 MILES IN ADVANCE OF THE PROJECT LIMITS.
- ② THE MESSAGE AND SIZE OF THE WORK ZONE PUBLIC INFORMATION SIGN SHALL BE AS SPECIFIED BY THE DEPARTMENT.
- ③ TO BE PLACED IN THE MEDIAN WHEN FEASIBLE. THE MESSAGE BOARD SHALL BE USED TO DISPLAY STATUS OF LANES WITHIN THE PROJECT. THE PRIMARY MESSAGES SHALL BE:
 "RIGHT LANE CLOSED" / " x MILES AHEAD"
 "LEFT LANE CLOSED" / " x MILES AHEAD"
 "ALL LANES OPEN"
- ④ THREE, TYPE II BARRICADES, DRUMS, OR VERTICAL BARRICADES AT 50' CENTERS.
- ⑤ THIS SIGN SHALL BE USED WHEN 2 LANES ARE CLOSED.
- ⑥ WHEN THE LEFT LANE IS CLOSED, SWITCH THESE TWO SIGNS AND THE DIRECTION OF THE MERGE ARROW.
- ⑦ THIS SIGN SHALL ONLY BE USED IF THE EXISTING SPEED LIMIT IS GREATER THAN 65 MPH.
- ⑧ 48"x36" FLUORESCENT ORANGE SIGN WITH BLACK LETTERS.

NOTES FOR "TEMPORARY INFORMATION SIGNING"

1. USE 6" D BLACK LETTERING ON FLOURESENT ORANGE BACKGROUND.
2. ERECT SIGNS AT LOCATIONS IN ADVANCE OF THE "ROAD CONSTRUCTION AHEAD" SIGNS AS DIRECTED BY THE ENGINEER.
3. ERECT SIGN ① WITH INSTALLED PANEL ② A MINIMUM OF ONE WEEK PRIOR TO THE START OF THE LANE CLOSURE.
4. REMOVE PANEL ② ON THAT DATE.
5. SEE SPECIAL PROVISION "TEMPORARY INFORMATION SIGNING" FOR ADDITIONAL INFORMATION.
6. WILL BE PAID FOR PER SQ FT AS "TEMPORARY INFORMATION SIGNING". EACH SIGN = 21 SQ FT AND THE DATE PANEL ② WILL NOT BE MEASURED SEPARATELY FOR PAYMENT.

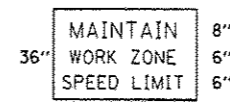

- ↑ ARROW BOARD
- PORTABLE CHANGEABLE MESSAGE SIGN
- ⊥ SIGN
- ⊕ TYPE II BARRICADE, DRUM, OR VERTICAL BARRICADE WITH MONODIRECTIONAL FLASHING LIGHT

GENERAL NOTE:

THIS STANDARD IS USED WHERE AT ANY TIME A LANE IS CLOSED ON A FREEWAY/EXPRESSWAY. WHEN THE LEFT LANE IS CLOSED, LEFT LANE CLOSED SIGNS SHALL BE SUBSTITUTED FOR THE RIGHT LANE CLOSED SIGNS. THE FIRST TWO SIGNS AND THE MESSAGE BOARD ARE STATIONARY. THE OTHER SIGNS AND ARROWBOARDS SHALL BE MOVED AS NECESSARY TO MAINTAIN THE REQUIRED DISTANCE FROM THE START OF THE LANE CLOSURE TAPER(S).

SEE SPECIAL PROVISIONS.

ALL DIMENSIONS ARE IN INCHES UNLESS OTHERWISE SHOWN.

FILE NAME *	USER NAME = sentacruzja	DESIGNED -	REVISED -	STATE OF ILLINOIS DEPARTMENT OF TRANSPORTATION	TRAFFIC CONTROL AND PROTECTION, STANDARD 701400 (SPECIAL)	F.A.I. RTE.	SECTION	COUNTY	TOTAL SHEETS	SHEET NO.
or \p-work\pudost\sentacruzja\0361285\0368077-std-details.dgn	DRAWN -	REVISED -	55			03 PATCHING 2015-3	GRUNDY	13	10	
MODELNAME*	PLOT SCALE * 500000.1838 / in.	CHECKED -	REVISED -			CONTRACT NO. 66D77				
	PLOT DATE * 3/31/2014	DATE -	REVISED -			ILLINOIS FED. AID PROJECT				

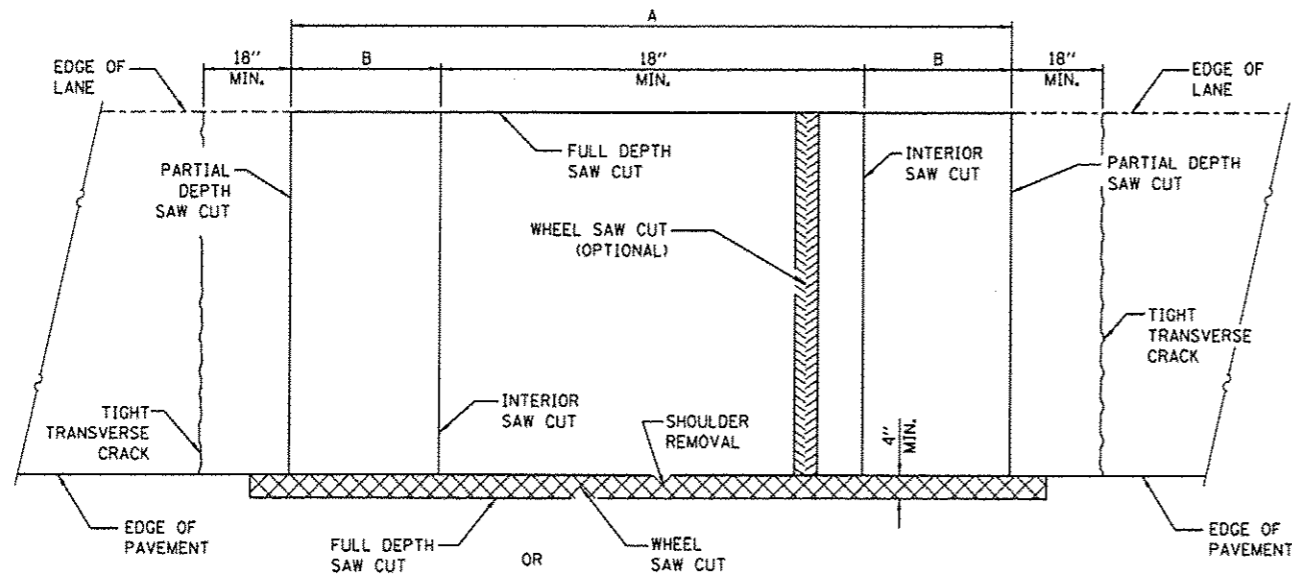

PAVEMENT SAWING DETAIL
(HMA SHOULDER)

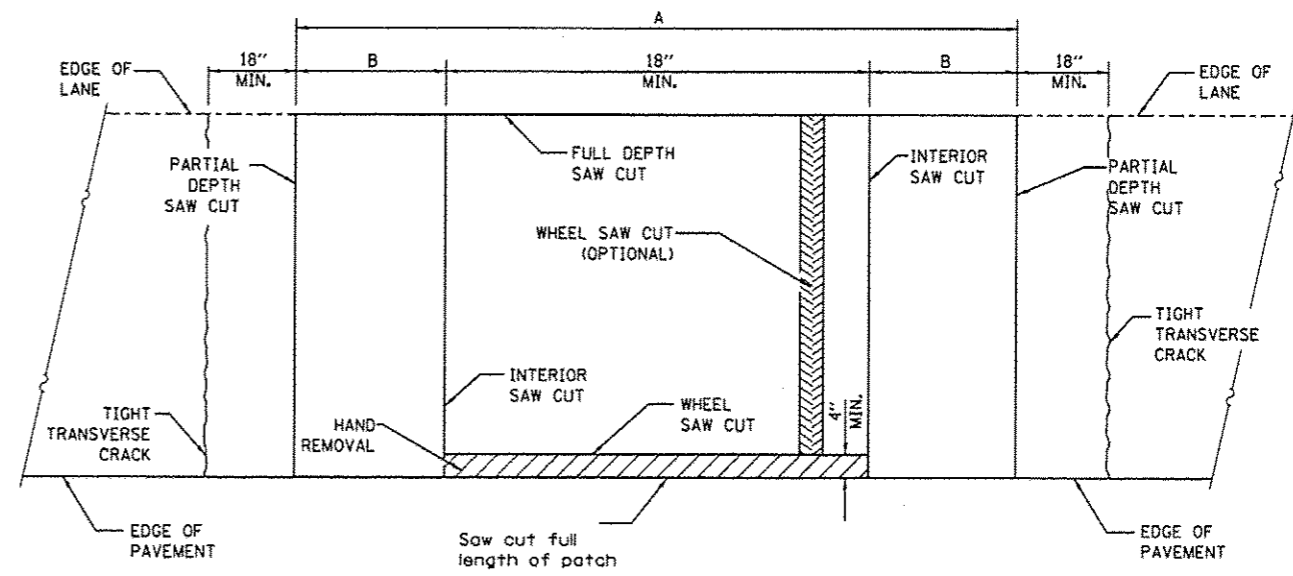

PAVEMENT SAWING DETAIL
(PCC SHOULDER)

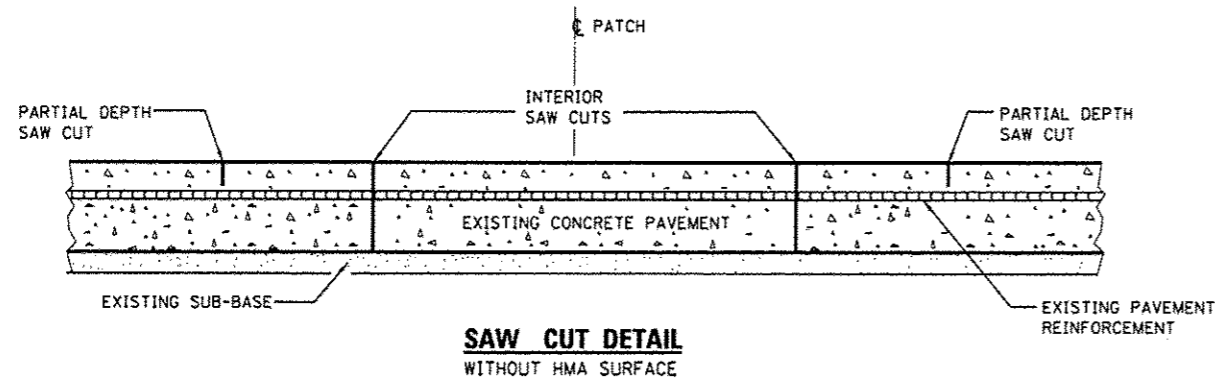

SAW CUT DETAIL
WITHOUT HMA SURFACE

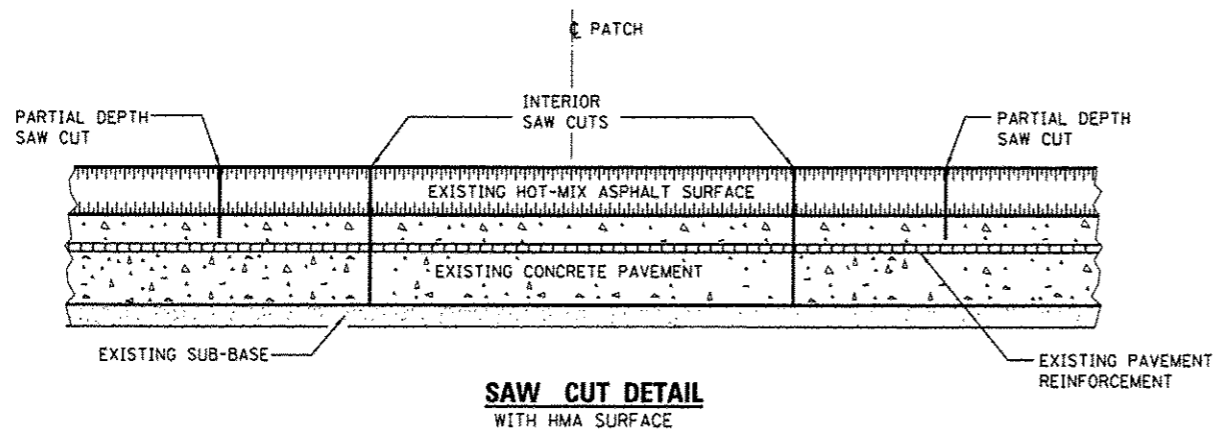

SAW CUT DETAIL
WITH HMA SURFACE

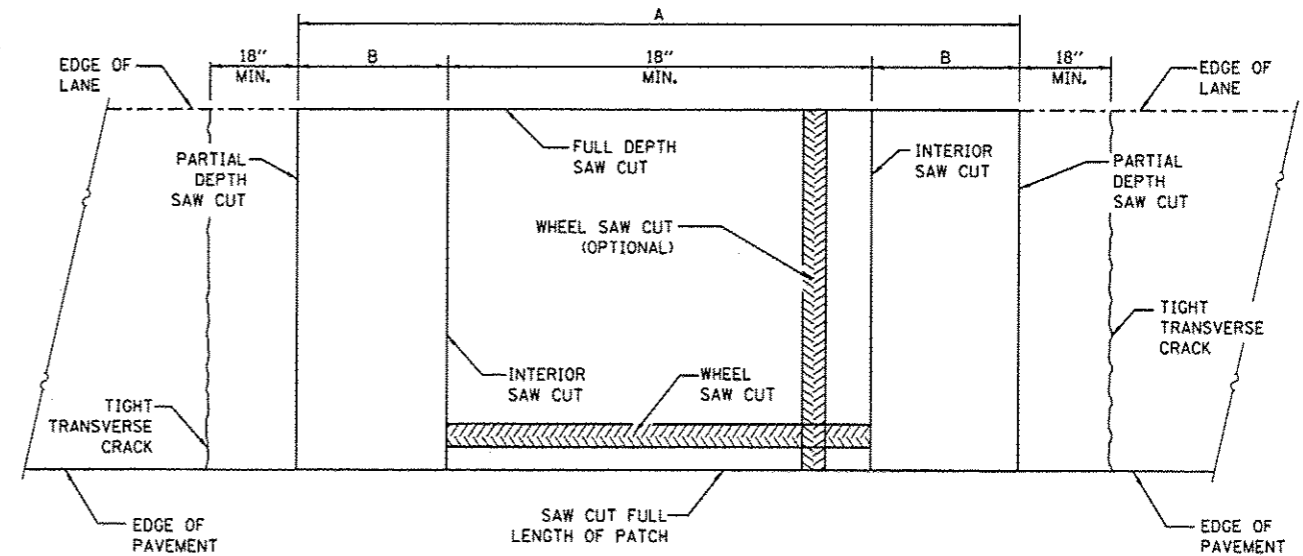

ALTERNATE SAWING DETAIL
(PCC SHOULDER)

EXISTING REINFORCEMENT BARS	A (MIN.)	B (MIN.)	C (MIN.)
#5	4'-6"	18"	16"
#6	5'-0"	21"	19"
#7	5'-6"	24"	22"
FABRIC	5'-0"	21"	18"

GENERAL NOTES

WHEN PATCHING TWO ADJACENT LANES IN ONE OPERATION THE LONGITUDINAL JOINT SHALL BE LONGITUDINAL SAWED JOINT AS DETAILED ON STANDARD 42001, HOWEVER, THE GROOVE MAYBE EITHER PREFORMED OR SAWED.

SEE STANDARD 421001 FOR DETAILS OF PAVEMENT REINFORCEMENT.

FILE NAME :	USER NAME :	DESIGNED -	REVISED -
or:\work\p\id\tsontacruz\ad\201205\366077-shs-details.dgn	tsontacruz	DRAWN -	REVISED -
#MODELNAME#	PLOT SCALE :	CHECKED -	REVISED -
	PLOT DATE :	DATE -	REVISED -

STATE OF ILLINOIS
DEPARTMENT OF TRANSPORTATION

CLASS A PATCHES

SCALE: SHEET 1 OF 2 SHEETS STA. TO STA.

F.A.I. RTE.	SECTION	COUNTY	TOTAL SHEETS	SHEET NO.
55	D3 PATCHING 2015-3	GRUNDY	13	11
CONTRACT NO. 66077				
ILLINOIS FED. AID PROJECT				

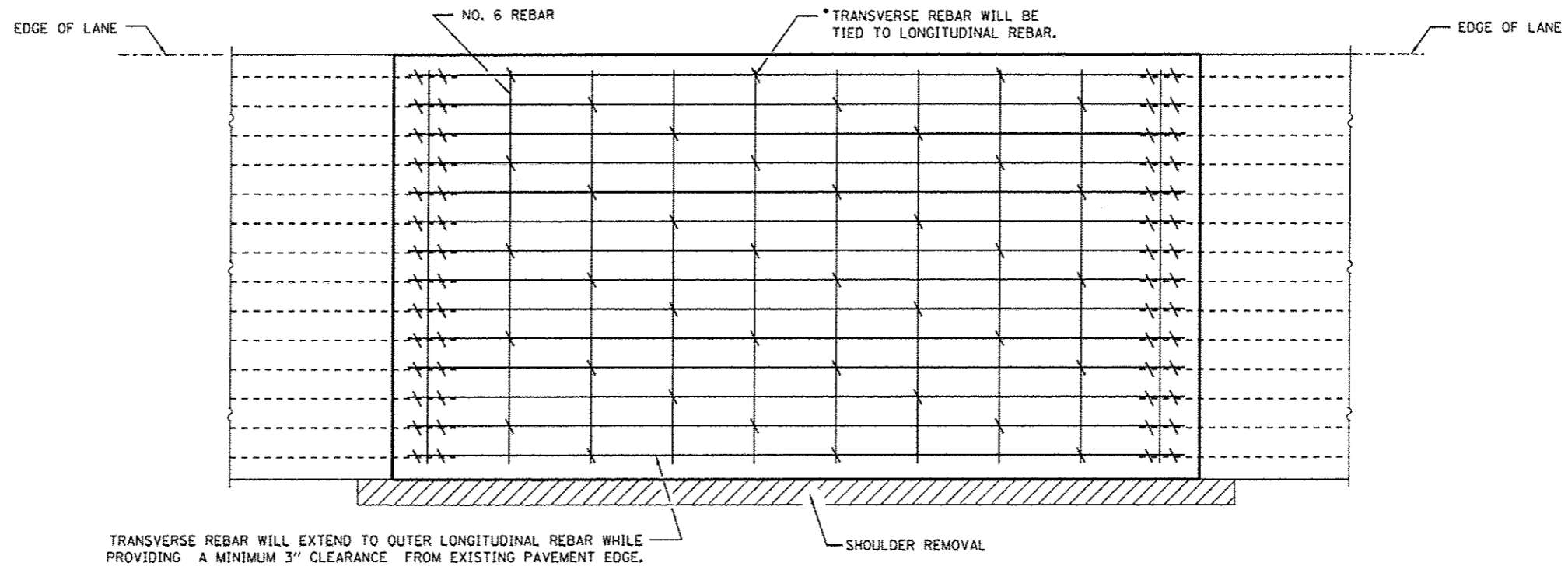

PAVEMENT REINFORCEMENT DETAIL

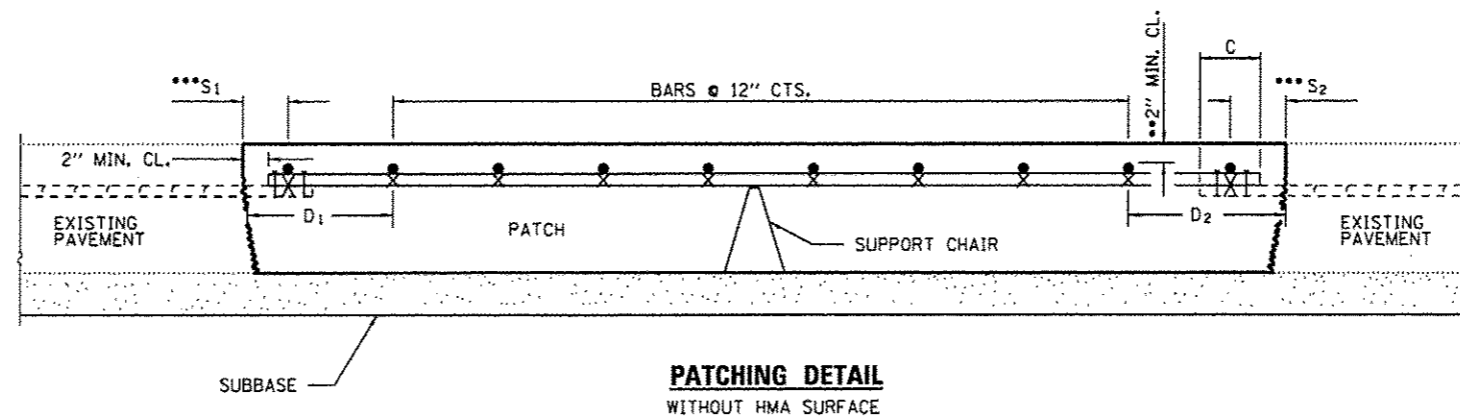

**PATCHING DETAIL
WITHOUT HMA SURFACE**

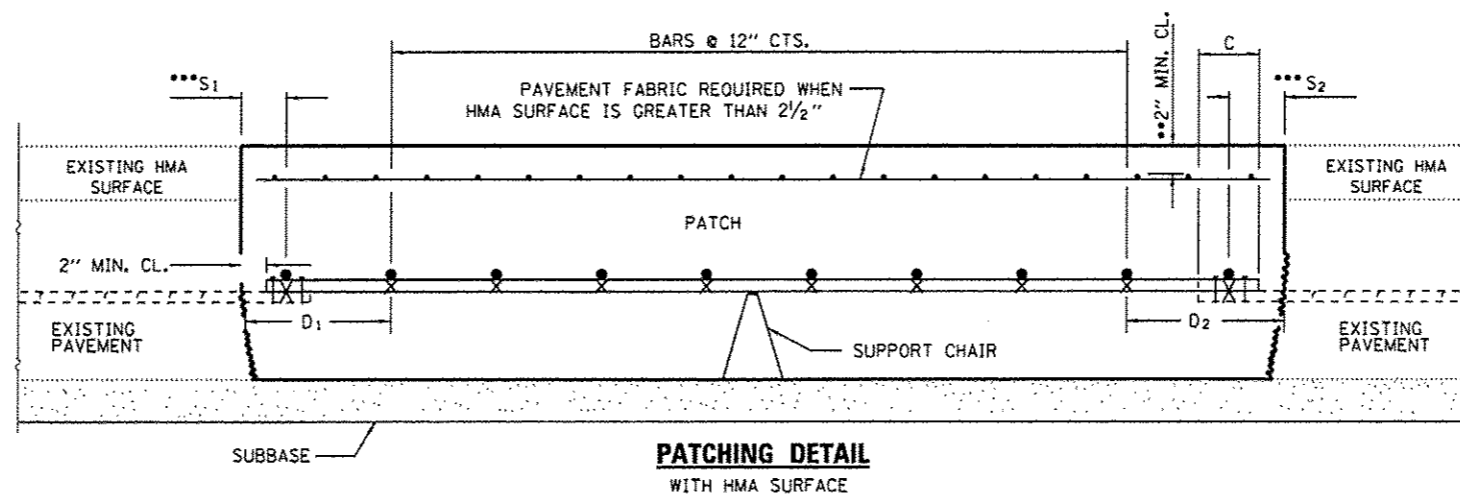

**PATCHING DETAIL
WITH HMA SURFACE**

- EVERY 3rd INTERSECTION MUST BE TIED.
- WHEN THE MINIMUM CLEARANCE CANNOT BE OBTAINED WITH THE TRANSVERSE REBAR ON TOP, THEN THE TRANSVERSE REBAR SHALL BE TIED TO THE BOTTOM OF THE LONGITUDINAL REBAR.
- VARIABLES: WHERE S_1 AND S_2 ARE $2\frac{1}{2}$ " MIN. AND 12" MAX. $D_1 = 2(S_1)$ AND $D_2 = 2(S_2)$.

FILE NAME =	USER NAME = sentacruz.je	DESIGNED -	REVISED -
c:\pw\work\pavdat\sentacruz.je\d381285\036677-ah\detailed.dgn		DRAWN -	REVISED -
	PLOT SCALE = 500000.1830 1 / in.	CHECKED -	REVISED -
#MODELNAME*	PLOT DATE = 3/31/2014	DATE -	REVISED -

STATE OF ILLINOIS
DEPARTMENT OF TRANSPORTATION

CLASS A PATCHES

SCALE: SHEET 2 OF 2 SHEETS STA. TO STA.

P.A.I. RTE.	SECTION	COUNTY	TOTAL SHEETS	SHEET NO.
65	D3 PATCHING 2015-3	GRUNDY	13	12
CONTRACT NO. 66077				
ILLINOIS FED. AID PROJECT				

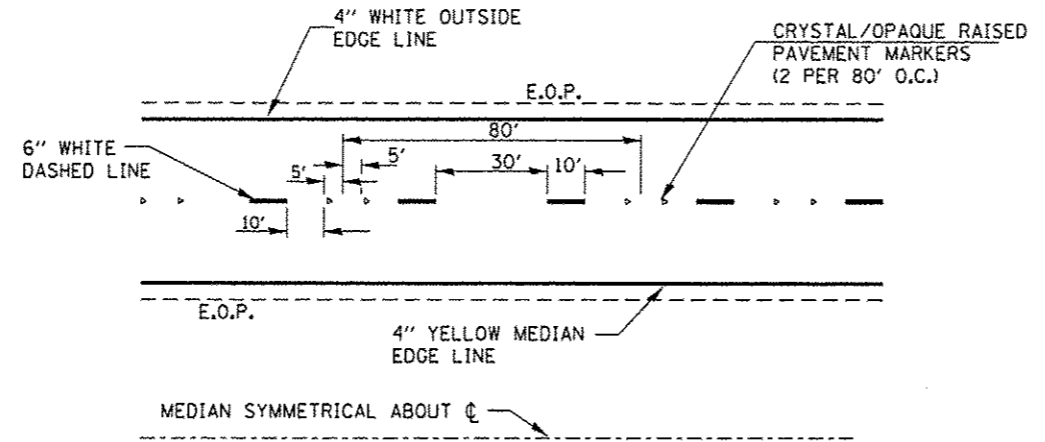

TYPICAL PAVEMENT MARKINGS

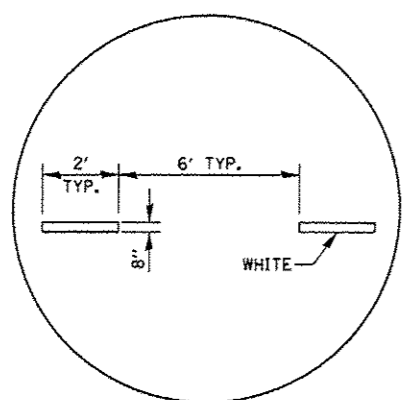

INTERSTATE RAMP TRANSITION LINE

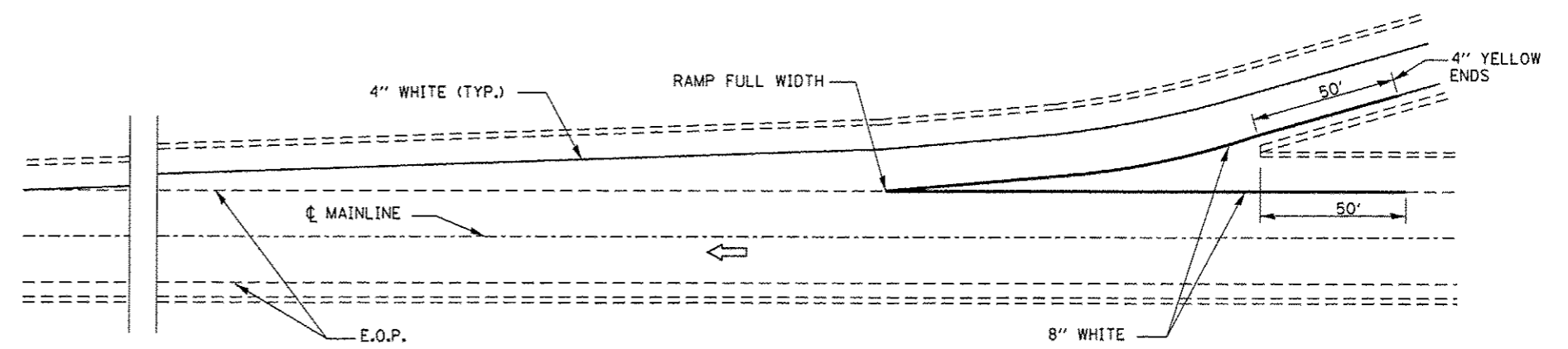

TYPICAL PAVEMENT MARKING FOR ENTRANCE RAMP TERMINALS

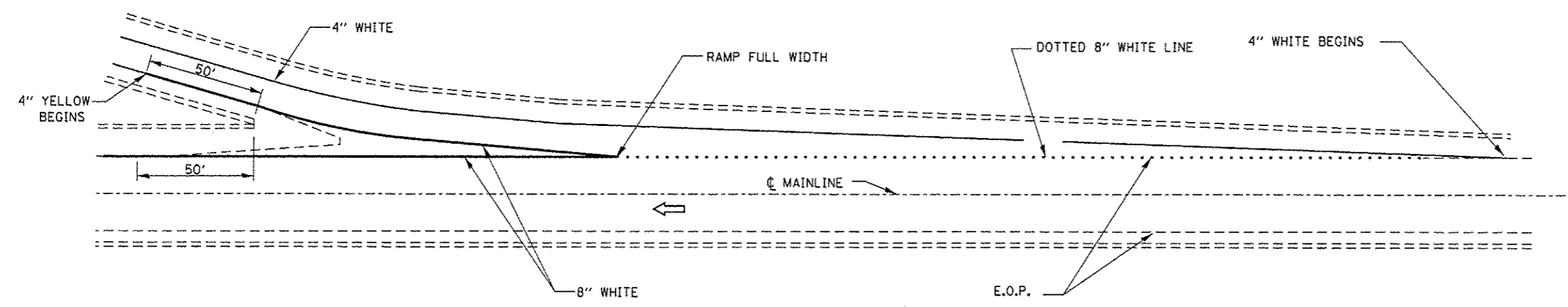

TYPICAL PAVEMENT MARKINGS FOR EXIT RAMP TERMINALS

FILE NAME *	USER NAME = santacruzja	DESIGNED -	REVISED -	STATE OF ILLINOIS DEPARTMENT OF TRANSPORTATION	TYPICAL PAVEMENT MARKINGS		F.A.I. RTE.	SECTION	COUNTY	TOTAL SHEETS	SHEET NO.
c:\pwwork\pwwork\santacruzja\9281285\0368077.sht-detail.dgn	DRAWN -	REVISED -	65				D3 PATCHING 2016-3	GRUNDY	13	13	
#MODELNAME*	PLOT SCALE = 580000.1838 1/125	CHECKED -	REVISED -		SCALE: SHEET 1 OF 1 SHEETS STA. TO STA.		CONTRACT NO. 66077		ILLINOIS FED. AID PROJECT		
	PLOT DATE = 3/31/2014	DATE -	REVISED -								