

|          |  |
|----------|--|
| DATE     |  |
| BY       |  |
| SURVEYED |  |
| PLOTTED  |  |
| TEMPLATE |  |
| AREAS    |  |
| CHECKED  |  |
| NO.      |  |

|          |  |
|----------|--|
| DATE     |  |
| BY       |  |
| SURVEYED |  |
| PLOTTED  |  |
| TEMPLATE |  |
| AREAS    |  |
| CHECKED  |  |
| NO.      |  |

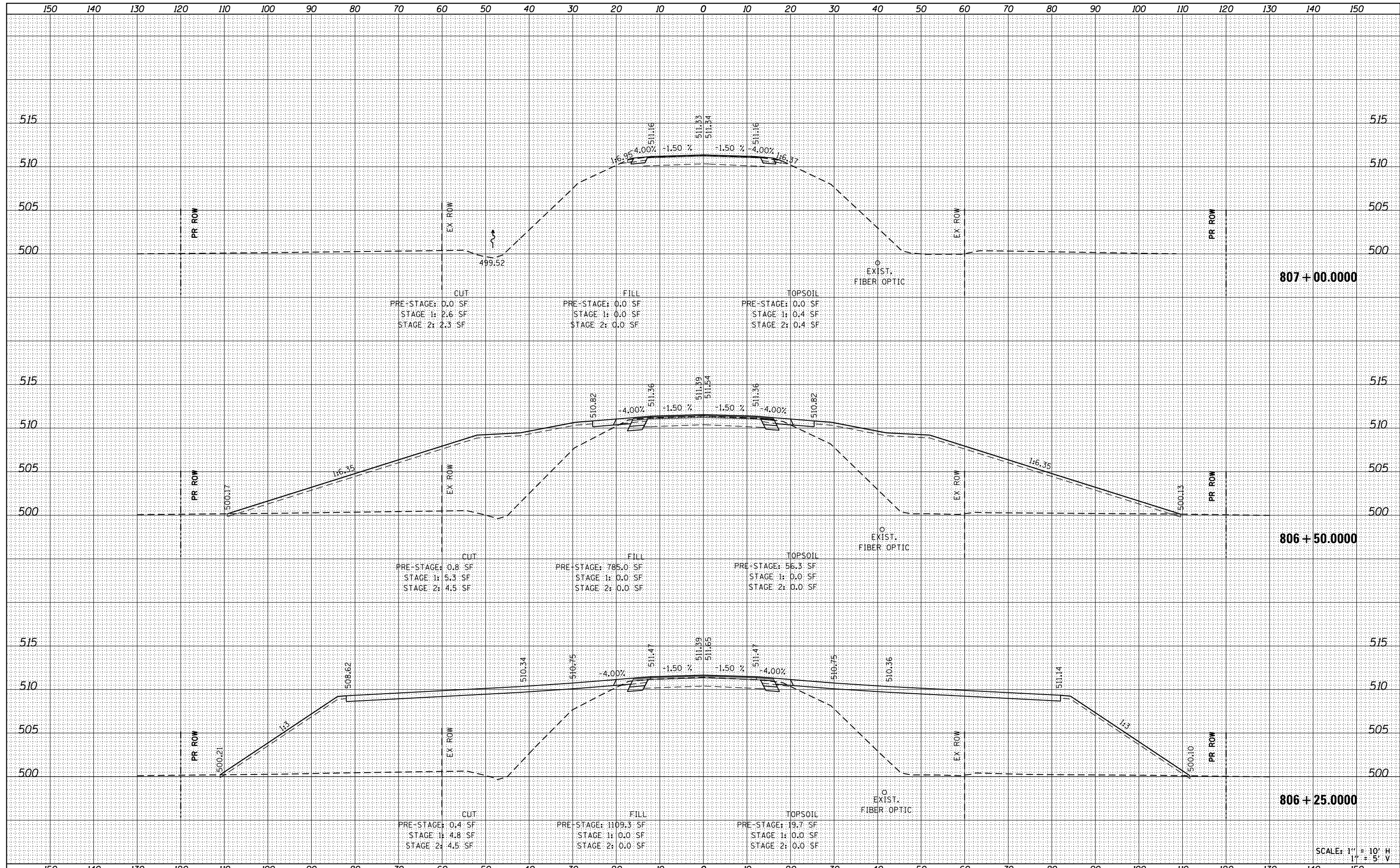

|  |                    |            |                           |   |   |               |         |        |              |           |
|--|--------------------|------------|---------------------------|---|---|---------------|---------|--------|--------------|-----------|
| FILE NAME =  | USER NAME = bemery | DESIGNED - | REVISED -                 | <b>STATE OF ILLINOIS</b><br><b>DEPARTMENT OF TRANSPORTATION</b> | <b>PROPOSED CROSS SECTIONS</b><br><b>IL 8 OVER KICKAPOO CREEK</b> | F.A.S. RTE.   | SECTION | COUNTY | TOTAL SHEETS | SHEET NO. |
| P:\Projects\2008 Projects\08379 IL 8 over Kickapoo Creek\CV\CADD Sheets\D468797-sht-xssh.d | DRAWN -            | REVISED -  | 1388                      |   |   | (Z-1D-BR-1)BR | PEORIA  | 89     | 88           |           |
| PLOT SCALE = 20.0000' / in.  | CHECKED -          | REVISED -  | CONTRACT NO. 68697        |   |   |               |         |        |              |           |
| PLOT DATE = 3/20/2014  | DATE -             | REVISED -  | ILLINOIS FED. AID PROJECT |   |   |               |         |        |              |           |

SCALE: 1" = 10' H  
1" = 5' V

SCALE: 1:10H 1:5V SHEET 12 OF 13 SHEETS STA. 806+38.8731 TO STA. 807+00.0000