

SECTION

SCALE: 2/8" = 1'-0"

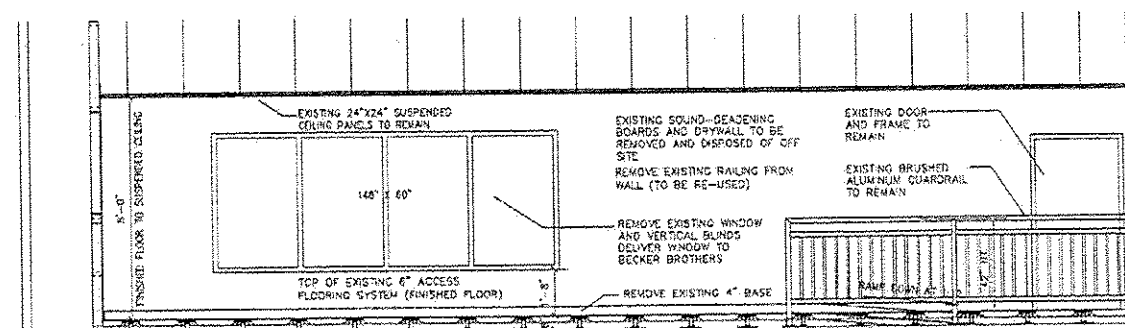

SECTION

$$\text{SCALE: } 3/8" = 1'-0"$$

PROPOSED FLOOR PLAN

SCALE: 1/4" = 1'-0"

DIMENSION DISCLAIMER:
ALL DIMENSIONS AS SHOWN ARE APPROXIMATE. CONTRACTOR TO
VERIFY ACTUAL DIMENSIONS IN FIELD AND CONSIDER ANY
VARIANCES WHEN CONDUCTING PROPOSED WORK. IN ORDER TO
ACHIEVE DESIRED CONDITIONS, CONTRACTOR IS TO BRING TO
ENGINEER'S ATTENTION ANY DISCREPANCIES WHICH WILL NOT
ALLOW THE FINAL WORK TO BE COMPLETED AS REFLECTED IN
THESE CONTRACT DRAWINGS.

ALL REMOVAL WORK TO BE INCLUDED IN THE BID PRICE FOR
DRYWALL AND PAINTING WORK

DOOR & HARDWARE SCHEDULE			
SYMBOL	DESCRIPTION	HARDWARE	REMARKS
①	3'-0" x 7'-0" x 1 3/4" 18GA. HOLLOW METAL DOOR, FLUSH PANEL W/ 18GA. STEEL FRAME & (3/4" FULL MORTISE HINGES.	BORE LOCK W/ DEAD LOCKING LATCH BOLT AND LEVER HANDLE W/ KEYWAY.	EXISTING REMOVE DOOR AND FRAME AND REINSTALL TO PROVIDE ROOM FOR PROPOSED VIDEO WALL.
②	(2) 2'-0" x 7'-0" x 1 3/4" 18GA. HOLLOW METAL DOUBLE DOOR, FLUSH PANELS W/ 18GA. STEEL FRAME & (3/4" FULL MORTISE HINGES EA. PANEL.	BORE LOCK W/ DEAD LOCKING LATCH BOLT, FLUSH BOLT ON INACTIVE LEAF AND LEVER HANDLE W/ KEYWAY.	EXISTING REMOVE DOOR AND FRAME AND LOCK METAL LOCK IN PROPOSED DOOR AND DISPOSE OF DOOR AND FRAME OFF JOB SITE.
③	(1) 3'-6" x 7'-0" x 3/4" 18GA. HOLLOW METAL DOOR, FLUSH PANELS W/ 18GA. STEEL FRAME & (3/4" FULL MORTISE HINGES.	RE-USE EXISTING HARDWARE AND LOCK FROM DOUBLE DOOR	PROPOSED INSTALL DOOR AND FRAME FOR USE PROPOSED VIDEO WALL.

① REVISED 6-4-14

FILE NAME =	USER NAME = hweider	DESIGNED -	REVISED -	STATE OF ILLINOIS DEPARTMENT OF TRANSPORTATION	DRYWALL AND PAINT WORK – REMOVAL ITEMS IDOT DISTRICT 4 COMMUNICATIONS CENTER	P.A.T. RLE	SECTION	COUNTY	SHEETS	NO.	
9188879 - Communications Center Project	608079 - Com Center Plans (Final Plans Review)	DRAWN -	REVISED -			T4	04 ITS SYSTEM 2014	PEORIA	11	9	
	PLOT SCALE = 3/16" = 1' in.	CHECKED -	REVISED -								CONTRACT NO. 608072
	PLOT DATE = 5/5/2014	DATE -	REVISED -			SCALE:		STA.	TO STA.		ILLINOIS DEPT. OF PROJECT

68B-73