

STATE OF ILLINOIS  
 DEPARTMENT OF TRANSPORTATION  
 DIVISION OF HIGHWAYS

**PROPOSED  
 HIGHWAY PLANS**

VARIOUS ROUTES  
 SECTION D5 CURVE SIGNING 2014-1  
 VARIOUS COUNTIES  
 SIGNING (NEW)  
 PROJECT ACHSIP-000S (991)  
 C-95-016-14

F.A. RY.	SECTION	COUNTY	TOTAL SHEETS	SHEET NO.
VAR.		ILLINOIS	22	1
CONTRACT NO. 70A62				

\* D5 CURVE SIGNING 2014-1

FOR INDEX OF SHEETS, SEE SHEET NO. 2  
 FOR SUMMARY OF QUANTITIES, SEE SHEET NO. 3  
 FOR LOCATION MAPS, SEE SHEETS NO. 4-13

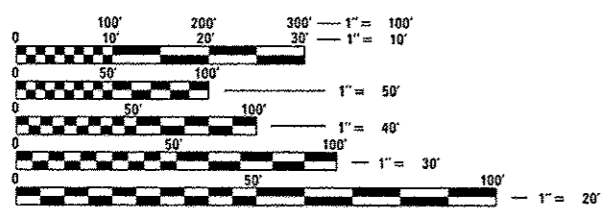
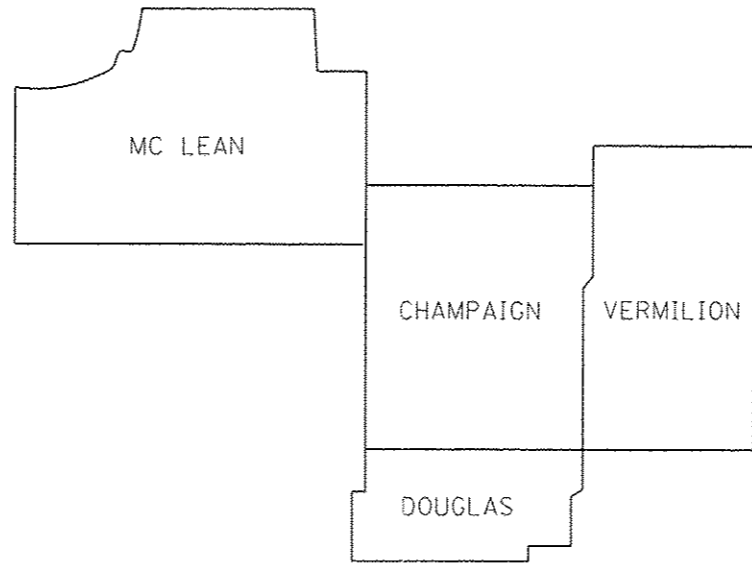
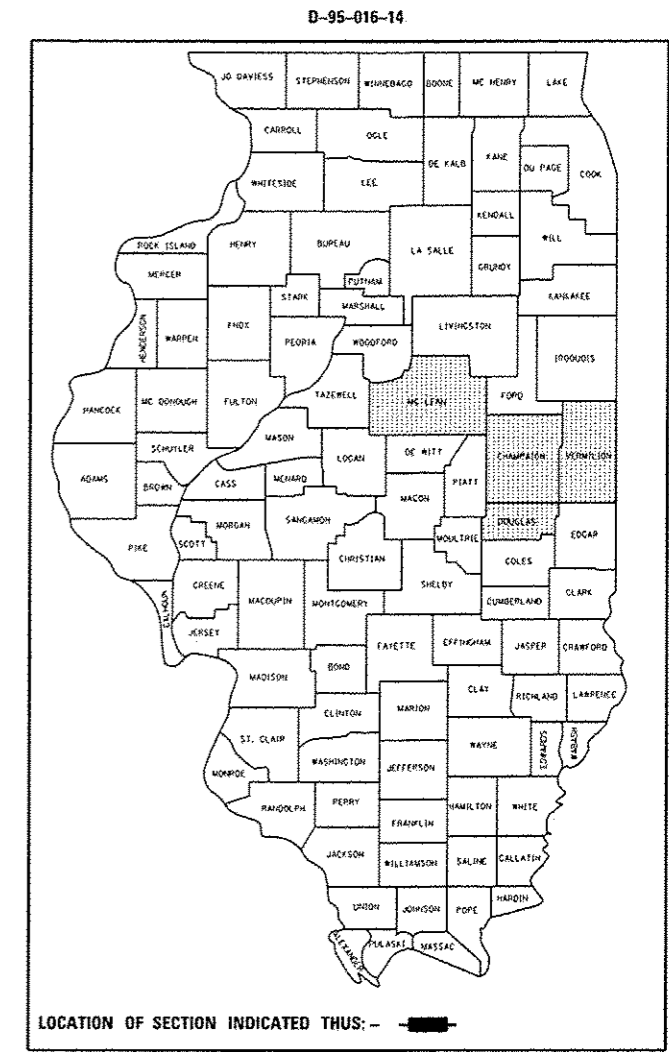

FULL SIZE PLANS HAVE BEEN PREPARED USING STANDARD ENGINEERING SCALES. REDUCED SIZED PLANS WILL NOT CONFORM TO STANDARD SCALES. IN MAKING MEASUREMENTS ON REDUCED PLANS, THE ABOVE SCALES MAY BE USED.

J.U.L.I.E.  
 JOINT UTILITY LOCATION INFORMATION FOR EXCAVATION  
 1-800-892-0123  
 OR 811

PROJECT ENGINEER - JASON STULTS  
 PHONE NUMBER: (217)465-4181  
 CONTRACT NO. 70A62

STATE OF ILLINOIS  
 DEPARTMENT OF TRANSPORTATION  
 DIVISION OF HIGHWAYS

SUBMITTED MARCH 19 2014  
Joseph S. Cooney  
 DEPUTY DIRECTOR OF HIGHWAYS, REGION ENGINEER *CHS*

May 9 2014  
John D. Baranzelli, P.E.  
 acting ENGINEER OF DESIGN AND ENVIRONMENT

May 9 2014  
Orfer Osman, P.E.  
 DIRECTOR OF HIGHWAYS, CHIEF ENGINEER

**PRINTED BY THE AUTHORITY  
 OF THE STATE OF ILLINOIS**

# INDEX OF SHEETS

SHEET NO.	DESCRIPTION
1	COVER SHEET
2	INDEX OF SHEETS
2	LIST OF HIGHWAY STANDARDS
2	GENERAL NOTES
3	SUMMARY OF QUANTITIES
4-6	MCLEAN COUNTY LOCATION MAP
7	DOUGLAS COUNTY LOCATION MAP
8-10	CHAMPAIGN COUNTY LOCATION MAP
11-13	VERMILION COUNTY LOCATION MAP
14-15	MCLEAN COUNTY SCHEDULES
16	DOUGLAS COUNTY SCHEDULES
17-18	CHAMPAIGN COUNTY SCHEDULES
19-20	VERMILION COUNTY SCHEDULES
21	SUMMARY OF SCHEDULES
22	DETAIL OF TYPICAL SIGN PLACEMENT

# HIGHWAY STANDARDS

STANDARD NO.	DESCRIPTION
000001-06	STANDARD SYMBOLS, ABBREVIATIONS AND PATTERNS
001006	DECIMAL OF AN INCH AND OF A FOOT
701001-02	OFF-ROAD OPERATIONS, 2L, 2W, MORE THAN 15' AWAY
701006-05	OFF-ROAD OPERATIONS, 2L, 2W, 15' TO 24" FROM PAVEMENT EDGE
701101-04	OFF-ROAD OPERATIONS, MULTILANE, 15' TO 24" FROM PAVEMENT EDGE
701106-02	OFF-ROAD OPERATIONS, MULTILANE, MORE THAN 15' AWAY
701301-04	LANE CLOSURE, 2L, 2W, SHORT TIME OPERATIONS
701426-06	LANE CLOSURE, MULTILANE, INTERMITTENT OR MOVING OPERATIONS FOR SPEEDS >= 45 MPH
701427-02	LANE CLOSURE, MULTILANE, INTERMITTENT OR MOVING OPERATIONS FOR SPEEDS <= 40 MPH
701456-03	PARTIAL EXIT RAMP CLOSURE FREEWAY/EXPRESSWAY
701901-03	TRAFFIC CONTROL DEVICES
720001-01	SIGN PANEL MOUNTING DETAILS
720006-04	SIGN PANEL ERECTION DETAILS
720011-01	METAL POSTS FOR SIGNS, MARKERS, & DELINEATORS
728001-01	TELESCOPING STEEL SIGN SUPPORT
729001-01	APPLICATIONS OF TYPES A & B METAL POSTS (FOR SIGNS & MARKERS)

# GENERAL NOTES

G.N.-100  
ENGLISH UNITS OF MEASUREMENT SHALL GOVERN OVER AND SUPERSEDE ANY METRIC UNITS SHOWN IN THIS CONTRACT. WHERE INCLUDED, METRIC UNITS ARE FOR INFORMATION ONLY.

G.N.-100A  
ELECTRONIC FILES AND/OR ELECTRONIC SURVEY INFORMATION INCLUDING CADD FILES WILL NOT BE AVAILABLE TO THE CONTRACTOR.

G.N.-720(SPL)  
TYPE ZZ SHEETING SHALL BE USED ON ALL SIGN PANELS.

SIGNS MUST BE FIELD VERIFIED AND ADJUSTED AS NEEDED BY THE ENGINEER TO PROVIDE CLEAR VISIBILITY OF THE SIGN AND TO ASSURE THAT SIGN PLACEMENT DOES NOT ADVERSELY AFFECT DRIVER SIGHT DISTANCE OR THE VISIBILITY OF OTHER SIGNAGE.

FILE NAME *	USER NAME * oearlockjd	DESIGNED -	REVISED -	<b>STATE OF ILLINOIS DEPARTMENT OF TRANSPORTATION</b>	<b>INDEX OF SHEETS, HIGHWAY STANDARDS &amp; GENERAL NOTES</b>	F.A. RTE.	SECTION	COUNTY	TOTAL SHEETS	SHEET NO.
c:\p\work\p1dot\oearlockjd\030205\070A62-shs-gennote.dgn	DRAWN -	REVISED -	VAR.			*	VARIOUS	22	2	
PLOT SCALE = 40.0000' / 1"	CHECKED -	REVISED -	* DS CURVE SIGNING 2014-1							
PLOT DATE = 3/28/2014	DATE -	REVISED -	CONTRACT NO. 70A62							
					SCALE:	SHEET OF SHEETS		STA. TO STA.		
ILLINOIS FED. AID PROJECT										

# SUMMARY OF QUANTITIES

LOCATION OF WORK:

VARIOUS ROUTES	VARIOUS ROUTES
VARIOUS COUNTIES	VARIOUS COUNTIES
HSIP	HSIP
90% FED	90% FED
10% STATE	10% STATE
URBAN	RURAL
0021	0021

CODE NO	ITEM	CONSTRUCTION TYPE CODE:	UNIT	TOTAL QUANTITY		
67100100	MOBILIZATION		L SUM	1.0	0.4	0.6
70100825	TRAFFIC CONTROL AND PROTECTION, STANDARD 701456		L SUM	1.0	1.0	
72000100	SIGN PANEL - TYPE 1		SD FT	2,644.0	1051.0	1593.0
72000200	SIGN PANEL - TYPE 2		SD FT	48.0	48.0	
72800100	TELESCOPING STEEL SIGN SUPPORT		FOOT	1,058.0	302.0	756.0
72900100	METAL POST - TYPE A		FOOT	1496.0	308.0	1100.0
72900200	METAL POST - TYPE B		FOOT	1,360.0	1360.0	
73000100	WOOD SIGN SUPPORT		FOOT	1900.0	696.0	1204.0
X7240300	SIGN REMOVAL		EACH	75.0	19.0	56.0

9 \* SPECIALTY ITEMS

TOWNSHIPS

MOUNT HOPE  
BLOOMINGTON  
NORMAL  
HUDSON  
LEXINGTON

# MCLEAN COUNTY LOCATIONS

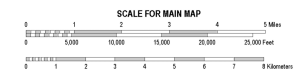
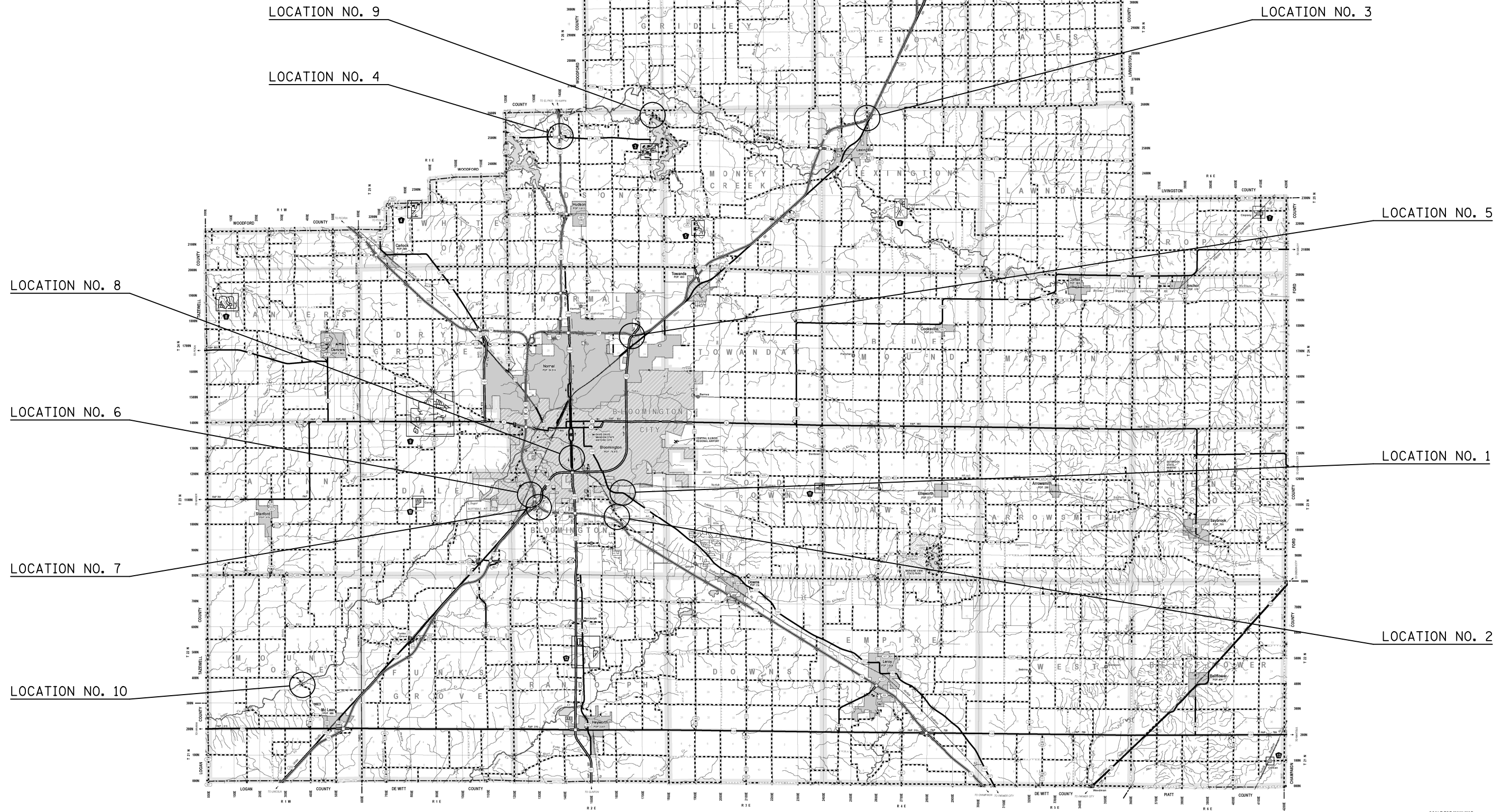

FILE NAME =	USER NAME = ceerlockjd	DESIGNED -	REVISED -
ei:\pw\work\p\dot\ceerlockjd\0382855\0570A62-sht-Location_Maps.dgn		DRAWN -	REVISED -
\$MODELNAME\$	PLOT SCALE = 40.0000' / in.	CHECKED -	REVISED -
	PLOT DATE = 3/20/2014	DATE -	REVISED -

**STATE OF ILLINOIS  
DEPARTMENT OF TRANSPORTATION**

**MCLEAN COUNTY LOCATION MAP**

SCALE: SHEET 1 OF 3 SHEETS STA. TO STA.

F.A. RTE.	SECTION	COUNTY	TOTAL SHEETS	SHEET NO.
VAR.	•	VARIOUS	22	4
• D5 CURVE SIGNING 2014-1		CONTRACT NO. 70A62		
ILLINOIS FED. AID PROJECT				

LOCATION NO. 1  
FAU 6406 (US 150)

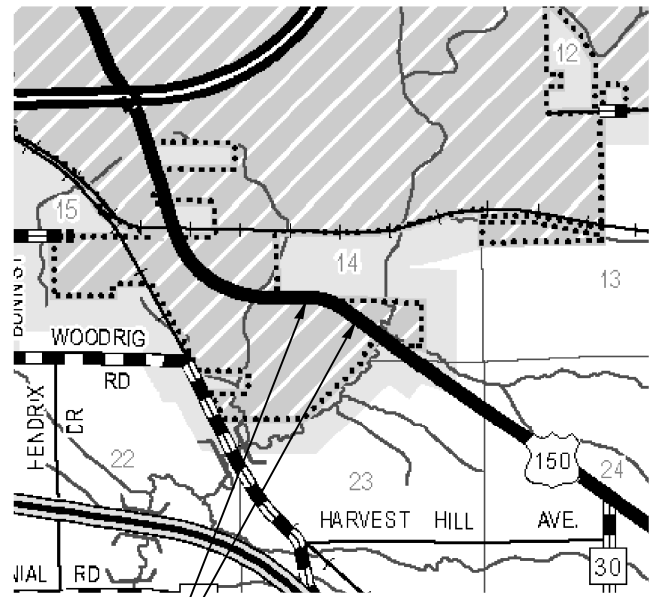

LIMITS OF IMPROVEMENT  
JURISDICTION: STATE

LOCATION NO. 2  
FAU 6428 (CAPODICE ROAD)

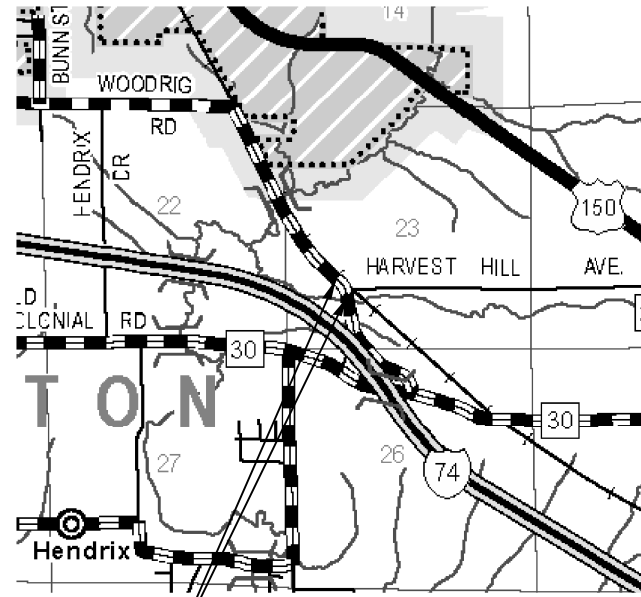

LIMITS OF IMPROVEMENT  
JURISDICTION: TOWNSHIP

LOCATION NO. 3  
FAI 55 (I 55)

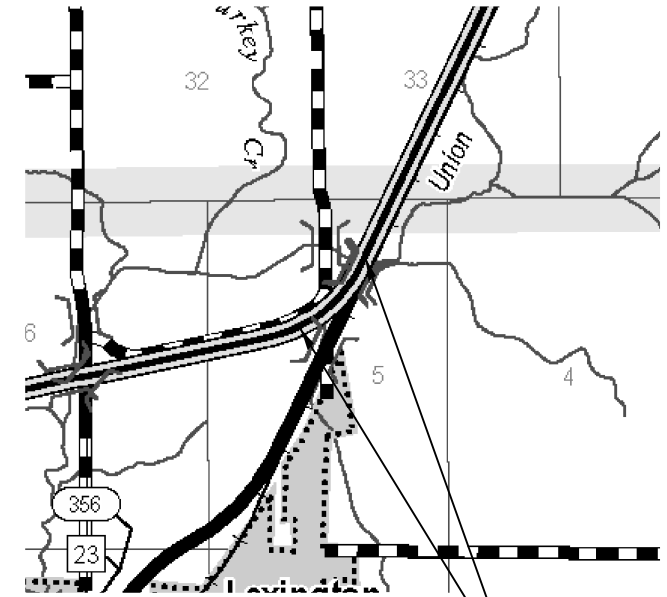

LIMITS OF IMPROVEMENT  
JURISDICTION: STATE

LOCATION NO. 4  
FAS 1274 (IL 251)

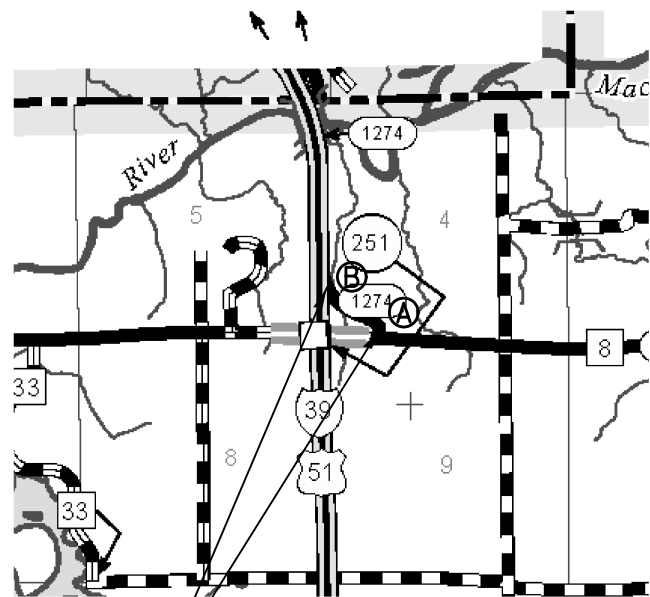

LIMITS OF IMPROVEMENT  
JURISDICTION: STATE

LOCATION NO. 5  
FAI 55 (I 55B NB TO I 55 NB RAMP)

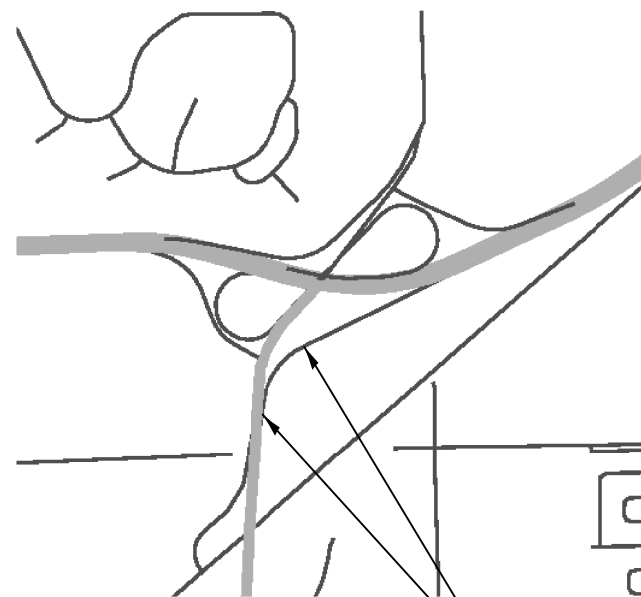

LIMITS OF IMPROVEMENT  
JURISDICTION: STATE

LOCATION NO. 6  
FAI 74 (I 74 WB TO VETERANS PRKY SB RAMP)

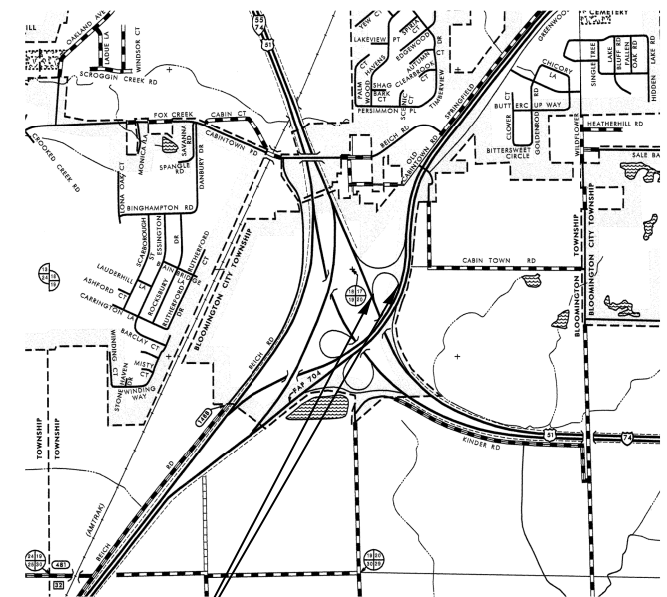

LIMITS OF IMPROVEMENT  
JURISDICTION: STATE

FILE NAME =	USER NAME = ceerlockjd	DESIGNED -	REVISED -
ce:\pwork\pwork\ceerlockjd\0382855\0570A62-sht-Location_Maps.dgn		DRAWN -	REVISED -
	PLOT SCALE = 48.0000' / in.	CHECKED -	REVISED -
\$MODELNAME\$	PLOT DATE = 3/20/2014	DATE -	REVISED -

STATE OF ILLINOIS  
DEPARTMENT OF TRANSPORTATION

MCLEAN COUNTY LOCATION MAP

SCALE: SHEET 2 OF 3 SHEETS STA. TO STA.

F.A. RTE.	SECTION	COUNTY	TOTAL SHEETS	SHEET NO.
VAR.	•	VARIOUS	22	5
• D5 CURVE SIGNING 2014-1			CONTRACT NO. 70A62	
ILLINOIS FED. AID PROJECT				

LOCATION NO. 7  
FAI 74 (I 74)

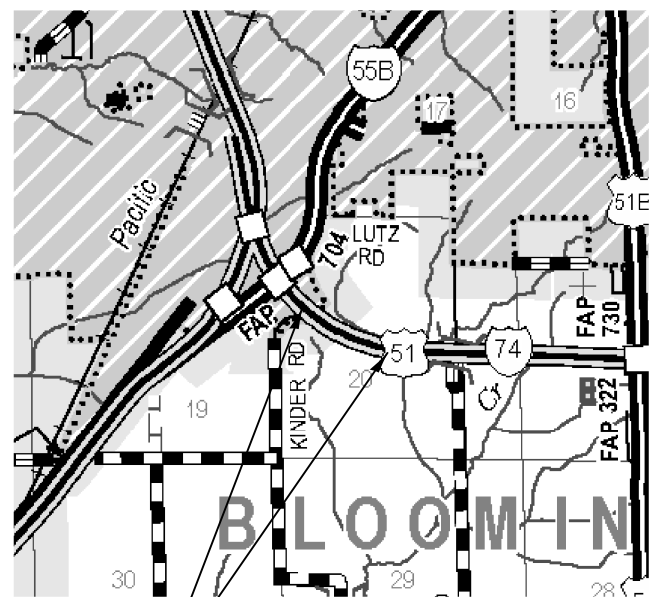

LIMITS OF IMPROVEMENT  
JURISDICTION: STATE

LOCATION NO. 8  
FAP 730 (US 51B)

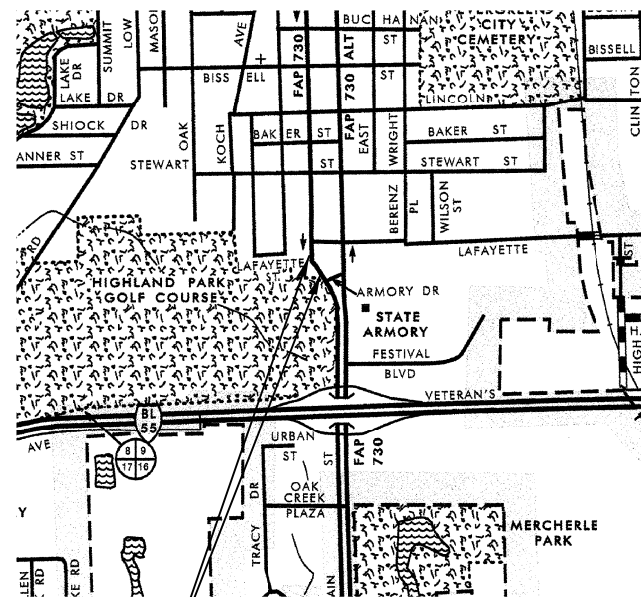

LIMITS OF IMPROVEMENT  
JURISDICTION: STATE

LOCATION NO. 9  
FAS 473 (CR 1750E / PJ KELLER HWY)

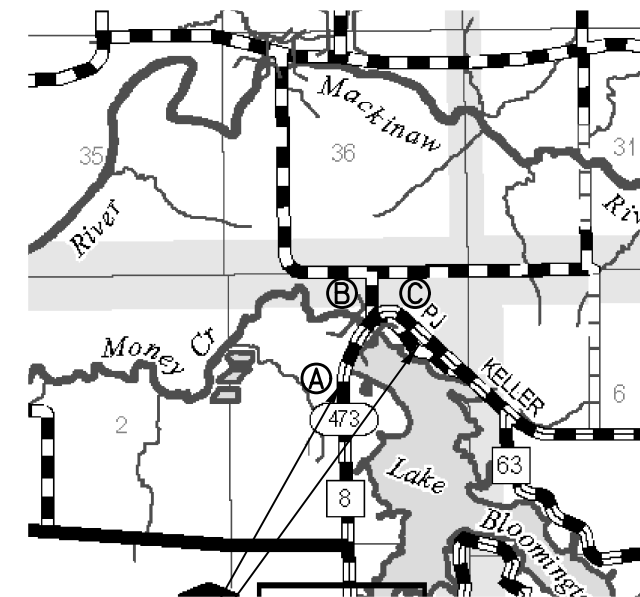

LIMITS OF IMPROVEMENT  
JURISDICTION: COUNTY

LOCATION NO. 10  
FAS 479 (SCHOOL ST)

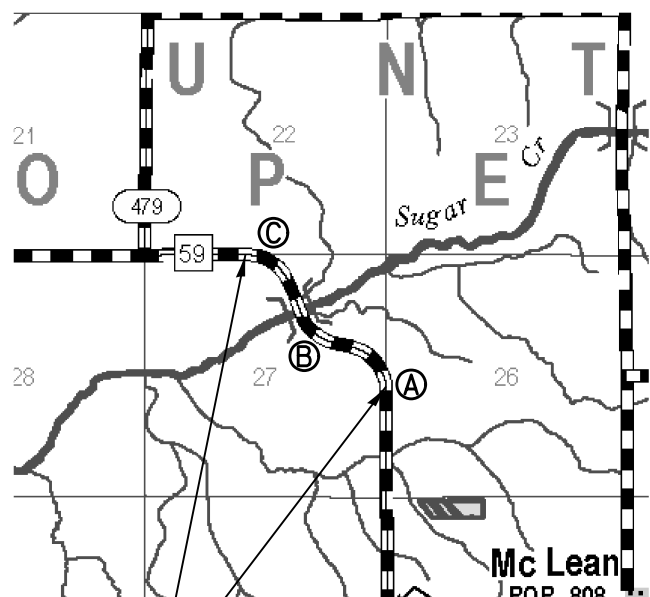

LIMITS OF IMPROVEMENT  
JURISDICTION: COUNTY

FILE NAME =	USER NAME = ceerlockjd	DESIGNED -	REVISED -
c:\pwork\pwork\ceerlockjd\0382855\0570A62-sht-Location_Maps.dgn		DRAWN -	REVISED -
	PLOT SCALE = 40.0000' / in.	CHECKED -	REVISED -
\$MODELNAME\$	PLOT DATE = 3/20/2014	DATE -	REVISED -

STATE OF ILLINOIS  
DEPARTMENT OF TRANSPORTATION

MCLEAN COUNTY LOCATION MAP

SCALE: SHEET 3 OF 3 SHEETS STA. TO STA.

F.A. RTE.	SECTION	COUNTY	TOTAL SHEETS	SHEET NO.
VAR.	•	VARIOUS	22	6
• D5 CURVE SIGNING 2014-1		CONTRACT NO. 70A62		
ILLINOIS FED. AID PROJECT				

TOWNSHIPS  
ARCOLA

# DOUGLAS COUNTY LOCATIONS

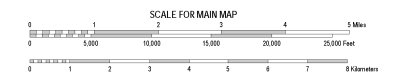
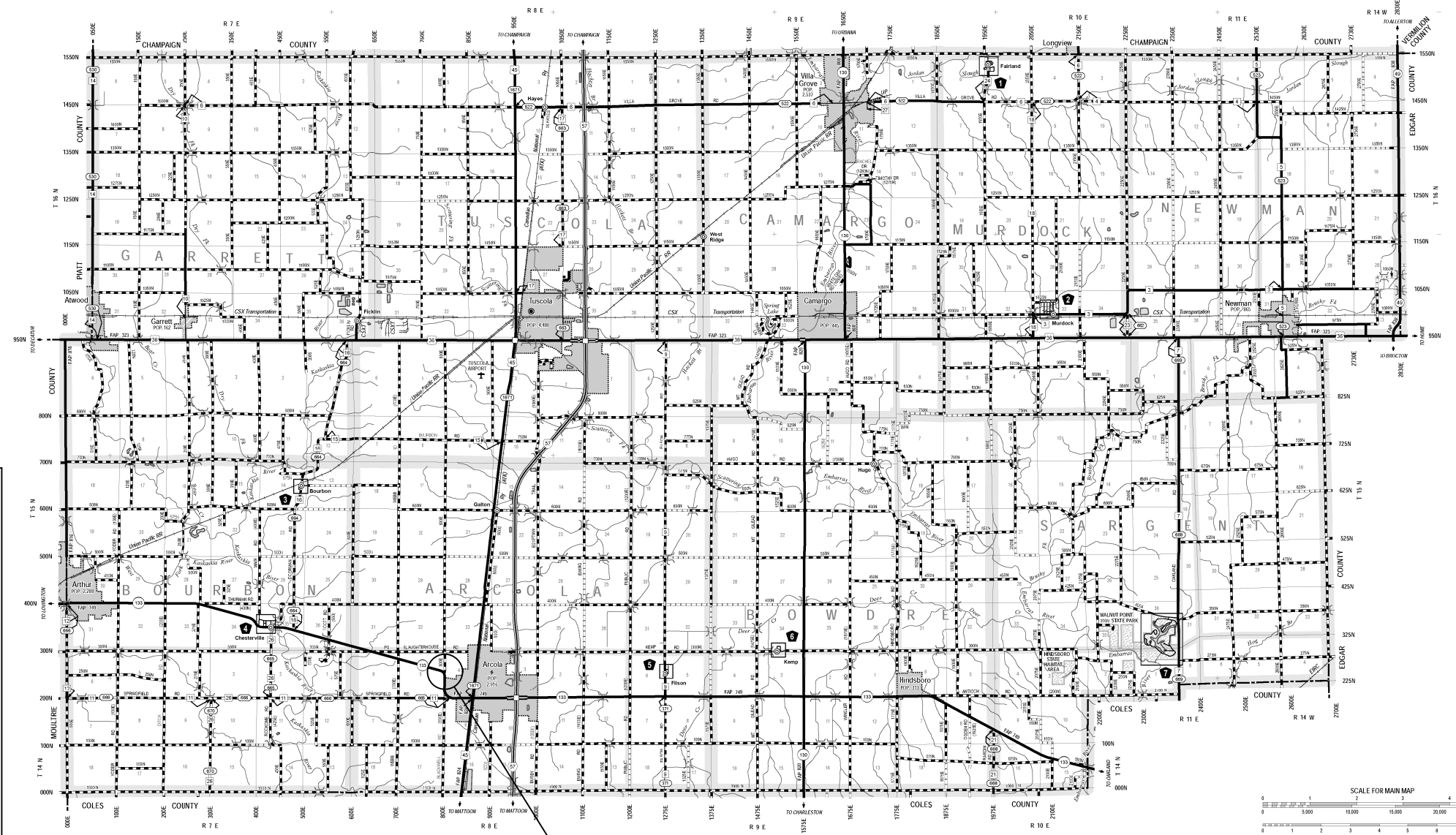

LOCATION NO. 11  
FAS 749 (IL 133)

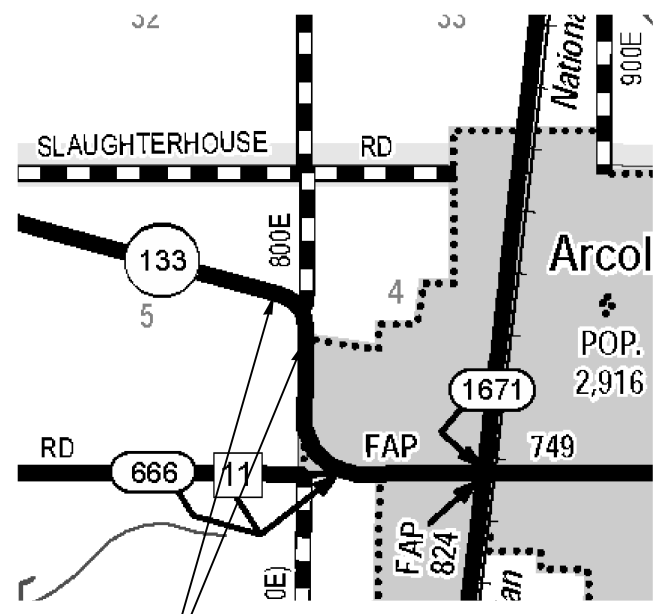

LIMITS OF IMPROVEMENT  
JURISDICTION: STATE

LOCATION NO. 11

FILE NAME =	USER NAME = ceerlockjd	DESIGNED -	REVISED -
c:\pwwork\pwwork\ceerlockjd\0382855\0570A62-sht-Location_Maps.dgn		DRAWN -	REVISED -
	PLOT SCALE = 40.0000' / in.	CHECKED -	REVISED -
\$MODELNAME\$	PLOT DATE = 3/20/2014	DATE -	REVISED -

STATE OF ILLINOIS  
DEPARTMENT OF TRANSPORTATION

DOUGLAS COUNTY LOCATION MAP

SCALE: SHEET 1 OF 1 SHEETS STA. TO STA.

F.A. RTE.	SECTION	COUNTY	TOTAL SHEETS	SHEET NO.
VAR.	•	VARIOUS	22	7
• D5 CURVE SIGNING 2014-1		CONTRACT NO. 70A62		
ILLINOIS FED. AID PROJECT				

TOWNSHIPS

URBANA  
 CHAMPAIGN  
 HENSLEY  
 MAHOMET  
 NEWCOMB  
 BROWN

# CHAMPAIGN COUNTY LOCATIONS



LOCATION NO. 19

LOCATION NO. 17

LOCATION NO. 12

LOCATION NO. 13

LOCATION NO. 20

LOCATION NO. 14

LOCATION NO. 15

LOCATION NO. 18

LOCATION NO. 16

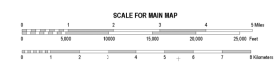
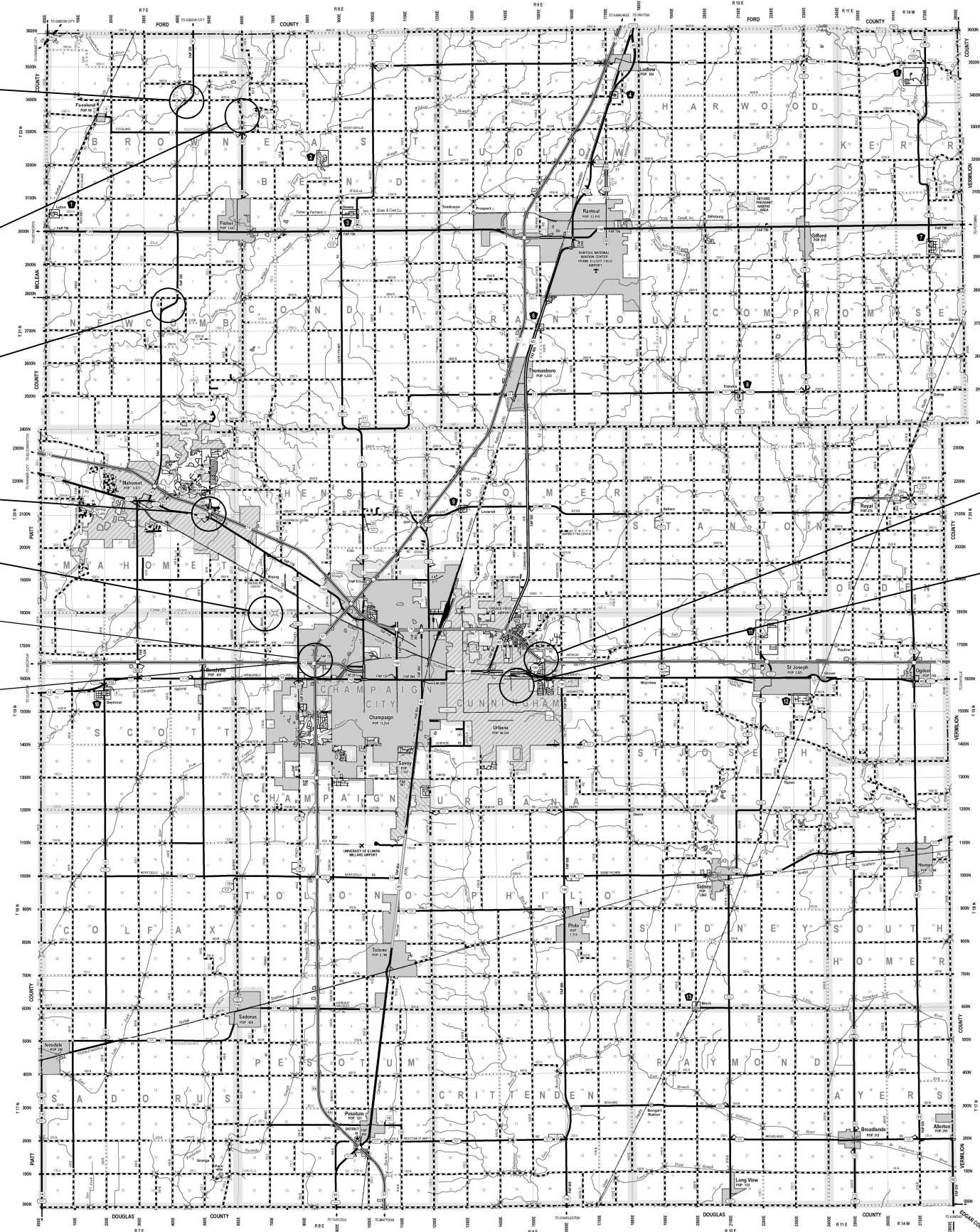

FILE NAME =	USER NAME = ceerlockjd	DESIGNED -	REVISED -
ct:\pw\work\p\dot\ceerlockjd\0382855\0570A62-sht-Location_Maps.dgn		DRAWN -	REVISED -
	PLOT SCALE = 40.0000' / in.	CHECKED -	REVISED -
\$MODELNAME\$	PLOT DATE = 3/20/2014	DATE -	REVISED -

STATE OF ILLINOIS  
 DEPARTMENT OF TRANSPORTATION

CHAMPAIGN COUNTY LOCATION MAP

SCALE: SHEET 1 OF 3 SHEETS STA. TO STA.

F.A. RTE.	SECTION	COUNTY	TOTAL SHEETS	SHEET NO.
VAR.	•	VARIOUS	22	8
• D5 CURVE SIGNING 2014-1		CONTRACT NO. 70A62		
ILLINOIS FED. AID PROJECT				



LOCATION NO. 12  
FAP 326 (IL 47)

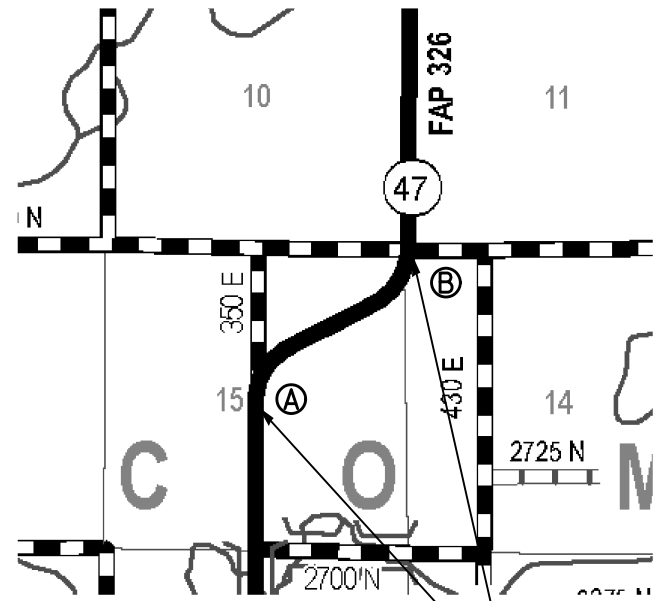

LIMITS OF IMPROVEMENT  
JURISDICTION: STATE

LOCATION NO. 13  
FAI 74 (PRAIRIEVIEW RD TO I 74 EB RAMP)

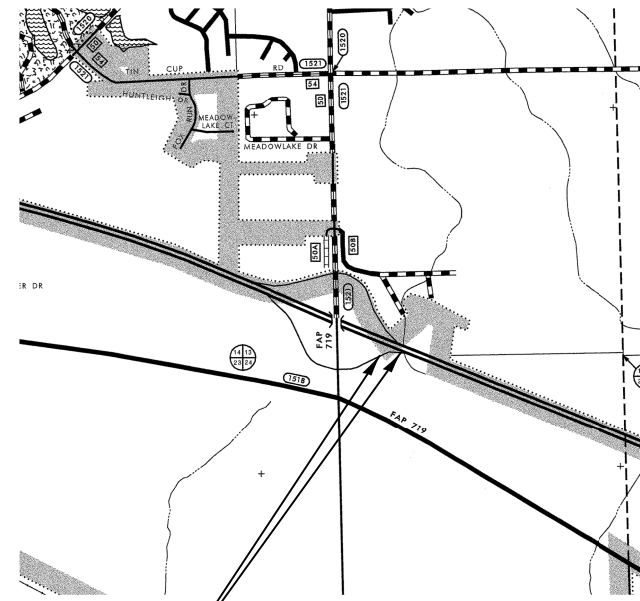

LIMITS OF IMPROVEMENT  
JURISDICTION: STATE

LOCATION NO. 14  
FAI 57 (I 72 EB TO I 57 SB RAMP)

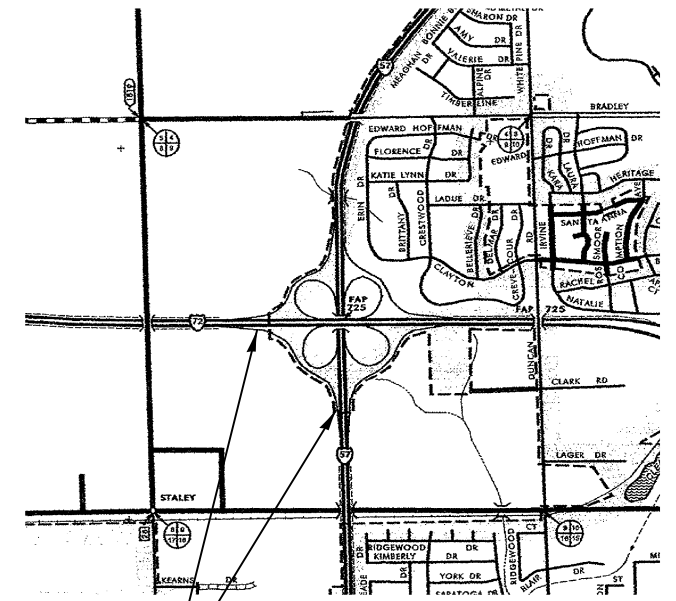

LIMITS OF IMPROVEMENT  
JURISDICTION: STATE

LOCATION NO. 15  
FAI 57 (I 72 WB TO I 57 NB RAMP)

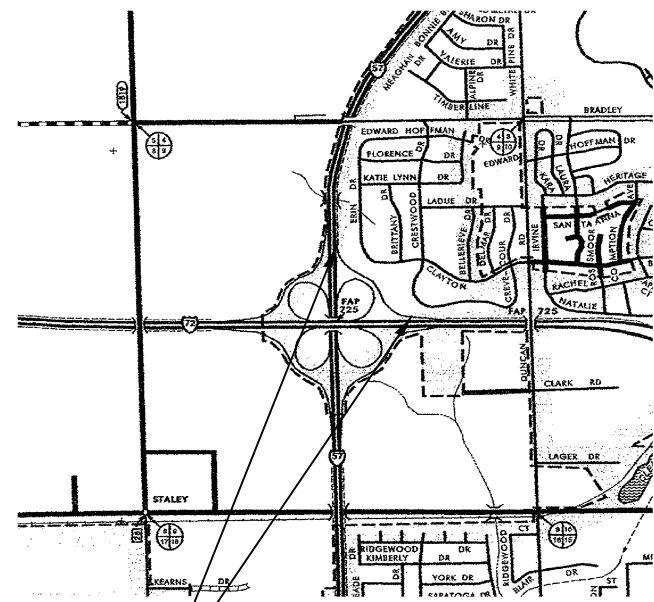

LIMITS OF IMPROVEMENT  
JURISDICTION: STATE

LOCATION NO. 16  
FAU 7185 (PHILO RD)



LIMITS OF IMPROVEMENT  
JURISDICTION: CITY

LOCATION NO. 17  
TR 80 (CR 600E)

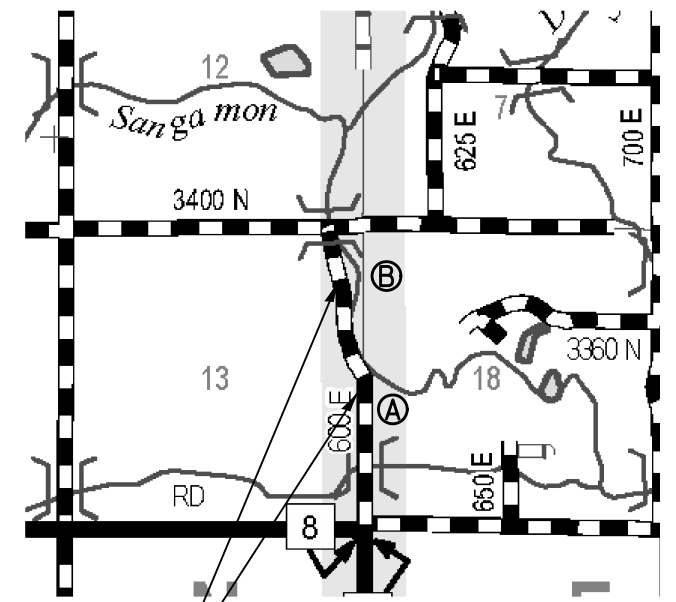

LIMITS OF IMPROVEMENT  
JURISDICTION: TOWNSHIP

FILE NAME =	USER NAME = ceerlockjd	DESIGNED -	REVISED -
ei:\pw\work\p\idot\ceerlockjd\0382855\0570A62-sht-Location_Maps.dgn		DRAWN -	REVISED -
	PLOT SCALE = 48.0000' / in.	CHECKED -	REVISED -
\$MODELNAME\$	PLOT DATE = 3/20/2014	DATE -	REVISED -

STATE OF ILLINOIS  
DEPARTMENT OF TRANSPORTATION

CHAMPAIGN COUNTY LOCATION MAP

SCALE: SHEET 2 OF 3 SHEETS STA. TO STA.

F.A. RTE.	SECTION	COUNTY	TOTAL SHEETS	SHEET NO.
VAR.	•	VARIOUS	22	9
• D5 CURVE SIGNING 2014-1			CONTRACT NO. 70A62	
ILLINOIS FED. AID PROJECT				

LOCATION NO. 18  
FAI 74 (US 130 NB TO I 74 WB RAMP)

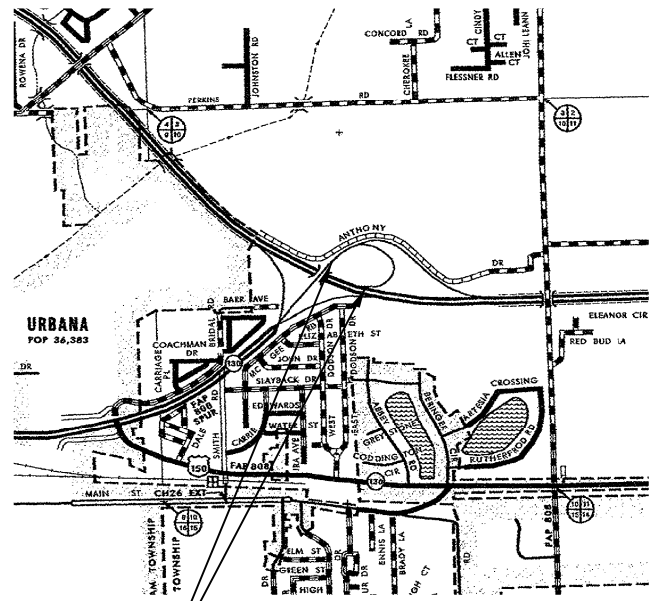

LIMITS OF IMPROVEMENT  
JURISDICTION: STATE

LOCATION NO. 19  
FAP 326 (IL 47)

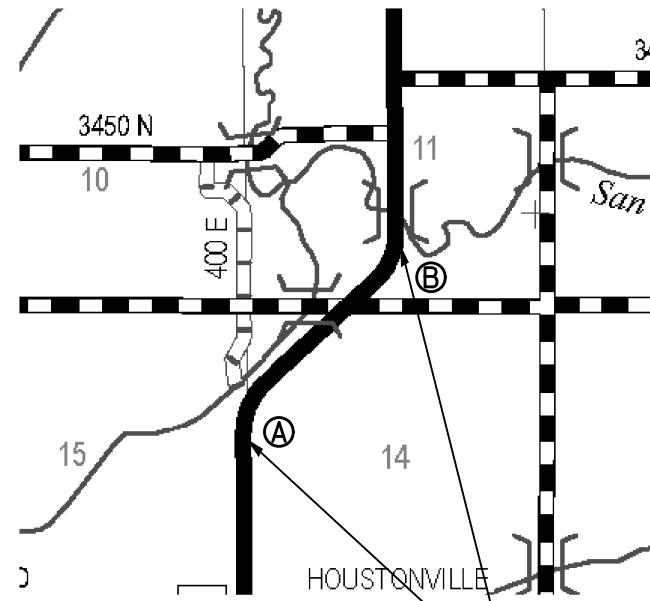

LIMITS OF IMPROVEMENT  
JURISDICTION: STATE

LOCATION NO. 20  
TR 94 (RISING RD)

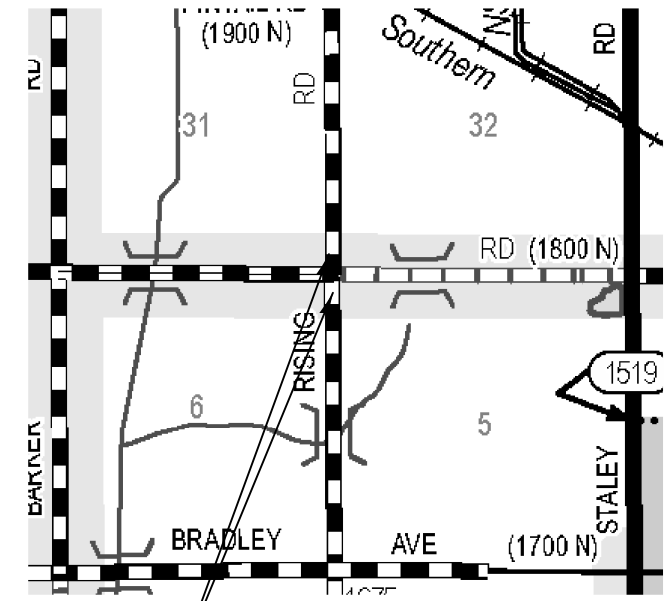

LIMITS OF IMPROVEMENT  
JURISDICTION: TOWNSHIP

FILE NAME =	USER NAME = ceerlockjd	DESIGNED -	REVISED -
ei:\pw\work\p\idot\ceerlockjd\0382855\0570A62-sht-Location_Maps.dgn		DRAWN -	REVISED -
	PLOT SCALE = 40.0000' / in.	CHECKED -	REVISED -
\$MODELNAME\$	PLOT DATE = 3/20/2014	DATE -	REVISED -

STATE OF ILLINOIS  
DEPARTMENT OF TRANSPORTATION

CHAMPAIGN COUNTY LOCATION MAP

SCALE: SHEET 3 OF 3 SHEETS STA. TO STA.

F.A. RTE.	SECTION	COUNTY	TOTAL SHEETS	SHEET NO.
VAR.	•	VARIOUS	22	10
• D5 CURVE SIGNING 2014-1		CONTRACT NO. 70A62		
ILLINOIS FED. AID PROJECT				

TOWNSHIPS

GEORGETOWN  
OAKWOOD  
DANVILLE  
NEWZELL  
ROSS

# VERMILION COUNTY LOCATIONS

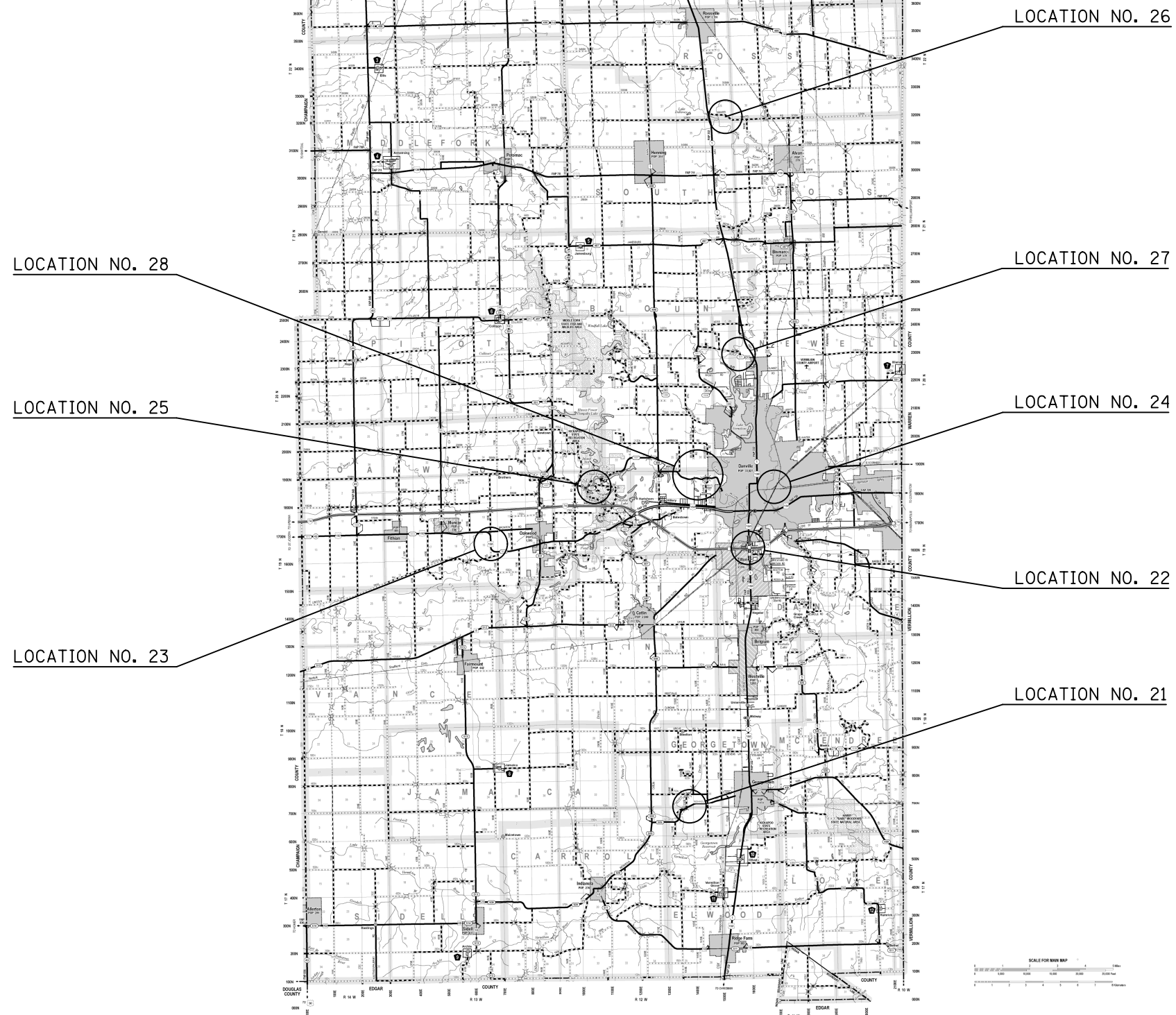

FILE NAME =	USER NAME = ceorlockjd	DESIGNED -	REVISED -
c:\pwork\work\pwork\ceorlockjd\0382855\0570A62-sht-Location_Maps.dgn		DRAWN -	REVISED -
	PLOT SCALE = 40.0000' / in.	CHECKED -	REVISED -
\$MODELNAME\$	PLOT DATE = 3/20/2014	DATE -	REVISED -

**STATE OF ILLINOIS  
DEPARTMENT OF TRANSPORTATION**

**VERMILION COUNTY LOCATION MAP**

SCALE: SHEET 1 OF 3 SHEETS STA. TO STA.

F.A. RTE.	SECTION	COUNTY	TOTAL SHEETS	SHEET NO.
	•	VARIOUS	22	11
• D5 CURVE SIGNING 2014-1		CONTRACT NO. 70A62		
ILLINOIS FED. AID PROJECT				

LOCATION NO. 21  
FAS 509 (GEORGETOWN-INDIANOLA RD)

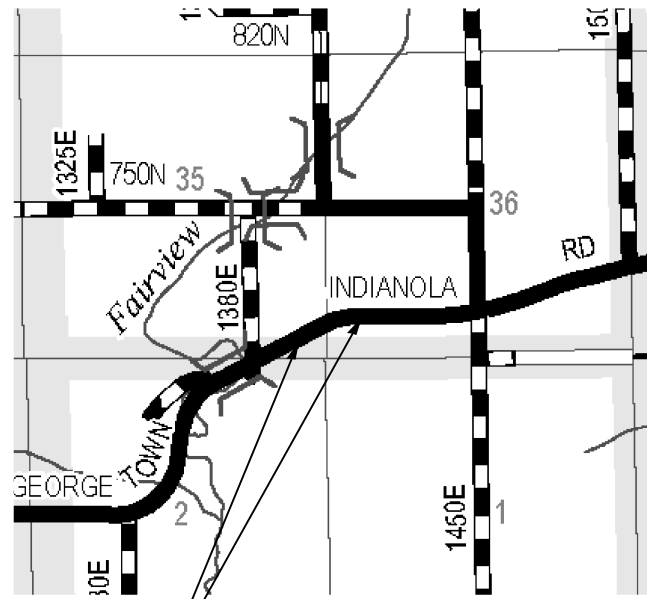

LIMITS OF IMPROVEMENT  
JURISDICTION: STATE

LOCATION NO. 22  
FAI 74 (US 150 NB TO I 74 EB RAMP)

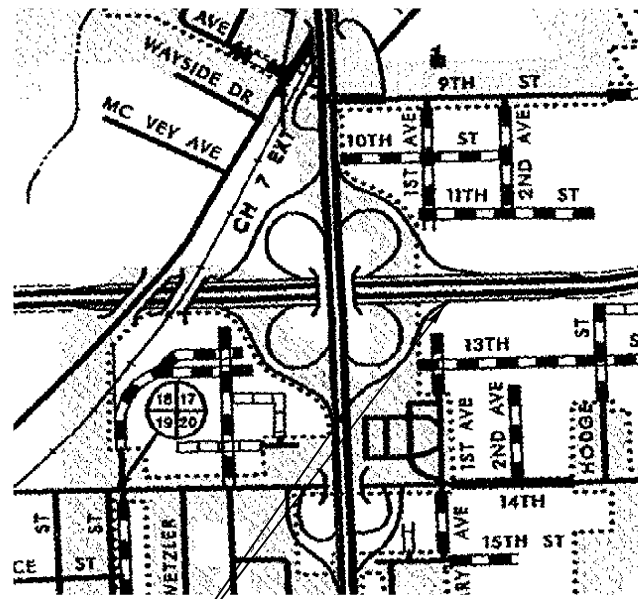

LIMITS OF IMPROVEMENT  
JURISDICTION: STATE

LOCATION NO. 23  
FAS 1512 (US 150)

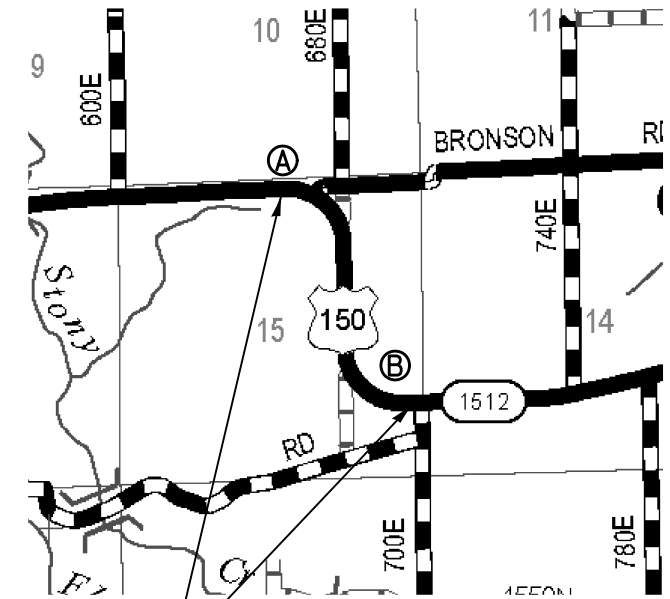

LIMITS OF IMPROVEMENT  
JURISDICTION: STATE

\* NOTE: CUSTOM W1-2 SIGNS AND W1-1A SIGNS ARE TO REMAIN IN PLACE.

LOCATION NO. 24  
FAU 7003 (WILLIAMS ST)

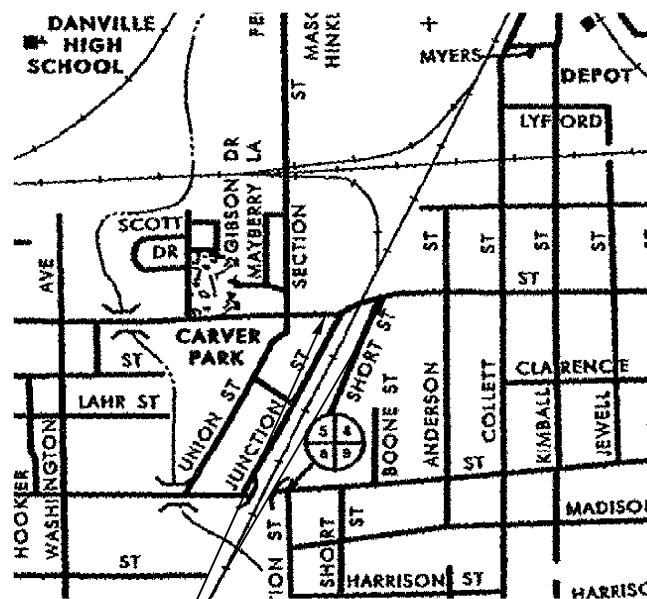

LIMITS OF IMPROVEMENT  
JURISDICTION: CITY

LOCATION NO. 25  
FAS 1507 (GLENBURN CREEK RD)

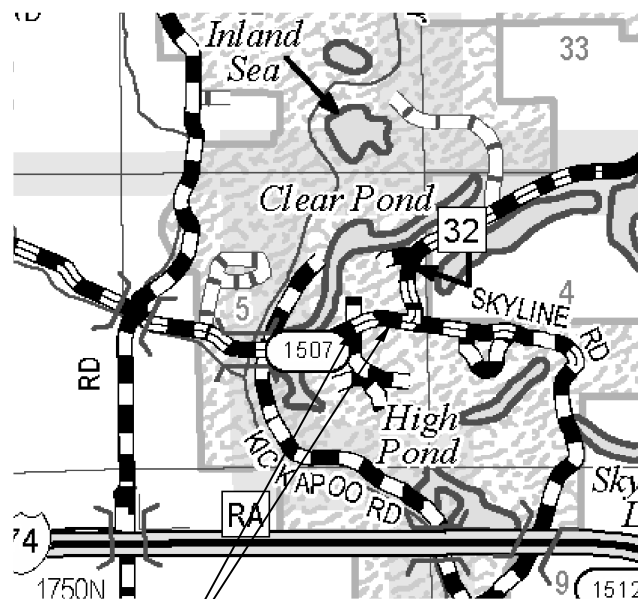

LIMITS OF IMPROVEMENT  
JURISDICTION: TOWNSHIP

LOCATION NO. 26  
TR 83 (MANN'S CHAPEL RD)

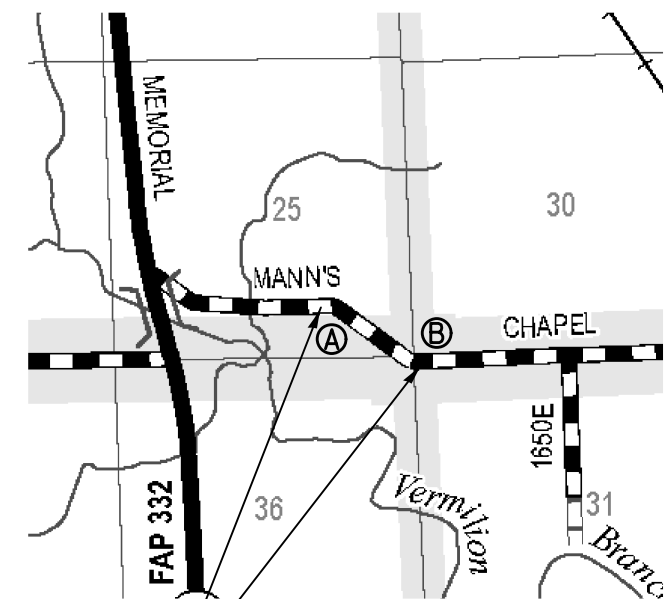

LIMITS OF IMPROVEMENT  
JURISDICTION: TOWNSHIP

LOCATION NO. 27  
FAS 1511 (CH 20 / W NEWELL RD)

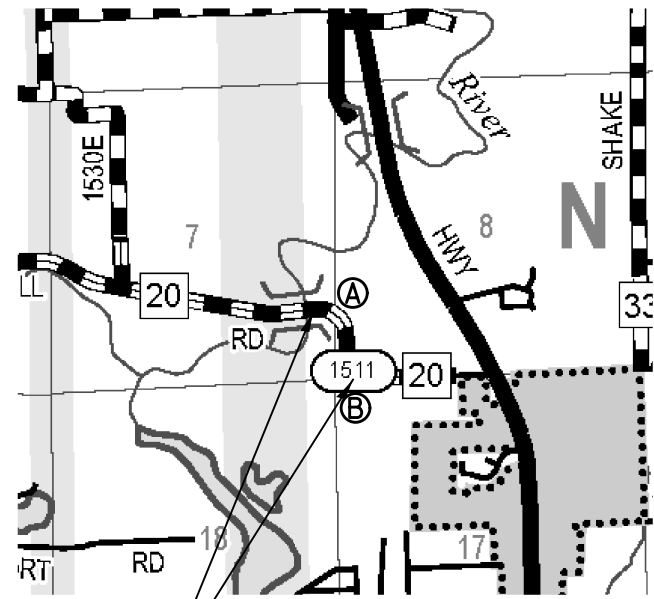

LIMITS OF IMPROVEMENT  
JURISDICTION: COUNTY

LOCATION NO. 28  
FAU 7000 (HUNGRY HOLLOW RD)

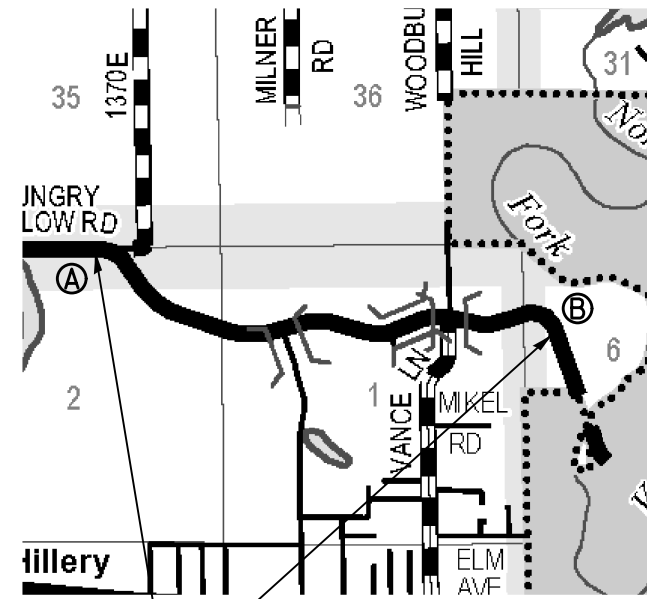

LIMITS OF IMPROVEMENT  
JURISDICTION: STATE

FILE NAME =	USER NAME = ceerlockjd	DESIGNED -	REVISED -
c:\pwork\work\pwork\ceerlockjd\0382855\0570A62-sht-Location_Maps.dgn		DRAWN -	REVISED -
	PLOT SCALE = 40.0000' / in.	CHECKED -	REVISED -
*MODELNAME*	PLOT DATE = 3/20/2014	DATE -	REVISED -

STATE OF ILLINOIS  
DEPARTMENT OF TRANSPORTATION

VERMILION COUNTY LOCATION MAPS

SCALE: SHEET 3 OF 3 SHEETS STA. TO STA.

F.A. RTE.	SECTION	COUNTY	TOTAL SHEETS	SHEET NO.
VAR.	•	VARIOUS	22	13
• D5 CURVE SIGNING 2014-1		CONTRACT NO. 70A62		
ILLINOIS FED. AID PROJECT				

# MCLEAN COUNTY SCHEDULES

MCLEAN COUNTY

URBAN LOCATIONS	LOCATION NO.	DESCRIPTION	LENGTH FEET	W1-8	W1-8	W1-8	W1-8	W1-1R	W1-1L	W1-2R	W1-2L	W1-3L	W1-4L	W13-1P	W13-3	METAL POST	WOOD POST	NOTES	ADVISORY SPEED
				SPACING FEET	18x24 EACH	24x30 EACH	30x36 EACH	36x36 EACH	36x36 EACH	36x36 EACH	36x36 EACH	24x24 EACH	36x48 EACH	EACH	EACH				
	1	US 150	772.90	160	12					1	1			2		6	2	DOUBLE CHEVRONS	50
	2	CAPODICE RD	255.00	80	10			1	1			1		3		5	3	DOUBLE CHEVRONS	30
	5	I 55B NB TO I 55 NB RAMP	786.98	120		8										8		SINGLE CHEVRONS	NONE
	6	VETERANS PRKY EB TO I 74 SB RAMP	846.00	120		8										8	1	SINGLE CHEVRONS	35
	7	I 74 WB	2600.00	200						14								SINGLE CHEVRONS	NONE
		I 74 EB	2180.00	200						12								SINGLE CHEVRONS	NONE
	8	US 51B	185.51	80	4							2		2		4	2	SINGLE CHEVRONS	25
	URBAN SUB-TOTAL				26	16	26	1	1	1	1	3		7	1	31	34		
RURAL LOCATIONS	3	I 55	2629.75	200						28							28	SINGLE CHEVRONS	NONE
	4	IL 251M - CURVE A	301.45	80	10			1					1	2		5	2	DOUBLE CHEVRONS	25
		IL 251M - CURVE B	1172.73	160	18								1			9	1	DOUBLE CHEVRONS	NONE
	9	CR 1750E / PJ KELLER HWY - CURVE A	330.00	120	8					1	1					4	2	DOUBLE CHEVRONS	NONE
		CR 1750E / PJ KELLER HWY - CURVE B	329.00	120	8					1	1					4	2	DOUBLE CHEVRONS	NONE
		CR 1750E / PJ KELLER HWY - CURVE C	781.00	120	16					1	1			2		8	2	DOUBLE CHEVRONS	35
	10	SCHOOL ST - CURVE A	1400.00	160	20								1	1			11	DOUBLE CHEVRONS	50
		SCHOOL ST - CURVE B	935.00	160	14								1	1			8	DOUBLE CHEVRONS	50
		SCHOOL ST - CURVE C	1185.00	-						1	1			2			2	-	50
	RURAL SUB-TOTAL				94		28	1		4	4		4	8		30	58		
MCLEAN COUNTY SUB-TOTAL				120	16	54	2	1	5	5	3	4	15	1	61	92			

SIGN PANEL - TYPE 1 (72000100)

SIGN	PANEL DIMENSION (INCH X INCH)	PANEL AREA (SQ FT)	URBAN	RURAL	URBAN	RURAL
			SIGN TOTAL	SIGN TOTAL	TOTAL PANEL AREA (SQ FT)	TOTAL PANEL AREA (SQ FT)
W1-8	18X24	3	26	94	78	282
W1-8	24X30	5	16	-	80	-
W1-8	30X36	7.5	26	28	195	210
W1-1R	36X36	9	1	1	9	9
W1-1L	36X36	9	1	-	9	-
W1-2R	36X36	9	1	4	9	36
W1-2L	36X36	9	1	4	9	36
W1-3L	36X36	9	3	-	27	-
W1-4L	36X36	9	-	4	-	36
W13-1P	24X24	4	7	8	28	32
			SUB-TOTAL		444	641
					(SQ FT)	(SQ FT)

SIGN PANEL - TYPE 2 (72000200)

SIGN	PANEL DIMENSION (INCH X INCH)	PANEL AREA (SQ FT)	URBAN	RURAL	URBAN	RURAL
			SIGN TOTAL	SIGN TOTAL	TOTAL PANEL AREA (SQ FT)	TOTAL PANEL AREA (SQ FT)
W13-3	36X48	12	1	-	12	-
			SUB-TOTAL		12	0
					(SQ FT)	(SQ FT)

SIGN REMOVAL (X7240300)

URBAN LOCATIONS	LOC NO.	DESCRIPTION	SIGN DESCRIPTION			SIGN REMOVAL (EACH)
			CHEVRON	ADVANCE WARN SIGN	ADVISORY SPEED SIGN	
	1	US 150		2		2
	2	CAPODICE RD		3	3	3
	5	I 55B NB TO I 55 NB RAMP		-	-	-
	6	VETERANS PRKY EB TO I 74 SB RAMP		-	1	1
	7	I 74 WB		-	-	-
		I 74 EB		-	-	-
	8	US 51B		2	2	2
			SUB-TOTAL			8
						(EACH)

RURAL LOCATIONS	LOC NO.	DESCRIPTION	SIGN DESCRIPTION			SIGN REMOVAL (EACH)
			CHEVRON	ADVANCE WARN SIGN	ADVISORY SPEED SIGN	
	3	I 55		-	-	-
	4	IL 251M - CURVE A		-	-	-
		IL 251M - CURVE B		1	1	1
	9	CR 1750E / PJ KELLER HWY - CURVE A		2	-	2
		CR 1750E / PJ KELLER HWY - CURVE B		2	-	2
		CR 1750E / PJ KELLER HWY - CURVE C		2	2	2
	10	SCHOOL ST - CURVE A		1	1	1
		SCHOOL ST - CURVE B		1	1	1
		SCHOOL ST - CURVE C		2	2	2
			SUB-TOTAL			11
						(EACH)

# MCLEAN COUNTY SCHEDULES

## METAL POST - TYPE A (72900100)

LOC NO.	DESCRIPTION	NUMBER OF POSTS	POST LENGTH (FOOT)	TOTAL POST LENGTH (FOOT)
URBAN LOCATIONS				
1	US 150	6	12	72
2	CAPODICE RD	5	12	60
5	I 55B NB TO I 55 NB RAMP	-	-	-
6	VETERANS PRKY EB TO I 74 SB RAMP	-	-	-
7	I 74 WB	-	-	-
	I 74 EB	-	-	-
8	US 51B	4	12	48
			SUB-TOTAL	180
				(FOOT)

LOC NO.	DESCRIPTION	NUMBER OF POSTS	POST LENGTH (FOOT)	TOTAL POST LENGTH (FOOT)
RURAL LOCATIONS				
3	I 55	-	-	-
4	IL 251M - CURVE A	5	12	60
	IL 251M - CURVE B	9	12	108
9	CR 1750E / PJ KELLER HWY - CURVE A	4	12	48
	CR 1750E / PJ KELLER HWY - CURVE B	4	12	48
	CR 1750E / PJ KELLER HWY - CURVE C	8	12	96
10	SCHOOL ST - CURVE A	-	-	-
	SCHOOL ST - CURVE B	-	-	-
	SCHOOL ST - CURVE C	-	-	-
			SUB-TOTAL	360
				(FOOT)

## WOOD SIGN SUPPORT (7300100)

LOC NO.	DESCRIPTION	NUMBER OF POSTS	POST LENGTH (FOOT)	TOTAL POST LENGTH (FOOT)
URBAN LOCATIONS				
1	US 150	2	18	36
2	CAPODICE RD	3	18	54
5	I 55B NB TO I 55 NB RAMP	-	-	-
6	VETERANS PRKY EB TO I 74 SB RAMP	1	18	18
7	I 74 WB	14	16	224
	I 74 EB	12	16	192
8	US 51B	2	18	36
			SUB-TOTAL	560
				(FOOT)

LOC NO.	DESCRIPTION	NUMBER OF POSTS	POST LENGTH (FOOT)	TOTAL POST LENGTH (FOOT)
RURAL LOCATIONS				
3	I 55	28	16	448
4	IL 251M - CURVE A	2	18	36
	IL 251M - CURVE B	1	16	16
9	CR 1750E / PJ KELLER HWY - CURVE A	2	16	32
	CR 1750E / PJ KELLER HWY - CURVE B	2	16	32
	CR 1750E / PJ KELLER HWY - CURVE C	2	18	36
10	SCHOOL ST - CURVE A	1	18	18
	SCHOOL ST - CURVE A	10	14	140
	SCHOOL ST - CURVE B	1	18	18
	SCHOOL ST - CURVE B	7	14	98
	SCHOOL ST - CURVE C	2	18	36
			SUB-TOTAL	910
				(FOOT)

## METAL POST - TYPE B (72900200)

LOC NO.	DESCRIPTION	NUMBER OF POSTS	POST LENGTH (FOOT)	TOTAL POST LENGTH (FOOT)
URBAN LOCATIONS				
1	US 150	-	-	-
2	CAPODICE RD	-	-	-
5	I 55B NB TO I 55 NB RAMP	8	14	112
6	VETERANS PRKY EB TO I 74 SB RAMP	8	14	112
7	I 74 WB	-	-	-
	I 74 EB	-	-	-
8	US 51B	-	-	-
			SUB-TOTAL	224
				(FOOT)

LOC NO.	DESCRIPTION	NUMBER OF POSTS	POST LENGTH (FOOT)	TOTAL POST LENGTH (FOOT)
RURAL LOCATIONS				
3	I 55	-	-	-
4	IL 251M - CURVE A	-	-	-
	IL 251M - CURVE B	-	-	-
9	CR 1750E / PJ KELLER HWY - CURVE A	-	-	-
	CR 1750E / PJ KELLER HWY - CURVE B	-	-	-
	CR 1750E / PJ KELLER HWY - CURVE C	-	-	-
10	SCHOOL ST - CURVE A	-	-	-
	SCHOOL ST - CURVE B	-	-	-
	SCHOOL ST - CURVE C	-	-	-
			SUB-TOTAL	0
				(FOOT)

# DOUGLAS COUNTY SCHEDULES

DOUGLAS COUNTY

	LOCATION NO.	DESCRIPTION	LENGTH FEET	W1-8 SPACING FEET	W1-8 18x24 EACH	W1-6R 48X24 EACH	W1-6L 48X24 EACH	W1-10R 36x36 EACH	W1-10L 36x36 EACH	W13-1P 24x24 EACH	METAL POST EACH	WOOD POST EACH	NOTES	ADVISORY SPEED
URBAN LOCATIONS	URBAN SUB-TOTAL													
RURAL LOCATIONS	11	IL 133	804.97	120	20	1	1	1	1	1	10	4	DOUBLE CHEVRONS	45
	RURAL SUB-TOTAL				20	1	1	1	1	1	10	4		
	DOUGLAS COUNTY SUB-TOTAL				20	1	1	1	1	1	10	4		

SIGN PANEL - TYPE 1 (72000100)

SIGN	PANEL DIMENSION (INCH X INCH)	PANEL AREA (SQ FT)	URBAN SIGN TOTAL	RURAL SIGN TOTAL	URBAN TOTAL PANEL AREA (SQ FT)	RURAL TOTAL PANEL AREA (SQ FT)
W1-8	18X24	3	-	20	-	60
W1-6R	48X24	8	-	1	-	8
W1-6L	48X24	8	-	1	-	8
W1-10R	36X36	9	-	1	-	9
W1-10L	36X36	9	-	1	-	9
W13-1P	24X24	4	-	1	-	4
				SUB-TOTAL	0 (SQ FT)	98 (SQ FT)

SIGN REMOVAL (X7240300)

	LOC NO.	DESCRIPTION	SIGN DESCRIPTION			SIGN REMOVAL (EACH)
			CHEVRON	ADVANCE WARN SIGN	ADVISORY SPEED SIGN	
URBAN LOCATIONS	-	-	-	-	-	-
						SUB-TOTAL 0 (EACH)
RURAL LOCATIONS	11	IL 133	20	4	1	24
						SUB-TOTAL 24 (EACH)

METAL POST - TYPE A (72900100)

	LOC NO.	DESCRIPTION	NUMBER OF POSTS	POST LENGTH (FOOT)	TOTAL POST LENGTH (FOOT)
URBAN LOCATIONS	-	-	-	-	-
				SUB-TOTAL	0 (FOOT)
RURAL LOCATIONS	11	IL 133	10	12	120
				SUB-TOTAL	120 (FOOT)

WOOD SIGN SUPPORT (7300100)

	LOC NO.	DESCRIPTION	NUMBER OF POSTS	POST LENGTH (FOOT)	TOTAL POST LENGTH (FOOT)
URBAN LOCATIONS	-	-	-	-	-
				SUB-TOTAL	0 (FOOT)
RURAL LOCATIONS	11	IL 133	2	14	28
			1	16	16
			1	18	18
				SUB-TOTAL	62 (FOOT)



# CHAMPAIGN COUNTY SCHEDULES

CHAMPAIGN COUNTY

LOCATION NO.	DESCRIPTION	LENGTH FEET	W1-8	W1-8	W1-8	W1-6R	W1-6L	W1-1R	W1-1L	W1-2R	W1-2L	W1-4R	W1-5L	W1-15	W13-1P	W13-3	METAL POST EACH	TELE POST EACH	WOOD POST EACH	NOTES	ADVISORY SPEED
			SPACING FEET	18x24 EACH	24x30 EACH	36x36 EACH	36x36 EACH	36x36 EACH	36x36 EACH	36x36 EACH	36x36 EACH	36x36 EACH	36x36 EACH	24x24 EACH	36x48 EACH	24x24 EACH	36x48 EACH				
13	PRAIRIEVIEW RD TO I 74 EB RAMP	483.62	120		5												5			SINGLE CHEVRONS	NONE
14	I 72 EB TO I 57 SB RAMP	1437.60	80		19											1	19		1	SINGLE CHEVRONS	30
15	I 72 WB TO I 57 NB RAMP	1512.60	80		20											1	20		1	SINGLE CHEVRONS	30
16	PHILO RD	205.00	80	8			1	1	1	1					2		4		4	DOUBLE CHEVRONS	30
18	US 130 NB TO I 74 WB RAMP	1330.00	80		18									1	1		18		1	SINGLE CHEVRONS	25
URBAN SUB-TOTAL				8	62	1	1	1	1					1	3	2	66		7		
RURAL LOCATIONS																					
12	IL 47 - CURVE A	1171.28	160	18						1	1						9		2	DOUBLE CHEVRONS	NONE
	IL 47 - CURVE B	1172.66	160	18						1	1						9		2	DOUBLE CHEVRONS	NONE
17	CR 600E - CURVE A	206.00	120	6									1		1			4		DOUBLE CHEVRONS	35
	CR 600E - CURVE B	202.00	120	6									1		1			4		DOUBLE CHEVRONS	35
19	IL 47 - CURVE A	949.40	160	14						1	1						7		2	DOUBLE CHEVRONS	NONE
	IL 47 - CURVE B	956.81	160	14						1	1						7		2	DOUBLE CHEVRONS	NONE
20	RISING RD	-	120	12								2						8		DOUBLE CHEVRONS	NONE
RURAL SUB-TOTAL				88						4	4	2	2		2		32	16	8		
CHAMPAIGN COUNTY SUB-TOTAL				96	62	1	1	1	1	4	4	2	2	1	5	2	98	16	15		

SIGN PANEL - TYPE 1 (72000100)

SIGN	PANEL DIMENSION (INCH X INCH)	PANEL AREA (SQ FT)	URBAN SIGN TOTAL	RURAL SIGN TOTAL	URBAN TOTAL PANEL AREA (SQ FT)	RURAL TOTAL PANEL AREA (SQ FT)
W1-8	18X24	3	8	88	24	264
W1-8	24X30	5	62	-	310	-
W1-6R	36X36	9	1	-	9	-
W1-6L	36X36	9	1	-	9	-
W1-1R	36X36	9	1	-	9	-
W1-1L	36X36	9	1	-	9	-
W1-2R	36X36	9	-	4	-	36
W1-2L	36X36	9	-	4	-	36
W1-4R	36X36	9	-	2	-	18
W1-5L	36X36	9	-	2	-	18
W1-15	36X36	9	1	-	9	-
W13-1P	24X24	4	3	2	12	8
SUB-TOTAL					391 (SQ FT)	380 (SQ FT)

SIGN REMOVAL (X7240300)

URBAN LOCATIONS	LOC NO.	DESCRIPTION	SIGN DESCRIPTION			SIGN REMOVAL (EACH)
			CHEVRON	ADVANCE WARN SIGN	ADVISORY SPEED SIGN	
	13	PRAIRIEVIEW RD TO I 74 EB RAMP	-	-	-	-
	14	I 72 EB TO I 57 SB RAMP	-	-	-	-
	15	I 72 WB TO I 57 NB RAMP	-	-	1	1
	16	PHILO RD	-	2	2	2
	18	US 130 NB TO I 74 WB RAMP	-	1	1	1
SUB-TOTAL						4 (EACH)
RURAL LOCATIONS	LOC NO.	DESCRIPTION	CHEVRON	ADVANCE WARN SIGN	ADVISORY SPEED SIGN	SIGN REMOVAL (EACH)
	12	IL 47 - CURVE A	-	2	2	2
		IL 47 - CURVE B	-	2	2	2
	17	CR 600E - CURVE A	-	1	1	1
		CR 600E - CURVE B	-	1	1	1
	19	IL 47 - CURVE A	-	2	-	2
		IL 47 - CURVE B	-	2	-	2
	20	RISING RD	4	-	-	4
SUB-TOTAL						14 (EACH)

SIGN PANEL - TYPE 2 (72000200)

SIGN	PANEL DIMENSION (INCH X INCH)	PANEL AREA (SQ FT)	URBAN SIGN TOTAL	RURAL SIGN TOTAL	URBAN TOTAL PANEL AREA (SQ FT)	RURAL TOTAL PANEL AREA (SQ FT)
W13-3	36X48	12	2	-	24	-
SUB-TOTAL					24 (SQ FT)	0 (SQ FT)

# CHAMPAIGN COUNTY SCHEDULES

## METAL POST - TYPE A (72900100)

URBAN LOCATIONS	LOC NO.	DESCRIPTION	NUMBER OF POSTS	POST LENGTH (FOOT)	TOTAL POST LENGTH (FOOT)
	13	PRAIRIEVIEW RD TO I 74 EB RAMP	5	16	80
	14	I 72 EB TO I 57 SB RAMP	-	-	-
	15	I 72 WB TO I 57 NB RAMP	-	-	-
	16	PHILO RD	4	12	48
	18	US 130 NB TO I 74 WB RAMP	-	-	-
		SUB-TOTAL			128 (FOOT)

RURAL LOCATIONS	LOC NO.	DESCRIPTION	NUMBER OF POSTS	POST LENGTH (FOOT)	TOTAL POST LENGTH (FOOT)
	12	IL 47 - CURVE A	9	12	108
		IL 47 - CURVE B	9	12	108
	17	CR 600E - CURVE A	-	-	-
		CR 600E - CURVE B	-	-	-
	19	IL 47 - CURVE A	7	12	84
		IL 47 - CURVE B	7	12	84
	20	RISING RD	-	-	-
		SUB-TOTAL			384 (FOOT)

## METAL POST - TYPE B (72900200)

URBAN LOCATIONS	LOC NO.	DESCRIPTION	NUMBER OF POSTS	POST LENGTH (FOOT)	TOTAL POST LENGTH (FOOT)
	13	PRAIRIEVIEW RD TO I 74 EB RAMP	-	-	-
	14	I 72 EB TO I 57 SB RAMP	19	16	304
	15	I 72 WB TO I 57 NB RAMP	20	16	320
	16	PHILO RD	-	-	-
	18	US 130 NB TO I 74 WB RAMP	18	16	288
		SUB-TOTAL			912 (FOOT)

RURAL LOCATIONS	LOC NO.	DESCRIPTION	NUMBER OF POSTS	POST LENGTH (FOOT)	TOTAL POST LENGTH (FOOT)
	12	IL 47 - CURVE A	-	-	-
		IL 47 - CURVE B	-	-	-
	17	CR 600E - CURVE A	-	-	-
		CR 600E - CURVE B	-	-	-
	19	IL 47 - CURVE A	-	-	-
		IL 47 - CURVE B	-	-	-
	20	RISING RD	-	-	-
		SUB-TOTAL			0 (FOOT)

## WOOD SIGN SUPPORT (7300100)

URBAN LOCATIONS	LOC NO.	DESCRIPTION	NUMBER OF POSTS	POST LENGTH (FOOT)	TOTAL POST LENGTH (FOOT)
	13	PRAIRIEVIEW RD TO I 74 EB RAMP	-	-	-
	14	I 72 EB TO I 57 SB RAMP	1	18	18
	15	I 72 WB TO I 57 NB RAMP	1	18	18
	16	PHILO RD	2	14	28
		PHILO RD	2	18	36
	18	US 130 NB TO I 74 WB RAMP	1	18	18
		SUB-TOTAL			118 (FOOT)

RURAL LOCATIONS	LOC NO.	DESCRIPTION	NUMBER OF POSTS	POST LENGTH (FOOT)	TOTAL POST LENGTH (FOOT)
	12	IL 47 - CURVE A	2	16	32
		IL 47 - CURVE B	2	16	32
	17	CR 600E - CURVE A	-	-	-
		CR 600E - CURVE B	-	-	-
	19	IL 47 - CURVE A	2	16	32
		IL 47 - CURVE B	2	16	32
	20	RISING RD	-	-	-
		SUB-TOTAL			128 (FOOT)

## TELESCOPING STEEL SIGN SUPPORT (72800100)

URBAN LOCATIONS	LOC NO.	DESCRIPTION	NUMBER OF POSTS	POST LENGTH (FOOT)	TOTAL POST LENGTH (FOOT)
	13	PRAIRIEVIEW RD TO I 74 EB RAMP	-	-	-
	14	I 72 EB TO I 57 SB RAMP	-	-	-
	15	I 72 WB TO I 57 NB RAMP	-	-	-
	16	PHILO RD	-	-	-
	18	US 130 NB TO I 74 WB RAMP	-	-	-
		SUB-TOTAL			0 (FOOT)

RURAL LOCATIONS	LOC NO.	DESCRIPTION	NUMBER OF POSTS	POST LENGTH (FOOT)	TOTAL POST LENGTH (FOOT)
	12	IL 47 - CURVE A	-	-	-
		IL 47 - CURVE B	-	-	-
	17	CR 600E - CURVE A	3	14	42
		CR 600E - CURVE B	1	18	18
		CR 600E - CURVE A	3	14	42
		CR 600E - CURVE B	1	18	18
	19	IL 47 - CURVE A	-	-	-
		IL 47 - CURVE B	-	-	-
	20	RISING RD	6	14	84
		RISING RD	2	16	32
		SUB-TOTAL			236 (FOOT)

# VERMILION COUNTY SCHEDULES

VERMILION COUNTY

URBAN LOCATIONS	LOCATION NO.	DESCRIPTION	LENGTH FEET	W1-8	W1-8	W1-8	W1-2R	W1-2L	W1-3L	W1-4R	W1-5R	W1-5L	W13-1P	W13-3	METAL	TELE	WOOD	NOTES	ADVISORY SPEED
				SPACING FEET	18x24 EACH	24x30 EACH	36x36 EACH	36x36 EACH	36x36 EACH	36x36 EACH	24X24 EACH	36X48 EACH	POST EACH	POST EACH	POST EACH				
	22	US 150 NB TO I 74 EB RAMP	995.73	80		14								1	14		1	SINGLE CHEVRONS	30
	24	WILLIAMS ST			4				2							4		DOUBLE CHEVRONS	NONE
	28	HUNGRY HOLLOW RD - CURVE A	625.00	120	14						1		1			8		DOUBLE CHEVRONS	40
		HUNGRY HOLLOW RD - CURVE B	833.00	120	16							1	1			9		DOUBLE CHEVRONS	40
URBAN SUB-TOTAL					34	14			2		1	1	2	1	14	21	1		
RURAL LOCATIONS																			
	21	GEORGETOWN-INDIANOLA RD	570.00	160	10		1	1							5		2	DOUBLE CHEVRONS	NONE
	23	US 150 - CURVE A	1583.49	160	22		1	1					2		11		2	DOUBLE CHEVRONS	50
		US 150 - CURVE B	1587.96	160	22		1	1					2		11		2	DOUBLE CHEVRONS	50
	25	GLENBURN CREEK RD	546.00	80	16		1	1								10		DOUBLE CHEVRONS	NONE
	26	MANN'S CHAPEL RD - CURVE A	201.00	120	6					1						4		DOUBLE CHEVRONS	NONE
		MANN'S CHAPEL RD - CURVE B	256.00	120	6					1						4		DOUBLE CHEVRONS	NONE
	27	W NEWELL RD - CURVE A	786.00	120	16					1			1			9		DOUBLE CHEVRONS	40
		W NEWELL RD - CURVE B	799.00	120	16					1			1			9		DOUBLE CHEVRONS	40
RURAL SUB-TOTAL					114			4	4	4			6		27	36	6		
VERMILION COUNTY SUB-TOTAL					148	14	4	4	2	4	1	1	8	1	41	57	7		

SIGN PANEL - TYPE 1 (72000100)

SIGN	PANEL DIMENSION (INCH X INCH)	PANEL AREA (SQ FT)	URBAN SIGN TOTAL	RURAL SIGN TOTAL	URBAN TOTAL PANEL AREA (SQ FT)	RURAL TOTAL PANEL AREA (SQ FT)
W1-8	18X24	3	34	114	102	342
W1-8	24X30	5	14	-	70	-
W1-2R	36X36	9	-	4	-	36
W1-2L	36X36	9	-	4	-	36
W1-3L	36X36	9	2	-	18	-
W1-4R	36X36	9	-	4	-	36
W1-5R	36X36	9	1	-	9	-
W1-5L	36X36	9	1	-	9	-
W13-1P	24X24	4	2	6	8	24
SUB-TOTAL					216 (SQ FT)	474 (SQ FT)

SIGN REMOVAL (X7240300)

URBAN LOCATIONS	LOC NO.	DESCRIPTION	SIGN DESCRIPTION			SIGN REMOVAL (EACH)
			CHEVRON	ADVANCE WARN SIGN	ADVISORY SPEED SIGN	
	22	US 150 NB TO I 74 EB RAMP	-	-	1	1
	24	WILLIAMS ST	2	2	-	4
	28	HUNGRY HOLLOW RD - CURVE A	-	1	1	1
		HUNGRY HOLLOW RD - CURVE B	-	1	1	1
SUB-TOTAL						7 (EACH)

SIGN PANEL - TYPE 2 (72000200)

SIGN	PANEL DIMENSION (INCH X INCH)	PANEL AREA (SQ FT)	URBAN SIGN TOTAL	RURAL SIGN TOTAL	URBAN TOTAL PANEL AREA (SQ FT)	RURAL TOTAL PANEL AREA (SQ FT)
W13-3	36X48	12	1	-	12	-
SUB-TOTAL					12 (SQ FT)	0 (SQ FT)

RURAL LOCATIONS	LOC NO.	DESCRIPTION	SIGN DESCRIPTION			SIGN REMOVAL (EACH)
			CHEVRON	ADVANCE WARN SIGN	ADVISORY SPEED SIGN	
	21	GEORGETOWN-INDIANOLA RD	-	-	-	-
	23	US 150 - CURVE A	-	2	2	2
		US 150 - CURVE B	-	2	2	2
	25	GLENBURN CREEK RD	-	-	-	-
	26	MANN'S CHAPEL RD - CURVE A	-	-	-	-
		MANN'S CHAPEL RD - CURVE B	-	1	-	1
	27	W NEWELL RD - CURVE A	-	1	1	1
		W NEWELL RD - CURVE B	-	1	1	1
SUB-TOTAL						7 (EACH)

# VERMILION COUNTY SCHEDULES

## METAL POST - TYPE A (72900100)

URBAN LOCATIONS	LOC NO.	DESCRIPTION	NUMBER OF POSTS	POST LENGTH (FOOT)	TOTAL POST LENGTH (FOOT)
	22	US 150 NB TO I 74 EB RAMP	-	-	-
	24	WILLIAMS ST	-	-	-
		WILLIAMS ST	-	-	-
	28	HUNGRY HOLLOW RD - CURVE A	-	-	-
		HUNGRY HOLLOW RD - CURVE A	-	-	-
		HUNGRY HOLLOW RD - CURVE B	-	-	-
		HUNGRY HOLLOW RD - CURVE B	-	-	-
		SUB-TOTAL		0	(FOOT)

RURAL LOCATIONS	LOC NO.	DESCRIPTION	NUMBER OF POSTS	POST LENGTH (FOOT)	TOTAL POST LENGTH (FOOT)
	21	GEORGETOWN-INDIANOLA RD	5	12	60
	23	US 150 - CURVE A	11	12	132
		US 150 - CURVE B	11	12	132
	25	GLENBURN CREEK RD	-	-	-
	26	MANN'S CHAPEL RD - CURVE A	-	-	-
		MANN'S CHAPEL RD - CURVE B	-	-	-
	27	W NEWELL RD - CURVE A	-	-	-
		W NEWELL RD - CURVE B	-	-	-
		SUB-TOTAL		324	(FOOT)

## METAL POST - TYPE B (72900200)

URBAN LOCATIONS	LOC NO.	DESCRIPTION	NUMBER OF POSTS	POST LENGTH (FOOT)	TOTAL POST LENGTH (FOOT)
	22	US 150 NB TO I 74 EB RAMP	14	16	224
	24	WILLIAMS ST	-	-	-
	28	HUNGRY HOLLOW RD - CURVE A	-	-	-
		HUNGRY HOLLOW RD - CURVE B	-	-	-
		SUB-TOTAL		224	(FOOT)

RURAL LOCATIONS	LOC NO.	DESCRIPTION	NUMBER OF POSTS	POST LENGTH (FOOT)	TOTAL POST LENGTH (FOOT)
	21	GEORGETOWN-INDIANOLA RD	-	-	-
	23	US 150 - CURVE A	-	-	-
		US 150 - CURVE B	-	-	-
	25	GLENBURN CREEK RD	-	-	-
	26	MANN'S CHAPEL RD - CURVE A	-	-	-
		MANN'S CHAPEL RD - CURVE B	-	-	-
	27	W NEWELL RD - CURVE A	-	-	-
		W NEWELL RD - CURVE B	-	-	-
		SUB-TOTAL		0	(FOOT)

## WOOD SIGN SUPPORT (7300100)

URBAN LOCATIONS	LOC NO.	DESCRIPTION	NUMBER OF POSTS	POST LENGTH (FOOT)	TOTAL POST LENGTH (FOOT)
	22	US 150 NB TO I 74 EB RAMP	1	18	18
	24	WILLIAMS ST	-	-	-
	28	HUNGRY HOLLOW RD - CURVE A	-	-	-
		HUNGRY HOLLOW RD - CURVE B	-	-	-
		SUB-TOTAL		18	(FOOT)

RURAL LOCATIONS	LOC NO.	DESCRIPTION	NUMBER OF POSTS	POST LENGTH (FOOT)	TOTAL POST LENGTH (FOOT)
	21	GEORGETOWN-INDIANOLA RD	2	16	32
	23	US 150 - CURVE A	2	18	36
		US 150 - CURVE B	2	18	36
	25	GLENBURN CREEK RD	-	-	-
	26	MANN'S CHAPEL RD - CURVE A	-	-	-
		MANN'S CHAPEL RD - CURVE B	-	-	-
	27	W NEWELL RD - CURVE A	-	-	-
		W NEWELL RD - CURVE B	-	-	-
		SUB-TOTAL		104	(FOOT)

## TELESCOPING STEEL SIGN SUPPORT (72800100)

URBAN LOCATIONS	LOC NO.	DESCRIPTION	NUMBER OF POSTS	POST LENGTH (FOOT)	TOTAL POST LENGTH (FOOT)
	22	US 150 NB TO I 74 EB RAMP	-	-	-
	24	WILLIAMS ST	2	14	28
		WILLIAMS ST	2	16	32
	28	HUNGRY HOLLOW RD - CURVE A	7	14	98
		HUNGRY HOLLOW RD - CURVE A	1	16	16
		HUNGRY HOLLOW RD - CURVE B	8	14	112
		HUNGRY HOLLOW RD - CURVE B	1	16	16
		SUB-TOTAL		302	(FOOT)

RURAL LOCATIONS	LOC NO.	DESCRIPTION	NUMBER OF POSTS	POST LENGTH (FOOT)	TOTAL POST LENGTH (FOOT)
	21	GEORGETOWN-INDIANOLA RD	-	-	-
	23	US 150 - CURVE A	-	-	-
		US 150 - CURVE B	-	-	-
	25	GLENBURN CREEK RD	8	14	112
		GLENBURN CREEK RD	2	16	32
	26	MANN'S CHAPEL RD - CURVE A	3	14	42
		MANN'S CHAPEL RD - CURVE A	1	16	16
		MANN'S CHAPEL RD - CURVE B	3	14	42
		MANN'S CHAPEL RD - CURVE B	1	16	16
	27	W NEWELL RD - CURVE A	8	14	112
		W NEWELL RD - CURVE A	1	18	18
		W NEWELL RD - CURVE B	8	14	112
		W NEWELL RD - CURVE B	1	18	18
		SUB-TOTAL		520	(FOOT)

# SUMMARY OF SCHEDULES

	SIGN REMOVAL X7240300 (EACH)	SIGN - T1 72000100 (SQ FT)	SIGN - T2 72000200 (SQ FT)	METAL POST - TA 72900100 (FOOT)	METAL POST - TB 72900200 (FOOT)	TELE SUPPORT 72800100 (FOOT)	WOOD SUPPORT 73000100 (FOOT)
MCLEAN COUNTY URBAN	8.0	444.0	12.0	180.0	224.0	0.0	560.0
DOUGLAS COUNTY URBAN	0.0	0.0	0.0	0.0	0.0	0.0	0.0
CHAMPAIGN COUNTY URBAN	4.0	391.0	24.0	128.0	912.0	0.0	118.0
VERMILION COUNTY URBAN	7.0	216.0	12.0	0.0	224.0	302.0	18.0
<b>URBAN SUB-TOTALS</b>	<b>19.0</b> (EACH)	<b>1051.0</b> (SQ FT)	<b>48.0</b> (SQ FT)	<b>308.0</b> (FOOT)	<b>1360.0</b> (FOOT)	<b>302.0</b> (FOOT)	<b>696.0</b> (FOOT)
MCLEAN COUNTY RURAL	11.0	641.0	0.0	360.0	0.0	0.0	910.0
DOUGLAS COUNTY RURAL	24.0	98.0	0.0	120.0	0.0	0.0	62.0
CHAMPAIGN COUNTY RURAL	14.0	380.0	0.0	384.0	0.0	236.0	128.0
VERMILION COUNTY RURAL	7.0	474.0	0.0	324.0	0.0	520.0	104.0
<b>RURAL SUB-TOTALS</b>	<b>56.0</b> (EACH)	<b>1593.0</b> (SQ FT)	<b>0.0</b> (SQ FT)	<b>1188.0</b> (FOOT)	<b>0.0</b> (FOOT)	<b>756.0</b> (FOOT)	<b>1204.0</b> (FOOT)
<b>FINAL TOTALS</b>	<b>75.0</b> (EACH)	<b>2644.0</b> (SQ FT)	<b>48.0</b> (SQ FT)	<b>1496.0</b> (FOOT)	<b>1360.0</b> (FOOT)	<b>1058.0</b> (FOOT)	<b>1900.0</b> (FOOT)

# DETAIL OF TYPICAL SIGN PLACEMENT

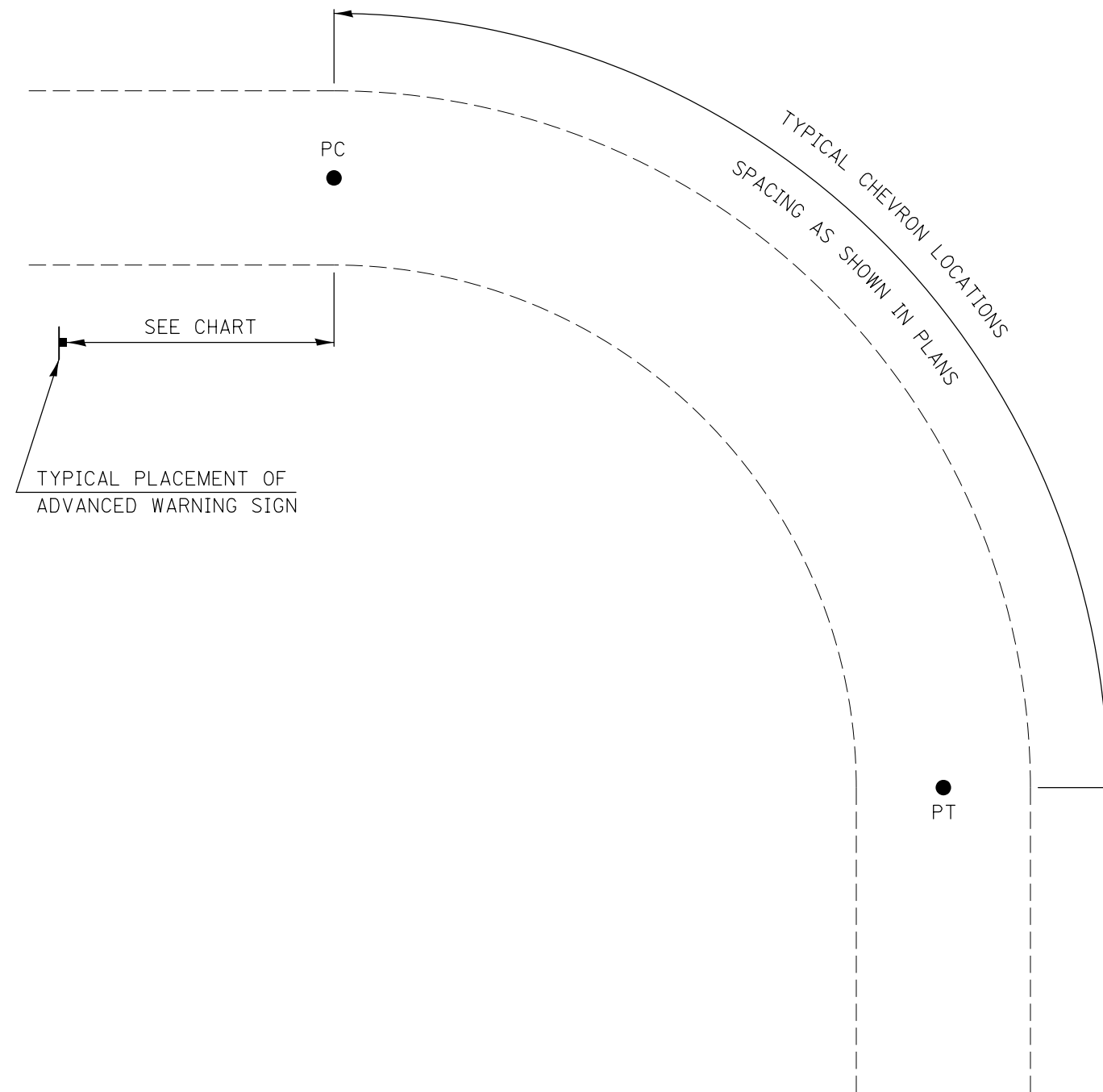

POSTED SPEED	ADVANCE PLACEMENT DISTANCE							
	ADVISORY SPEED							
	0	10	20	30	40	50	60	70
20 MPH	100 FT	100 FT	-	-	-	-	-	-
25 MPH	100 FT	100 FT	100 FT	-	-	-	-	-
30 MPH	100 FT	100 FT	100 FT	-	-	-	-	-
35 MPH	100 FT	100 FT	100 FT	100 FT	-	-	-	-
40 MPH	125 FT	100 FT	100 FT	100 FT	-	-	-	-
45 MPH	175 FT	125 FT	100 FT	100 FT	100 FT	-	-	-
50 MPH	250 FT	200 FT	175 FT	125 FT	100 FT	-	-	-
55 MPH	325 FT	275 FT	225 FT	200 FT	125 FT	100 FT	-	-
60 MPH	400 FT	350 FT	325 FT	275 FT	200 FT	100 FT	-	-
65 MPH	475 FT	450 FT	400 FT	350 FT	275 FT	200 FT	100 FT	-
70 MPH	550 FT	525 FT	500 FT	450 FT	375 FT	275 FT	150 FT	100 FT

THE MINIMUM ADVANCE PLACEMENT DISTANCE IS LISTED AS 100 FT TO PROVIDE ADEQUATE SPACING BETWEEN SIGNS