

F.A.P. RTE.	SECTION	COUNTY	TOTAL SHEETS	SHEET NO.
612	(101) RS-10	SCHUYLER	6	1
FED. ROAD DIST. NO.	ILLINOIS	CONTRACT NO. 72G44		

STATE OF ILLINOIS  
DEPARTMENT OF TRANSPORTATION  
DIVISION OF HIGHWAYS

# PROPOSED CONTRACT MAINTENANCE

FOR INDEX OF SHEETS, SEE SHEET NO. 2

FAP 612 (IL 103)  
SECTION (101) RS-10

SCHUYLER COUNTY

C-96-008-14  
R 1 W



ADT = 650  
SU = 30  
MU = 60

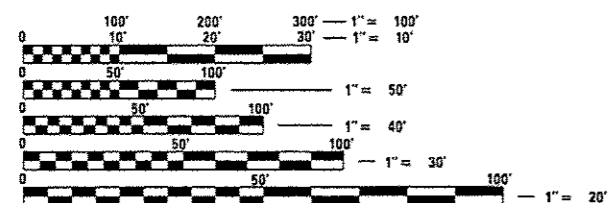

FULL SIZE PLANS HAVE BEEN PREPARED USING STANDARD ENGINEERING SCALES. REDUCED SIZED PLANS WILL NOT CONFORM TO STANDARD SCALES. IN MAKING MEASUREMENTS ON REDUCED PLANS, THE ABOVE SCALES MAY BE USED.

J.U.L.I.E.  
JOINT UTILITY LOCATION INFORMATION FOR EXCAVATION  
1-800-892-0123  
OR 811

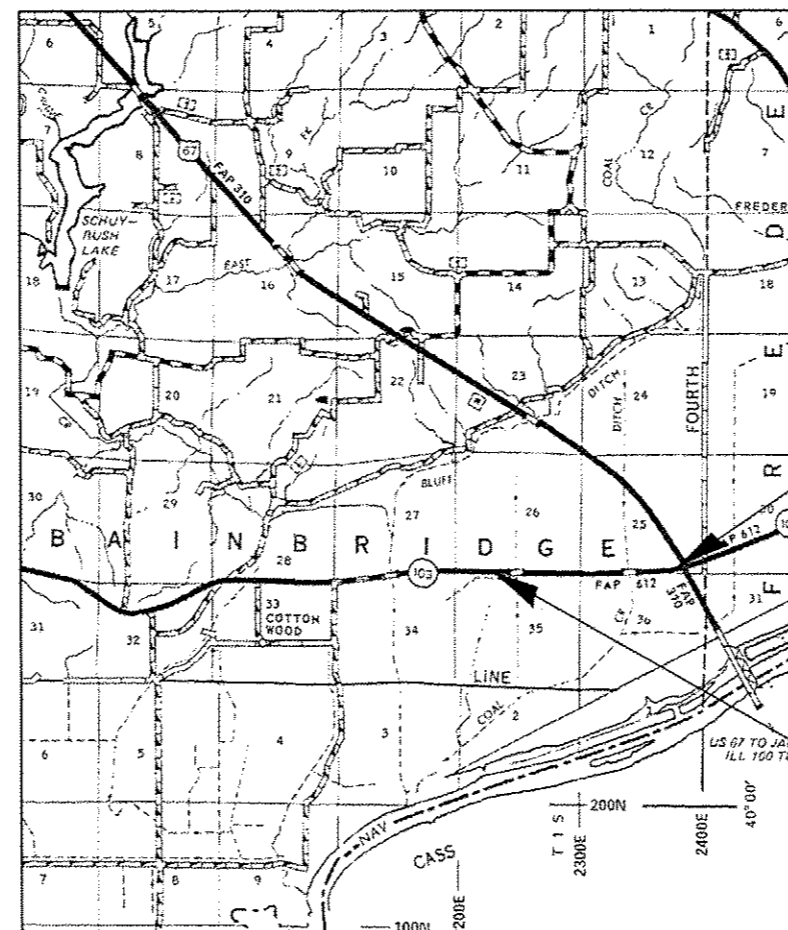

END PROJECT  
STA. 14 + 623.846

BEGIN PROJECT  
STA. 11 + 887.961

GROSS LENGTH = 8,976.00 FT. = 1.700 MILE

PLAN AND CONTRACT TECHNICIAN  
TIMOTHY SHARP (217)782-7743

CONTRACT NO. 72G44

STATE OF ILLINOIS  
DEPARTMENT OF TRANSPORTATION  
DIVISION OF HIGHWAYS

SUBMITTED March 24 20 14

*Roger Z...*  
DEPUTY DIRECTOR OF HIGHWAYS, REGION ENGINEER

May 9 20 14  
*John D. Baranzelli, PE, Jr.*  
ENGINEER OF DESIGN AND ENVIRONMENT

May 9 20 14  
*Omer Osman, PE, Jr.*  
DIRECTOR OF HIGHWAYS, CHIEF ENGINEER

PRINTED BY THE AUTHORITY  
OF THE STATE OF ILLINOIS