

* Note: From existing Handhole in NE Quadrant to the East: See Detector Loop Sheets for Detector information

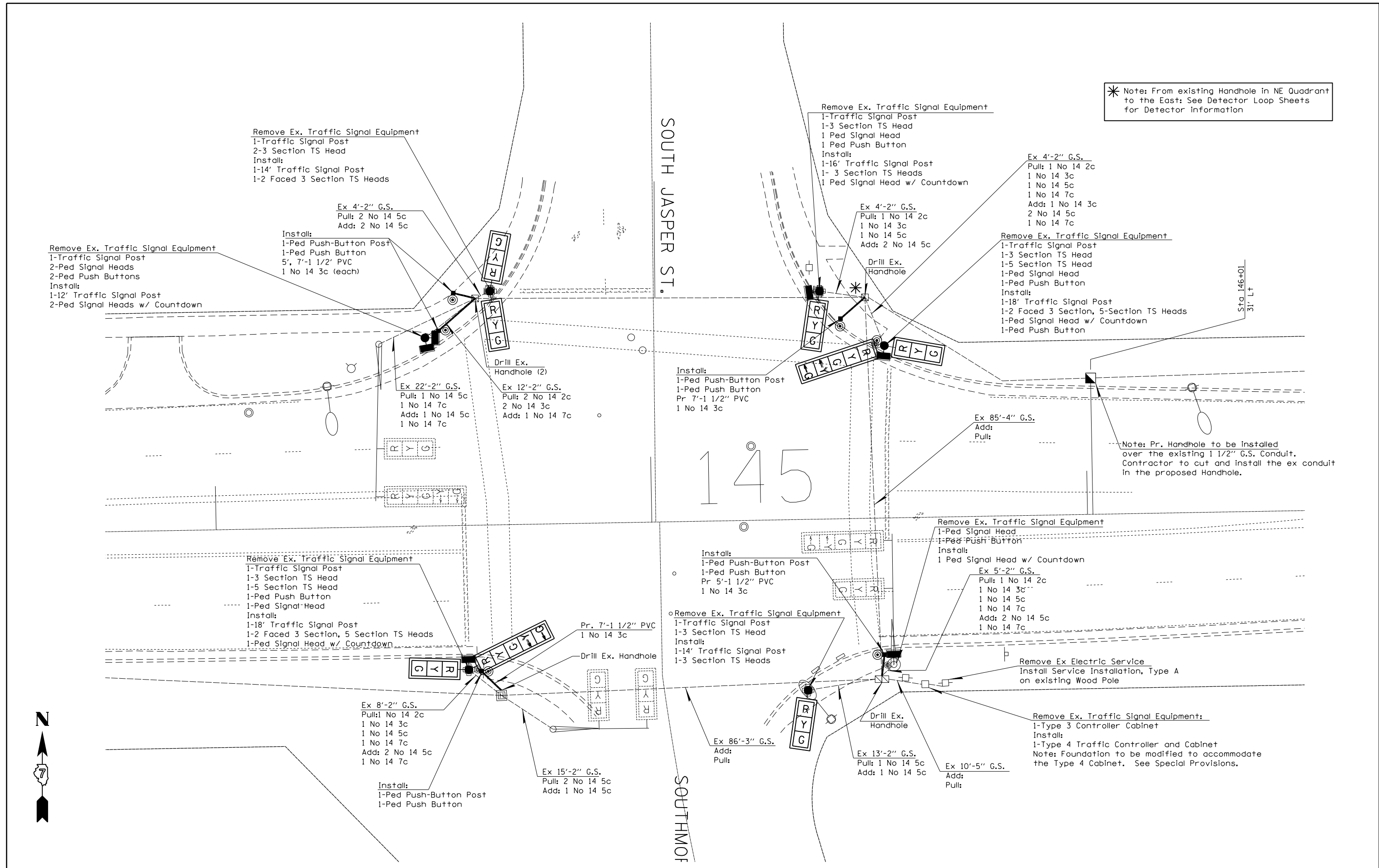

FILE NAME =
 c:\pwwork\pwwork\stef\enmk\d0181707\074475-TS-sht.dgn

USER NAME = stefenmk
 DESIGNED -
 DRAWN -
 PLOT SCALE = 20.0000' / in.
 PLOT DATE = 4/4/2014

DESIGNED -
 DRAWN -
 CHECKED -
 DATE -

REVISED -
 REVISED -
 REVISED -
 REVISED -

**STATE OF ILLINOIS
 DEPARTMENT OF TRANSPORTATION**

**TRAFFIC SIGNAL PLANS
 INTERSECTION OF JASPER/SOUTH MORELAND-SIGNALS & CABLES**

SCALE: SHEET 5 OF 18 SHEETS STA. TO STA.

F.A.P. RTE.	SECTION	COUNTY	TOTAL SHEETS	SHEET NO.
712	128RS-4,148KRS-2	Macon	73	57
ILLINOIS FED. AID PROJECT			CONTRACT NO. 74475	