

CONSTRUCT PERPENDICULAR
MID-BLOCK CURB RAMP IN
ACCORDANCE WITH STANDARD 424016

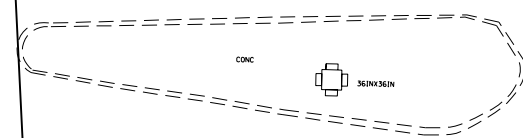

ADD CROSSWALK



PAY ITEM (UNIT)	COURT & MAIN							
	QUADRANT							
	NW		NE		SW		SE	
	state	city	state	city	state	city	state	city
SIDEWALK REMOVAL (SQ FT)	173				194			157
CURB REMOVAL (FOOT)								
COMB. CURB & GUTTER REMOVAL (FOOT)	15							
COMB. CONC. CURB & GUTTER, TYPE B-6.12 (FOOT)	15							
COMB. CONC. CURB & GUTTER, TYPE B-6.24 (FOOT)	15							
PCC SIDEWALK 4" (SQ FT)	173				153			157
DETECTABLE WARNINGS (SQ FT)	8				8			8

CONSTRUCT DIAGONAL
CURB RAMP IN ACCORDANCE
WITH STANDARD 424006

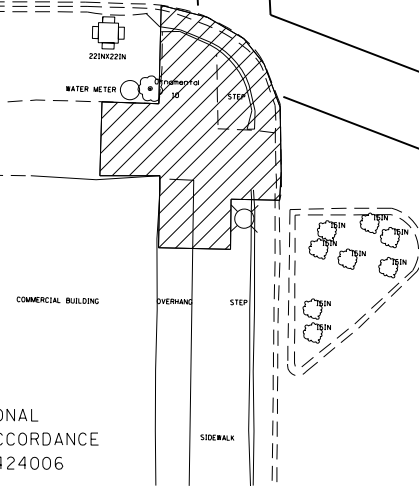

ϕ COURT ST +85

CONSTRUCT CORNER PARALLEL
CURB RAMP IN ACCORDANCE
WITH STANDARD 424011

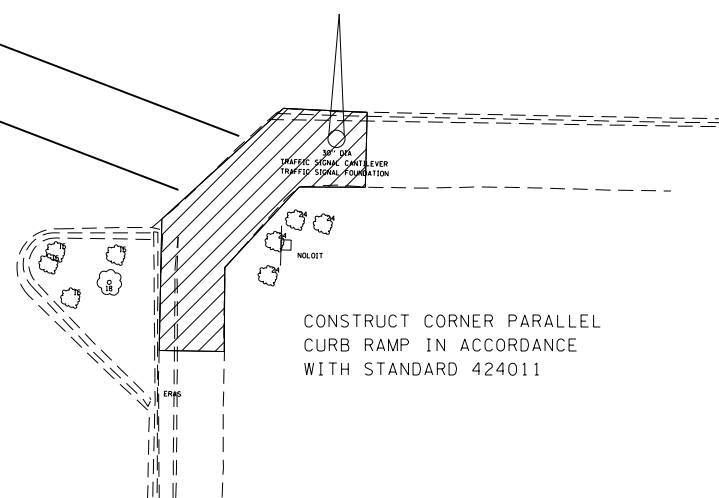

FILE NAME =	USER NAME = steffenmk	DESIGNED -	REVISED -
c:\pw\work\p\dot\steffenmk\d0282300\074554-sht-sidewalk-details.dgn		DRAWN -	REVISED -
Default	PLOT SCALE = 16.0000' / in.	CHECKED -	REVISED -
	PLOT DATE = 4/5/2013	DATE -	REVISED -

STATE OF ILLINOIS
DEPARTMENT OF TRANSPORTATION

SIDEWALK DETAILS
COURT STREET

SCALE: SHEET 10 OF 15 SHEETS STA. TO STA.

F.A.P. RTE.	SECTION	COUNTY	TOTAL SHEETS	SHEET NO.
781	(1Z,17Z)RS-1	CRAWFORD	60	40
CONTRACT NO. 74554			ILLINOIS FED. AID PROJECT	