

MATCHLINE STA. 205+00

MATCHLINE STA. 28+00

MATCHLINE STA. 210+00

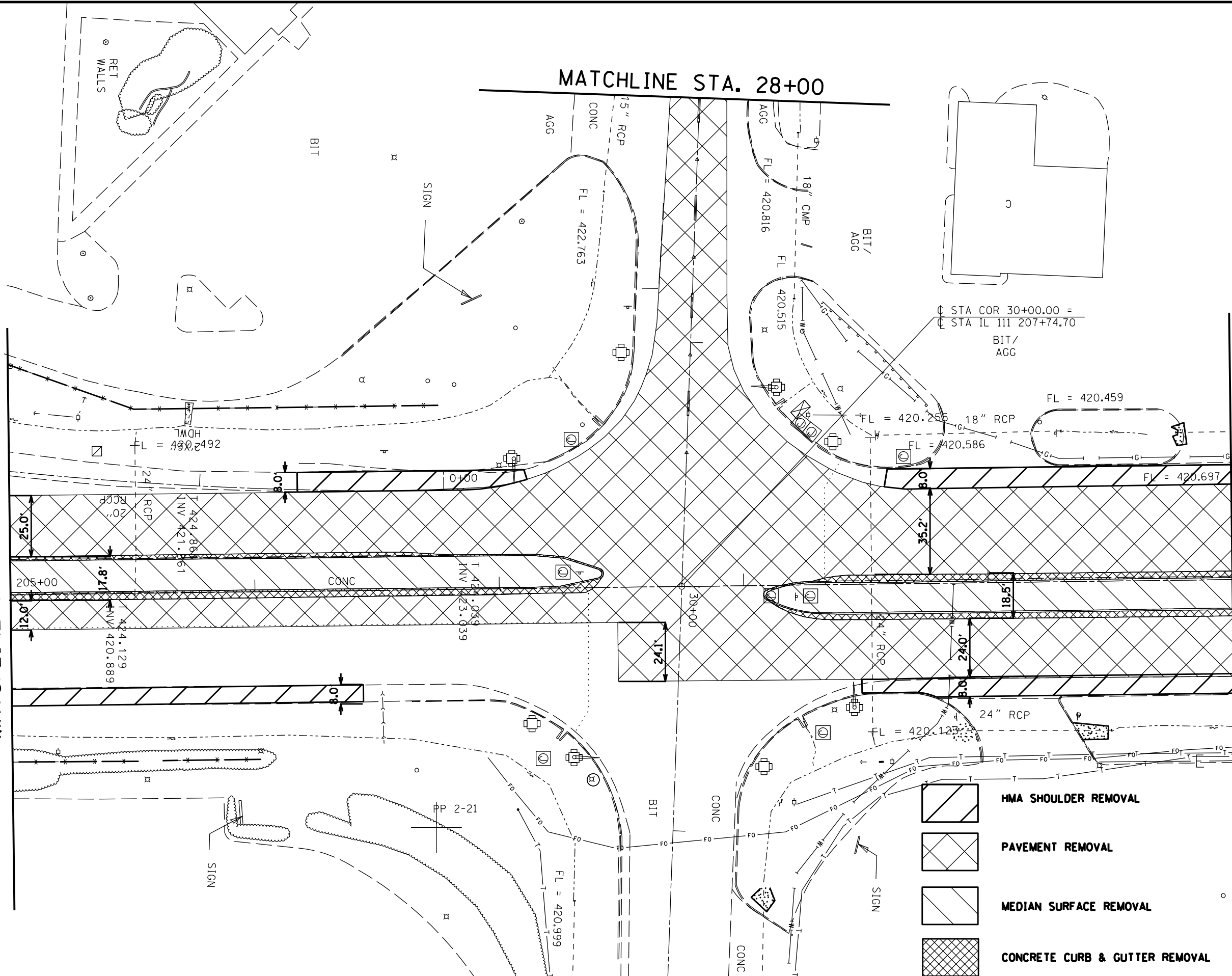

ROCK





STA COR 30+00.00 =
 STA IL 111 207+74.70
 BIT/
 AGG

FL = 420.459
 18" RCP
 FL = 420.255
 FL = 420.586

TMQH
 FL = 420.2492

24" RCP
 INV 424.886
 INV 421.861
 CONC
 T 424.039
 INV 423.039
 T 424.129
 INV 420.889

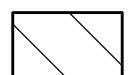
FL = 420.697
 35.2'
 24" RCP
 24'0"
 18.5'
 24" RCP
 FL = 420.123

-  HMA SHOULDER REMOVAL
-  PAVEMENT REMOVAL
-  MEDIAN SURFACE REMOVAL
-  CONCRETE CURB & GUTTER REMOVAL

FAP 582/FAU 9079

FILE NAME = *FILEL*	USER NAME = *USER*	DESIGNED -	REVISED -	STATE OF ILLINOIS DEPARTMENT OF TRANSPORTATION	REMOVAL SHEETS				F.A.P. RTE.	SECTION	COUNTY	TOTAL SHEETS	SHEET NO.
MODELNAME	PLOT SCALE = *SCALE*	DRAWN -	REVISED -		SCALE:	SHEET	OF	SHEETS	STA.	TO STA.	MADISON	73	20
	PLOT DATE = *DATE*	CHECKED -	REVISED -								CONTRACT NO. 76F41		
		DATE -	REVISED -								ILLINOIS FED. AID PROJECT		