

FAP 793 (US 40)

MS 0.0
FAP 793
LAT. 38.71756389
LONG. -89.91390643

MS 10.4
FAP 793
LAT. 38.73185021
LONG. -89.72221138

MS 9.45
FAP 692
LAT. 38.88851382
LONG. -89.66959919

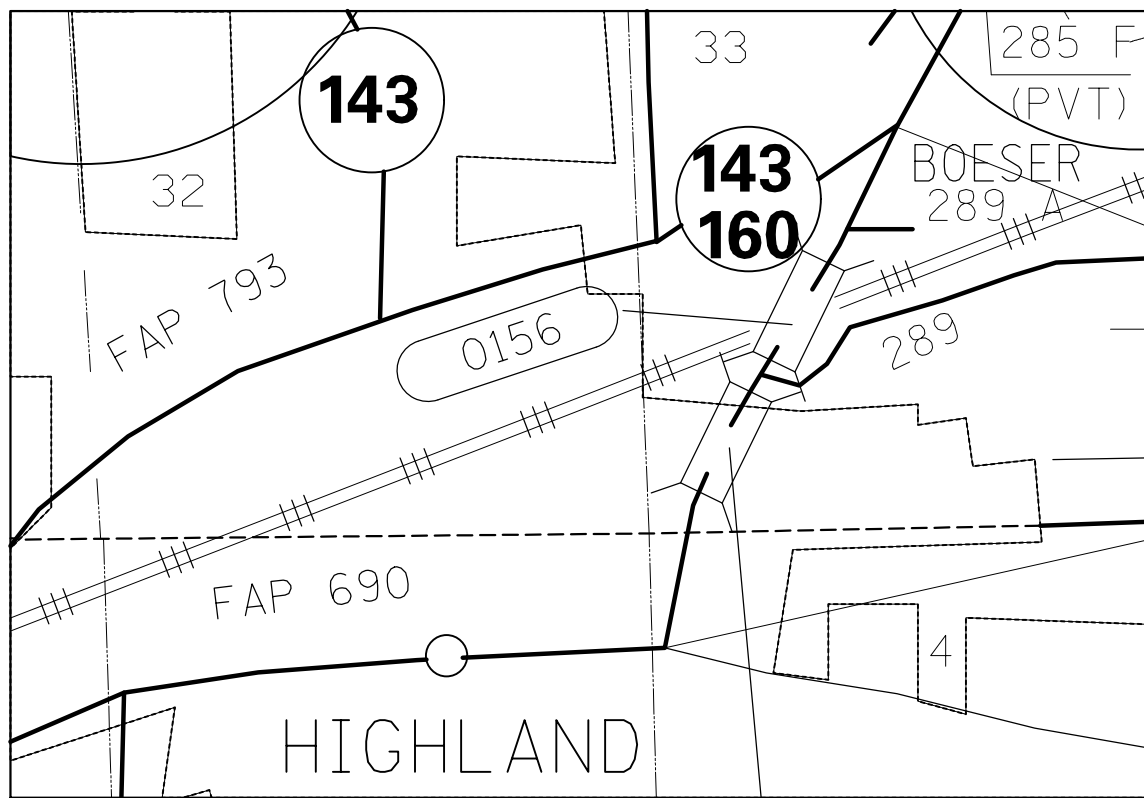

FAP 690 (IL 160)

MS 0.9
FAP 690
LAT. 38.75356738
LONG. -89.66358682

MS 0.0
FAP 690
LAT. 38.73995518
LONG. -89.67147333

MS 0.0
FAP 692
LAT. 38.75054063
LONG. -89.6717715

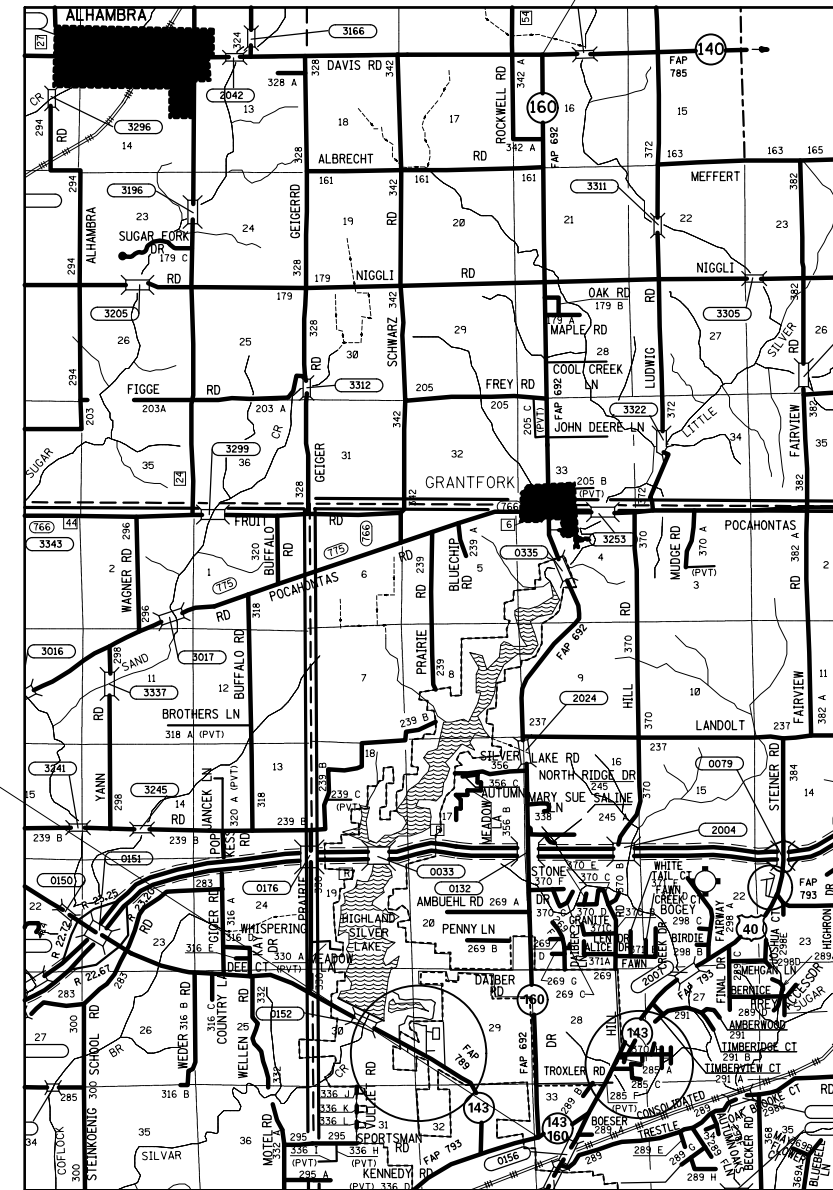

FAP 692 (IL 160)

FILE NAME =	USER NAME = nivesa	DESIGNED - GEL	REVISED -
et:\pw\work\p\dot\nivesa\d0388125\d876h21-sh-t-plan.dgn		DRAWN - LAC	REVISED -
	PLOT SCALE = 100.0000' / in.	CHECKED - MDP	REVISED -
	PLOT DATE = 4/11/2014	DATE - 3/20/2012	REVISED -

STATE OF ILLINOIS
DEPARTMENT OF TRANSPORTATION

SCALE:		SHEET NO. OF SHEETS		STA. TO STA.	

LOCATION MAP

• FAP 793/690/692		F.A.P. R.T.E.	SECTION	COUNTY	TOTAL SHEETS	SHEET NO.
		(31,37,32,39,S-1,12,45,86)I-1		MADISON	12	4
				CONTRACT NO. 76H21		
		ILLINOIS FED. AID PROJECT				