

B.M.: R.R. Spike in Power Pole 25' Rt. Sta. 867+35  
 Elev. 423.27.  
 Existing structure N1035-0006, built as S.B.I.  
 Rt. 34, Sec. 3B in 1924, 2 spans R.C. abut on R.  
 C. closed abutments & pier. The contractor  
 shall remove the existing superstructure in  
 stages and provide a new superstructure  
 with 24" W Flange Beams. Repair and rebuild  
 the pier & abutments as required. One way  
 traffic shall be maintained at all times  
 using stage construction.  
 No salvage.

STATE OF ILLINOIS  
 DEPARTMENT OF TRANSPORTATION

035-0006

DATE	BY	CHKD	APP'D
10/23/14	J.M.	J.M.	J.M.

GENERAL NOTES

Revisions shall be kept through hole. Date 8/2/14. Item 1/2. Issue 1/2.

Construction grade of Structure Slab = 17360 Lbs.

All structural steel shall be AASHTO M-222 superior metal minimum yield strength and attached bars shall be AASHTO M-183 and shall conform with the grade of bars used other otherwise noted.

Plans showing of construction dimensions will not be permitted to the bottom flange of beams or girders nor to the top flange for a distance equal to one-half the beam length past any pier supports. Plans showing other areas will be permitted only when approved by the Engineer.

Reinforcing bars shall be set before concrete placement over supports. It shall be the responsibility of the Contractor to verify all dimensions and conditions existing in the field prior to construction and starting of materials.

Expansion joints shall consist of self-aligning expansion sections and 1/2" x 1/2" hooked bars.

Bearing steel surfaces shall be compressed or adjusted to the designated elevations within a tolerance of 1/8 inch. Adjustment shall be made either by grinding the surface or by shimming the bearing. Two 1/2" x 1/2" x 1/2" steel plates, of the dimensions of the bottom bearing plate, shall be provided for each bearing in addition to all other plates or shims.

The main load carrying member components subject to tensile stress shall conform to the Supplemental Requirements for Hot Rolled Steel Grade 50. Components are the tension flanges, webs and all brace plate material in the steel girders or web flange beams.

Protective coat shall be applied to deck surface, inside faces and top faces of curb.

Reinforcement bars shall conform to the requirements of AASHTO M-31 Grade 60.

TOTAL BILL OF MATERIALS

Item	Unit	Super	Sub	Total
Removal of Existing Superstructure	Each	1		1
Class X Concrete	Cu Yds	457	431	888
Reinforcement Bars	Lbs	5960	3980	9940
Reinforcement Bars (Epoxy Coated)	Lbs	10200		10200
Structural Steel	L.S.			28
Protective Coat	Sq. Yds	201		201
Temporary Guardrail	Lin. Ft.	55		55
Concrete Removal	Cu Yds		222	222
Expansion Bolts 1/2" x 9"	Each		33	33
Steel Railing T x T	Lin. Ft.	110		110
Name Plate	Each	1		1

Note: Adequate struts shall be placed at the abutments before existing superstructure is removed and shall remain in place until new superstructure has been erected to prevent damage to abutments from unrestrained earth pressure. Cost incidental.

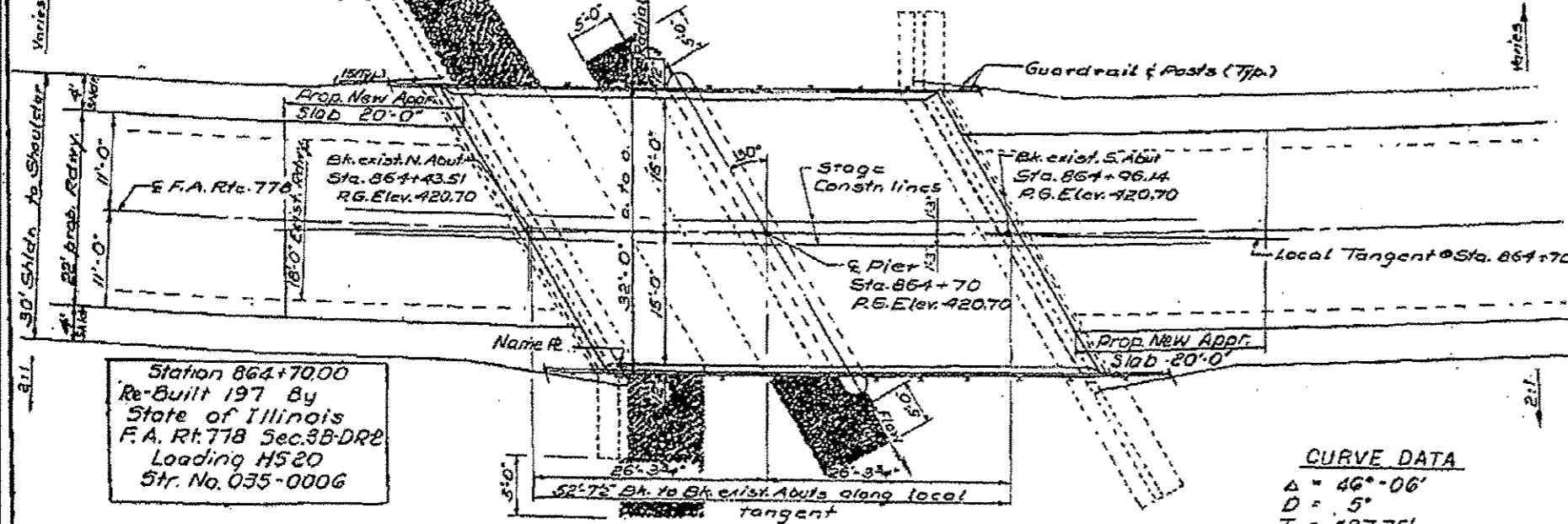
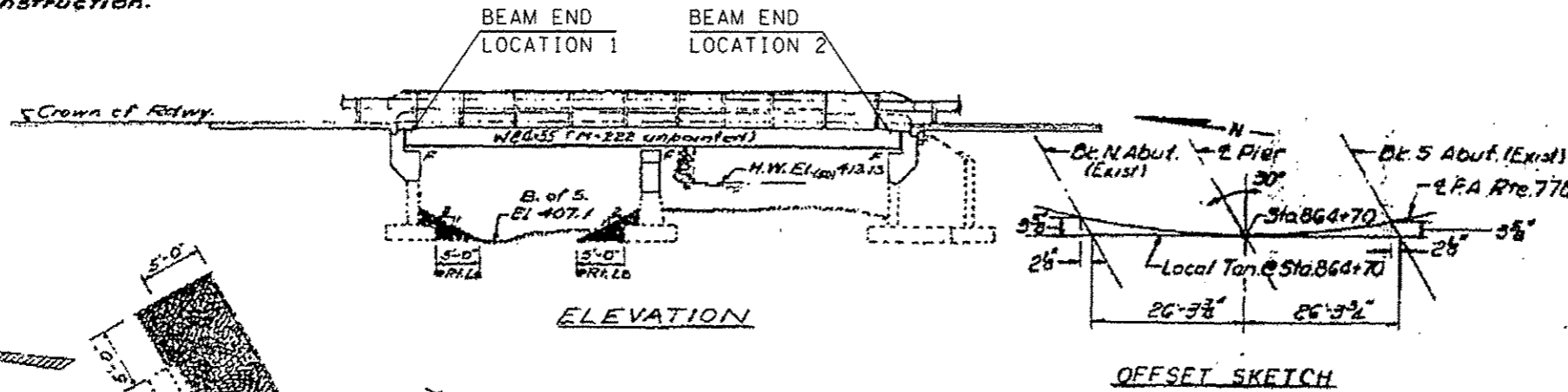

CURVE DATA

$\Delta = 46^{\circ}06'$   
 $D = 5'$   
 $T = 487.75'$   
 $L = 922'$   
 $R = 1146.28'$   
 $E = 99.42'$   
 Prop. S.E. = 0.08 ft/ft  
 Attain S.E. Sta. 862+15 to Sta. 864+31  
 Trans. from .08 to Exist. S.E. - Sta. 866+25 to Sta. 867+25

DESIGN STRESSES

$f_c = 3,500$  psi.  
 $f_y = 60,000$  psi. (Reinf.)  
 $f_y = 50,000$  psi. (Struct.) M-222 Gr. 50  
 $f_y = 36,000$  psi. M-183  
 Loading H-520-44  
 Allow 25 #/ft for Future W.S.  
 Design Specifications: 1973 AASHTO, 1974, 1975, 1976 and 1977 Interim Specifications.  
 \*\* Epoxy Coated Reinf. Bars shall be used in the top layer of the slab.

WATERWAY INFORMATION

Drainage Area 148 Sq. Miles  
 Existing Opening 169 Sq. Ft.  
 Required Opening 169 Sq. Ft.  
 Proposed Opening (allow 50% H.W.E.) 169 Sq. Ft.

H.W.E. (50) = 413.13'  
 $Q_{(50)} = 1090$  cfs  
 Created Head - Negligible  
 H.W.E. (100) = 413.5'  
 $Q_{(100)} = 1260$  cfs  
 Created Head - Negligible

PROP. GRADE PROFILE F.A. RTE. 778

DESIGNED: [Signature]	DATE: Feb 23 1975
CHECKED: P.L.S. [Signature]	DESIGNED: [Signature]
DRAWN: Mercado V.H.	CHECKED: [Signature]
CHECKED: [Signature]	APPROVED: [Signature]

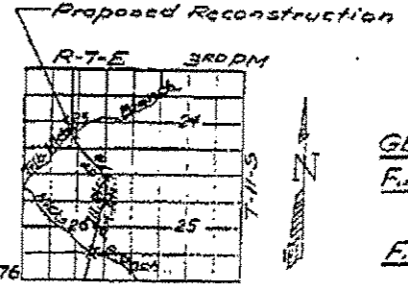

GENERAL PLAN & ELEVATION  
 F.A. RTE. 778 OVER TRIB. HICKS  
 BRANCH  
 F.A. RTE. 778 SEC. 3B-DR-2  
 HARDIN COUNTY  
 STA. 864+70.00

LOCATION SKETCH  
 FOR INFORMATION ONLY

FILE NAME: c:\pwwork\pvidot\dahmer_jd\8382426\78418-1\1.plandgn	USER NAME: Dahmer_jd	DESIGNED: [Signature]	REVISED: [Signature]	STATE OF ILLINOIS DEPARTMENT OF TRANSPORTATION	035-0006	IL 34 OVER HICKS BRANCH	F.A. RTE. SECTION COUNTY TOTAL SHEETS SHEET NO. VAR. 09 BRIDGE PAINT 2014-1 * 13 6 CONTRACT NO. 78418
Default	PLOT SCALE: 2.8017' / 1" in.	CHECKED: [Signature]	REVISED: [Signature]	SCALE: SHEET OF SHEETS STA. TO STA.			(ILLINOIS) FED. AID PROJECT

NEW SHEET 6-3-14