

**CE032**

REVISIONS

NUMBER	BY	DATE

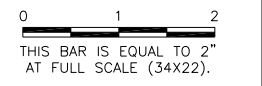

CRITICAL POINT TABLE			
POINT	LATITUDE	LONGITUDE	ELEVATION
1	N38° 30' 28.12"	W89° 05' 29.00"	530'
2	N38° 30' 28.14"	W89° 05' 31.75"	531'
3	N38° 30' 37.81"	W89° 05' 31.61"	526'
4	N38° 30' 37.82"	W89° 05' 32.71"	526'
5	N38° 30' 38.85"	W89° 05' 32.69"	526'
6	N38° 30' 38.84"	W89° 05' 31.59"	526'
7	N38° 30' 53.86"	W89° 05' 31.37"	522'
8	N38° 30' 53.97"	W89° 05' 28.62"	522'
9	N38° 30' 56.84"	W89° 05' 28.58"	520'
10	N38° 30' 56.73"	W89° 05' 31.33"	520'
11	N38° 31' 01.83"	W89° 05' 31.26"	519'
12	N38° 31' 01.86"	W89° 05' 34.83"	518'
13	N38° 31' 03.62"	W89° 05' 34.81"	518'
14	N38° 31' 03.59"	W89° 05' 31.23"	519'
15	N38° 31' 19.01"	W89° 05' 31.01"	518'
16	N38° 31' 18.98"	W89° 05' 28.26"	518'
17	N38° 31' 10.88"	W89° 05' 28.38"	518'
18	N38° 31' 10.87"	W89° 05' 27.37"	518'
19	N38° 31' 09.99"	W89° 05' 27.38"	518'
20	N38° 31' 09.99"	W89° 05' 28.39"	518'

**LEGEND**

- BARRICADES IDOT TYPE 1 WITH RED LIGHTS AND 20"x 20" ORANGE FLAGS AT 15' SPACING
- RUNWAY OBJECT FREE ZONE
- TAXIWAY OBJECT FREE AREA
- SITework AREAS
- CONTRACTOR ACCESS
- RUNWAY CLOSURE MARKER

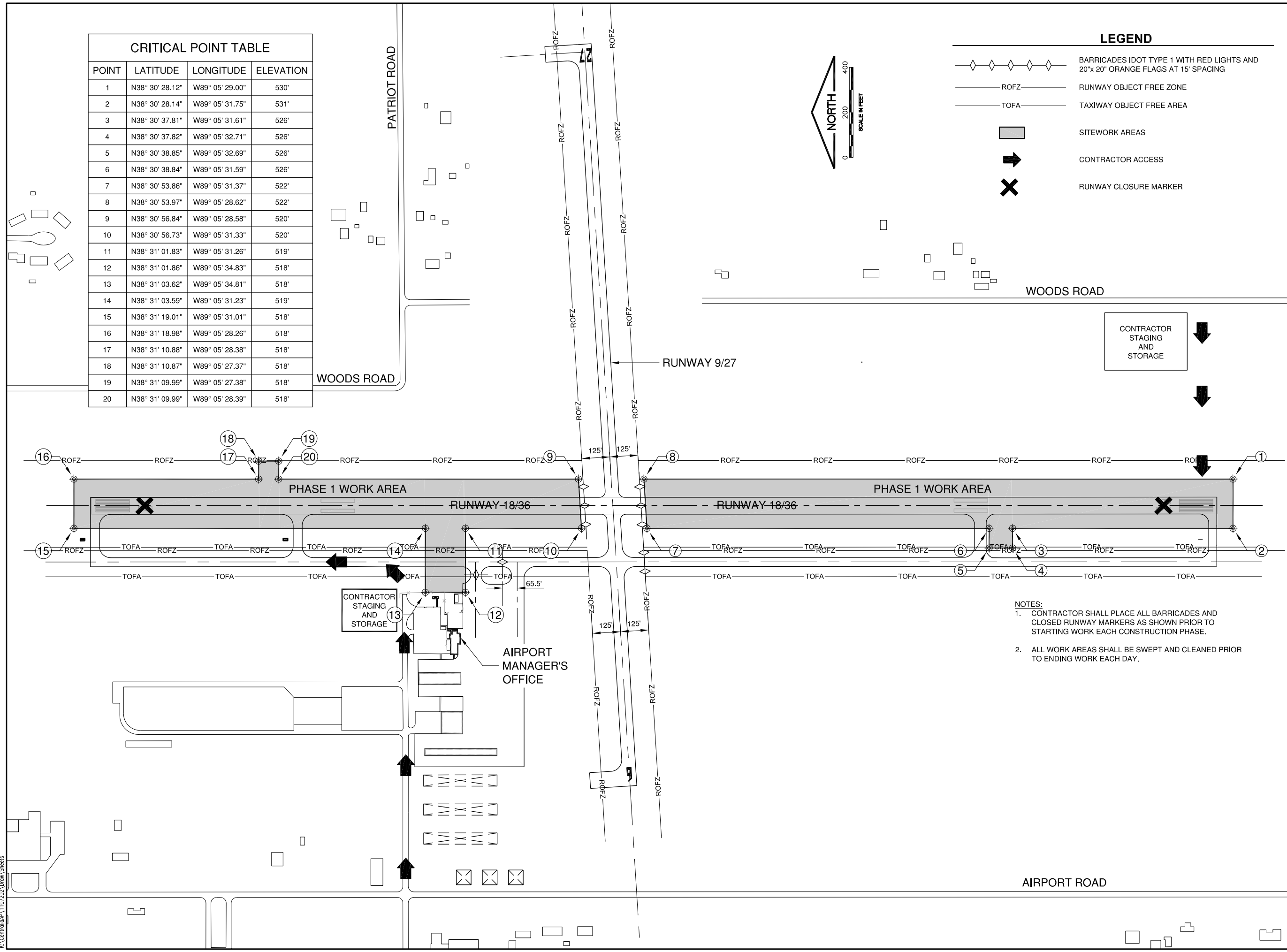
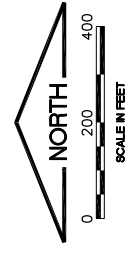

- NOTES:**
- CONTRACTOR SHALL PLACE ALL BARRICADES AND CLOSED RUNWAY MARKERS AS SHOWN PRIOR TO STARTING WORK EACH CONSTRUCTION PHASE.
  - ALL WORK AREAS SHALL BE SWEEPED AND CLEANED PRIOR TO ENDING WORK EACH DAY.

**CITY OF CENTRALIA, ILLINOIS**  
**CENTRALIA MUNICIPAL AIRPORT**  
**CENTRALIA, ILLINOIS**  
**CONSTRUCT NEW ELECTRICAL VAULT; REHABILITATE**  
**MIRLS, PAPI & REILS ON RUNWAY 18/36**  
**CONSTRUCTION ACTIVITY PLAN 1**

© Copyright CMT, Inc.  
  
**CMT**  
 CRAWFORD, MURPHY & TILLY, INC.  
 CONSULTING ENGINEERS  
 License No. 184-000613

DESIGN BY:	KLB
DRAWN BY:	ADD, DPA
CHECKED BY:	KLB
APPROVED BY:	RLV
DATE:	MAY 2, 2014
JOB No:	11072-02
IL. PROJ. NO. ENL-4230 PROJ. NO. 3-17-SBGP-XX	
SHEET 03 OF 30 SHEETS	

K:\Centralia\1107202\Draws\Sheets