

CE032

REVISIONS		
NUMBER	BY	DATE

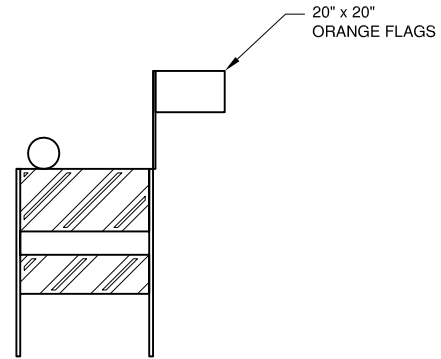
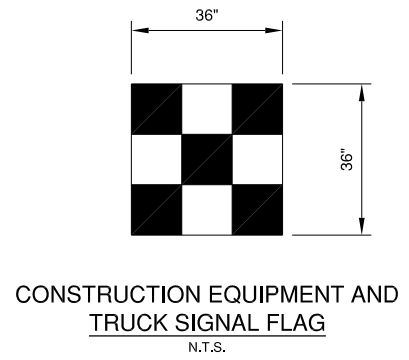
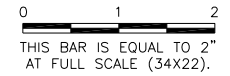

FLASHER BARRICADE NOTES

1. FLASHERS TO BE BATTERY OPERATED. LENS TO BE RED AND BE ABLE TO ROTATE 90 DEGREES.
2. SANDBAGS TO BE PLACED ON EACH SUPPORT BRACE AS REQUIRED TO PREVENT DISPLACEMENT BY WIND, JET OR PROP BLAST.
3. NO SEPARATE PAYMENT WILL BE MADE FOR THIS ITEM. COSTS SHALL BE CONSIDERED INCIDENTAL TO THE PROJECT.
4. PLACE AT 15' INTERVALS.

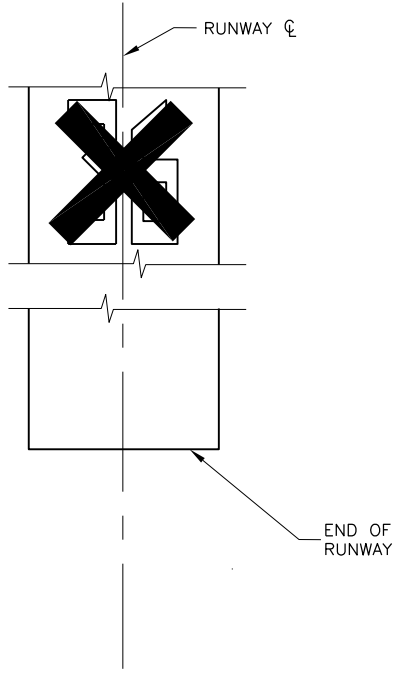

NOTES

1. MARKERS SHALL BE SOLID YELLOW.
2. MARKERS SHALL BE PAINTED BURLAP, PLYWOOD OR OTHER APPROVED SOLID MATERIALS.
3. CONTRACTOR SHALL MAINTAIN MARKERS.
4. COST OF FURNISHING, INSTALLING, MAINTAINING, RELOCATING AND REMOVING MARKERS SHALL BE INCIDENTAL TO THE CONTRACT.
5. MARKERS SHALL BE PLACED OVER EXISTING RUNWAY NUMERALS.

SECURITY NOTES

1. MAINTAINING THE SECURITY REQUIREMENTS OF THE AIRPORT SHALL BE A PRIMARY CONCERN FOR THE CONTRACTOR.
2. THE CONTRACTOR WILL BE RESPONSIBLE FOR MAINTAINING AIRPORT SECURITY BY SUPERVISING OPENINGS OR MAINTAINING THE AIRPORT PERIMETER FENCE LINE AT ALL TIMES DURING THE COURSE OF THE WORK.
3. FINES CAN BE LEVIED AGAINST THE CONTRACTOR BY THE TRANSPORTATION SECURITY ADMINISTRATION (TSA) FOR NEGLIGENCE IF THE AIRPORT SECURITY IS COMPROMISED AND THE AIRPORT PERIMETER FENCE LINE IS NOT MAINTAINED AS SPECIFIED ABOVE. FINES CAN ALSO BE LEVIED AGAINST THE CONTRACTOR FOR FAILURE TO COOPERATE WITH THE AIRPORT MANAGEMENT AS REQUIRED TO MAINTAIN AIRPORT SECURITY.

CONSTRUCTION ACTIVITY GENERAL NOTES

1. CONSTRUCTION PHASING IS OF CRITICAL IMPORTANCE TO THE AIRPORT FOR THIS PROJECT.
2. THE CONTRACTOR SHALL PLAN AND CONDUCT HIS WORK SO AS TO NOT INTERFERE OR HINDER THE PROGRESS OR WORK BEING PERFORMED BY OTHER CONTRACTORS.
3. THE TIMELY PROSECUTION OF THE OVERALL PROJECT IS DEPENDENT UPON THE PROPER COORDINATION BETWEEN CONTRACTORS.
4. IT SHALL BE FULLY UNDERSTOOD BY THE CONTRACTOR THAT THE PROSECUTION OF THE OVERALL PROJECT ARE THE GOVERNING CRITERIA FOR RESOLVING CONFLICTS WHICH MAY ARISE BETWEEN HIS SCHEDULE AND THE SCHEDULE OF OTHER CONTRACTORS.
5. WHEN CONFLICTS ARISE, RESOLUTION OF SUCH CONFLICTS WILL BE MADE BY THE AIRPORT THROUGH THE RESIDENT ENGINEER IN THE BEST INTEREST OF THE AIRPORT.
6. DELAYS, CHANGES IN SCHEDULING, OR THE EXPEDITION OF WORK UNDER THIS CONTRACT TO PROVIDE FOR THE TIMELY PROSECUTION OF THE PROJECT WILL BE CONSIDERED INCIDENTAL TO THE CONTRACT AND NO ADDITIONAL COMPENSATION WILL BE ALLOWED.
7. CONTRACTOR'S STAGING, STORAGE, AND PARKING WILL BE AS SHOWN ON THE CONSTRUCTION ACTIVITY PLANS.
8. THE CONTRACTOR SHALL PLACE ALL BARRICADES AND EROSION CONTROL ITEMS AS SHOWN IN THE PLANS PRIOR TO INITIATING WORK IN EACH PHASE. ALL COSTS TO FURNISH, INSTALL, AND MAINTAIN THESE ITEMS SHALL BE CONSIDERED INCIDENTAL TO THE PROJECT.
9. CONSTRUCTION RELATED ITEMS REQUIRING THE CLOSURE OF RUNWAYS AND TAXIWAYS SHALL REQUIRE CLOSE COORDINATION WITH THE AIRPORT. NO EXTENSION TO CONTRACT TIME WILL BE GIVEN FOR DELAYS CAUSED BY LACK OF ADEQUATE COORDINATION. THE AIRPORT SHALL REQUIRE 72 HOURS NOTIFICATION PRIOR TO THE CLOSURE OF RUNWAYS.
10. CONSTRUCTION BARRICADES SHALL BE SET AT THE LIMITS OF THE WORK AREA OF EACH PHASE. OFFSETTING BARRICADES TO ANY LOCATION DIFFERENT THAN SHOWN IN THE PLANS WILL COORDINATED WITH THE AIRPORT IN ADVANCE. IN THE EVENT OF A CONFLICT BETWEEN CONSTRUCTION OPERATIONS AND TAXIING AIRCRAFT, THE CONTRACTOR SHALL CEASE OPERATIONS AND RETURN THE BARRICADES TO THE EDGE OF THE WORKING LIMITS. ALL BARRICADES SHALL BE REMOVED AT THE END OF EACH CONSTRUCTION PHASE.

CITY OF CENTRALIA, ILLINOIS
CENTRALIA MUNICIPAL AIRPORT
CENTRALIA, ILLINOIS
CONSTRUCT NEW ELECTRICAL VAULT; REHABILITATE
MIRLS, PAPI & REILS ON RUNWAY 18/36
CONSTRUCTION ACTIVITY PLAN NOTES AND DETAILS

© Copyright CMT, Inc.
CMT
 CRAWFORD, MURPHY & TILLY, INC.
 CONSULTING ENGINEERS
 License No. 184-000613

DESIGN BY:	KLB
DRAWN BY:	ADD, DPA
CHECKED BY:	KLB
APPROVED BY:	RLV
DATE:	MAY 2, 2014
JOB No:	11072-02
IL PROJ. NO. ENL-4230 PROJ. NO. 3-17-SBGP-XX	
SHEET 07 OF 30 SHEETS	