

CONSTRUCTION PLANS

REHABILITATE TAXIWAYS B & E

MOUNT VERNON AIRPORT AUTHORITY
MOUNT VERNON AIRPORT (MVN)
MOUNT VERNON, JEFFERSON COUNTY, ILLINOIS

SBG PROJECT NO. 3-17-0074-B28
IDA PROJECT NO. MVN-4326

VICINITY MAP

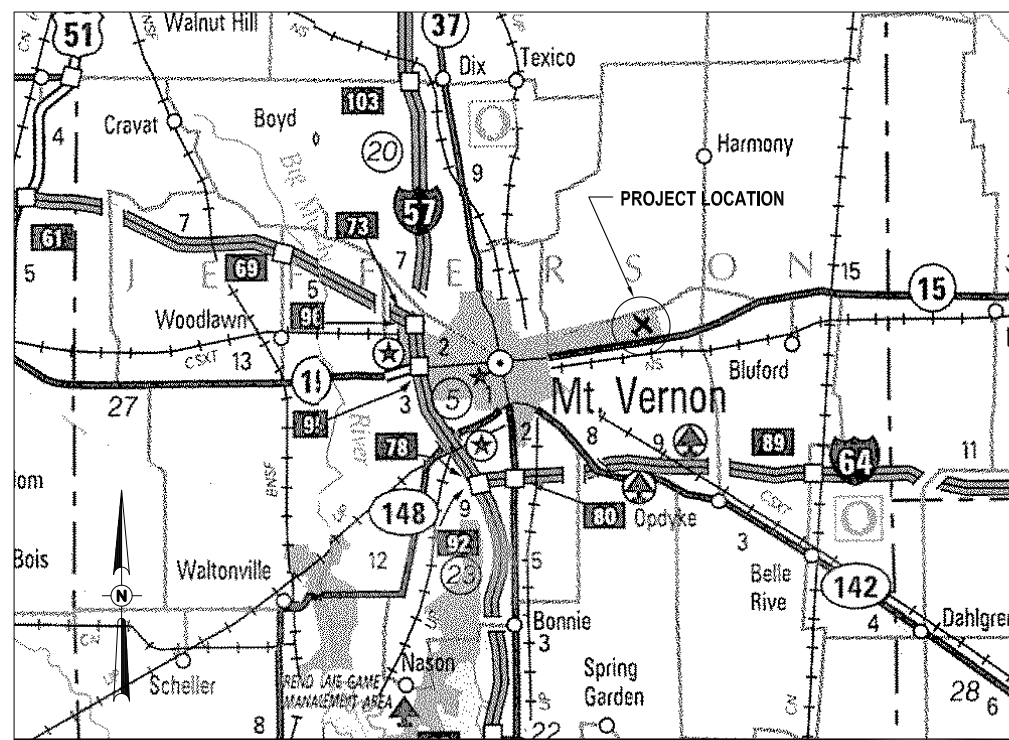

LOCATION MAP

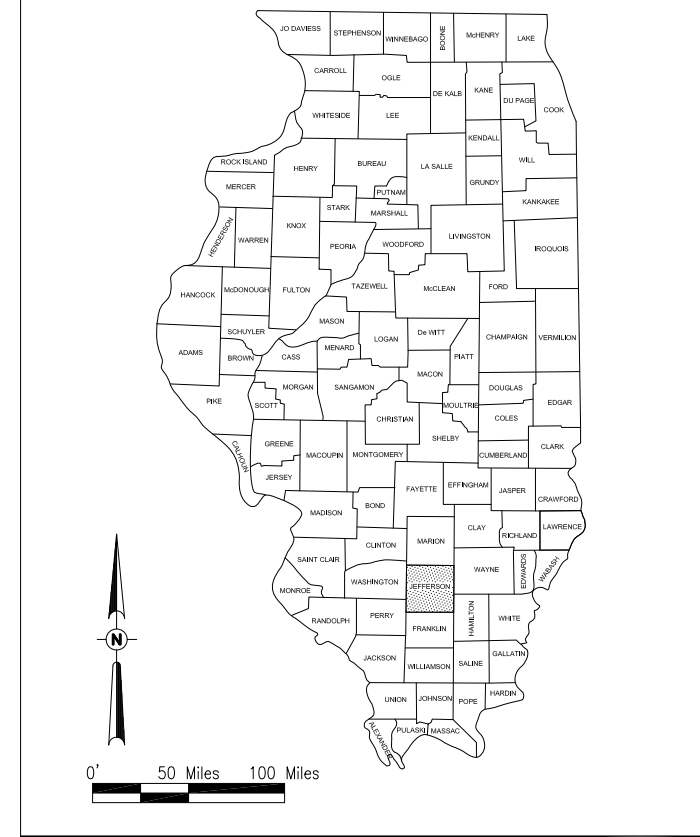

NOTICE TO CONTRACTORS AND BIDDERS

THESE CONSTRUCTION PLANS RELY UPON THE SPECIAL PROVISIONS AND THE SPECIFICATIONS TO PROVIDE FOR A COMPLETE DESCRIPTION OF THE WORK AND CONSTRUCTION REQUIREMENTS. THE PLANS SHALL ONLY BE USED IN COMBINATION WITH ALL CONTRACT DOCUMENTS.

No.	Issue/Description	Sheets Changed	Date	By

Seal Date of Plans

Barry S. Stolz, P.E.
Project Engineer

[Signature] 5/9/2014 Date

HANSON
HANSON PROFESSIONAL SERVICES INC.
1525 S 6th St.
Springfield, Illinois 62568
Telephone: 217-788-2450
Fax: 217-788-2503

[Signature] 5/8/14 Date

Robert A. Waller, P.E.
Project Manager

MVA Mt. Vernon Airport
MOUNT VERNON AIRPORT AUTHORITY
100 Aviation Drive
Mt. Vernon, IL 62864
Telephone: 618.242.7016

[Signature] 5/8/2014 Date

Chris Collins
Airport Manager

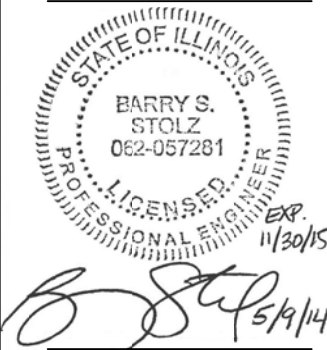

SUMMARY OF QUANTITIES				
ITEM NO.	DESCRIPTION	UNIT	TOTAL QUANTITIES	AS BUILT QUANTITIES
AR150510	ENGINEER'S FIELD OFFICE	LS	1	
AR150520	MOBILIZATION	LS	1	
AR150540	HAUL ROUTE	LS	1	
AR162620	CLASS E GATE - 20'	EA	1	
AR401613	BIT. SURF. CSE. - METHOD I, SUPERPAVE	TON	863	
AR401650	BITUMINOUS PAVEMENT MILLING	SY	9,551	
AR403613	BIT. BASE CSE. - METHOD I, SUPERPAVE	TON	1,100	
AR603510	BITUMINOUS TACK COAT	GAL	1,911	
AR620520	PAVEMENT MARKING - WATERBORNE	SF	2,050	
AR620525	PAVEMENT MARKING - BLACK BORDER	SF	1,880	
AR800454	8" HDPE PIPE	LF	90	

SHEET LIST	
SHEET NO.	SHEET TITLE
1	COVER SHEET
2	SUMMARY OF QUANTITIES AND INDEX TO SHEETS
3	SCOPE OF WORK
4	SAFETY AND PHASING PLAN-WORK AREA 1 TAXIWAY B
5	SAFETY AND PHASING PLAN-WORK AREA 2 TAXIWAY E
6	CONSTRUCTION SAFETY AND PHASING DETAILS AND NOTES
7	PROPOSED TYPICAL SECTIONS
8	PROPOSED CONSTRUCTION PLANS
9	PROPOSED CONSTRUCTION PLANS - ACCESS ROADS
10	PROPOSED PLAN AND PROFILE-TWY B
11	PROPOSED PLAN AND PROFILE-TWY E
12	PROPOSED PAVEMENT MARKING PLANS
13	MISCELLANEOUS DETAILS AND NOTES

REHABILITATE
TAXIWAYS B & E

IDA No: MVN-4326

Contract No. MV060

NO.	DATE	DESCRIPTION		
		LAY	DWN	REV

ISSUE: MAY 9, 2014
PROJECT NO: 13A0077D
CAD FILE: G-002FLP.DWG
LAYOUT BY: JRH 03/19/2014
DRAWN BY: JRH 03/19/2014
REVIEWED BY: JSL 04/21/2014

© Copyright Hanson Professional Services Inc. 2013
SHEET TITLE

SUMMARY OF
QUANTITIES AND
INDEX TO SHEETS

UTILITY NOTE

THE LOCATION, SIZE, AND TYPE OF MATERIAL OF EXISTING UNDERGROUND AND/OR ABOVEGROUND UTILITIES INDICATED ON THE PLANS ARE NOT REPRESENTED AS BEING ACCURATE, SUFFICIENT OR COMPLETE. NEITHER THE OWNER NOR THE ENGINEER ASSUMES ANY RESPONSIBILITY...

J.U.L.I.E. INFORMATION

COUNTY JEFFERSON
CITY MT. VERNON
TOWNSHIP MT. VERNON
SECTION NO. 22, 23, 26 & 27
ADDRESS MT. VERNON AIRPORT AUTHORITY
R.R. #4
MT. VERNON, ILLINOIS 62864

LEGEND

- EXISTING IMPROVEMENTS
EXISTING BUILDINGS
PROPOSED IMPROVEMENTS

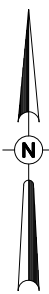

0' 200' 400' 800'
HALF SIZE SCALE: 1" = 800'
FULL SIZE SCALE: 1" = 400'

CONTROL POINT DATA

Table with 5 columns: NO., DESCRIPTION, NORTHING, EASTING, ELEV. Includes data for NGS MONUMENT and BRASS DISC STAMPED.

CRITICAL POINTS

Table with 6 columns: DESCRIPTION, LATITUDE, LONGITUDE, GROUND ELEVATION, EQUIP. HEIGHT, EQUIP. ELEV. Includes data for CP#1 through CP#7.

GENERAL NOTES

- 1. THE SCOPE OF WORK SHEET IS INTENDED ONLY AS A GENERAL DESCRIPTION OF WORK ITEMS AND THEIR APPROXIMATE LOCATIONS AND LIMITS...
2. WORK FOR THIS PROJECT SHALL CONSIST OF, BUT IS NOT LIMITED TO, REHABILITATION OF TWO TAXIWAYS...
3. THE CONTRACTOR SHALL FURNISH ALL LABOR, MATERIAL, EQUIPMENT, AND TRANSPORTATION NECESSARY TO CONSTRUCT ALL ELEMENTS OF THE PROJECT...
4. THE RULES, REGULATIONS, AND SPECIFICATIONS ENUMERATED HEREIN SHALL BE CONSIDERED AS MINIMUM REQUIREMENTS...
5. THE CONSTRUCTION ENTRANCE AS SHOWN ON THE SCOPE OF WORK AND/OR SAFETY PHASING PLAN ARE ONLY TO BE USED FOR THE PROJECT...
6. IT SHALL BE THE RESPONSIBILITY OF THE CONTRACTOR TO PROTECT, PRESERVE AND REPAIR THE EXISTING AIRFIELD AND ROADWAY PAVEMENTS AT ALL TIMES...
7. NO EQUIPMENT SHALL BE PERMITTED TO CROSS OR USE ANY EXISTING PAVEMENT OUTSIDE THE CONSTRUCTION LIMITS...
8. CONTRACTOR IS REQUIRED TO PROVIDE THEIR OWN RESTROOM FACILITIES...
9. UNLESS OTHERWISE NOTED, ALL DISTURBED AREAS OUTSIDE OF THE PROPOSED CONSTRUCTION LIMITS SHALL BE GRADED, SEEDED AND/OR HYDROMULCH SEEDED AT NO ADDITIONAL COST TO THE CONTRACT...
10. ALL WASTE MATERIAL SHALL BE HAULED FROM THE AIRPORT AND PROPERLY DISPOSED OF UNLESS OTHERWISE SPECIFIED HEREIN...
11. THE CONTRACTOR SHALL BE RESPONSIBLE FOR OBTAINING PERMITS FOR HAULING ON PUBLIC ROADS, AS APPLICABLE...
12. THE OWNER SHALL HAVE THE RIGHT OF FIRST REFUSAL FOR ALL SALVAGEABLE MATERIAL REMOVED ON THE PROJECT...
13. THE CONTRACTOR SHALL PROVIDE ONE SET OF REDLINED AS-BUILT DRAWINGS TO THE RESIDENT ENGINEER AT THE COMPLETION OF THE PROJECT...
14. CONTRACTOR SHALL NOTE THAT ALL AREAS WITHIN THE AIRPORT PROPERTY LINE AND OUTSIDE THE CONSTRUCTION LIMITS MAY BE USED FOR AGRICULTURAL PURPOSES...
15. CONTRACTOR SHALL RESTORE TO ORIGINAL CONDITION ALL GRASS, STONE, OR PAVEMENT DISTURBED BY CONTRACTOR'S CONSTRUCTION OPERATIONS...
16. THE PROJECT PAY ITEMS ARE INTENDED TO BE INCLUSIVE OF ALL WORK TO BE PERFORMED AS SHOWN IN THESE PLANS...
17. APPROXIMATE LOCATIONS OF UNDERGROUND UTILITIES ARE SHOWN THROUGHOUT THESE PLANS...
18. THE CONTRACTOR MUST AT ALL TIMES MAINTAIN PROPER DRAINAGE FOR ALL AREAS AFFECTED BY HIS WORK.

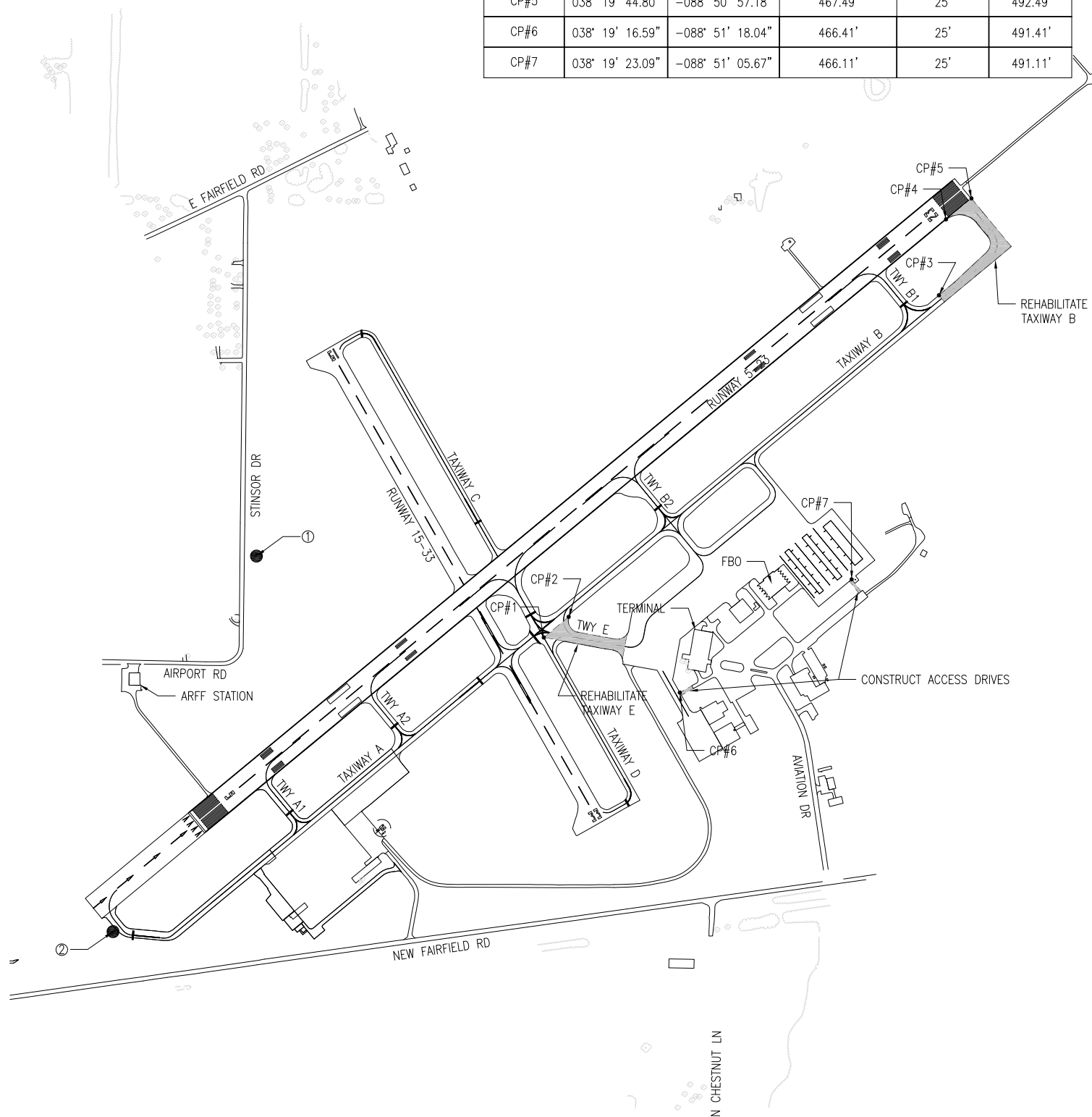

Offices Nationwide
www.hanson-inc.com

Hanson Professional Services Inc.
1525 S. 6th Street
Springfield, IL 62703
phone: 217-788-2450
fax: 217-788-2503

Illinois Licensed
Professional Service Corporation
#184-001084

MT. VERNON AIRPORT



100 Aviation Dr
Mt. Vernon, IL 62864



Handwritten signature of Barry S. Stolz dated 5/19/14

REHABILITATE TAXIWAYS B & E

IDA No: MVN-4326

Contract No. MV060

Empty table with 4 columns: NO., DATE, LAY, DWN, REV

ISSUE: MAY 9, 2014

PROJECT NO: 13A0077D
CAD FILE: G-003-SOW.DWG
LAYOUT BY: JRH 03/19/2014
DRAWN BY: JRH 03/19/2014
REVIEWED BY: JSL 04/21/2014

Copyright Hanson Professional Services Inc. 2013
SHEET TITLE

SCOPE OF WORK



REHABILITATE TAXIWAYS B & E

IDA No: MVN-4326

Contract No. MV060

NO.	DATE	DESCRIPTION

NO.	DATE	DESCRIPTION

ISSUE: MAY 9, 2014
PROJECT NO: 13A0077D
CAD FILE: C-004-SFY.DWG
LAYOUT BY: JRH 03/19/2014
DRAWN BY: JRH 03/19/2014
REVIEWED BY: JSL 04/21/2014
© Copyright Hanson Professional Services Inc. 2013
SHEET TITLE

SAFETY AND PHASING PLAN-WORK AREA 1 TAXIWAY "B"

MAY 12, 2014 4:41 PM STOLZ.DWG
p:\13A0077D\CAD\Drawings\SheetC-004-SFY

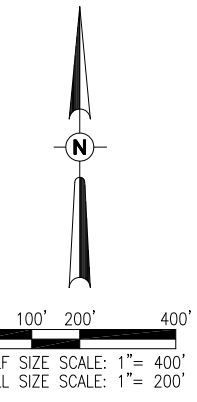
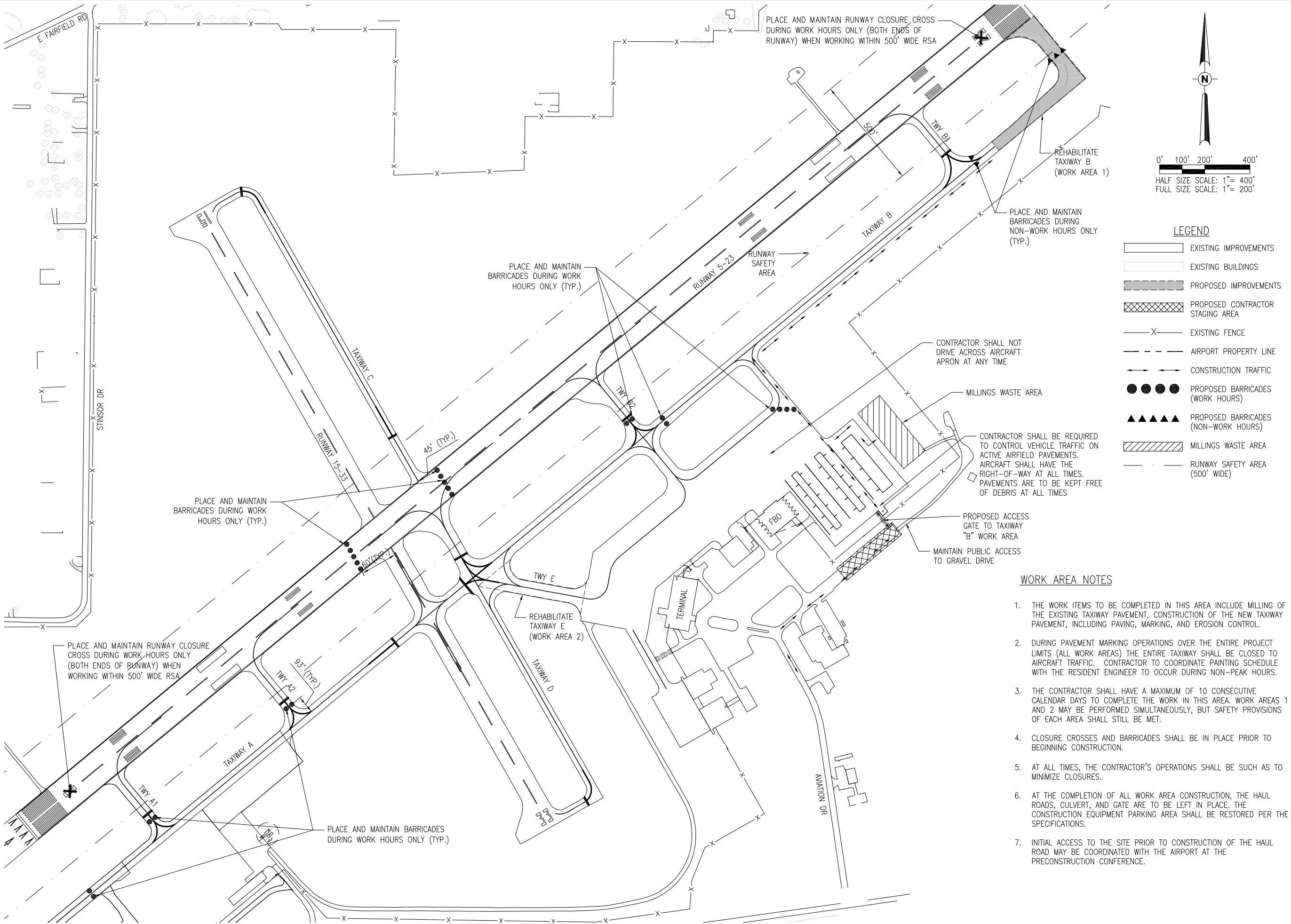

- #### LEGEND
- [Double line] EXISTING IMPROVEMENTS
 - [Thin line] EXISTING BUILDINGS
 - [Hatched box] PROPOSED IMPROVEMENTS
 - [Cross-hatched box] PROPOSED CONTRACTOR STAGING AREA
 - [Line with X] EXISTING FENCE
 - [Dashed line] AIRPORT PROPERTY LINE
 - [Arrow] CONSTRUCTION TRAFFIC
 - [Circle] PROPOSED BARRICADES (WORK HOURS)
 - [Triangle] PROPOSED BARRICADES (NON-WORK HOURS)
 - [Diagonal hatched box] MILLINGS WASTE AREA
 - [Dashed line with dots] RUNWAY SAFETY AREA (500' WIDE)

WORK AREA NOTES

1. THE WORK ITEMS TO BE COMPLETED IN THIS AREA INCLUDE MILLING OF THE EXISTING TAXIWAY PAVEMENT, CONSTRUCTION OF THE NEW TAXIWAY PAVEMENT, INCLUDING PAVING, MARKING, AND EROSION CONTROL.
2. DURING PAVEMENT MARKING OPERATIONS OVER THE ENTIRE PROJECT LIMITS (ALL WORK AREAS) THE ENTIRE TAXIWAY SHALL BE CLOSED TO AIRCRAFT TRAFFIC. CONTRACTOR TO COORDINATE PAINTING SCHEDULE WITH THE RESIDENT ENGINEER TO OCCUR DURING NON-PEAK HOURS.
3. THE CONTRACTOR SHALL HAVE A MAXIMUM OF 10 CONSECUTIVE CALENDAR DAYS TO COMPLETE THE WORK IN THIS AREA. WORK AREAS 1 AND 2 MAY BE PERFORMED SIMULTANEOUSLY, BUT SAFETY PROVISIONS OF EACH AREA SHALL STILL BE MET.
4. CLOSURE CROSSES AND BARRICADES SHALL BE IN PLACE PRIOR TO BEGINNING CONSTRUCTION.
5. AT ALL TIMES, THE CONTRACTOR'S OPERATIONS SHALL BE SUCH AS TO MINIMIZE CLOSURES.
6. AT THE COMPLETION OF ALL WORK AREA CONSTRUCTION, THE HAUL ROADS, CULVERT, AND GATE ARE TO BE LEFT IN PLACE. THE CONSTRUCTION EQUIPMENT PARKING AREA SHALL BE RESTORED PER THE SPECIFICATIONS.
7. INITIAL ACCESS TO THE SITE PRIOR TO CONSTRUCTION OF THE HAUL ROAD MAY BE COORDINATED WITH THE AIRPORT AT THE PRECONSTRUCTION CONFERENCE.



Barry S. Stolz 5/19/14

REHABILITATE TAXIWAYS B & E

IDA No: MVN-4326

Contract No. MV060

NO.	DATE	DESCRIPTION		
		LAY	DWN	REV

ISSUE: MAY 9, 2014
PROJECT NO: 13A0077D
CAD FILE: C-004-SFY.DWG
LAYOUT BY: JRH 03/19/2014
DRAWN BY: JRH 03/19/2014
REVIEWED BY: JSL 04/21/2014
© Copyright Hanson Professional Services Inc. 2013
SHEET TITLE

SAFETY AND PHASING PLAN-WORK AREA 2 TAXIWAY "E"

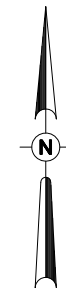
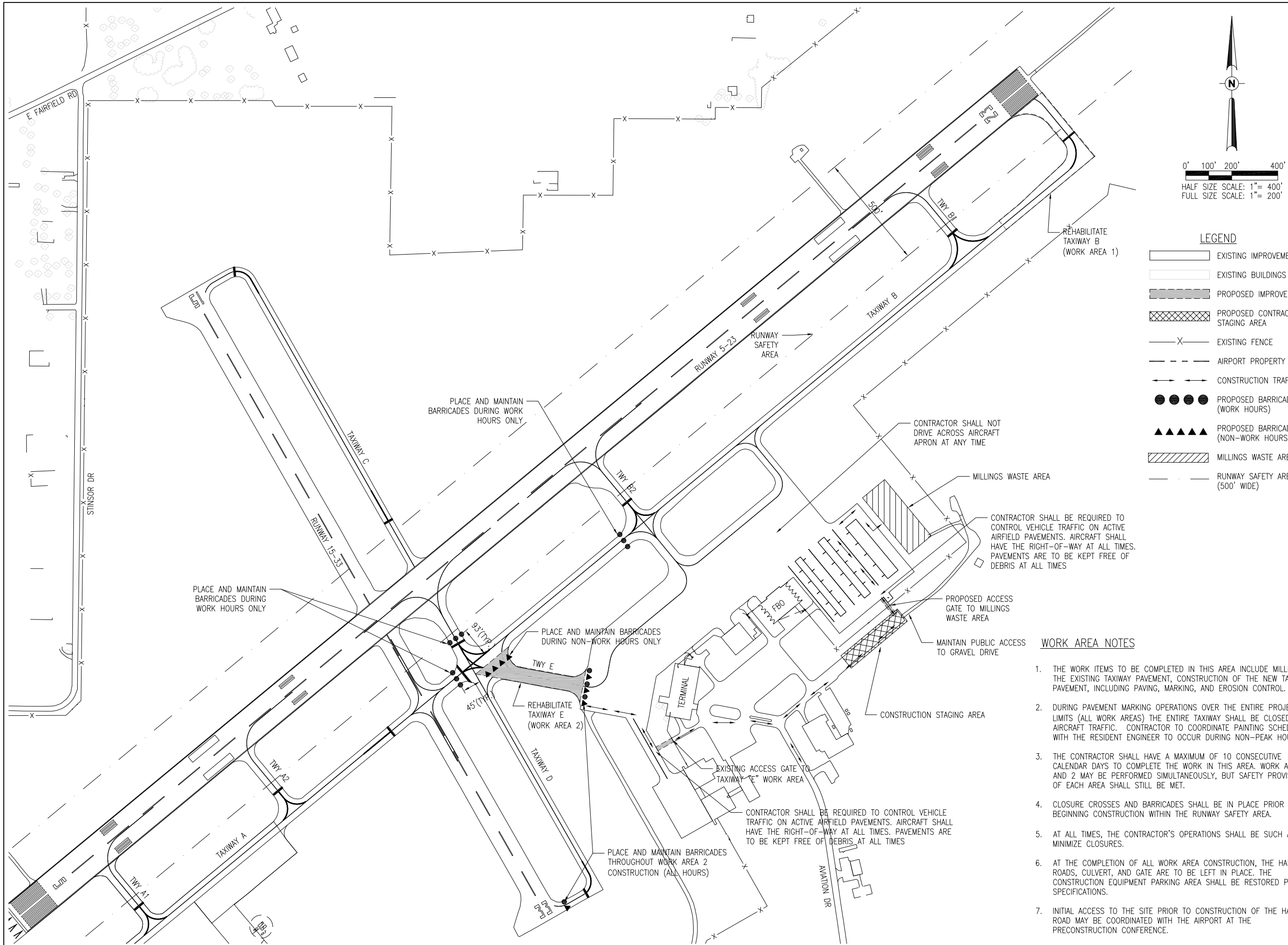

0' 100' 200' 400'
HALF SIZE SCALE: 1" = 400'
FULL SIZE SCALE: 1" = 200'

- LEGEND**
- EXISTING IMPROVEMENTS
 - EXISTING BUILDINGS
 - PROPOSED IMPROVEMENTS
 - PROPOSED CONTRACTOR STAGING AREA
 - X EXISTING FENCE
 - AIRPORT PROPERTY LINE
 - CONSTRUCTION TRAFFIC
 - PROPOSED BARRICADES (WORK HOURS)
 - PROPOSED BARRICADES (NON-WORK HOURS)
 - MILLINGS WASTE AREA
 - RUNWAY SAFETY AREA (500' WIDE)

WORK AREA NOTES

1. THE WORK ITEMS TO BE COMPLETED IN THIS AREA INCLUDE MILLING OF THE EXISTING TAXIWAY PAVEMENT, CONSTRUCTION OF THE NEW TAXIWAY PAVEMENT, INCLUDING PAVING, MARKING, AND EROSION CONTROL.
2. DURING PAVEMENT MARKING OPERATIONS OVER THE ENTIRE PROJECT LIMITS (ALL WORK AREAS) THE ENTIRE TAXIWAY SHALL BE CLOSED TO AIRCRAFT TRAFFIC. CONTRACTOR TO COORDINATE PAINTING SCHEDULE WITH THE RESIDENT ENGINEER TO OCCUR DURING NON-PEAK HOURS.
3. THE CONTRACTOR SHALL HAVE A MAXIMUM OF 10 CONSECUTIVE CALENDAR DAYS TO COMPLETE THE WORK IN THIS AREA. WORK AREAS 1 AND 2 MAY BE PERFORMED SIMULTANEOUSLY, BUT SAFETY PROVISIONS OF EACH AREA SHALL STILL BE MET.
4. CLOSURE CROSSES AND BARRICADES SHALL BE IN PLACE PRIOR TO BEGINNING CONSTRUCTION WITHIN THE RUNWAY SAFETY AREA.
5. AT ALL TIMES, THE CONTRACTOR'S OPERATIONS SHALL BE SUCH AS TO MINIMIZE CLOSURES.
6. AT THE COMPLETION OF ALL WORK AREA CONSTRUCTION, THE HAUL ROADS, CULVERT, AND GATE ARE TO BE LEFT IN PLACE. THE CONSTRUCTION EQUIPMENT PARKING AREA SHALL BE RESTORED PER THE SPECIFICATIONS.
7. INITIAL ACCESS TO THE SITE PRIOR TO CONSTRUCTION OF THE HAUL ROAD MAY BE COORDINATED WITH THE AIRPORT AT THE PRECONSTRUCTION CONFERENCE.

MAY 12, 2014 4:40 PM STC\JL\2014547 pvc\slp\rev036.hanson.dcm\hanson\Projects\Documents\13\jobs\13A0077\13A0077D\CAD\Drawings\SheetC-004-SFY



REHABILITATE TAXIWAYS B & E
IDA No: MVN-4326
Contract No. MV060

NO.	DATE	DESCRIPTION		
		LAY	DWN	REV

ISSUE: MAY 9, 2014
PROJECT NO: 13A0077D
CAD FILE: G-501-SFY.DWG
LAYOUT BY: JRH 03/19/2014
DRAWN BY: JRH 03/19/2014
REVIEWED BY: JSL 04/21/2014
© Copyright Hanson Professional Services Inc. 2013
SHEET TITLE

CONSTRUCTION SAFETY AND PHASING DETAILS AND NOTES

SAFETY NOTES

1. FOLLOWING ARE THE CONSTRUCTION SAFETY PROCEDURES THAT THE CONTRACTOR SHALL FOLLOW THROUGHOUT THIS PROJECT. ADDITIONAL REQUIREMENTS ARE SHOWN ON THE SAFETY AND PHASING NOTES AND DETAILS SHEET.
2. ALL PROVISIONS OF THE LATEST EDITION OF FAA ADVISORY CIRCULAR AC 150/5370-2 (CURRENT EDITION), "OPERATIONAL SAFETY ON AIRPORTS DURING CONSTRUCTION", APPLY TO THIS CONTRACT, EXCEPT AS MODIFIED BY THIS SAFETY PLAN, OR AS MODIFIED BY THE OWNER THROUGH THE RESIDENT ENGINEER AT THE PRECONSTRUCTION CONFERENCE, OR DURING THE COURSE OF THE CONTRACT.
3. THE CONTRACTORS SHALL MINIMIZE DISRUPTION OF STANDARD OPERATING PROCEDURES FOR AERONAUTICAL ACTIVITY BY REMAINING WITHIN THE PRESCRIBED STAGING, CONSTRUCTION, AND PHASING AREAS PRESENTED ON THE PROJECT SAFETY AND PHASING PLANS.
4. NO UNAUTHORIZED PERSONNEL SHALL ENTER ANY AREA OF THE AIRPORT THAT COULD POTENTIALLY BE HAZARDOUS. THE AIRPORT MANAGER RESERVES THE RIGHT TO SUSPEND OPERATIONS IN ORDER TO MAINTAIN SAFETY AT THE AIRPORT.
5. CONTRACTOR EQUIPMENT, VEHICLES, AND PROJECT MATERIALS SHALL BE STORED AT THE STAGING AREA SHOWN ON THE PLAN VIEW, EXCEPT AS OTHERWISE PROVIDED FOR AT THE PRECONSTRUCTION CONFERENCE.
6. ALL CONSTRUCTION EQUIPMENT OPERATING IN THE PRESCRIBED CONSTRUCTION AREA IS REQUIRED TO DISPLAY A CHECKERBOARD FLAG PROPERLY LOCATED OR A ROTATING BEACON (STROBE) AS SPECIFIED IN AC 150/5210-5, "PAINTING, MARKING, AND LIGHTING OF VEHICLES USED ON AN AIRPORT" LATEST EDITION.
7. NO CONSTRUCTION MATERIAL STOCKPILES SHALL BE LOCATED WITHIN 250' OF ANY ACTIVE RUNWAY, WITHIN 93' OF ANY OTHER ACTIVE AIRPORT OPERATIONS AREA, OR PENETRATE A PART 77 IMAGINARY SURFACE (PROVIDED BY THE RESIDENT ENGINEER) EXTENDING OUT AND UPWARDS FROM ALL SIDES OF AN ACTIVE RUNWAY.
8. CLOSED AIRFIELD PHASING AREAS, OPEN TRENCHES, AND STOCKPILED MATERIALS AT THE CONSTRUCTION SITE SHALL BE PROMINENTLY MARKED WITH LIGHTED BARRICADES WITH STEADY BURNING OR FLASHING RED LIGHTS AS SPECIFIED IN 150/5370-2, "OPERATIONAL SAFETY ON AIRPORT DURING CONSTRUCTION, LATEST EDITION. LIGHTED BARRICADES MUST BE NO TALLER THAN 18" (EXCLUSIVE OF SUPPLEMENTARY LIGHTS AND FLAGS) ON THE TAXIWAYS AND COMPLY WITH ADVISORY CIRCULAR 150/5370-2, LATEST EDITION. CONTRACTOR SHALL NIGHT CHECK BARRICADES DAILY FOR PROPER OPERATION.
9. NO OPEN TRENCHES WITHIN 250' OF AN ACTIVE RUNWAY CENTERLINE OR WITHIN 93' OF ANY AIRPORT OPERATIONS AREA WILL BE PERMITTED UNLESS PROPERLY MARKED. OTHER TRENCHES SHALL BE MAINTAINED SAFE, I.E., BARRICADED OR COVERED WITH STEEL PLATES IN ALL OTHER AREAS.
10. OPEN TRENCHES, EXCAVATIONS, AND STOCKPILED MATERIALS AT THE CONSTRUCTION SITE SHOULD BE PROMINENTLY MARKED WITH ORANGE FLAGS AND LIGHTED WITH FLASHING YELLOW LIGHTS DURING HOURS OF RESTRICTED VISIBILITY AND/OR DARKNESS.
11. NO CONSTRUCTION EQUIPMENT GREATER THAN 25' TALL WILL BE PERMITTED ON THE AIRPORT. HOWEVER OTHER EQUIPMENT TALLER THAN 25' MAY BE PERMITTED WITH THE APPROVAL OF THE AIRPORT MANAGER AND AIRSPACE APPROVAL BY THE FAA.
12. NO OPEN FLAME WELDING OR TORCH CUTTING OPERATION IS PERMITTED UNLESS ADEQUATE FIRE AND SAFETY PRECAUTIONS ARE PROVIDED AND HAVE BEEN APPROVED BY THE AIRPORT MANAGER NO FLARE POTS ARE ALLOWED ON THE PROJECT.
13. SOIL, DEBRIS, AND LOOSE MATERIAL DROPPED OR TRUCKED ONTO AIRPORT ROADS, TAXIWAYS, AND SOD SURFACES, OR WHICH CAN BE BLOWN ONTO SUCH SURFACES, SHALL BE IMMEDIATELY SWEEP, PICKED UP AND REMOVED, OR PLACED INTO CLOSED CONTAINERS. ANY DAMAGE TO AIRPORT PROPERTY SHALL BE REPAIRED IMMEDIATELY AT NO COST TO THE OWNER.
14. EACH CONTRACTOR SHALL BE RESPONSIBLE FOR LOCATING AND MAINTAINING AIRPORT LIGHTING AND NAVIGATIONAL ELECTRICAL SYSTEMS DURING CONSTRUCTION. A CONTACT PERSON AND TELEPHONE NUMBER FOR 24 HOUR EMERGENCY IMMEDIATE REPAIR SHALL BE SUBMITTED TO THE AIRPORT MANAGER AND RESIDENT ENGINEER. HAUL ROUTES CROSSING PAVEMENT, DRAINAGE, MISCELLANEOUS STRUCTURES AND/OR AIRFIELD CABLES SHALL BE PROTECTED FROM DAMAGE.
15. ALL AIRCRAFT AND AIRPORT OPERATIONS HAVE THE RIGHT-OF-WAY. CONTRACTOR TO YIELD TO VEHICLES AND REMAIN CLEAR AT ALL TIMES.
16. CONTRACTOR SHALL PLACE, SECURE, AND MAINTAIN LIGHTED BARRICADES AND CLOSURE CROSSES WHEN A RUNWAY/TAXIWAY/APRON IS CLOSED OR AS REQUIRED BY THE PLANS AND DESIGNATED BY THE RESIDENT ENGINEER.
17. CONTRACTOR SHALL MARK HAZARDOUS AREA WITH STEADY-BURNING OR FLASHING RED LIGHTS DURING PERIODS OF LOW VISIBILITY AS REQUIRED.
18. THE CONTRACTOR SHALL PERIODICALLY PERFORM ONSITE INSPECTIONS THROUGHOUT THE DURATION OF THE PROJECT WITH THE IMMEDIATE REMEDY OF ANY DIFFERENCES, WHETHER CAUSED BY NEGLIGENCE, OVERSIGHT, OR PROJECT SCOPE CHANGE.
19. CONTRACTOR SHALL MOVE MAINTENANCE OF TRAFFIC COMPONENTS AT THE WRITTEN DIRECTION OF THE RESIDENT ENGINEER AT NO ADDITIONAL COST.
20. CONTRACTOR SHALL NOT REMOVE THE BARRICADES WITHOUT THE APPROVAL BY THE RESIDENT ENGINEER.
21. CONTRACTOR SHALL MAINTAIN FLASHERS, SIGNS AND/OR BARRICADES AS REQUIRED BY THE PLANS, CITY OR COUNTY REGULATIONS OR CONTRACTOR ACTIVITIES. CONTRACTOR SHALL OBTAIN ANY AND ALL REQUIRED LOCAL PERMITS UNLESS SPECIFIED OTHERWISE.
22. THE CONTRACTOR SHALL UTILIZE WATER AND/OR CHEMICALS APPROVED BY THE RESIDENT ENGINEER AS NECESSARY TO CONTROL DUST.
23. NO CONSTRUCTION VEHICLES SHALL BE DRIVEN ACROSS ANY ACTIVE RUNWAY, INCLUDING TURF RUNWAYS. CONSTRUCTION EQUIPMENT OR CONSTRUCTION ACTIVITY WILL NOT BE PERMITTED WITHIN 250' OF ANY ACTIVE RUNWAY CENTERLINE OR WITHIN 93' OF ANY OTHER ACTIVE AIRPORT TAXIWAY OR APRON. HOWEVER, CONSTRUCTION MAY BE PERMITTED IN THESE AREAS IF THE CONTRACTOR HAS GAINED APPROVAL FROM THE AIRPORT MANAGER AT LEAST 7 DAYS IN ADVANCE OF THE SCHEDULED CONSTRUCTION PERIOD AND THE OPERATIONAL AREA IS CLOSED TO TRAFFIC AND PROPER NOTAMS ARE ISSUED BY THE AIRPORT MANAGER TO THE APPROPRIATE FLIGHT SERVICE STATION.
24. UNLESS SPECIFIED OTHERWISE, COST FOR THE ABOVE IS TO BE CONSIDERED INCIDENTAL TO THE PROJECT. SEPARATE PAYMENT SHALL NOT BE MADE.

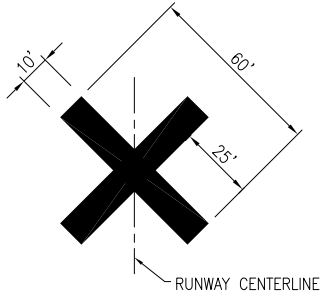

1. TEMPORARY CLOSURE CROSS MARKINGS SHALL BE "AVIATION YELLOW."
2. TEMPORARY CLOSURE CROSS MARKINGS SHALL BE CONSTRUCTED OF PLYWOOD, SNOW FENCE OR APPROVED FABRIC AND SHALL BE SECURED TO PAVEMENT BY SANDBAGS OR OTHER APPROVED METHOD.
3. COST FOR PROVIDING, PLACING, MAINTAINING, AND REMOVING CLOSURE CROSSES SHALL BE INCLUDED IN THE COST OF THE OTHER CONTRACT ITEMS.

CLOSURE CROSS MARKER DETAIL
NOT TO SCALE

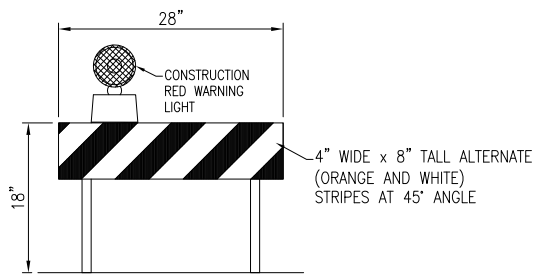

MODIFIED TYPE II BARRICADE
NOT TO SCALE

BARRICADE NOTES

1. ALL CONSTRUCTION SIGNS AND TRAFFIC CONTROL DEVICES SHALL CONFORM TO THE MANUAL ON UNIFORM TRAFFIC CONTROL DEVICES INCLUDING THE ILLINOIS SUPPLEMENT (LATEST EDITION) AND THE FAA ADVISORY CIRCULARS (LATEST EDITION) UNLESS NOTED OTHERWISE. THE FAA OR MORE STRINGENT SPECIFICATIONS SHALL GOVERN.
2. MODIFIED TYPE II BARRICADES SHALL BE SPACED END TO END THE WIDTH OF THE PAVEMENT IN 4' INCREMENTS. BARRICADES ARE TO BE SET BACK 66' FROM THE ACTIVE TAXIWAY CENTERLINE OR AS SHOWN ON THE PLANS.
3. CONSTRUCTION RED WARNING LIGHT: THESE ARE PORTABLE, LENS DIRECTED, ENCLOSED LIGHTS. THE COLOR OF THE LIGHT EMITTED SHALL BE RED. THEY MAY BE USED IN EITHER A STEADY BURN (TYPE C) OR LOW INTENSITY FLASHING MODE (TYPE A) UNLESS NOTED OTHERWISE.
4. THE LIGHTING SHALL BE MAINTAINED IN OPERATION DURING THE HOURS OF DARKNESS BETWEEN 1/2 HOUR AFTER SUNSET AND 1/2 HOUR BEFORE SUNRISE AND WHEN CONDITIONS EXIST WHICH TEND TO OBSCURE VISION.
5. BARRICADES SHALL BE SECURED TO THE GROUND BY APPROVED METHODS TO PREVENT MOVEMENT BY PROP WASH, JET BLAST OR OTHER WIND CURRENTS.
6. THE ONLY COLOR COMBINATION ON TYPE II BARRICADES IS ORANGE AND WHITE. THE ORANGE STRIPES SHALL BE ENCAPSULATED LENS REFLECTIVE SHEETING. THE WHITE STRIPES SHALL BE EITHER ENCAPSULATED OR ENCLOSED LENS REFLECTIVE SHEETING AND MUST BE IN ACCEPTABLE CONDITION.
7. COST FOR PROVIDING, PLACING, MAINTAINING, AND REMOVING BARRICADES SHALL BE INCLUDED IN THE COST OF THE OTHER CONTRACT ITEMS.

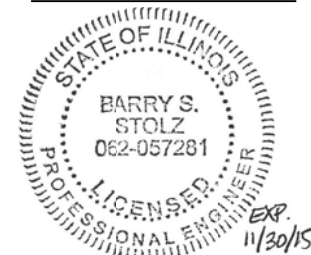

Barry S. Stolz 5/19/14

REHABILITATE TAXIWAYS B & E

IDA No: MVN-4326

Contract No. MV060

NO.	DATE	DESCRIPTION		
		LAY	DWN	REV

ISSUE: MAY 9, 2014
PROJECT NO: 13A0077D
CAD FILE: C-300-TYP.DWG
LAYOUT BY: JRH 03/20/2014
DRAWN BY: JRH 03/20/2014
REVIEWED BY: JSL 04/21/2014

© Copyright Hanson Professional Services Inc. 2013
SHEET TITLE

PROPOSED TYPICAL SECTIONS

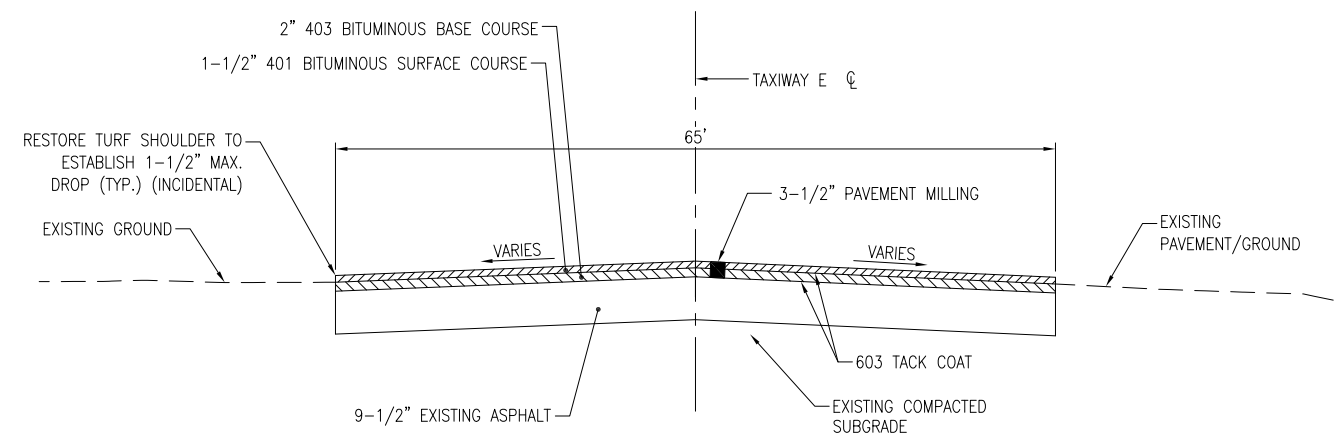

TYPICAL SECTION - TAXIWAY E
(SLOPES AND DIMENSIONS VARY AT INTERSECTIONS)
NOT TO SCALE

- MILLING EQUIPMENT SHALL BE CAPABLE OF ACCURATELY ESTABLISHING PROFILE GRADES BY REFERENCING FROM EITHER THE EXISTING PAVEMENT OR FROM INDEPENDENT GRADE CONTROL.

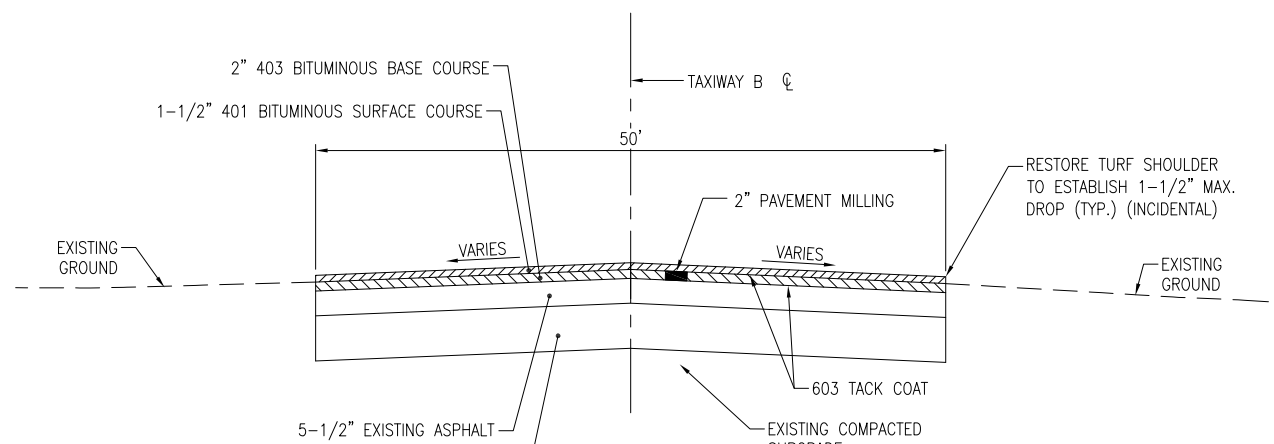

TYPICAL SECTION - TAXIWAY B
(SLOPES AND DIMENSIONS VARY AT INTERSECTIONS)
NOT TO SCALE

- MILLING EQUIPMENT SHALL BE CAPABLE OF ACCURATELY ESTABLISHING PROFILE GRADES BY REFERENCING FROM EITHER THE EXISTING PAVEMENT OR FROM INDEPENDENT GRADE CONTROL.

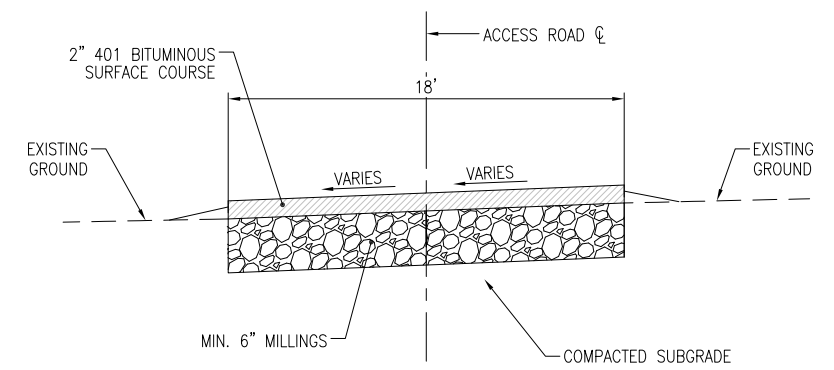

TYPICAL SECTION - ACCESS ROAD
NOT TO SCALE

- REFER TO SPECIAL PROVISION AR150540 HAUL ROUTE FOR PAYMENT INFORMATION.
- PROPOSED PAVEMENT SHALL MATCH INTO EXISTING PAVEMENT ELEVATIONS AND BE GRADED TO DRAIN.

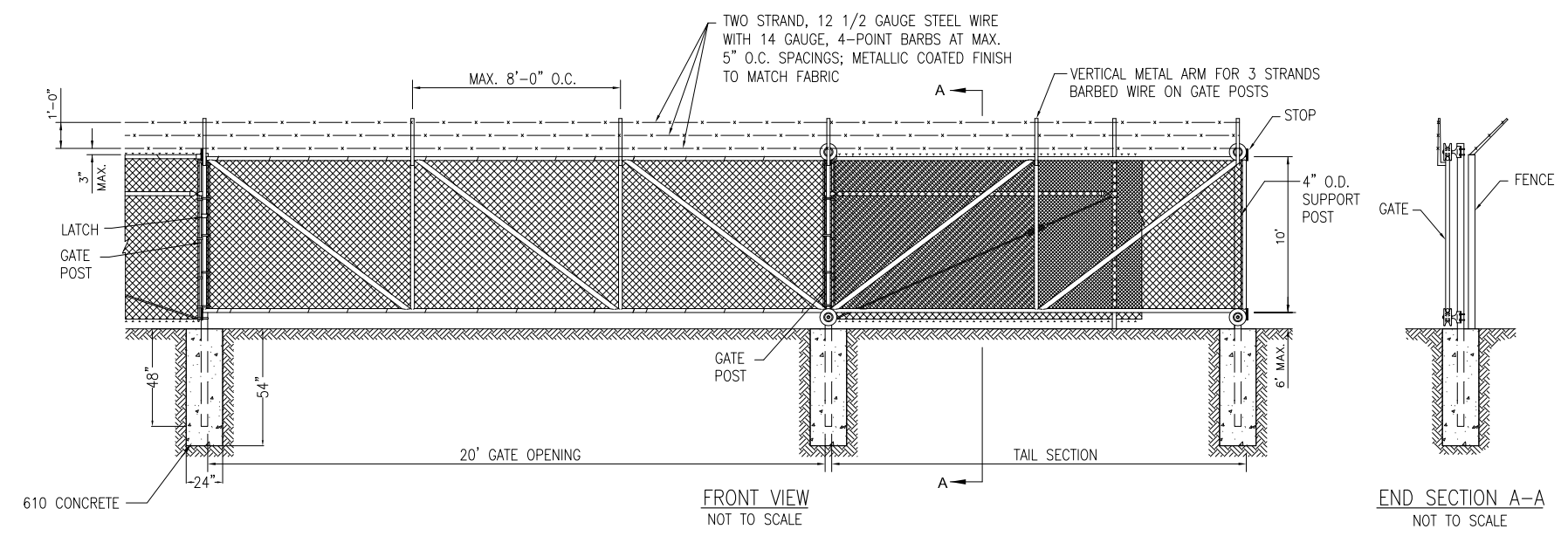

SINGLE CANTILEVER MANUAL SLIDE GATE DETAILS

MAY 12, 2014 5:00 PM STC01201547 pvc:\sp\rev\036.hanson.com\hanson_projects\documents\13\jobs\13A0077\13A0077\DCAD\hanson\sheet\c-300-typ



Barry S. Stolz 5/9/14

REHABILITATE TAXIWAYS B & E

IDA No: MVN-4326

Contract No. MV060

NO.	DATE	DESCRIPTION		
		LAY	DWN	REV

ISSUE: MAY 9, 2014
PROJECT NO: 13A0077D
CAD FILE: C-121-CON.DWG
LAYOUT BY: JRH 03/20/2014
DRAWN BY: JRH 03/20/2014
REVIEWED BY: JSL 04/21/2014
© Copyright Hanson Professional Services Inc. 2013
SHEET TITLE

PROPOSED CONSTRUCTION PLANS - TAXIWAYS B & E

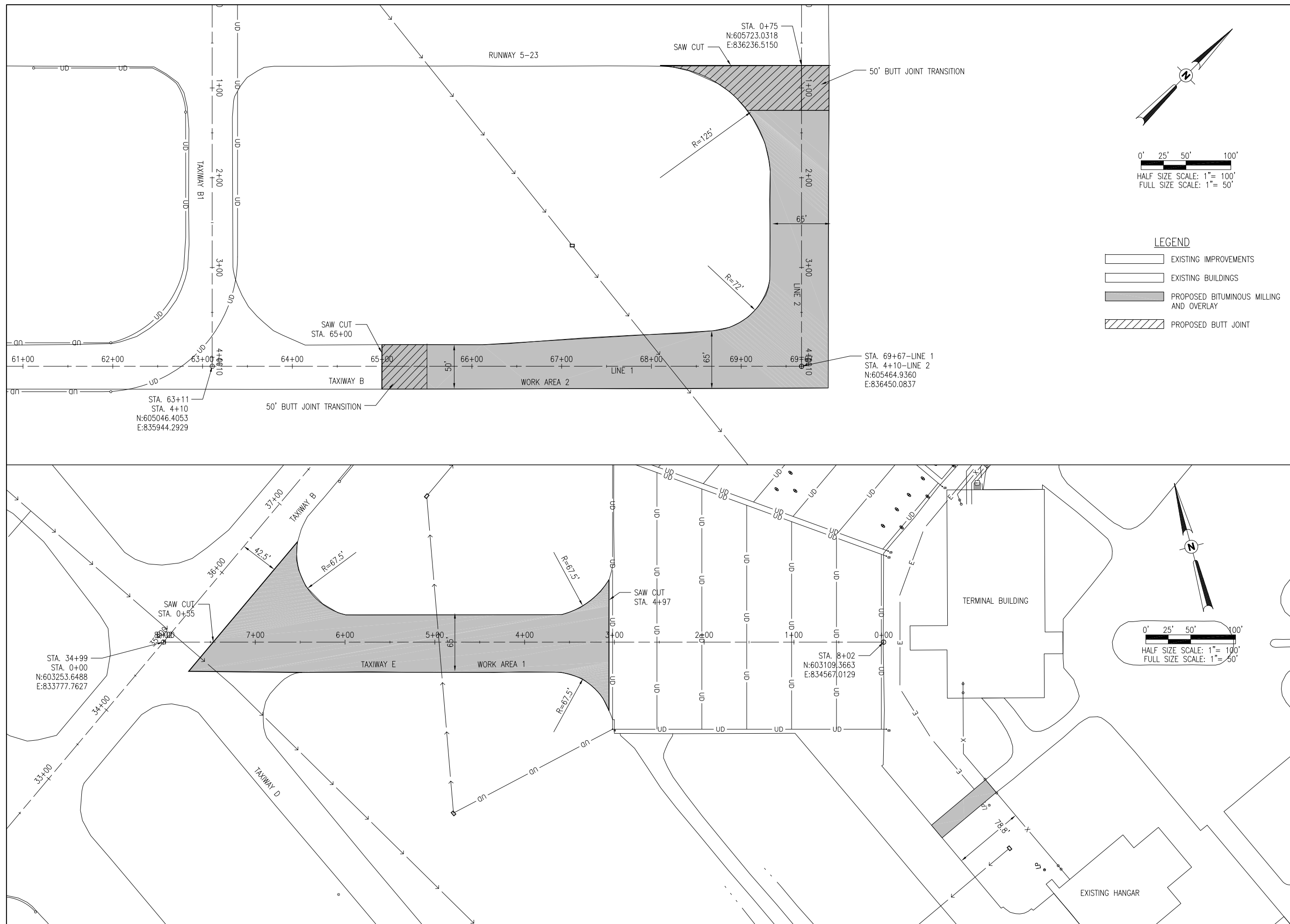

MAY 12, 2014 4:37 PM STC01201547
p:\projects\13A0077D\CAD\Drawings\SheetC-121-CON

STATE OF ILLINOIS
BARRY S. STOLZ
062-057281
PROFESSIONAL ENGINEER
EX. 11/30/15
Barry S. Stolz 5/9/14

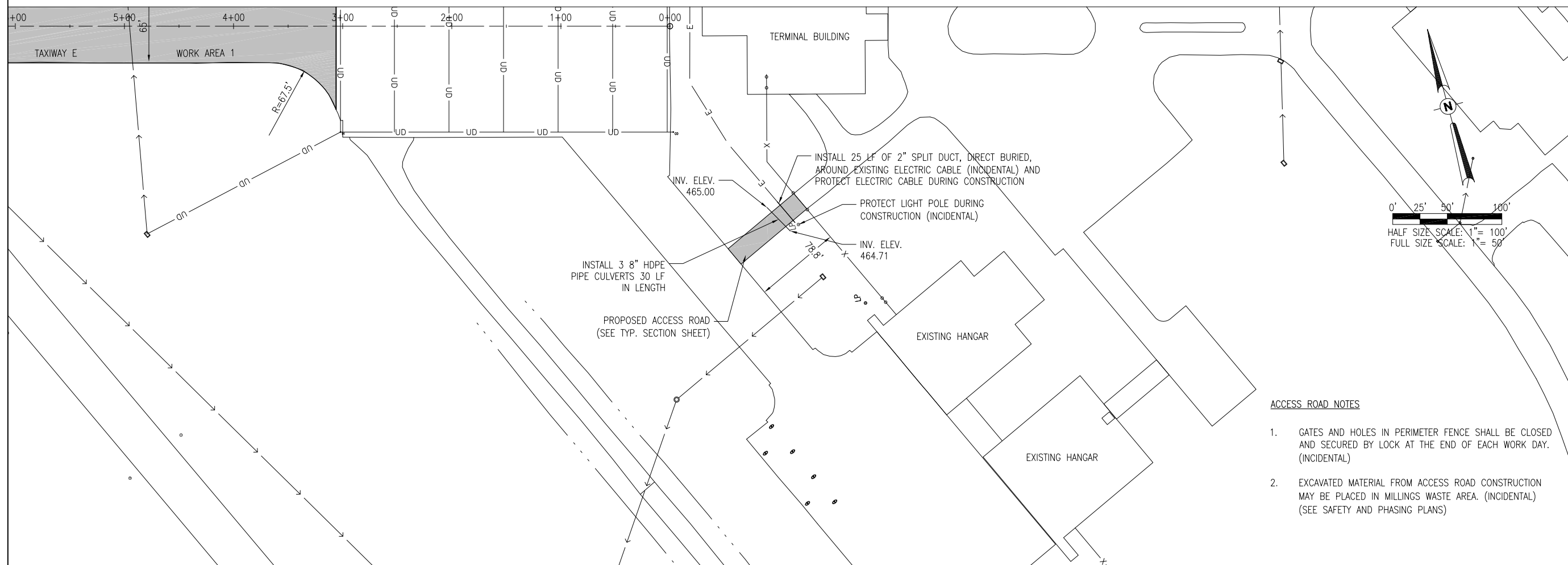
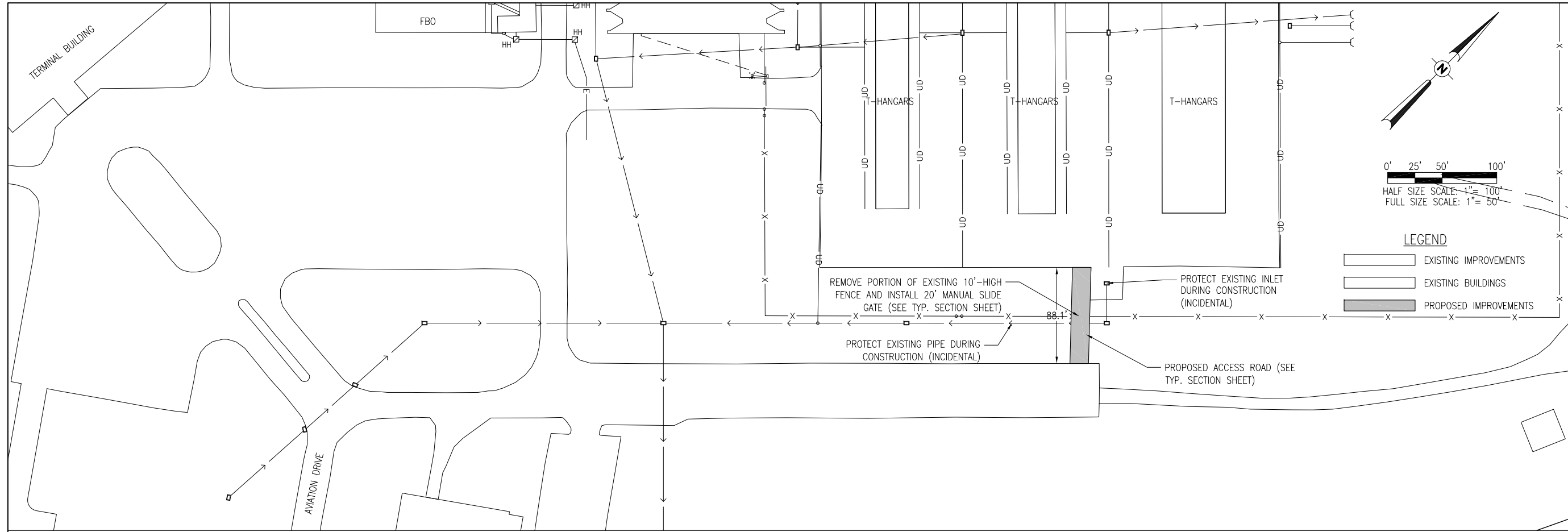

- ACCESS ROAD NOTES**
- GATES AND HOLES IN PERIMETER FENCE SHALL BE CLOSED AND SECURED BY LOCK AT THE END OF EACH WORK DAY. (INCIDENTAL)
 - EXCAVATED MATERIAL FROM ACCESS ROAD CONSTRUCTION MAY BE PLACED IN MILLINGS WASTE AREA. (INCIDENTAL) (SEE SAFETY AND PHASING PLANS)

REHABILITATE TAXIWAYS B & E

IDA No: MVN-4326

Contract No. MV060

NO.	DATE	DESCRIPTION		
		LAY	DWN	REV

ISSUE: MAY 9, 2014
PROJECT NO: 13A0077D
CAD FILE: C-121-CON.DWG
LAYOUT BY: JRH 03/20/2014
DRAWN BY: JRH 03/20/2014
REVIEWED BY: JSL 04/21/2014
© Copyright Hanson Professional Services Inc. 2013
SHEET TITLE

PROPOSED CONSTRUCTION PLANS - ACCESS ROADS

MAY 12, 2014 4:37 PM STC01201547
p:\projects\13A0077D\CAD\Drawings\SheetC-121-CON

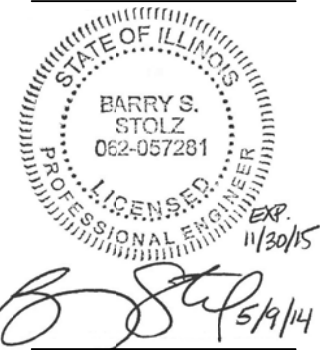

REHABILITATE TAXIWAYS B & E

IDA No: MVN-4326

Contract No. MV060

NO.	DATE	DESCRIPTION		
		LAY	DWN	REV

ISSUE: MAY 9, 2014
PROJECT NO: 13A0077D
CAD FILE: C-701-PNP.DWG
LAYOUT BY: JRH 03/20/2014
DRAWN BY: JRH 03/20/2014
REVIEWED BY: JSL 04/21/2014
© Copyright Hanson Professional Services Inc. 2013
SHEET TITLE

PROPOSED PLAN AND PROFILE-TAXIWAY B

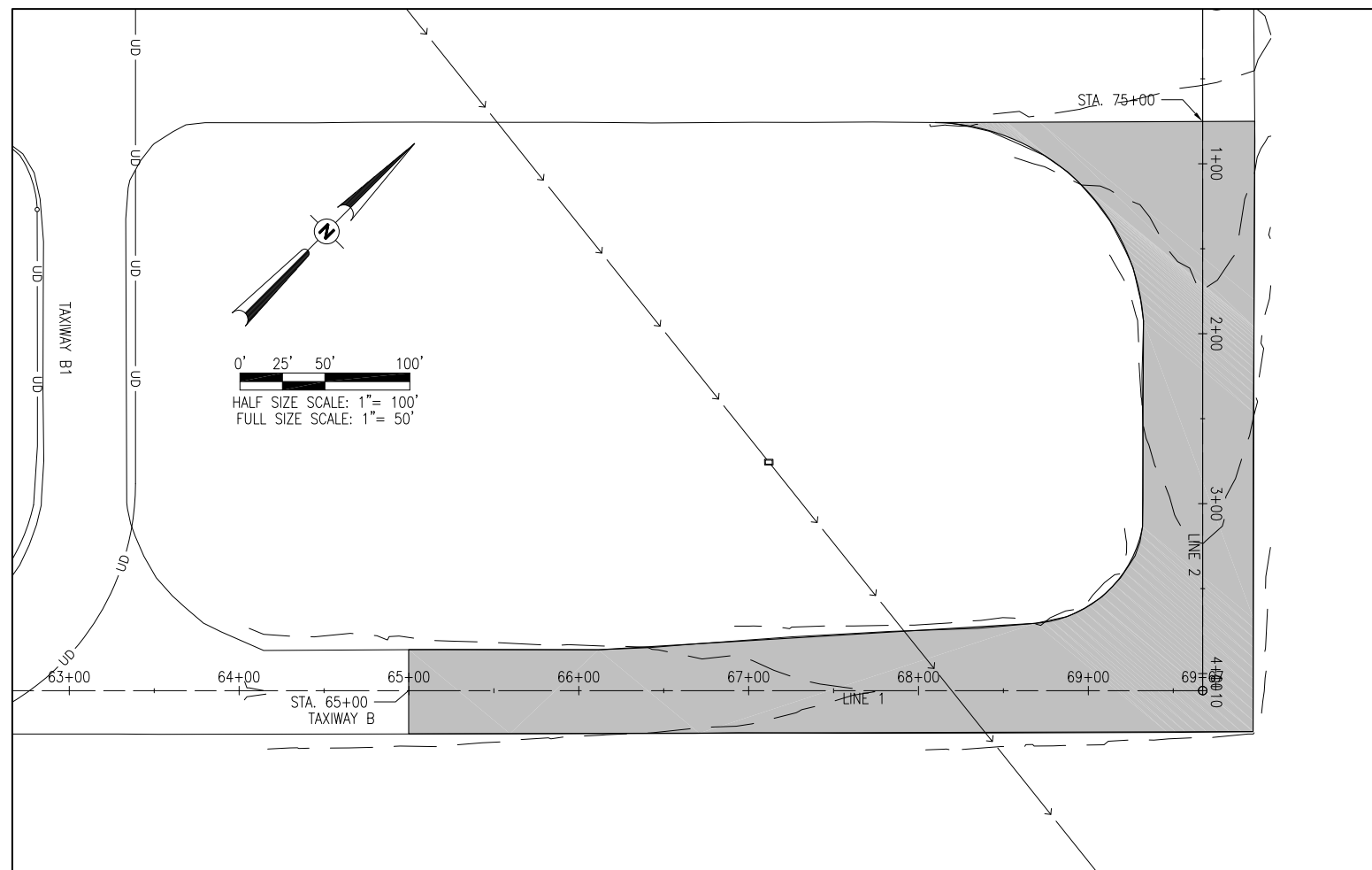

PLAN-TAXIWAY B-LINE 1

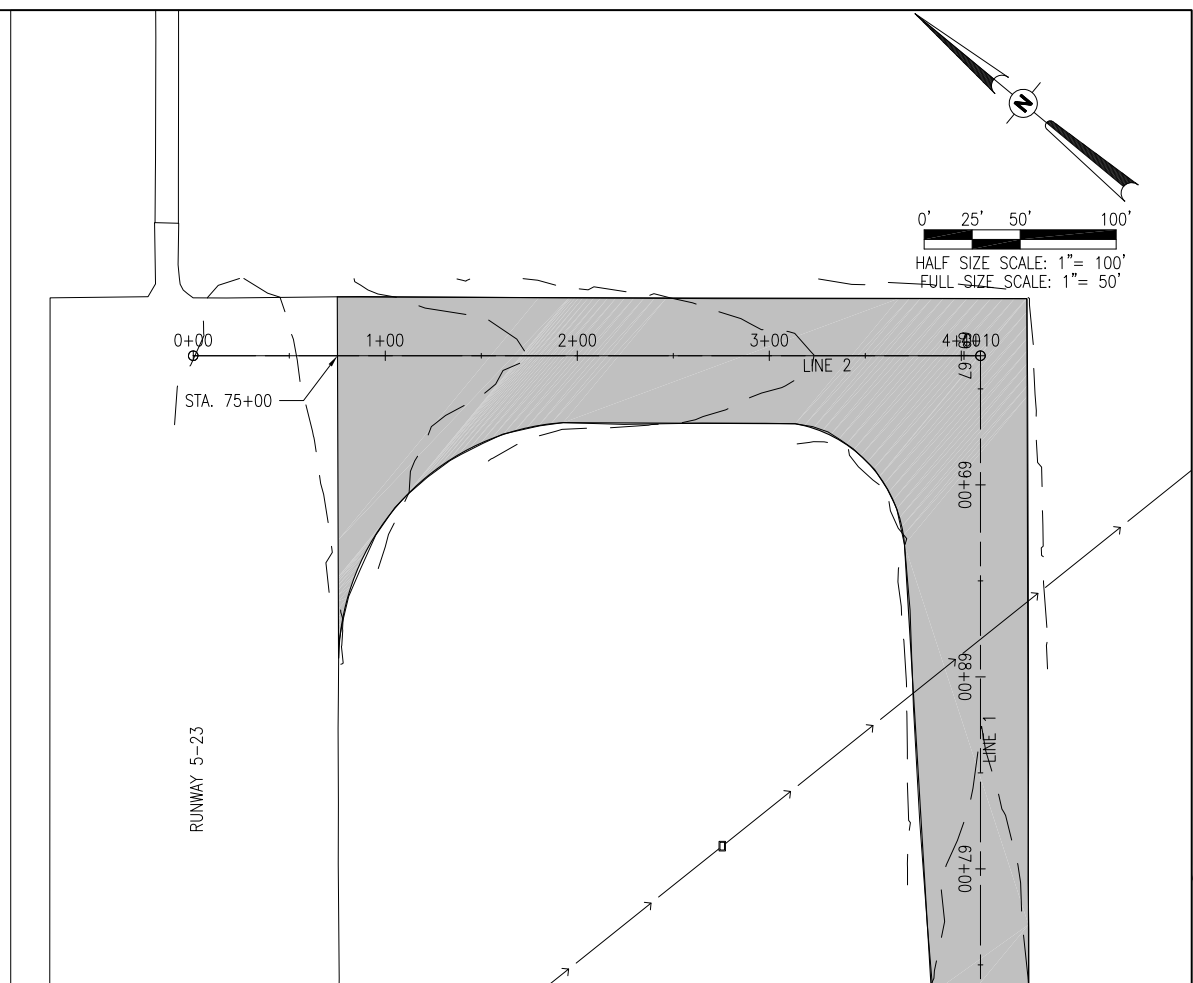

PLAN-TAXIWAY B-LINE 2

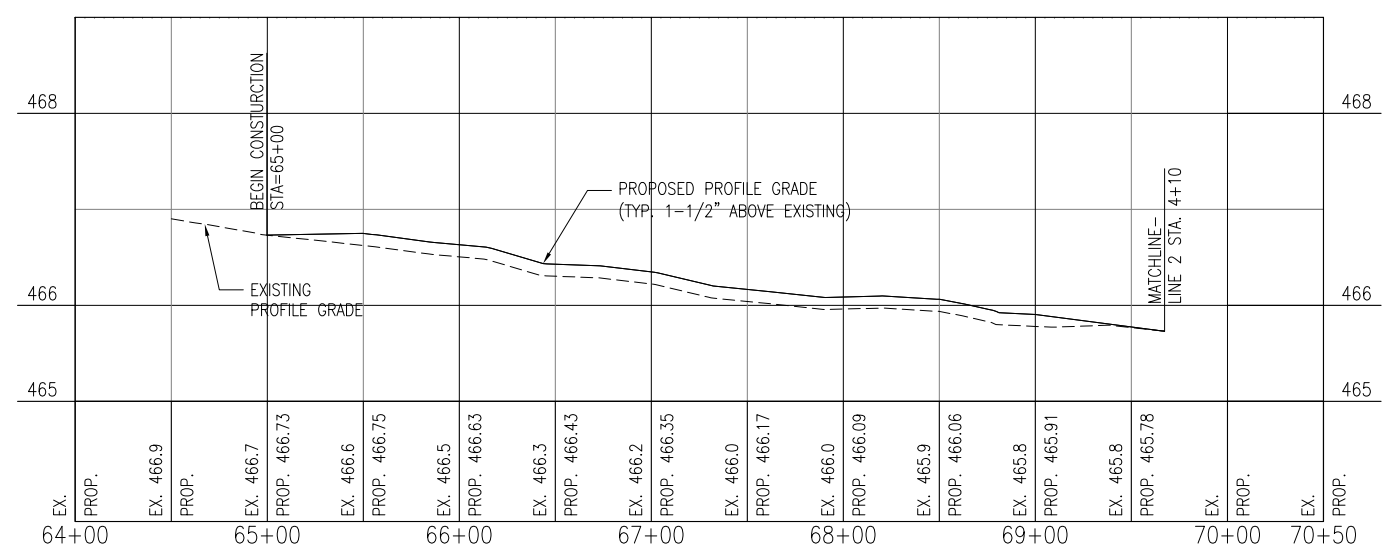

PROFILE-TAXIWAY B-LINE 1

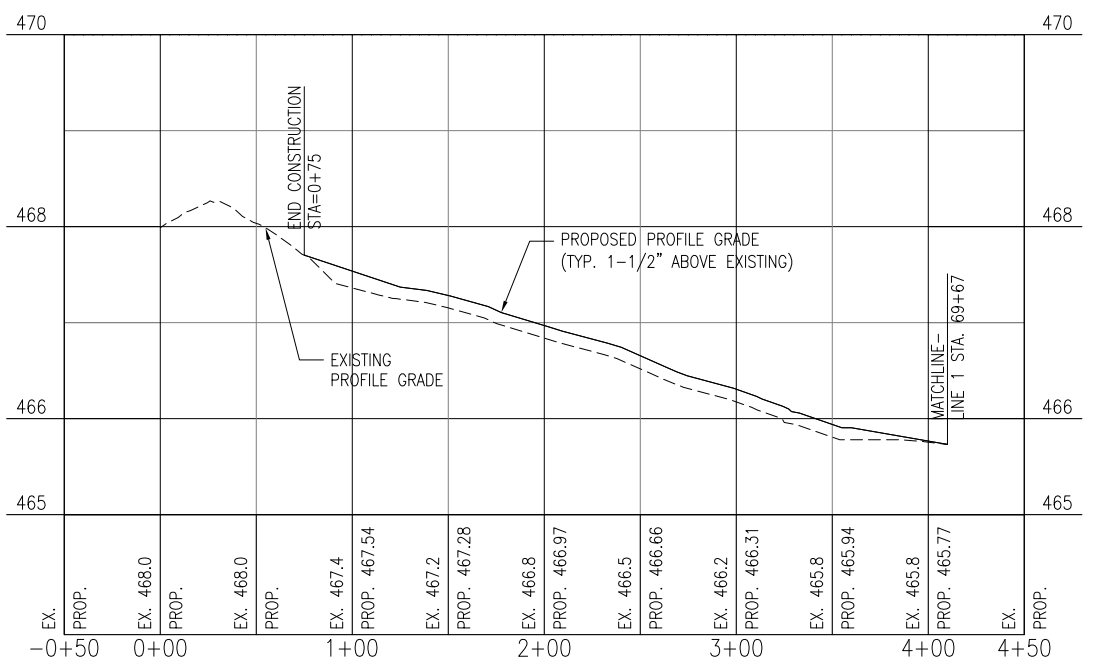

PROFILE-TAXIWAY B-LINE 2

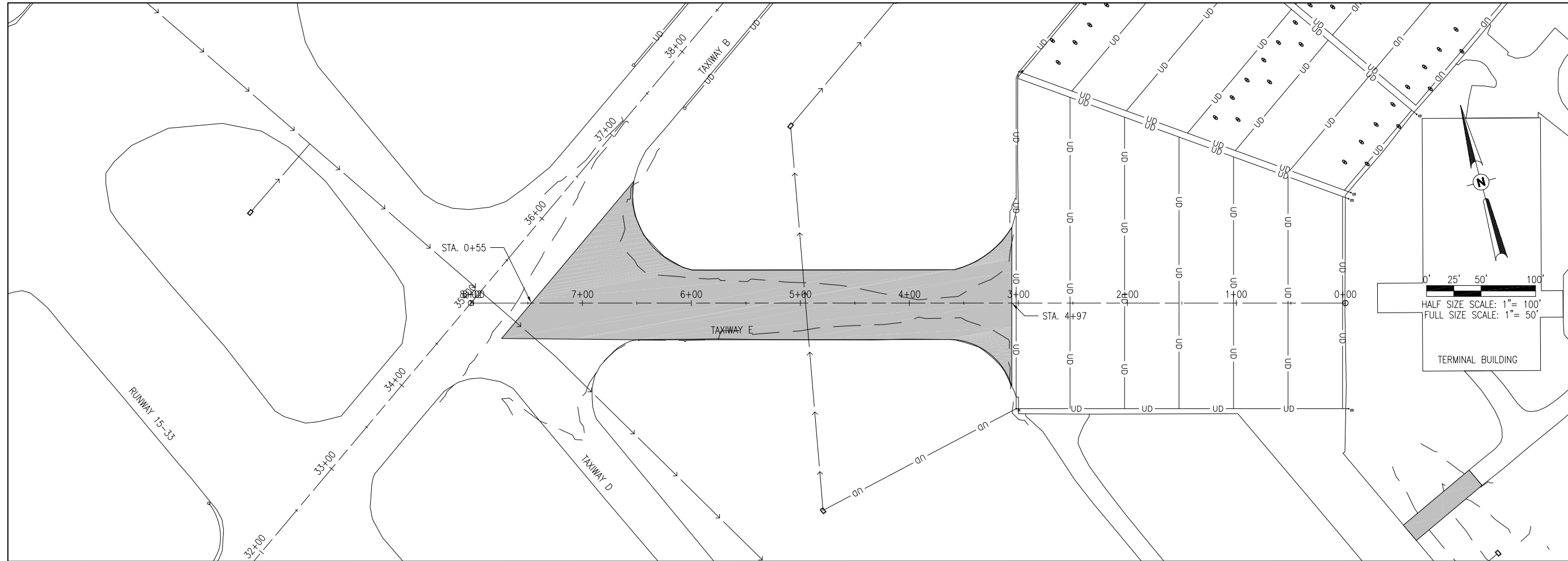

PLAN-TAXIWAY E

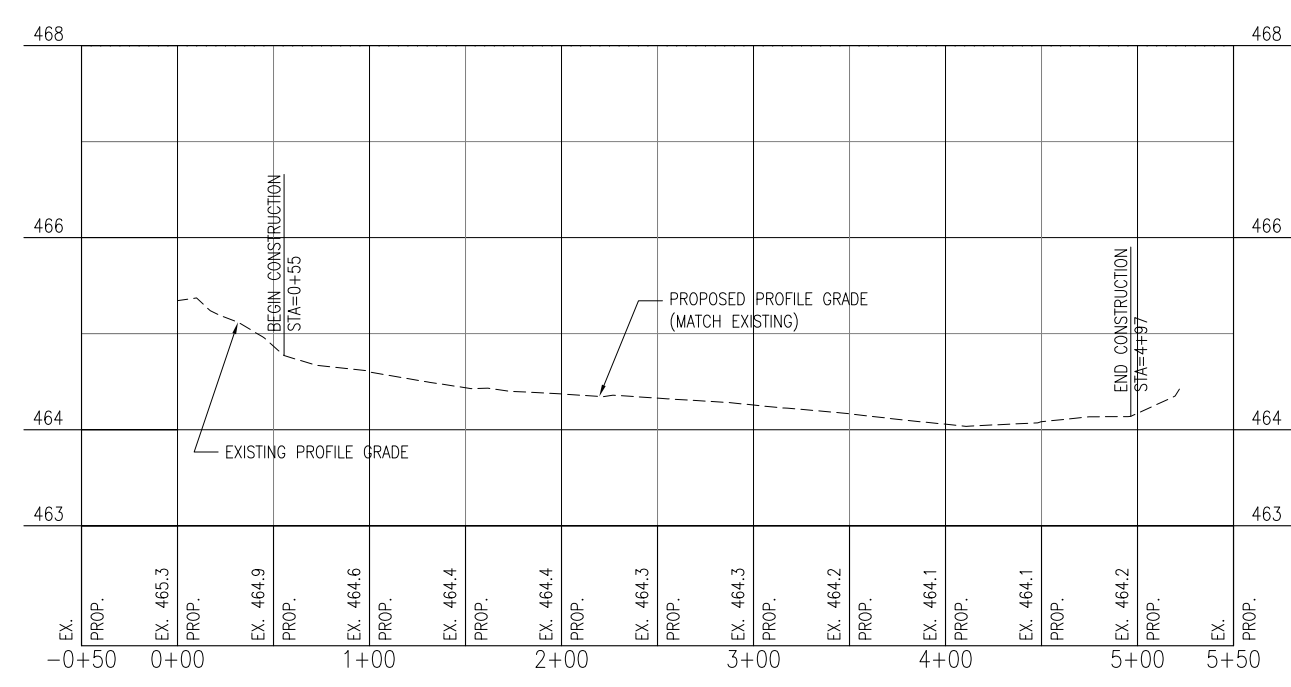

PROFILE-TAXIWAY E

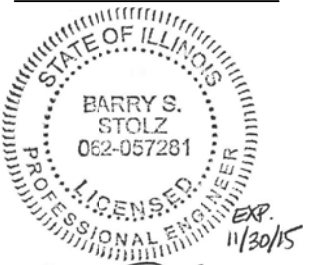

B. Stolz 5/9/14

REHABILITATE TAXIWAYS B & E
IDA No: MVN-4326
Contract No. MV060

NO.	DATE	DESCRIPTION		
		LAY	DWN	REV

ISSUE: MAY 9, 2014
PROJECT NO: 13A0077D
CAD FILE: C-701-PNP.DWG
LAYOUT BY: JRH 03/20/2014
DRAWN BY: JRH 03/20/2014
REVIEWED BY: JSL 04/21/2014
© Copyright Hanson Professional Services Inc. 2013
SHEET TITLE

PROPOSED PLAN AND PROFILE-TAXIWAY E

MAY 12, 2014 11:31 AM STOLZ.201547
p:\c\sp\rev\06.hanson.donr\hanson\Projects\Documents\13\jobs\13A0077\CAD\DWG\airports\SheetC-701-PNP

STATE OF ILLINOIS
BARRY S. STOLZ
062-057281
PROFESSIONAL ENGINEER
11/30/15
5/19/14

PAVEMENT MARKING NOTES

1. TYPE B GLASS BEADS SHALL BE REQUIRED FOR ALL WHITE AND YELLOW PERMANENT PAINT MARKINGS. GLASS BEADS ARE NOT REQUIRED FOR TEMPORARY MARKINGS OR BLACK PAINT. REFER TO SPECIFICATION ITEM 620 FOR ADDITIONAL INFORMATION.
2. PAINT SHALL MEET REQUIREMENTS OF TECHNICAL SPECIFICATION 620, WATERBORNE PAINT.
3. IMMEDIATELY PRIOR TO THE APPLICATION OF PAINT, ALL SURFACES SHALL BE DRY AND FREE FROM DIRT, GREASE, OIL, LANTANCE, OR OTHER FOREIGN MATERIAL WHICH WOULD REDUCE THE BOND BETWEEN THE PAINT AND THE PAVEMENT. THIS SHALL INCLUDE PAINTED AREAS ON THE EXISTING PAVEMENTS. REFER TO SPECIFICATION ITEM 620-3.3 FOR ADDITIONAL INFORMATION.
4. EXISTING PAVEMENT MARKINGS OUTSIDE THE LIMITS OF THE MARKINGS SHOWN ON THE MARKING PLAN WHICH ARE REMOVED OR WORN DUE TO CONSTRUCTION ACTIVITY SHALL BE REPAINTED. NO ADDITIONAL COMPENSATION SHALL BE MADE FOR THIS WORK.
5. NUMERAL MARKING TEMPLATES FOR SURFACE PAINTED HOLD POSITION SIGN MARKINGS SHALL BE PROVIDED BY THE OWNER FOR CONTRACTOR USE ON THE PROJECT. TEMPLATES SHALL BE MAINTAINED IN GOOD CONDITION AND RETURNED TO THE OWNER AFTER CONTRACTOR USE.

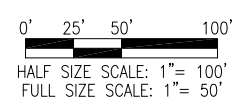
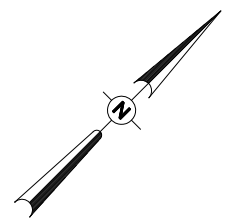
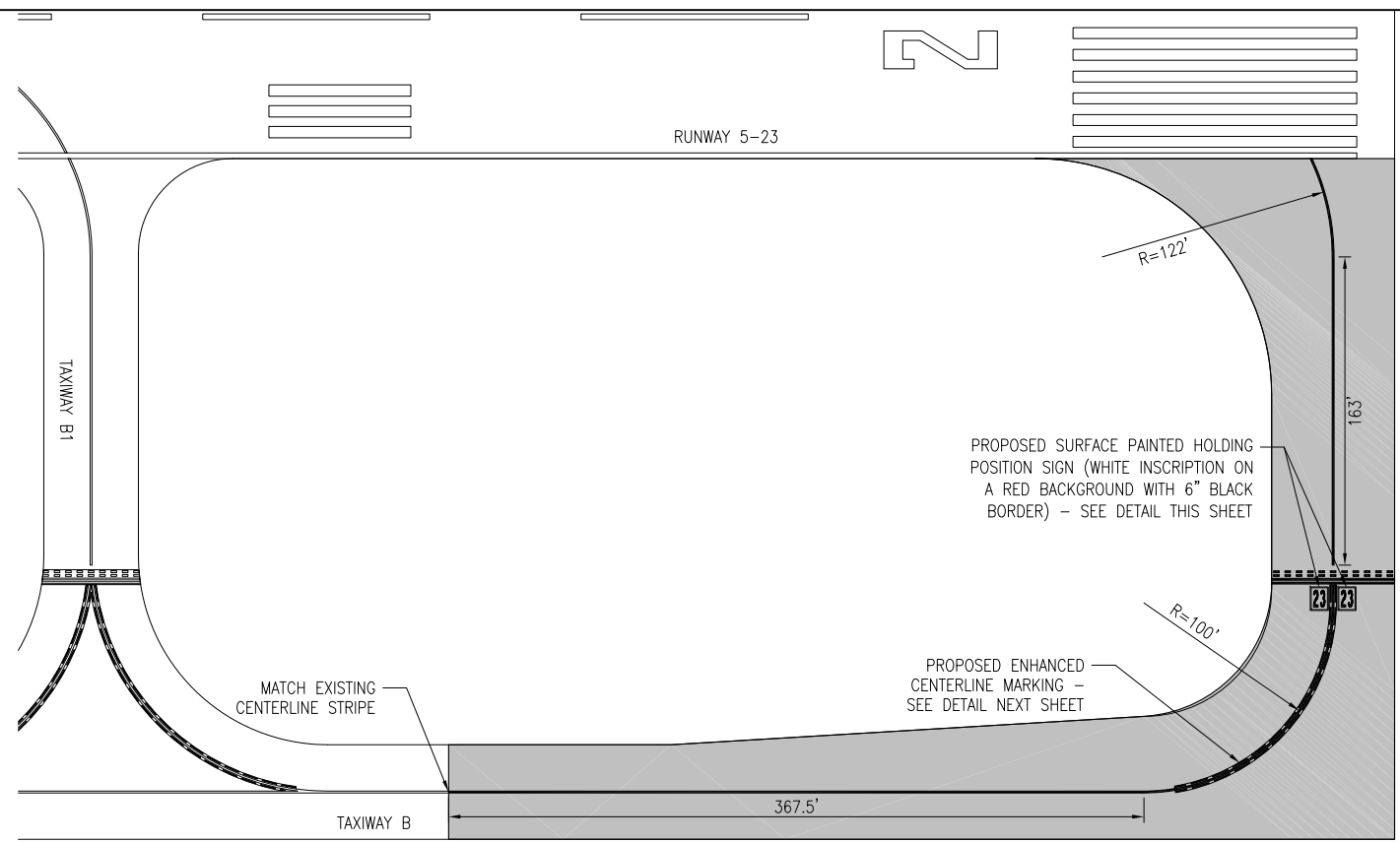

LEGEND

- EXISTING IMPROVEMENTS
- EXISTING BUILDINGS
- PROPOSED IMPROVEMENTS

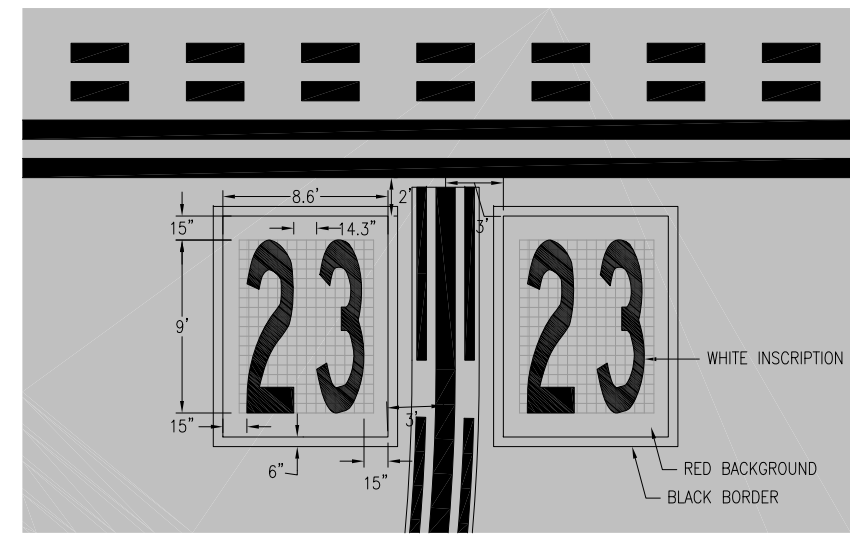

SURFACE PAINTED HOLDING POSITION SIGN DETAIL
TAXIWAY "B" SHORT OF RUNWAY END 23
SCALE: 1" = 5'

NOTE: GRID SHOWN FOR PROPER SIZING OF INSCRIPTIONS - NOT TO BE PAINTED. GRID SPACING IS 0.5 FEET.

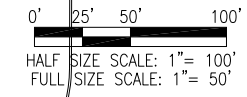
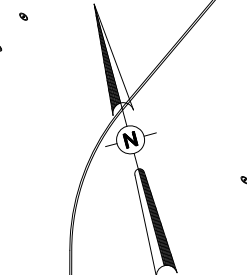
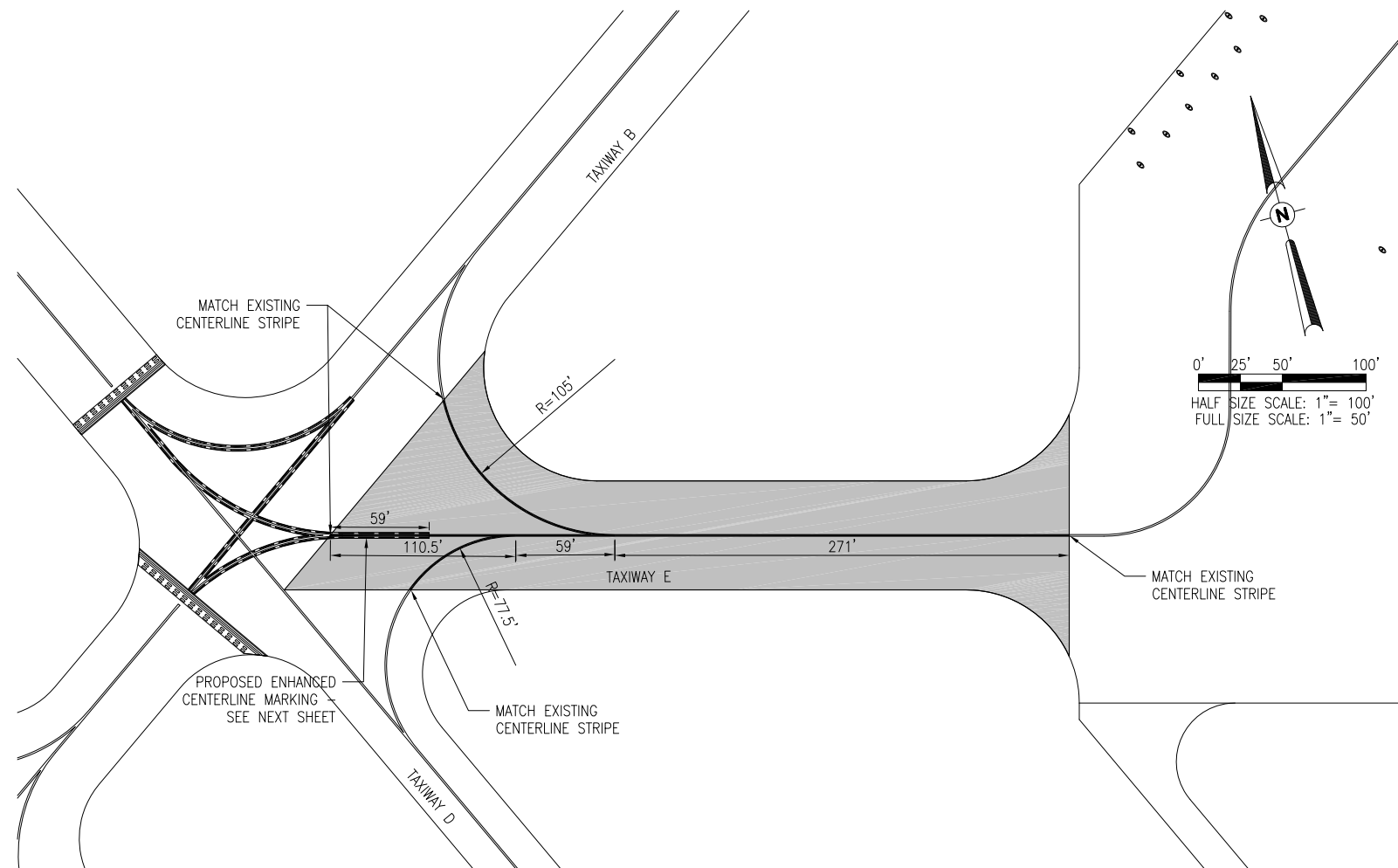

REHABILITATE TAXIWAYS B & E
IDA No: MVN-4326
Contract No. MV060

NO.	DATE	DESCRIPTION		
		LAY	DWN	REV

ISSUE: MAY 9, 2014
PROJECT NO: 13A0077D
CAD FILE: C-151-MRK.DWG
LAYOUT BY: JRH 03/20/2014
DRAWN BY: JRH 03/20/2014
REVIEWED BY: JSL 04/21/2014
© Copyright Hanson Professional Services Inc. 2013
SHEET TITLE

PROPOSED PAVEMENT MARKING PLANS

STATE OF ILLINOIS
BARRY S. STOLZ
062-057281
PROFESSIONAL ENGINEER
11/30/15
5/19/14

REHABILITATE
TAXIWAYS B & E

IDA No: MVN-4326

Contract No. MV060

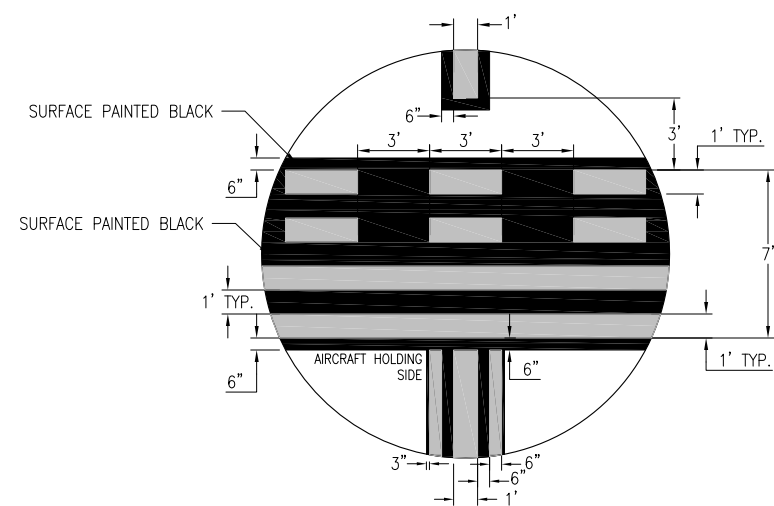

RUNWAY HOLDING POSITION DETAIL
"NOT TO SCALE"

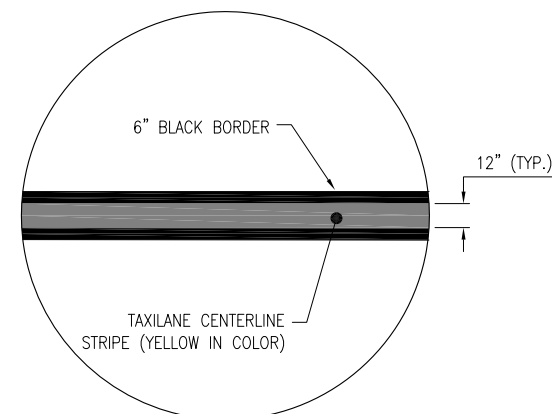

TAXIWAY CENTERLINE DETAIL
NOT TO SCALE

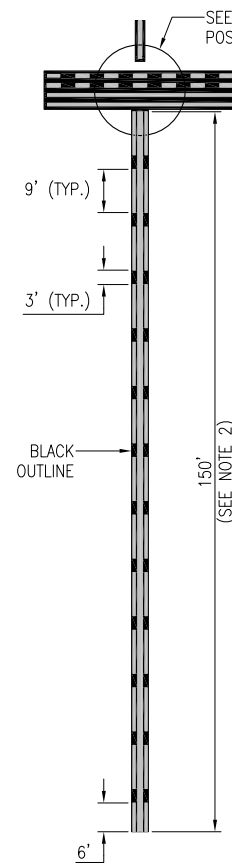

ENHANCED TAXIWAY CENTERLINE MARKING NOTES:

1. TAXIWAY CENTERLINE MARKINGS SHALL BE YELLOW IN COLOR AND OUTLINED IN BLACK.
2. TAXIWAY CENTERLINE MARKINGS SHALL BE ENHANCED FOR 150-FT PRIOR TO A RUNWAY HOLDING POSITION MARKING, UNLESS NOTED OTHERWISE. FOR A CURVED TAXIWAY CENTERLINE, THIS DISTANCE SHALL BE MEASURED ALONG THE CENTERLINE BEING ENHANCED TO A DISTANCE OF 150-FT.
3. WHERE TWO TAXIWAY CENTERLINES CONVERGE AT OR BEFORE THE RUNWAY HOLDING POSITION MARKING, PARTIAL INNER DASHED LINES LESS THAN 5 FEET AT THE POINT OF CONVERGENCE MAY BE OMITTED.
4. DASHES ON EITHER SIDE OF THE TAXIWAY CENTERLINE MUST BE ALIGNED, STARTING AND STOPPING WITH THE DASHES ON THE OPPOSITE SIDE OF THE CENTERLINE. TO ACCOMPLISH THIS FOR CURVED TAXIWAY CENTERLINES, THE MEASUREMENTS FOR THE DASHES AND GAPS SHALL BE MADE AT THE CENTERLINE AND EXTENDED PERPENDICULAR FROM THE CENTERLINE TO OBTAIN THE LOCATIONS OF THE DASHES.
5. ENHANCED TAXIWAY CENTERLINE MARKINGS SHALL BE IN ACCORDANCE WITH THE CURRENT EDITION OF FAA AC 150/5340-1, STANDARDS FOR AIRPORT MARKING.
6. PAINTING OF HOLDING POSITION MARKINGS IS NOT REQUIRED.

ENHANCED TAXIWAY CENTERLINE MARKING DETAIL
NOT TO SCALE

STORM WATER POLLUTION PREVENTION NOTES

1. THE CONTRACTOR SHALL IMPLEMENT ALL PROVISIONS OF THE CONTRACT DOCUMENTS TO ASSURE THAT STORM WATER POLLUTION PREVENTION ITEMS ARE CONSTRUCTED AND MAINTAINED IN A TIMELY MANNER. SEDIMENTATION MUST NOT BE TRANSPORTED OFF THE CONSTRUCTION SITE. PERMANENT DRAINAGE FEATURES AND VEGETATIVE MEASURES SHALL BE PROVIDED AS SOON AS POSSIBLE.
2. THE CONTRACTOR SHALL BE REQUIRED TO IMPLEMENT AND MAINTAIN STORM WATER POLLUTION PREVENTION PRACTICES AND MEASURES PRIOR TO THE STRIPPING OF EXISTING VEGETATION WHERE EVER POSSIBLE AND AS SOON AS CONSTRUCTION PERMITS IN OTHER AREAS. POLLUTION CONTROL MEASURES SHALL BE IN ACCORDANCE WITH THE CONTRACT DOCUMENTS, INCLUDING THESE CONSTRUCTION PLANS, AND WITH STANDARDS AND SPECIFICATIONS FOR SOIL EROSION AND SEDIMENT CONTROL, ILLINOIS ENVIRONMENTAL PROTECTION AGENCY, CURRENT ISSUE. THE CONTRACTOR SHALL ADJUST HIS OPERATIONS AND IMPLEMENT POLLUTION CONTROL MEASURES SO THAT NO RUNOFF FROM STRIPPED AREAS WILL LEAVE THE CONSTRUCTION SITE OTHER THAN THROUGH SEDIMENT TRAPS OR OTHER SUITABLE CONTROL MEASURES.
3. POLLUTION CONTROL ITEMS SHALL BE PROVIDED AS NOTED ON THE STORM WATER POLLUTION PREVENTION PLAN AND IN THE STORM WATER POLLUTION PREVENTION DETAILS AND AS DIRECTED BY THE ENGINEER. THE LIMITS OF SUCH MEASURES SHALL BE STAKED BY THE CONTRACTOR PRIOR TO THE COMMENCEMENT OF CONSTRUCTION. SUCH LIMITS MAY BE ADJUSTED BY THE ENGINEER TO ACCOUNT FOR ACTUAL SITE CONDITIONS EXPERIENCED DURING CONSTRUCTION. ADDITIONAL COMPENSATION FOR MEASURES EXCEEDING THE PLAN QUANTITIES WILL BE PAID FOR AT THE CONTRACT UNIT PRICE FOR EACH ITEM.
4. THE CONTRACTOR IS TO MAINTAIN AND ADJUST, REPAIR OR REPLACE ALL POLLUTION PREVENTION MEASURES AS REQUIRED OR AS DIRECTED BY THE ENGINEER UNTIL PERMANENT VEGETATION HAS BEEN ESTABLISHED. MAINTENANCE OF POLLUTION CONTROL MEASURES IS TO BE PROVIDED AT NO ADDITIONAL COST TO THE CONTRACT.

NO.	DATE	DESCRIPTION		
		LAY	DWN	REV

ISSUE: MAY 9, 2014
PROJECT NO: 13A0077D
CAD FILE: C-581-DET.DWG
LAYOUT BY: JRH 04/04/2014
DRAWN BY: JRH 04/04/2014
REVIEWED BY: JSL 04/21/2014
© Copyright Hanson Professional Services Inc. 2013
SHEET TITLE

MISCELLANEOUS
DETAILS AND NOTES